

INSTALLATION INSTRUCTIONS

1935W - HOLDEN VX, VY & VZ SEDAN 10/00 TO 07/06.

PLEASE READ INSTRUCTIONS THROUGH BEFORE YOU BEGIN

WARNING: 1. Do not drill, cut weld or otherwise modify the towbar.

2. If you are using electric welding on a motor vehicle, **always** check that the vehicle is not equipped with electronic engine or instrument management equipment. Failure to do so could **destroy** any onboard computers. If in doubt, check with the vehicle's manufacturer.

Max. Towing Weight: 1250 kg

1. Ensure all hardware items have been included.
2. Remove the bumper bar, the bumper stiffener and stiffener brackets. Retain the four M12 nuts from the stiffener brackets.
3. From under the vehicle remove the rear nut securing the centre fuel tank bracket and discard nut. Offer the forward mounting bracket to the vehicle, loosely secure using M10 x 1.5p nuts and spring washers forward most, ensure fuel tank bracket is returned to its original position.
4. Loosely secure using M10 x 1.5p nuts, spring washers and flat washers rear most.
5. Offer towbar to vehicle; refit bumper stiffener brackets and loosely secure using, M12 spring washers and existing M12 nuts.
6. Secure forward mounting bracket to towbar with M12 x 35 - 1.75p bolt, flat washer, spring washer and nut.
7. Tighten all bolts to the correct settings as listed below.
8. Refit bumper stiffener and bumper bar.
9. Attach the lug to the towbar using M16 x 45 bolts and spring washer.
10. Towbar rating sticker to be conspicuously located on inside rear end of the driver's door. **(See diagram below)**

NOTE: Hayman Reese recommends that you check your towball to ensure it complies with Australian Design Rules **ASA4177.2**.

RECOMMENDED ASSEMBLY TORQUE LISTING

| Diameter | Grade 8.8 Bolt |
|-----------------|-----------------------|
| | Nm |
| M6 | 9.5 |
| M8 | 21.7 |
| M10 | 43.4 |
| M12 | 77.3 |
| M14 | 121.0 |
| M16 | 189.8 |

FOR TOWING PURPOSES ONLY

For towing capacity details please refer to vehicle owner's manual or to the manufacturer. Overloading can void your warranties.

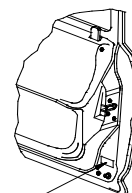

← POSITION OF TOWBAR RATING STICKER

PLEASE NOTE: It is advised to remove your lug or tbn when not actually towing so as to produce a clear view of the vehicles registration plate if obscured, and to also provide maximum available departure angle

1935W - HOLDEN VX, VY & VZ SEDAN 10/00 TO 07/06.

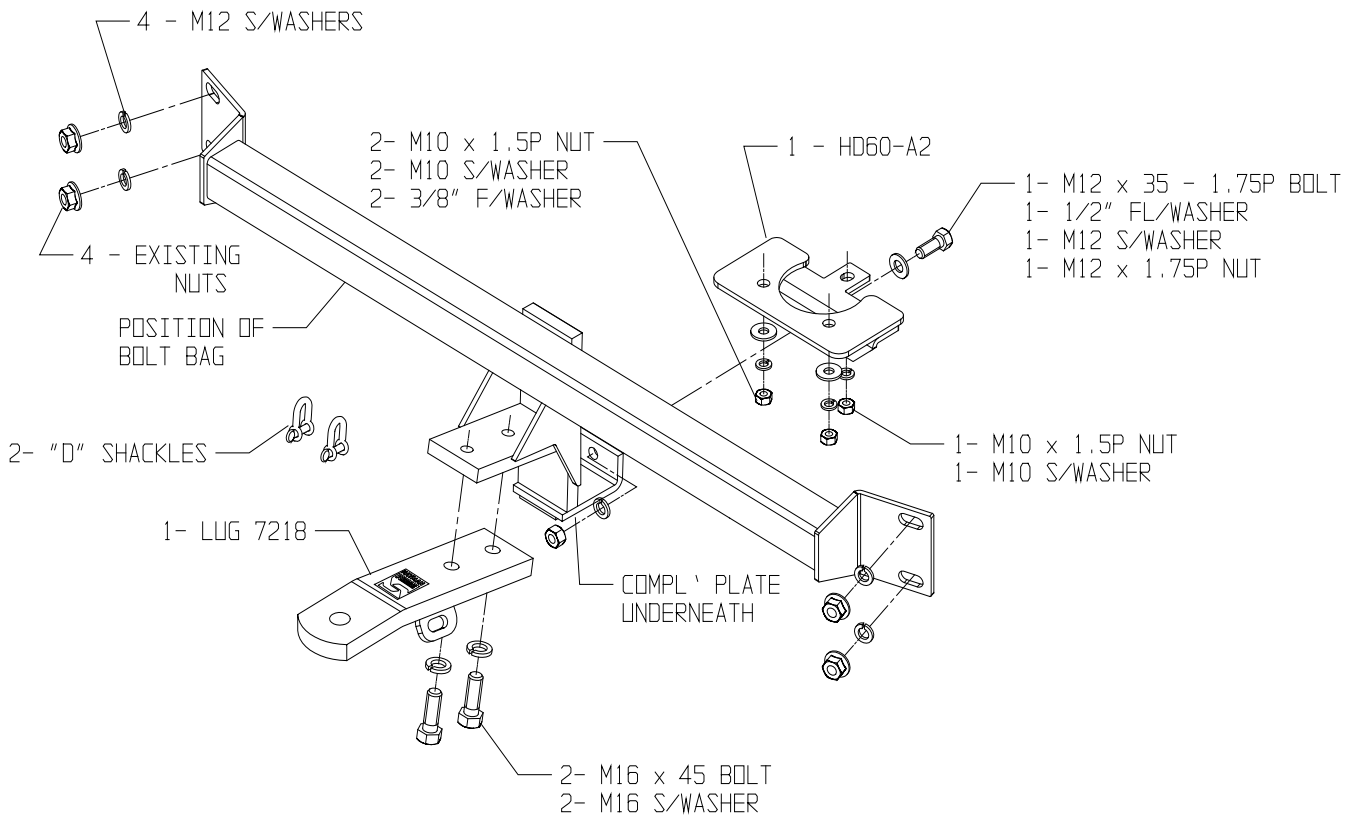

HAYMAN REESE
PART No: 100044-WL
HOLDEN COMMODORE – VT-VX-VY-VZ
INSTALLATION INSTRUCTIONS

PLEASE ENSURE THAT INSTRUCTIONS ARE UNDERSTOOD PRIOR TO FITMENT

Wiring Loom Installation Instructions

Holden Commodore – VT-VX-VY-VZ
Part No: 100044-WL

Tail Harness Length Required: 1200mm
RPA Override Switch Part No: 04848 (If Fitted)

Wiring Loom Installation Time: Approx 20 Mins

Issue Date 28-10-09

Page 1

Part No: 100044-WL

Hayman Reese (Cequent)
PO Box 4050, Dandenong South VIC 3164
Phone 1800 812 017 Email info@haymanreese.com.au

www.haymanreese.com.au



HAYMAN REESE
PART No: 100044-WL
HOLDEN COMMODORE – VT-VX-VY-VZ
INSTALLATION INSTRUCTIONS

PLEASE ENSURE THAT INSTRUCTIONS ARE UNDERSTOOD PRIOR TO FITMENT

**Note: For Wagon models, go to step 9.
For VT, VX, VY and VZ sedan models,
continue:**

1. In the luggage compartment area, remove the floor carpet (1).



2. Remove the rear trim fasteners and rear trim (1).

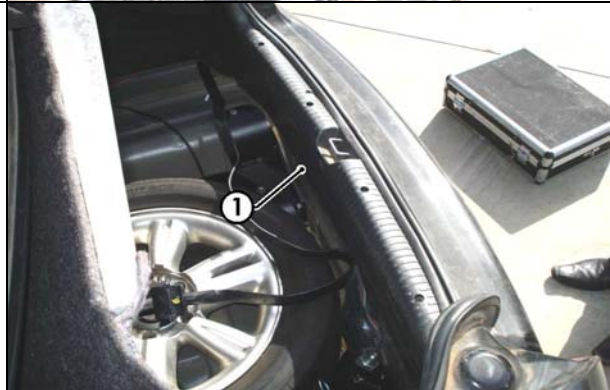

3. Remove the RHS luggage compartment trim fasteners and the RHS trim (1).



Issue Date 28-10-09

Page 2

Part No: 100044-WL

Hayman Reese (Cequent)
PO Box 4050, Dandenong South VIC 3164
Phone 1800 812 017 Email info@haymanreese.com.au

www.haymanreese.com.au



HAYMAN REESE
PART No: 100044-WL
HOLDEN COMMODORE – VT-VX-VY-VZ
INSTALLATION INSTRUCTIONS

PLEASE ENSURE THAT INSTRUCTIONS ARE UNDERSTOOD PRIOR TO FITMENT

4. Remove the rear bumper fascia fasteners and then remove the rear bumper fascia (1).

Drill a Ø30mm grommet hole (2) out of the location shown. File down any rough edges and spray on rust inhibitor.

Mount the Tail Harness socket (Tail length 1200mm) to the towbar mounting bracket using M4 fasteners.

Route the harness along the towbar and into the grommet hole.

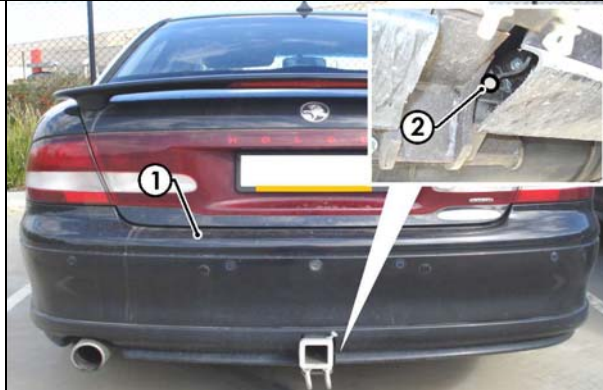

5. In the luggage compartment, retrieve the Tail Harness (1).

Adjust the harness grommet to the desired position, ensuring that it is seated correctly into the vehicle grommet hole. Secure the vehicle grommet using a cable tie.

On the outside of the vehicle, secure the harness to the towbar using cable ties.

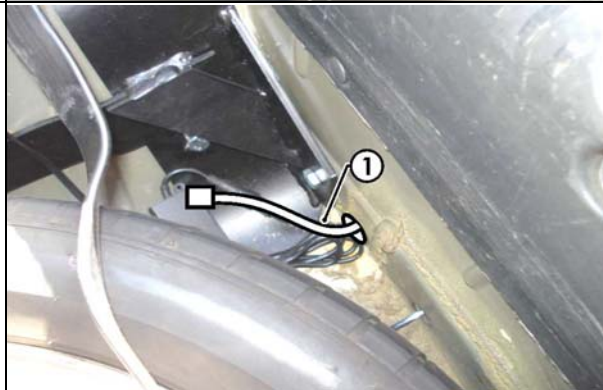

6. Disconnect the RHS tail light connectors (1) and the 1-way indicator connector (2). Connect the Trailer Patch Harness (P/No: 100044-WL) (3) in between the tail light connectors and the 1-way indicator connector.

Connect the Tail Harness 8-way male connector (4) to the Trailer Patch Harness 8-way female connector (5).

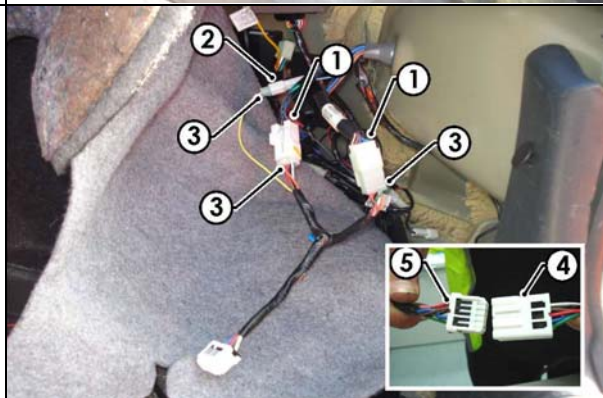

Issue Date 28-10-09

Page 3

Part No: 100044-WL

Hayman Reese (Cequent)
PO Box 4050, Dandenong South VIC 3164
Phone 1800 812 017 Email info@haymanreese.com.au

www.haymanreese.com.au



HAYMAN REESE
PART No: 100044-WL
HOLDEN COMMODORE – VT-VX-VY-VZ
INSTALLATION INSTRUCTIONS

PLEASE ENSURE THAT INSTRUCTIONS ARE UNDERSTOOD PRIOR TO FITMENT

7. Refit the rear bumper fascia (1).



8. Test the Trailer Harness function using a Light Board or multimeter.

Secure the Trailer Patch Harness using cable ties.

Refit all removed parts and secure all fasteners ensuring there are no squeaks or rattles.

Place instructions in glove box after fitment.

Issue Date 28-10-09

Page 4

Part No: 100044-WL

Hayman Reese (Cequent)
PO Box 4050, Dandenong South VIC 3164
Phone 1800 812 017 Email info@haymanreese.com.au

www.haymanreese.com.au



HAYMAN REESE
PART No: 100044-WL
HOLDEN COMMODORE – VT-VX-VY-VZ
INSTALLATION INSTRUCTIONS

PLEASE ENSURE THAT INSTRUCTIONS ARE UNDERSTOOD PRIOR TO FITMENT

9. The following steps for Wagon models only.

Remove the rear bumper fascia fasteners and the rear bumper fascia.

Remove the RHS luggage compartment access door (1).

Remove the RHS tail light assembly fasteners and the tail light assembly (2).



10. Drill a Ø30mm hole (1) at the indicated position of the rear tail gate, below the RHS tail light cavity opening. File down any rough edges and spray on rust inhibitor.



11. Mount the Tail Harness socket (1) (Tail length 1200mm) to the towbar mounting bracket using M4 fasteners.

Route the Tail Harness along the towbar and into the grommet hole.

Adjust the harness grommet to the desired position, ensuring that it is seated correctly into the vehicle grommet hole. Secure the vehicle grommet using a cable tie.

Secure the harness to the towbar using cable ties

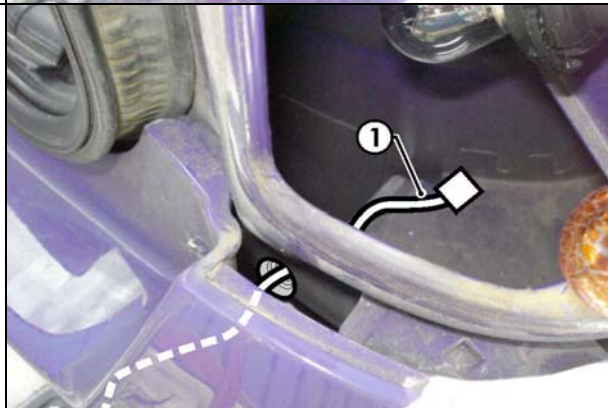

Issue Date 28-10-09

Page 5

Part No: 100044-WL

Hayman Reese (Cequent)
PO Box 4050, Dandenong South VIC 3164
Phone 1800 812 017 Email info@haymanreese.com.au

www.haymanreese.com.au



HAYMAN REESE
PART No: 100044-WL
HOLDEN COMMODORE – VT-VX-VY-VZ
INSTALLATION INSTRUCTIONS

PLEASE ENSURE THAT INSTRUCTIONS ARE UNDERSTOOD PRIOR TO FITMENT

12. Disconnect the RHS tail light connectors (1) and the 1-way indicator connector (2). Connect the Trailer Patch Harness (P/No: 100044-WL) (3) in between the tail light connectors and the 1-way indicator connector.

Connect the Tail Harness 8-way male connector (4) to the Trailer Patch Harness 8-way female connector (5).

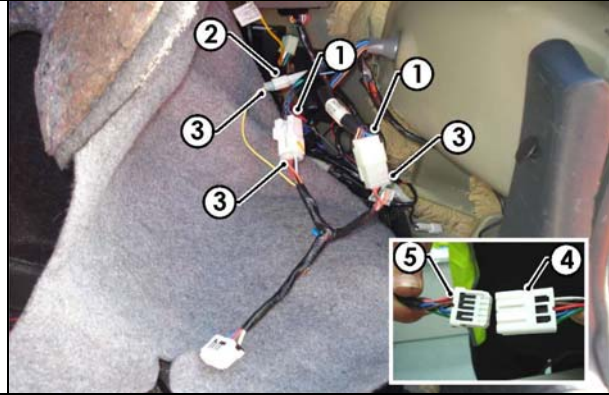

13. Test the Trailer Harness function using a Light Board or multimeter.

Secure the Trailer Patch Harness using cable ties.

Refit all removed parts and secure all fasteners ensuring there are no squeaks or rattles.

Place instructions in glove box after fitment.

Issue Date 28-10-09

Page 6

Part No: 100044-WL

Hayman Reese (Cequent)
PO Box 4050, Dandenong South VIC 3164
Phone 1800 812 017 Email info@haymanreese.com.au

www.haymanreese.com.au

