

HAYMAN REESE
PART No: **03110RW**
HONDA HR-V 2015 ON

INSTALLATION INSTRUCTIONS

PLEASE ENSURE THAT ALL INSTRUCTIONS ARE UNDERSTOOD PRIOR TO FITMENT
PLACE THESE INSTRUCTIONS IN THE VEHICLE'S GLOVEBOX AFTER INSTALLATION IS COMPLETED



Installation Time: Approx **80** Mins

Towbar Installation Instructions

Towbar capacity

HONDA HR-V 2015 ON

Part Number **03110RW**

Max Towing Braked

800 kg

Max Static Ball Load

70 kg

Hayman Reese (Cequent)
PO Box 4050, Dandenong South VIC 3164
Phone 1800 812 017 Email info@haymanreese.com.au

INSTALLATION INSTRUCTIONS

PLEASE ENSURE THAT ALL INSTRUCTIONS ARE UNDERSTOOD PRIOR TO FITMENT
PLACE THESE INSTRUCTIONS IN THE VEHICLES'S GLOVEBOX AFTER INSTALLATION IS COMPLETED

Warning:

1. Do not, drill, cut, weld or otherwise modify the towbar.
2. If you are using electric welding on a motor vehicle, **always** check that the vehicle is not equipped with electronic engine or instrument management equipment. Failure to do so could **destroy** any onboard computers. If in doubt, check with the vehicle's manufacturer.
3. If TBM is used in inverted position tow ball may make contact with rear tailgate when lowered, which could cause damage.

General:

1. Ensure all hardware items have been included refer to assembly diagram.
2. It is recommended that the instructions are read through and completely understood before making any attempt to fit this product.
3. Be wary of any changes to vehicle designs or other accessories that may conflict with the installation of this product.
4. Before drilling ensure that the area is clear of fuel, electrical & other components.
5. All holes drilled into the body panels shall have all burrs & swarf removed then coated with a suitable rust preventative paint.
6. The high tensile fasteners supplied with this product were used to achieve the specified rating. If replacement is required ensure that fasteners of the same rating & quality are used. Contact an authorised **Hayman Reese** dealer if further information is required.
7. Ensure that all hardware is fastened to torque list below check fasteners on regular basis.
8. Towbar load rating sticker provided with this product shall be conspicuously located on inside rear end of the driver's door. **(See diagram below).**
9. Hayman Reese recommends that you check your tow ball to ensure that it complies with the Australian standards **AS 4177.2**.
10. **PLEASE NOTE:** It is advised to remove your lug or tbn when not actually towing so as to produce a clear view of the vehicles registration plate if obscured, and to also provide maximum available departure angle.
11. Pull Pin must be fit in down position.

Tow bar Maintenance and Care.

Hayman Reese recommends that bolt torque's, as listed below, are routinely and regularly inspected and checked for correct tension. Replace any worn or defective parts.

We recommended to remove Tow Ball Mounts (TBM's, tongues or lugs) when not being used for any considerable length of time.

So as to avoid injury, when not towing it is suggested that the tongue, Pull Pin and R-clip are removed then stored in a safe, clean and dry place, away from excessive moisture.

Hitch Pull Pins and spring "R" clips are regularly checked for proper installation. Replace any worn or defective parts.

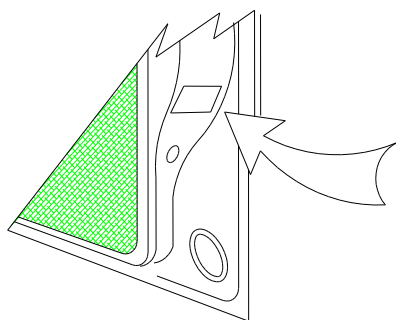

Place load rating sticker
inside driver's door here

RECOMMENDED ASSEMBLY TORQUE LISTING

Diameter Grade 8.8 Bolt

M6	9.5 Nm
M8	21.7 Nm
M10	43.4 Nm
M12	77.3 Nm
M14	146 Nm
M16	189.8 Nm

FOR TOWING PURPOSES ONLY

For towing capacity details please refer to vehicle owner's manual or to the manufacturer. Overloading can void your warranties.

HAYMAN REESE
PART No: 03110RW
HONDA HR-V 2015 ON

INSTALLATION INSTRUCTIONS

PLEASE ENSURE THAT ALL INSTRUCTIONS ARE UNDERSTOOD PRIOR TO FITMENT
 PLACE THESE INSTRUCTIONS IN THE VEHICLES'S GLOVEBOX AFTER INSTALLATION IS COMPLETED

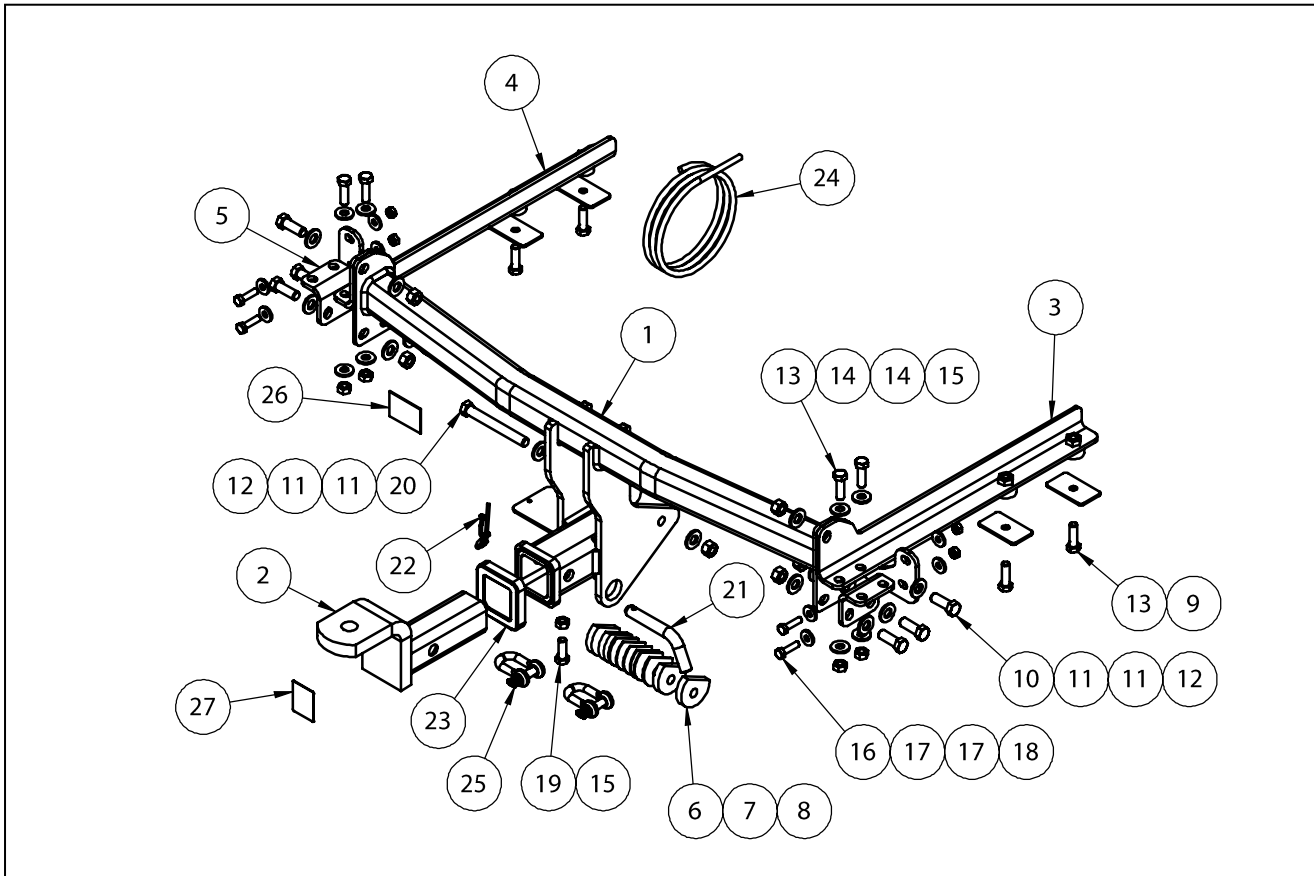

QTY.	DESCRIPTION	ITEM NO.	QTY.	DESCRIPTION	ITEM NO.
1	WELDED ASSEMBLY	1	5	HEX NUT M10x1.5	15
1	TBM ASSEMBLY	2	4	BOLT M8-1.25x30mm	16
1	SIDE ARM RHS	3	8	FLAT WASHER M8x22x3.3mm	17
1	SIDE ARM LHS	4	4	NUT M8- 1.25	18
2	SIDE ARM BENT BRACKET	5	1	SET SCREW HEX M10x30x1.5P	19
4	LARGE SPACER	6	1	BOLT M12x110	20
2	MID SPACER	7	1	PULL PIN	21
4	SMALL SPACER	8	1	SPRING COTTER PIN ASSY	22
4	WASHER PLATE	9	1	HITCH BOX COLLAR COVER	23
6	SET SCREW M12x35 1.75P	10	1	WIRING LOOM	24
14	WASHER FLAT 1/2"x1 1/8"x1/8"	11	2	D' SHACKLE	25
7	HEX NUT M12x1.75 PC8	12	1	ACRYLIC CP	26
8	SET SCREW M10-1.5x35mm	13	1	H.R STICKER	27
8	WASHER FT M10x25.4x3	14			

INSTALLATION INSTRUCTIONS

PLEASE ENSURE THAT ALL INSTRUCTIONS ARE UNDERSTOOD PRIOR TO FITMENT
PLACE THESE INSTRUCTIONS IN THE VEHICLES'S GLOVEBOX AFTER INSTALLATION IS COMPLETED

1. Remove all Screws located in Wheel Arc that are retaining the Wheel Arc Plastic trim, then unclip the wheel arc plastic trim from vehicle and remove a Screw that is present under the trim which retains the bumper to the vehicle.

Do this for both LH & RH sides.

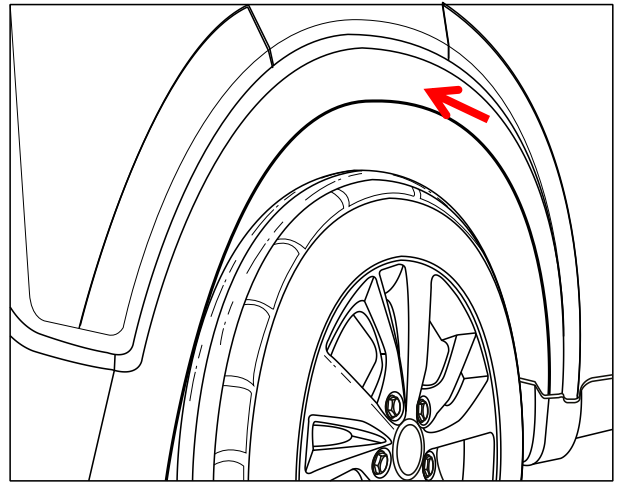

2. Remove all Fasteners retaining the plastic under cover and place plastic under cover to the side.

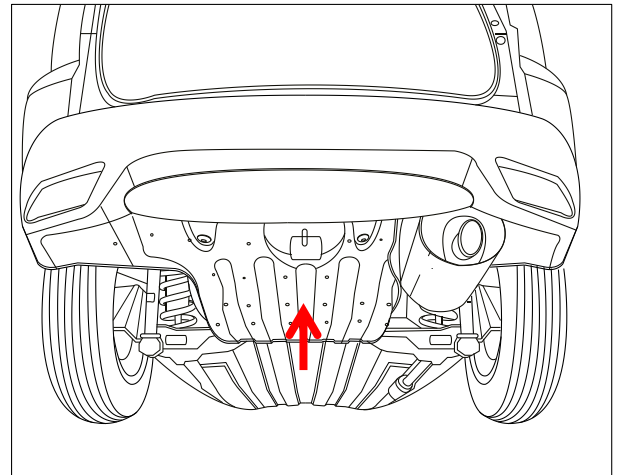

3. Remove all Screws retaining bumper to vehicle located under the rear door.

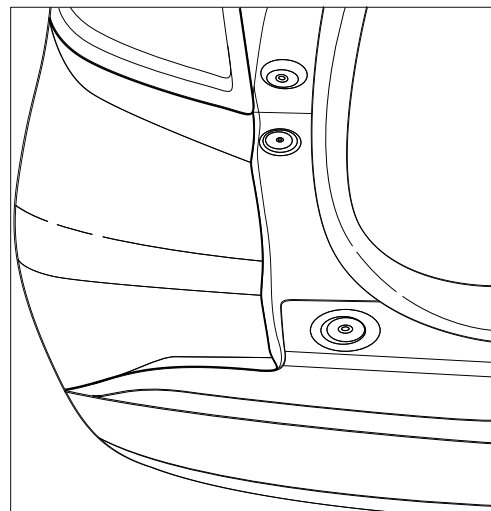

INSTALLATION INSTRUCTIONS

PLEASE ENSURE THAT ALL INSTRUCTIONS ARE UNDERSTOOD PRIOR TO FITMENT
PLACE THESE INSTRUCTIONS IN THE VEHICLES'S GLOVEBOX AFTER INSTALLATION IS COMPLETED

4. Firmly pull on bumper to release the clips retaining it to the vehicle, and place bumper to the side.

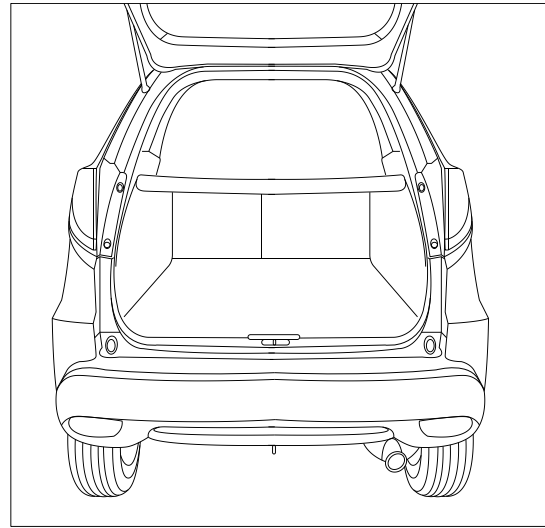

5. Cut back panel to open up chassis rail, using the existing cuts as guide for both LH & RH sides.

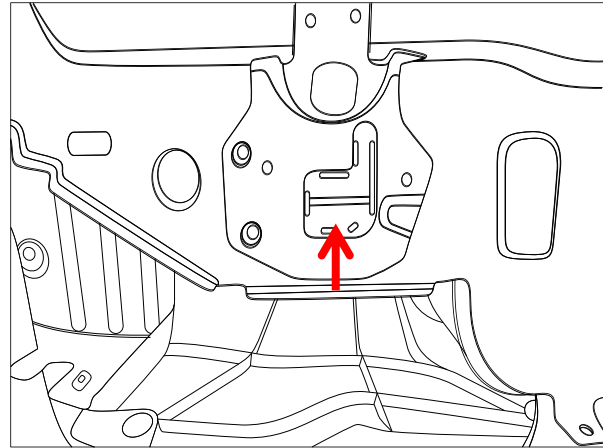

6. Insert side arm into chassis rail and loose fasten with Bolts and Washer Plate for both LH & RH sides, then offer Towbar centre section to vehicle and also loosely fasten.

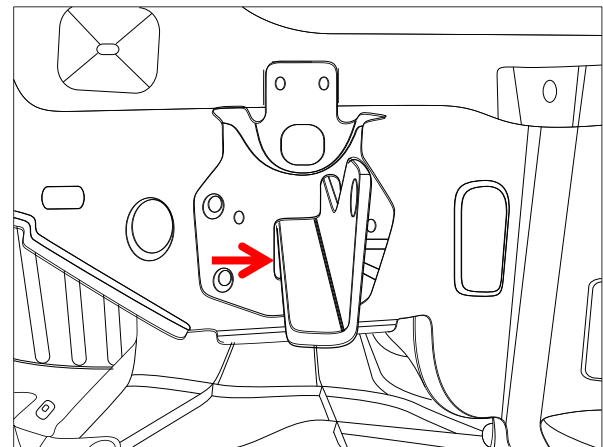

INSTALLATION INSTRUCTIONS

PLEASE ENSURE THAT ALL INSTRUCTIONS ARE UNDERSTOOD PRIOR TO FITMENT
PLACE THESE INSTRUCTIONS IN THE VEHICLES'S GLOVEBOX AFTER INSTALLATION IS COMPLETED

7. Attach Towbar centre section to the factory shipping hook using the supplied shim plates as need to fill the gaps either side and then tighten all bolts to the torque specification provide for each size Bolt on page 2.

Plastic under cover requires a cut use the plastic ribs and edge of existing shipping hook cut out as guide as seen in image.

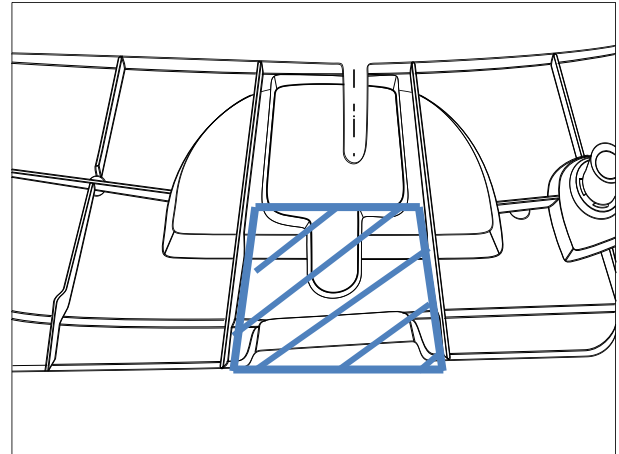

8. Create a Bumper cut using the existing Bumper cut template located in the inside of the Bumper to determine the centre of the bumper, make cut out approximately 110mm wide and 80mm high.

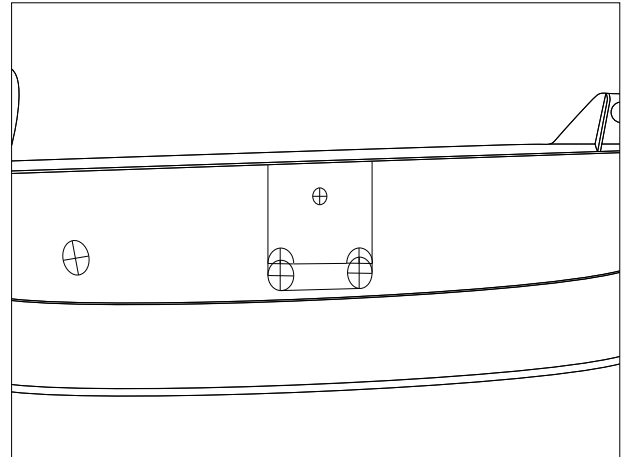

9. Refit all components back onto vehicle in reverse order to disassembly.

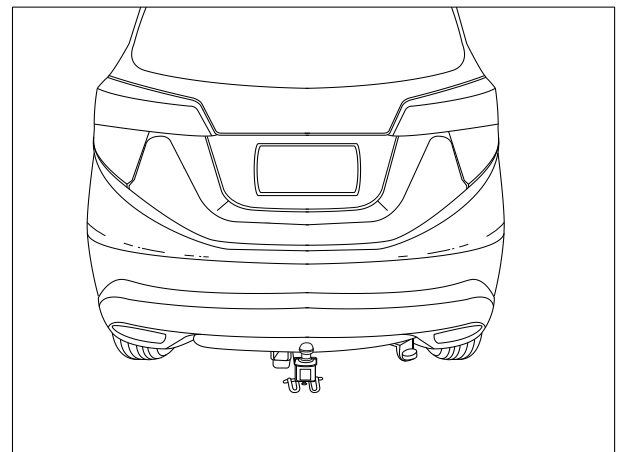

HAYMAN REESE
PART No: 101288-WL
HONDA HR-V

INSTALLATION INSTRUCTIONS

PLEASE ENSURE THAT INSTRUCTIONS ARE UNDERSTOOD PRIOR TO FITMENT

Wiring Loom Installation Instructions

HONDA HR-V
Part No: 101288-WL

Tail Harness Length Required: 1800mm

Wiring Loom Installation Time: Approx 30 Mins

Important



Due to possible vehicle variations, always confirm any noted vehicle colour wires with a multi-meter to ensure the correct function is identified before soldering or scotch locking.

Issue Date 05-04-16

Page 1

Hayman Reese (Cequent)
PO Box 4050, Dandenong South VIC 3164
Phone 1800 812 017 Email info@haymanreese.com.au

www.haymanreese.com.au



HAYMAN REESE
PART No: 101288-WL
HONDA HR-V

INSTALLATION INSTRUCTIONS

PLEASE ENSURE THAT INSTRUCTIONS ARE UNDERSTOOD PRIOR TO FITMENT

1. In the luggage compartment, fold down the rear seats (1).
2. Remove the floor cover carpet (2) by removing the two screws (3).
3. Remove the luggage compartment rear trim (4).

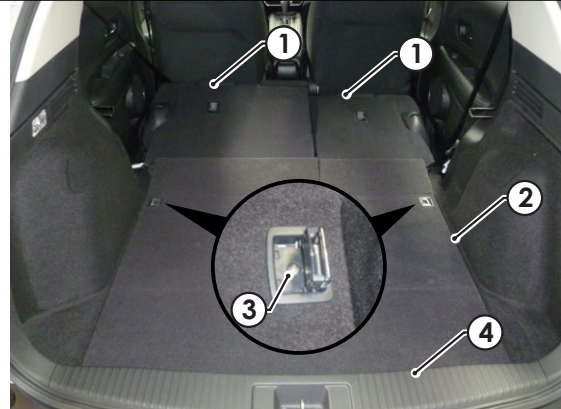

4. In the luggage compartment RHS rear quarter area, find the location as shown on the sheet metal floor (1) near the vent and drill out a Ø30mm hole. Apply rust inhibitor after drilling.



5. Disconnect the vehicle RHS tail light connectors and patch the trailer patch (P/No: 101288-WL) RHS branch connectors (2) in between.

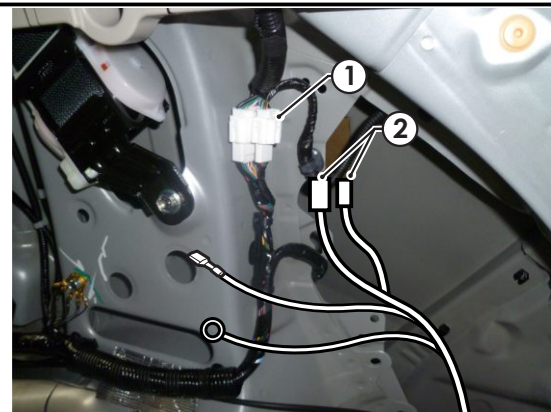

Issue Date 05-04-16

Page 2

Hayman Reese (Cequent)
PO Box 4050, Dandenong South VIC 3164
Phone 1800 812 017 Email info@haymanreese.com.au

HAYMAN REESE
PART No: 101288-WL
HONDA HR-V

INSTALLATION INSTRUCTIONS

PLEASE ENSURE THAT INSTRUCTIONS ARE UNDERSTOOD PRIOR TO FITMENT

6. Following the table below, connect the ezy-tap (1) to the corresponding vehicle wire (2), then connect the trailer patch terminal (3) to the ezy-tap (1). Due to vehicle variations, ensure to use a multi-meter to determine the correct signals.

Function	Trailer Patch	Vehicle Wire
REVERSE	BLACK	BROWN

7. Secure the trailer patch ground ring terminal (4) to the vehicle grounding point (5).
8. Route the trailer patch harness across the rear of the vehicle towards the LHS.

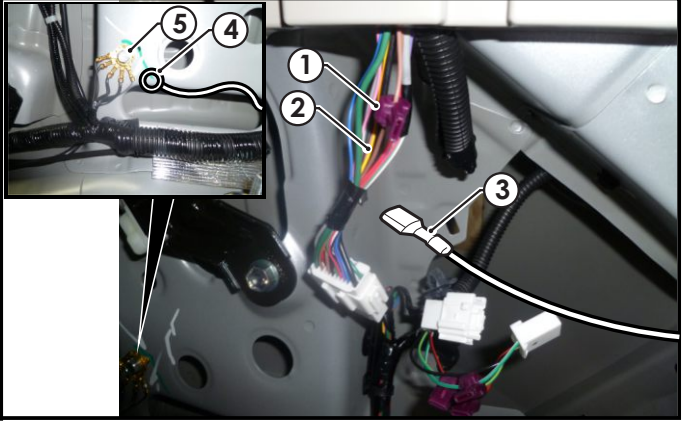

9. Disconnect the vehicle LHS tail light connector (1) and patch the trailer patch LHS branch connectors (2) in between.

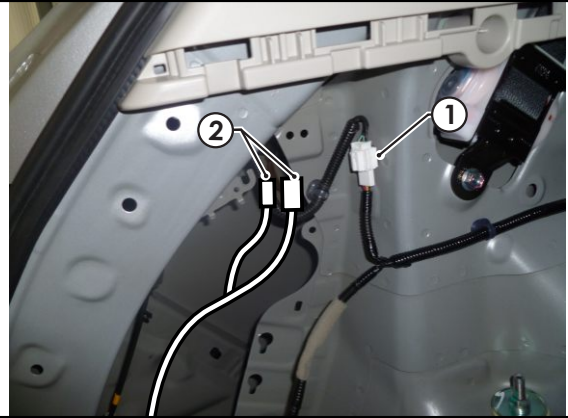

10. At the rear exterior of the vehicle, mount the tail harness socket (1) to the towbar mounting bracket using M4 fasteners.
11. Route the tail harness (tail length: 1800mm) (2) across the RHS and up into the drilled out grommet hole (3). Adjust the trailer patch harness grommet (3) so that it is seated correctly and cable tie in place.

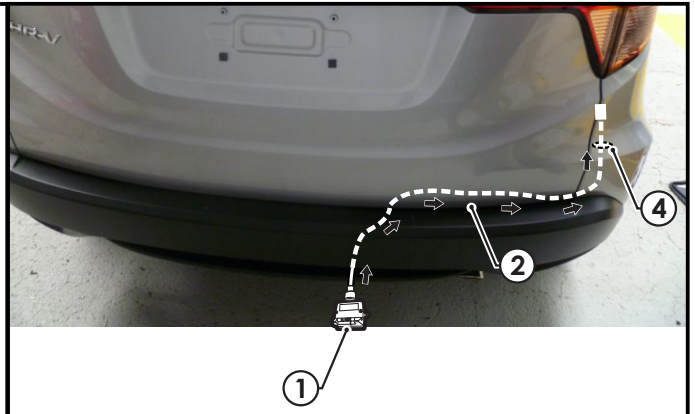

Issue Date 05-04-16

Page 3

Hayman Reese (Cequent)
 PO Box 4050, Dandenong South VIC 3164
 Phone 1800 812 017 Email info@haymanreese.com.au

HAYMAN REESE
PART No: 101288-WL
HONDA HR-V

INSTALLATION INSTRUCTIONS

PLEASE ENSURE THAT INSTRUCTIONS ARE UNDERSTOOD PRIOR TO FITMENT

12. Connect the tail harness 8-way connector (1) to the trailer patch 8-way mating connector (2).

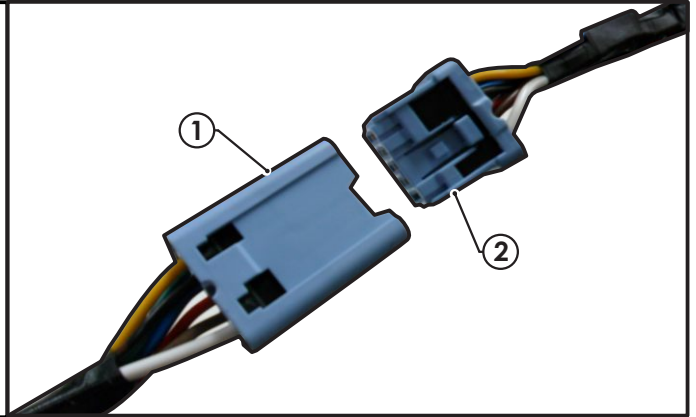

13. Test the body harness using a light board or multi-meter.
14. Secure all harnesses using cable ties.
15. Re-fit all removed parts and secure all fasteners, ensuring there are no squeaks or rattles.
16. Place the instructions in the glove box after fitment.

Issue Date 05-04-16

Page 4

Hayman Reese (Cequent)
PO Box 4050, Dandenong South VIC 3164
Phone 1800 812 017 Email info@haymanreese.com.au



FITTING INSTRUCTIONS

Smart Pin (55070BL)

• These fitting instructions are supplied to ensure understanding of how the SMART PIN should be fitted and used correctly.

• Once installed, we recommend **ALL** instructions are kept and placed in the vehicle glove box.

NOTE: Routine maintenance and inspection of the towbar & SMART PIN is required. Regularly inspect for wear and check the tightness of the SMART PIN NUT. Follow instructions below to retighten the nut when necessary.

***Do not tow with your vehicle if the R CLIP or the SMART PIN NUT is loose or missing. Replacement parts are available from your Hayman Reese Distributor.**

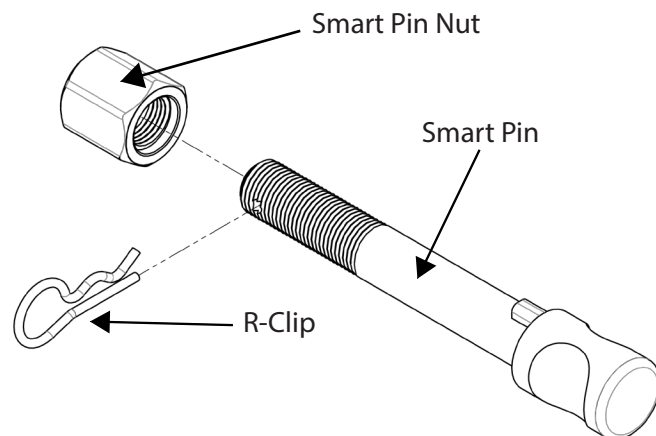
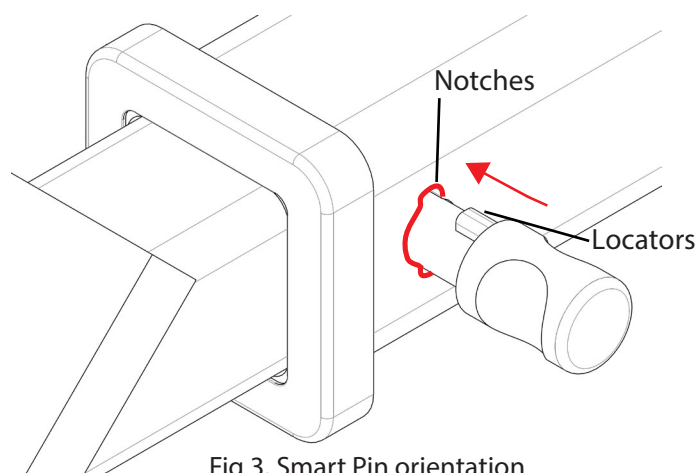
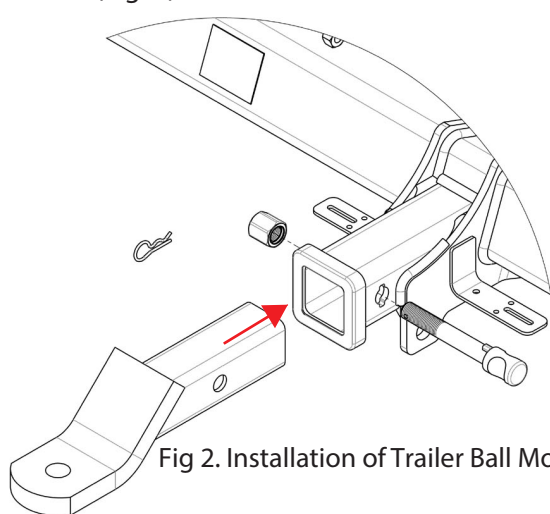

Fig 1. Smart Pin assembly

STEP 1 Insert Trailer Ball Mount (TBM) into towbar HITCHBOX, aligning hole in TBM SHANK with hole in HITCHBOX (Fig. 2).



STEP 2 Insert SMART PIN through hole in HITCHBOX and hole in TBM SHANK; ensure the LOCATORS are inserted into the NOTCHES in the HITCHBOX (Fig. 3).

STEP 3 Screw SMART PIN NUT onto SMART PIN; tighten SMART PIN NUT until finger tight, ensuring TBM is restrained from movement.

STEP 4 Tighten SMART PIN NUT by turning nut a further 1/8th of a turn in the clockwise direction using a 24mm spanner (Fig 4).

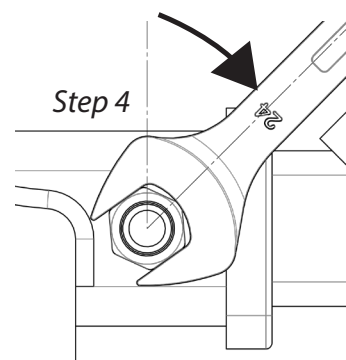

STEP 5 Install SMART PIN R CLIP through the hole on the SMART PIN (Fig. 1).

