

**HAYMAN REESE**  
**PART No: 03118RW**  
**MITSUBISHI TRITON D-CAB WITH STEP**  
**INSTALLATION INSTRUCTIONS**

PLEASE ENSURE THAT ALL INSTRUCTIONS ARE UNDERSTOOD PRIOR TO FITMENT  
PLACE THESE INSTRUCTIONS IN THE VEHICLE'S GLOVEBOX AFTER INSTALLATION IS COMPLETED



Installation Time: Approx 30 Mins

**Towbar Installation Instructions**

**Towbar capacity**

**MITSUBISHI TRITON D-CAB WITH STEP**

<b>Part Number 03118RW</b>	<b>Max Towing Braked</b>	<b>3100 kg</b>
	<b>Max Towing Unbraked</b>	<b>700 kg</b>
	<b>Max Static Ball Load</b>	<b>310 kg</b>

Hayman Reese (Cequent)  
PO Box 4050, Dandenong South VIC 3164  
Phone 1800 812 017 Email [info@haymanreese.com.au](mailto:info@haymanreese.com.au)

**HAYMAN REESE**  
**PART No: 03118RW**  
**MITSUBISHI TRITON D-CAB WITH STEP**

**INSTALLATION INSTRUCTIONS**

PLEASE ENSURE THAT ALL INSTRUCTIONS ARE UNDERSTOOD PRIOR TO FITMENT  
PLACE THESE INSTRUCTIONS IN THE VEHICLES'S GLOVEBOX AFTER INSTALLATION IS COMPLETED

**Warning:**

1. Do not, drill, cut, weld or otherwise modify the towbar.
2. If you are using electric welding on a motor vehicle, **always** check that the vehicle is not equipped with electronic engine or instrument management equipment. Failure to do so could **destroy** any onboard computers. If in doubt, check with the vehicle's manufacturer.
3. If TBM is used in inverted position tow ball may make contact with rear tailgate when lowered, which could cause damage.

**General:**

1. Ensure all hardware items have been included refer to assembly diagram.
2. It is recommended that the instructions are read through and completely understood before making any attempt to fit this product.
3. Be wary of any changes to vehicle designs or other accessories that may conflict with the installation of this product.
4. Before drilling ensure that the area is clear of fuel, electrical & other components.
5. All holes drilled into the body panels shall have all burrs & swarf removed then coated with a suitable rust preventative paint.
6. The high tensile fasteners supplied with this product were used to achieve the specified rating. If replacement is required ensure that fasteners of the same rating & quality are used. Contact an authorised **Hayman Reese** dealer if further information is required.
7. Ensure that all hardware is fastened to torque list below check fasteners on regular basis.
8. Towbar load rating sticker provided with this product shall be conspicuously located on inside rear end of the driver's door. **(See diagram below).**
9. Hayman Reese recommends that you check your tow ball to ensure that it complies with the Australian standards **AS 4177.2**.
10. **PLEASE NOTE:** It is advised to remove your LUG or TBM when not actually towing so as to produce a clear view of the vehicles registration plate if obscured, and to also provide maximum available departure angle.
11. Pull Pin must be fit in down position.

**Tow bar Maintenance and Care.**

Hayman Reese recommends that bolt torque's, as listed below, are routinely and regularly inspected and checked for correct tension. Replace any worn or defective parts.

We recommended to remove Tow Ball Mounts (TBM's, tongues or lugs) when not being used for any considerable length of time.

So as to avoid injury, when not towing it is suggested that the tongue, Pull Pin and R-clip are removed then stored in a safe, clean and dry place, away from excessive moisture.

Hitch Pull Pins and spring "R" clips are regularly checked for proper installation. Replace any worn or defective parts.

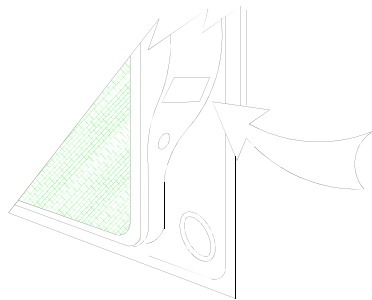

Place load rating sticker  
inside driver's door here

**RECOMMENDED ASSEMBLY TORQUE LISTING**

Diameter Grade 8.8 Bolt

M6	9.5 Nm
M8	21.7 Nm
M10	43.4 Nm
M12	77.3 Nm
M14	146 Nm
M16	189.8 Nm

**FOR TOWING PURPOSES ONLY**

For towing capacity details please refer to vehicle owner's manual or to the manufacturer. Overloading can void your warranties.

# HAYMAN REESE

PART No: 03118RW

MITSUBISHI TRITON D-CAB WITH STEP

## INSTALLATION INSTRUCTIONS

PLEASE ENSURE THAT ALL INSTRUCTIONS ARE UNDERSTOOD PRIOR TO FITMENT  
PLACE THESE INSTRUCTIONS IN THE VEHICLE'S GLOVEBOX AFTER INSTALLATION IS COMPLETED

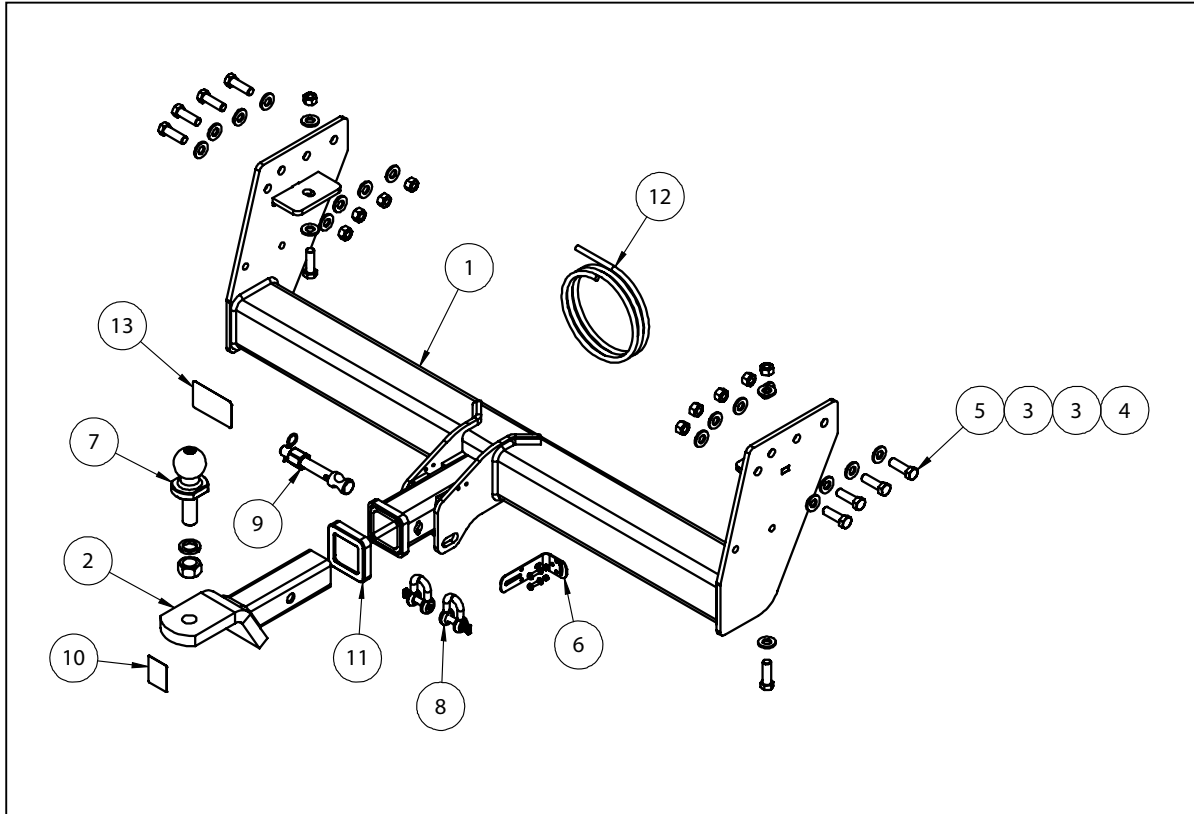

QTY.	DESCRIPTION	ITEM NO.
1	WELDED ASSY	1
1	TBM ASSY	2
10	SET SCREW M12x40 1.75P	3
10	HEX NUT M12 -1.75P	4
20	WASHER FLAT 1/2" x1 1/8"x1/8"	5
1	UNIVERSAL PLUG BRACKET KIT	6
1	HR TOWBALL	7
2	10mm "D" SHACKLE	8
1	ANTI-RATTLE PULL PIN ASSY GOLD	9
1	H R STICKER	10
1	HITCH BOX COLLAR COVER	11
1	WIRING LOOM	12
1	ACRYLIC CP LABEL	13

**HAYMAN REESE**  
**PART No: 03118RW**  
**MITSUBISHI TRITON D-CAB WITH STEP**

**INSTALLATION INSTRUCTIONS**

PLEASE ENSURE THAT ALL INSTRUCTIONS ARE UNDERSTOOD PRIOR TO FITMENT  
PLACE THESE INSTRUCTIONS IN THE VEHICLES'S GLOVEBOX AFTER INSTALLATION IS COMPLETED

1. Remove step from vehicle, making sure to disconnect reversing sensors if fitted.

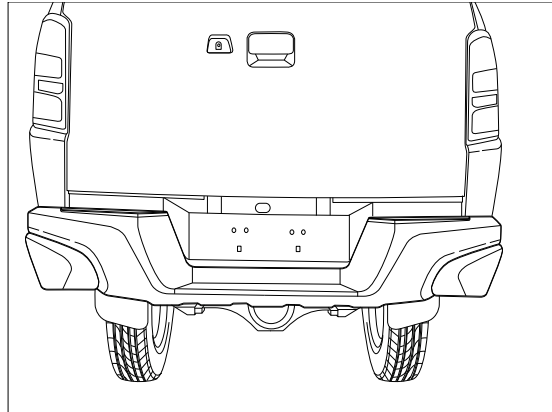

2. Remove step brackets from vehicle and discard.

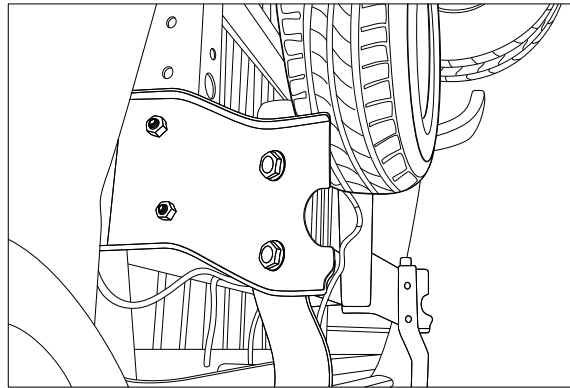

3. Offer Towbar to vehicle and secure with 5X fasteners on both LH & RH side to a torque of 125Nm.

Refit step to vehicle, by attaching to Towbar and secure with existing fasteners to a torque of 50Nm.

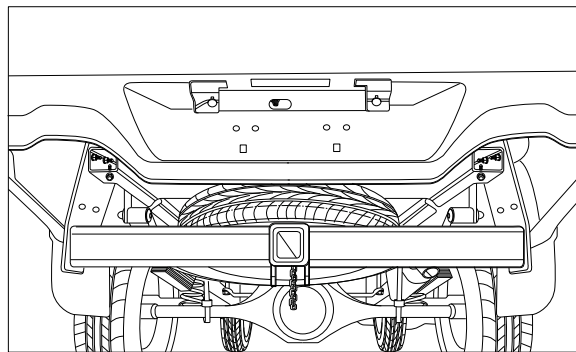

**HAYMAN REESE**  
**PART No: 100006-WL**  
**MITSUBISHI TRITON (all models) Single Cab, Dual Cab**

**INSTALLATION INSTRUCTIONS**

PLEASE ENSURE THAT INSTRUCTIONS ARE UNDERSTOOD PRIOR TO FITMENT

**Wiring Loom Installation Instructions**

**MITSUBISHI TRITON (all models)**  
**Single Cab and Dual Cab**

**Part No: 100006-WL**

**Tail Harness Length Required: 1800mm**

**Wiring Loom Installation Time: Approx. 30 minutes**

Issue Date 22-06-15

Page 1

Part No: 100006-WL

Hayman Reese (Cequent)  
PO Box 4050, Dandenong South VIC 3164  
Phone 1800 812 017 Email [info@haymanreese.com.au](mailto:info@haymanreese.com.au)

[www.haymanreese.com.au](http://www.haymanreese.com.au)



# HAYMAN REESE

## PART No: 100006-WL

### MITSUBISHI TRITON (all models) Single Cab, Dual Cab

# INSTALLATION INSTRUCTIONS

PLEASE ENSURE THAT INSTRUCTIONS ARE UNDERSTOOD PRIOR TO FITMENT

All instruction steps are applicable to current and previous models, single cab and dual cab.

1. Underneath the rear LHS quarter of the vehicle, disconnect the LHS tail light connector (1).
2. Connect the trailer patch connectors (P/No: 100006-WL) (2) in between the tail light connectors (1).

**Note:** Depending on vehicle variation, the tail light connectors on the LHS chassis may be located before or after the spare wheel area. Dual cab shown for fitment.

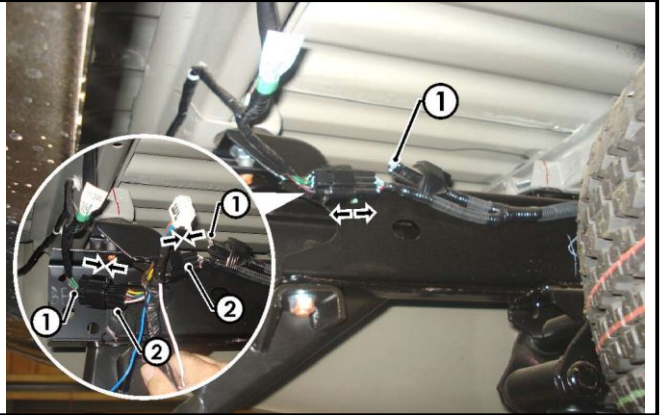

3. Connect the relays (1) to the trailer patch.
4. Insert green secondary lock so that the connectors cannot come out.
5. Secure the relays (1) and trailer patch ground ring terminal (2) onto the chassis rail using a tek screw (not supplied).

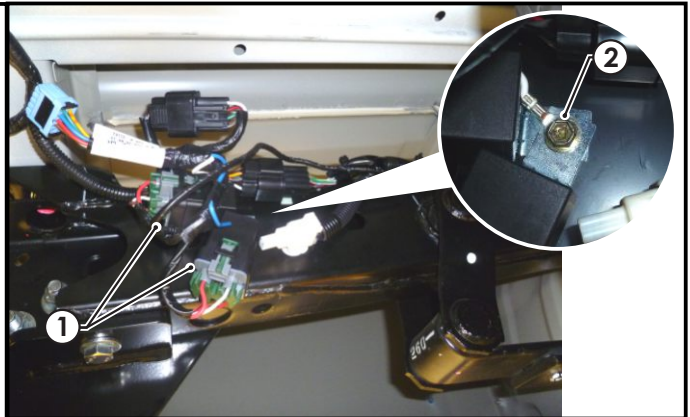

6. Connect the tail harness 8-way connector (1) to the trailer patch 8-way mating connector (2).
7. **Waterproof the trailer patch 8-way connector (1) and the tail harness 8-way male connector (2) using silicone or grease (3).**

**Note:** Underneath the vehicle, bundle up any excess tail harness length with a cable tie (not supplied).

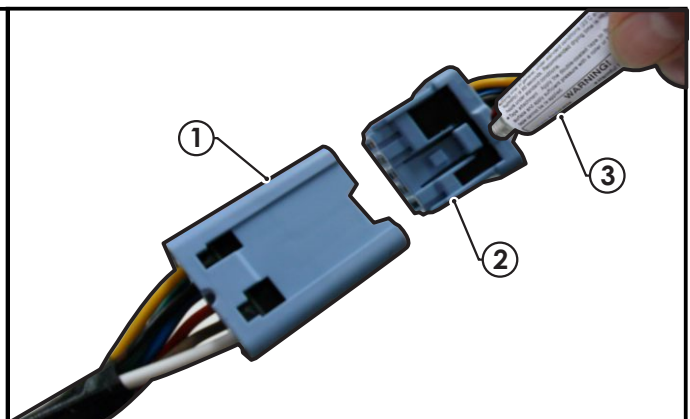

Issue Date 22-06-15

Page 2

Part No: 100006-WL

Hayman Reese (Cequent)  
PO Box 4050, Dandenong South VIC 3164  
Phone 1800 812 017 Email [info@haymanreese.com.au](mailto:info@haymanreese.com.au)

[www.haymanreese.com.au](http://www.haymanreese.com.au)



**HAYMAN REESE**  
**PART No: 100006-WL**  
**MITSUBISHI TRITON (all models) Single Cab, Dual Cab**  
**INSTALLATION INSTRUCTIONS**

PLEASE ENSURE THAT INSTRUCTIONS ARE UNDERSTOOD PRIOR TO FITMENT

8. Route the trailer patch battery ring terminal wire along the LHS chassis rail following the vehicle body harness, all the way to the engine bay battery area.
9. Secure harness with cable ties (not supplied) at every 200mm intervals. Ensure to keep away from any moving parts or sharp objects.



10. In the engine bay, retrieve the trailer patch ring terminal branch (1).

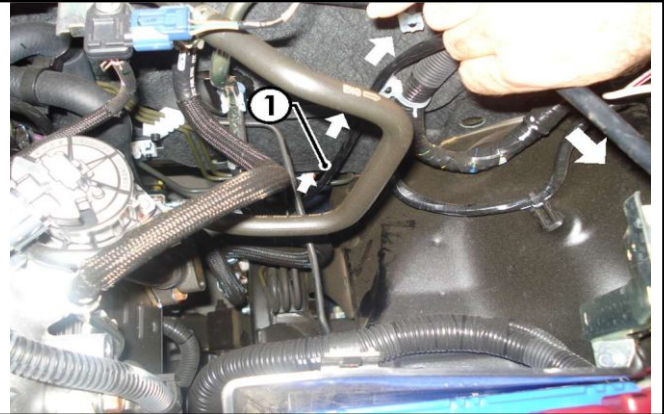

11. Secure the trailer patch ring terminal (1) onto the positive battery terminal (2).

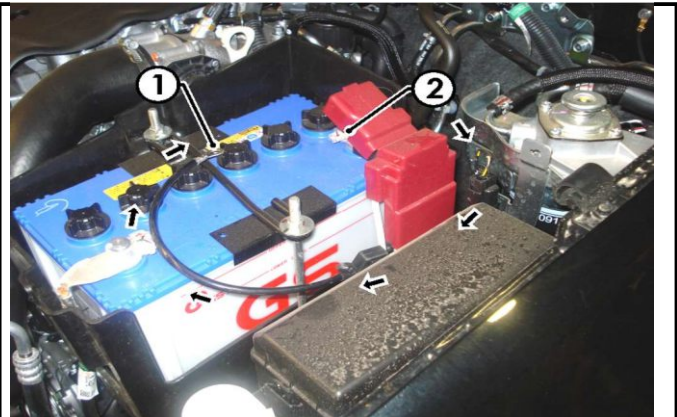

Issue Date 22-06-15

Page 3

Part No: 100006-WL

Hayman Reese (Cequent)  
PO Box 4050, Dandenong South VIC 3164  
Phone 1800 812 017 Email [info@haymanreese.com.au](mailto:info@haymanreese.com.au)

**HAYMAN REESE**  
**PART No: 100006-WL**  
**MITSUBISHI TRITON (all models) Single Cab, Dual Cab**  
**INSTALLATION INSTRUCTIONS**

PLEASE ENSURE THAT INSTRUCTIONS ARE UNDERSTOOD PRIOR TO FITMENT

- 12.** At the exterior rear of the vehicle, route the tail harness (1) across the towbar and mount the tail harness socket (2) to the towbar mounting plate using M4 fasteners (not supplied).

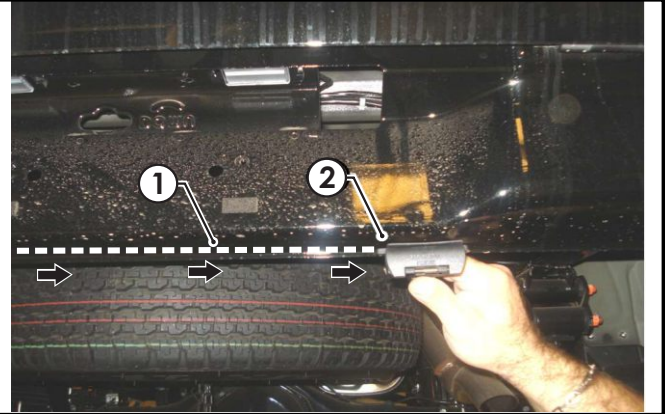

- 13.** Test the trailer patch function using a light board or multi-meter.
- 14.** Secure all harnesses using cables ties (not supplied).
- 15.** Re-fit all removed parts and secure all fasteners, ensuring there are no squeaks or rattles.
- 16.** Place instructions in glove box after fitment

Issue Date 22-06-15

Page 4

Part No: 100006-WL

Hayman Reese (Cequent)  
PO Box 4050, Dandenong South VIC 3164  
Phone 1800 812 017 Email [info@haymanreese.com.au](mailto:info@haymanreese.com.au)

[www.haymanreese.com.au](http://www.haymanreese.com.au)







# FITTING INSTRUCTIONS

## Smart Pin (55070BL)

• These fitting instructions are supplied to ensure understanding of how the SMART PIN should be fitted and used correctly.

• Once installed, we recommend **ALL** instructions are kept and placed in the vehicle glove box.

**NOTE: Routine maintenance and inspection of the towbar & SMART PIN is required. Regularly inspect for wear and check the tightness of the SMART PIN NUT. Follow instructions below to retighten the nut when necessary.**

**\*Do not tow with your vehicle if the R CLIP or the SMART PIN NUT is loose or missing. Replacement parts are available from your Hayman Reese Distributor.**

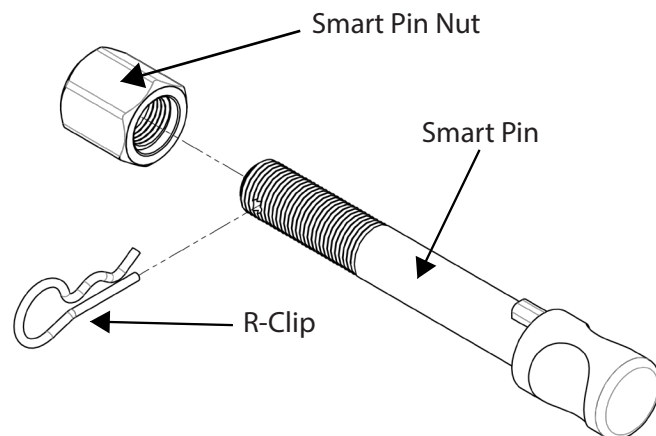
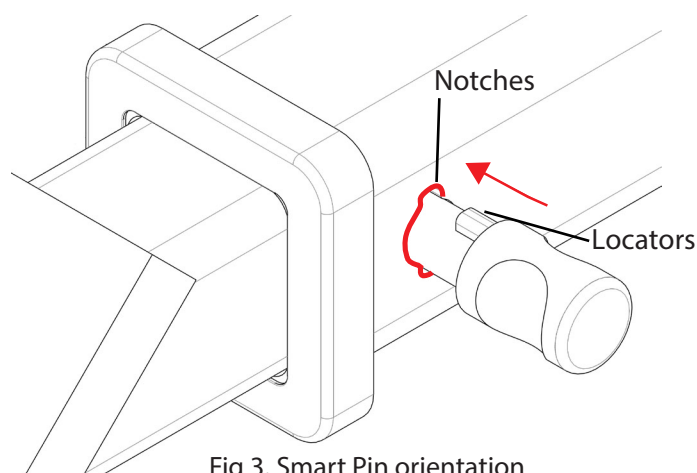
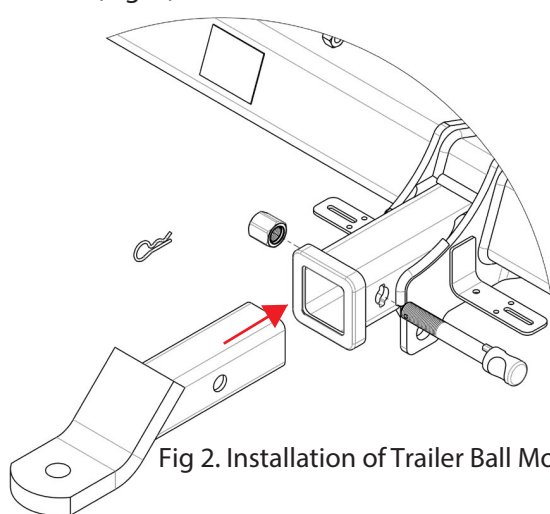

Fig 1. Smart Pin assembly

**STEP 1** Insert Trailer Ball Mount (TBM) into towbar HITCHBOX, aligning hole in TBM SHANK with hole in HITCHBOX (Fig. 2).



**STEP 2** Insert SMART PIN through hole in HITCHBOX and hole in TBM SHANK; ensure the LOCATORS are inserted into the NOTCHES in the HITCHBOX (Fig. 3).

**STEP 3** Screw SMART PIN NUT onto SMART PIN; tighten SMART PIN NUT until finger tight, ensuring TBM is restrained from movement.

**STEP 4** Tighten SMART PIN NUT by turning nut a further 1/8th of a turn in the clockwise direction using a 24mm spanner (Fig 4).

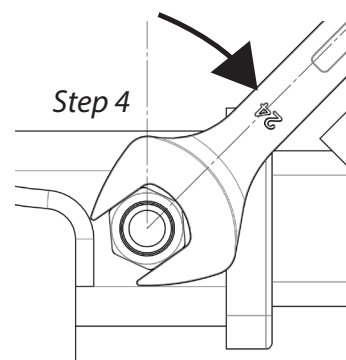

**STEP 5** Install SMART PIN R CLIP through the hole on the SMART PIN (Fig. 1).

