

HAYMAN REESE

PART No: 03240RW

HOLDEN COMMODORE ZB CL4

INSTALLATION INSTRUCTIONS

PLEASE ENSURE THAT INSTRUCTIONS ARE UNDERSTOOD PRIOR TO FITMENT
PLACE THESE INSTRUCTIONS IN THE VEHICLE'S GLOVEBOX AFTER INSTALLATION IS COMPLETED



Installation Time: Approx 105 Mins

Towbar Installation Instructions

Towbar capacity

HOLDEN COMMODORE ZB CL4

Part Number 03240RW

Max Towing Braked 2100 kg

Max Towing Unbraked 750 kg

Max Static Ball Load 90 kg

ECU: 04839

Tail Harness Part No:04936

RPA Disable: Near transmission lever

Electric brake input location: Near blue connector

Hayman Reese (Cequent)
PO Box 4050, Dandenong South VIC 3164
Phone 1800 812 017 Email info@haymanreese.com.au

www.haymanreese.com.au



HAYMAN REESE
PART No: 03240RW
HOLDEN COMMODORE ZB CL4
INSTALLATION INSTRUCTIONS

PLEASE ENSURE THAT INSTRUCTIONS ARE UNDERSTOOD PRIOR TO FITMENT
PLACE THESE INSTRUCTIONS IN THE VEHICLE'S GLOVEBOX AFTER INSTALLATION IS COMPLETED

Warning:

1. Do not, drill, cut, weld or otherwise modify the towbar.
2. If you are using electric welding on a motor vehicle, **always** check that the vehicle is not equipped with electronic engine or instrument management equipment. Failure to do so could **destroy** any on board computers. If in doubt, check with the vehicle's manufacturer.
3. If TBM is used in inverted position tow ball may make contact with rear tailgate when lowered, which could cause damage.

General:

1. Ensure all hardware items have been included refer to assembly diagram.
2. It is recommended that the instructions are read through and completely understood before making any attempt to fit this product.
3. Be wary of any changes to vehicle designs or other accessories that may conflict with the installation of this product.
4. Before drilling ensure that the area is clear of fuel, electrical & other components.
5. All holes drilled into the body panels shall have all burrs & swarf removed then coated with a suitable rust preventative paint.
6. The high tensile fasteners supplied with this product were used to achieve the specified rating. If replacement is required ensure that fasteners of the same rating & quality are used. Contact an authorised **Hayman Reese** dealer if further information is required.
7. Ensure that all hardware is fastened to torque list below check fasteners on regular basis.
8. Towbar load rating sticker provided with this product shall be conspicuously located on inside rear end of the driver's door. **(See diagram below).**
9. Hayman Reese recommends that you check your tow ball to ensure that it complies with the Australian standards **AS 4177.2**.
10. **PLEASE NOTE:** It is advised to remove your LUG or TBM when not actually towing so as to produce a clear view of the vehicles registration plate if obscured, and to also provide maximum available departure angle.

Tow bar Maintenance and Care.

Hayman Reese recommends that bolt torque's, as listed below, are routinely and regularly inspected and checked for correct tension. Replace any worn or defective parts.

We recommended to remove Tow Ball Mounts (TBM's, tongues or lugs) when not being used for any considerable length of time.

So as to avoid injury, when not towing it is suggested that the tongue, Pull Pin and R-clip are removed then stored in a safe, clean and dry place, away from excessive moisture.

Hitch Pull Pins and spring "R" clips are regularly checked for proper installation. Replace any worn or defective parts.

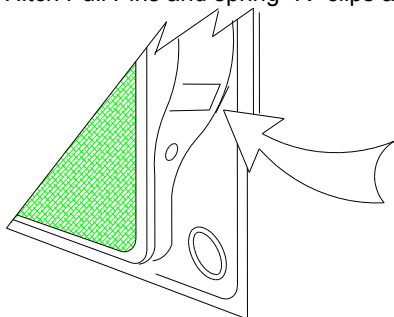

Place load rating sticker
inside driver's door here

**RECOMMENDED ASSEMBLY TORQUE
LISTING**

Diameter Grade 8.8 Bolt

M6	9.5 Nm
M8	21.7 Nm
M10	43.4 Nm
M12	77.3 Nm
M14	146 Nm
M16	189.8 Nm

FOR TOWING PURPOSES ONLY

For towing capacity details please refer to vehicle
owner's manual or to the manufacturer. Overloading can
void your warranties.

Hayman Reese (Cequent)
PO Box 4050, Dandenong South VIC 3164
Phone 1800 812 017 Email info@haymanreese.com.au

www.haymanreese.com.au



HAYMAN REESE

PART No: 03240RW

HOLDEN COMMODORE ZB CL4

INSTALLATION INSTRUCTIONS

PLEASE ENSURE THAT INSTRUCTIONS ARE UNDERSTOOD PRIOR TO FITMENT
PLACE THESE INSTRUCTIONS IN THE VEHICLE'S GLOVEBOX AFTER INSTALLATION IS COMPLETED

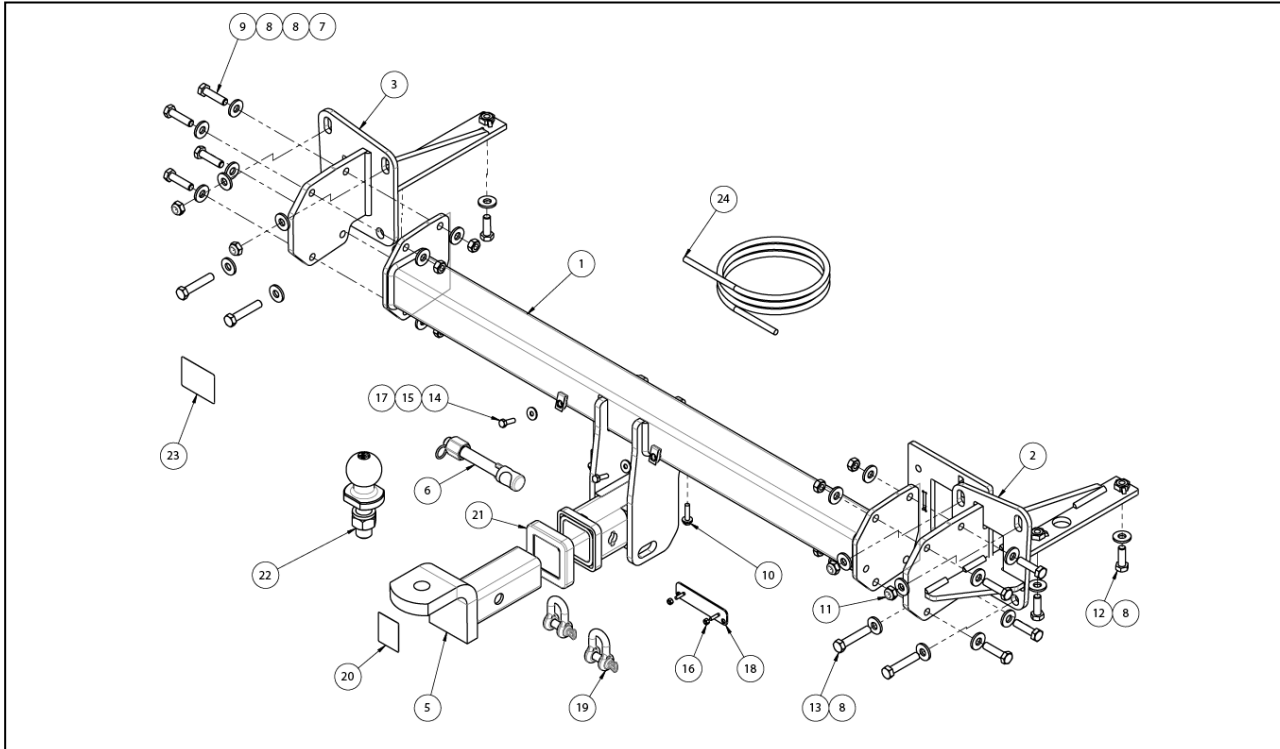

ITEM	DESCRIPTION	QTY
1	HOLDEN WAGON WELDED ASSY	1
2	SIDE ARM ASSY RH	1
3	SIDE ARM ASSY LH	1
4	BUMPER TAB	2
5	TRAILER BALL MOUNT	1
6	ANTI-RATTLE PULL PIN ASSY GOLD	1
7	NUT HEX HD M10 X 1.25P G8	8
8	WASHER PLAIN M10 X 25 X 3	28
9	BOLT HEX HD M10 X 40 X 1.25P G10.9	8
10	TEK SCREW 14-10 HEX HD 25mm	2
11	NUT M10 NYLOC	4
12	SETSCREW HXHD M10X30X1.5P G8.8	4

ITEM	DESCRIPTION	QTY
13	BOLT M10 - 1.5 x 55mm	4
14	SET SCREW M6 x 20 GR 8.8 Z/P	2
15	WASHER FLAT M6x18x1.5	2
16	NUT NYLON LOCK HEX HD M4X0.7P G8	2
17	CLIP NUT 6MM	2
18	VE PLUG BRACKET	1
19	"D" SHACKLE 10mm	2
20	H.R STICKER	1
21	HITCH BOX COLLAR COVER	1
22	HR TOWBALL	1
23	ACRYLIC COMPLIANCE LABEL	1
24	WIRING LOOM	1

Hayman Reese (Cequent)
PO Box 4050, Dandenong South VIC 3164
Phone 1800 812 017 Email info@haymanreese.com.au

www.haymanreese.com.au



HAYMAN REESE
PART No: 03240RW
HOLDEN COMMODORE ZB CL4
INSTALLATION INSTRUCTIONS

PLEASE ENSURE THAT INSTRUCTIONS ARE UNDERSTOOD PRIOR TO FITMENT
PLACE THESE INSTRUCTIONS IN THE VEHICLE'S GLOVEBOX AFTER INSTALLATION IS COMPLETED

1. In wheel arch, remove 4 x Torx screws.

Repeat for other side

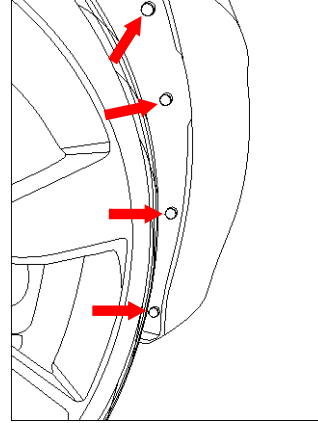

2. In the wheel arch peel back the trim and remove the exposed 1 x Screw.

Repeat for other side.

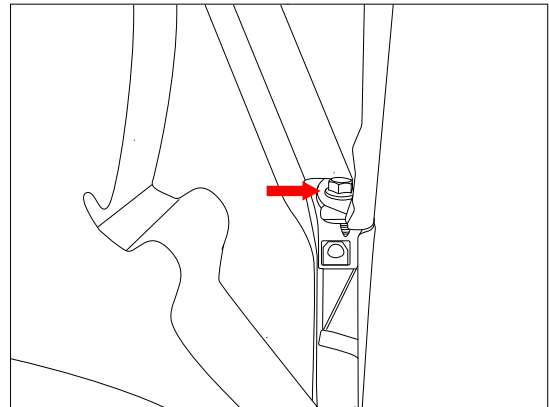

3. Under bumper, remove 2 x screws.

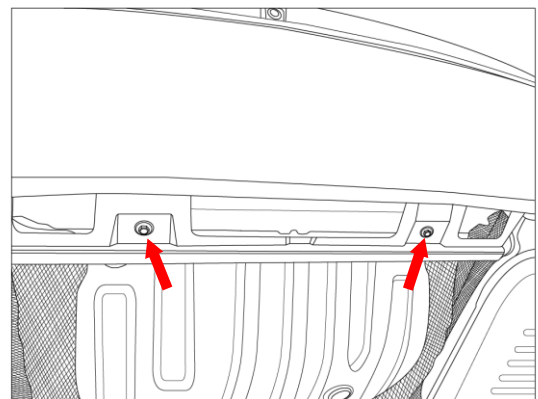

Hayman Reese (Cequent)
PO Box 4050, Dandenong South VIC 3164
Phone 1800 812 017 Email info@haymanreese.com.au

www.haymanreese.com.au



HAYMAN REESE

PART No: 03240RW

HOLDEN COMMODORE ZB CL4

INSTALLATION INSTRUCTIONS

PLEASE ENSURE THAT INSTRUCTIONS ARE UNDERSTOOD PRIOR TO FITMENT
PLACE THESE INSTRUCTIONS IN THE VEHICLE'S GLOVEBOX AFTER INSTALLATION IS COMPLETED

4. Remove the Number Plate and remove the exposed 2 x screws securing the bumper to the back panel.

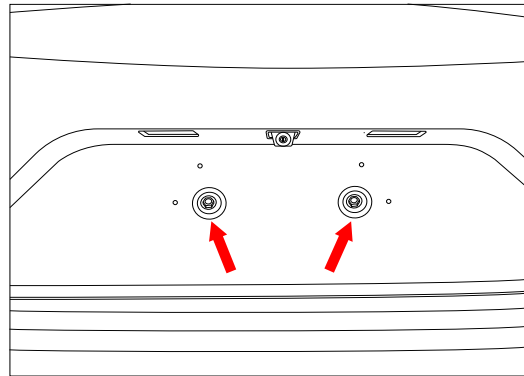

5. Peel away bumper from the sides and remove from vehicle. Ensure to disconnect the electrical harness (RH side).

Set bumper aside in a safe location.

6. Remove the 4 x Nuts on the top and 4 x Bolts on the bottom that secure the impact beam and the exhaust brackets.

Discard the impact beam along with the fasteners.

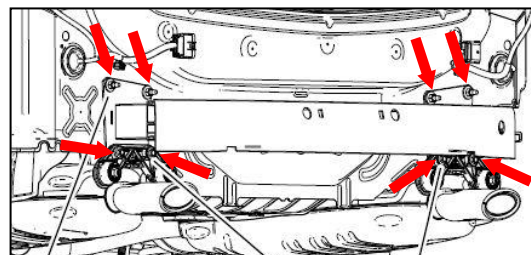

Hayman Reese (Cequent)
PO Box 4050, Dandenong South VIC 3164
Phone 1800 812 017 Email info@haymanreese.com.au

www.haymanreese.com.au



HAYMAN REESE
PART No: 03240RW
HOLDEN COMMODORE ZB CL4
INSTALLATION INSTRUCTIONS

PLEASE ENSURE THAT INSTRUCTIONS ARE UNDERSTOOD PRIOR TO FITMENT
PLACE THESE INSTRUCTIONS IN THE VEHICLE'S GLOVEBOX AFTER INSTALLATION IS COMPLETED

7. Lower the LH and RH mufflers.
8. Remove the LH and RH heat shields secured with screw on retainers to gain access to the chassis rails.

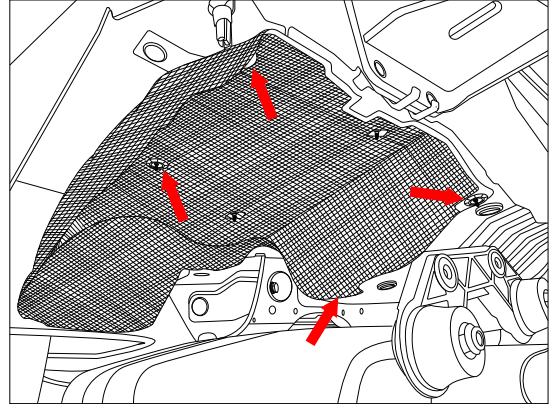

9. Insert the LH side arm assembly into the chassis rail and loosely secure with 2 x M10 bolts complete with 1 x washer per bolt.
 10. Loosely secure (only) the top side arm mountings with 2 x Nylocs complete with 1 x washer per nyloc.
- Repeat for other side.

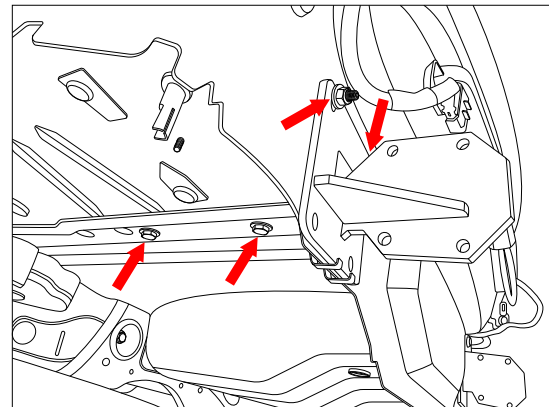

11. Lift cross tube to the side arms and loosely secure with 8 x M10 bolts complete with 2 x washers and 1 x nut per bolt.

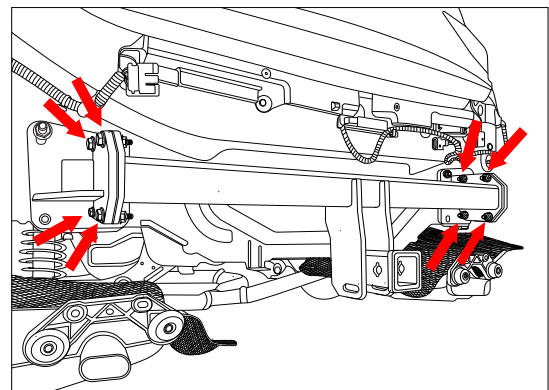

Hayman Reese (Cequent)
PO Box 4050, Dandenong South VIC 3164
Phone 1800 812 017 Email info@haymanreese.com.au

www.haymanreese.com.au



HAYMAN REESE

PART No: 03240RW

HOLDEN COMMODORE ZB CL4

INSTALLATION INSTRUCTIONS

PLEASE ENSURE THAT INSTRUCTIONS ARE UNDERSTOOD PRIOR TO FITMENT
PLACE THESE INSTRUCTIONS IN THE VEHICLE'S GLOVEBOX AFTER INSTALLATION IS COMPLETED

12. Tighten the 2 x M10 bottom fasteners.

Torque to 44Nm.

Repeat for other side.

13. Refit the 2 x heat shields removed in step 8.

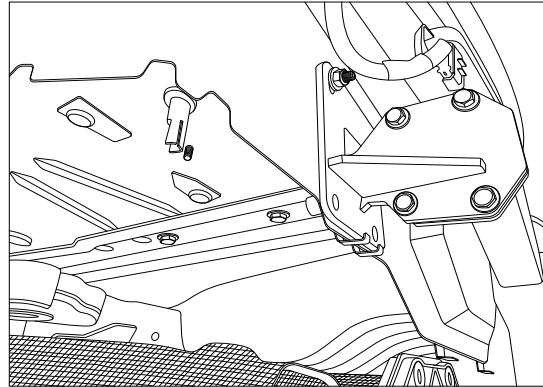

14. Raise the muffler and loosely secure the muffler brackets along with the bottom holes on the side arm brackets with 2 x M10 bolts complete with 1 x washer per bolt to the back panel.

Repeat for other side.

15. Tighten all the fasteners to the torques as specified:

Cross tube to side arms M10 (10.9) : 68Nm
M10 Nyloc : 44Nm
M10 Bolt to rear panel : 44Nm

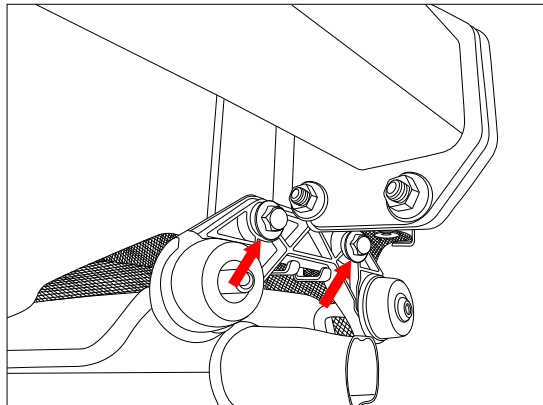

16. Working on the outside of the bumper panel, locate the centre, mark off and cut out 100mm wide and 160mm long as measured from the edge of the bumper. (The cut should stop at the first style line)

NOTE: The bumper has an inner skin panel that requires some material removal.

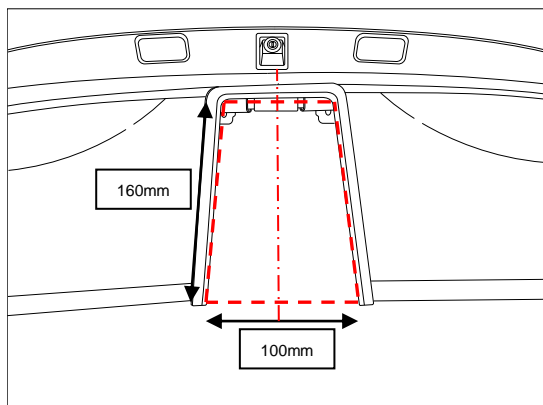

Hayman Reese (Cequent)
PO Box 4050, Dandenong South VIC 3164
Phone 1800 812 017 Email info@haymanreese.com.au

www.haymanreese.com.au



HAYMAN REESE
PART No: 03240RW
HOLDEN COMMODORE ZB CL4
INSTALLATION INSTRUCTIONS

PLEASE ENSURE THAT INSTRUCTIONS ARE UNDERSTOOD PRIOR TO FITMENT
PLACE THESE INSTRUCTIONS IN THE VEHICLE'S GLOVEBOX AFTER INSTALLATION IS COMPLETED

17. Fit the clip nuts to the 2 x bumper brackets and loosely secure to the inside of the bumper with 1x M6 bolt complete with 1 x washer.

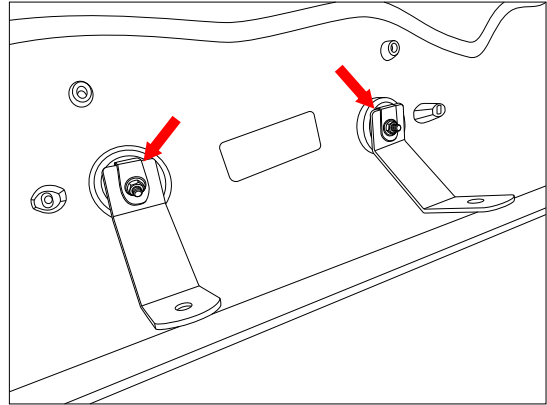

18. At an appropriate position on the bumper, mark out and drill 2x ø5mm holes 69mm apart on bumper skin to support plug bracket. Feed bracket threads through drilled holes prior to reinstalling bumper.

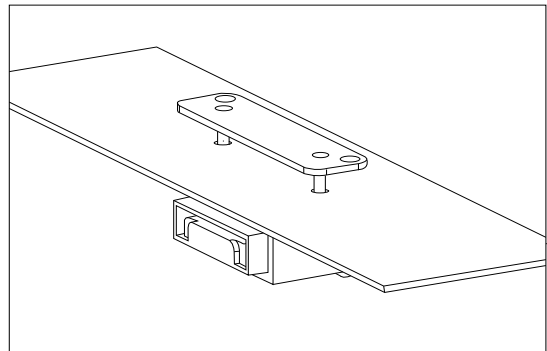

19. In the boot, remove the LHS cover (1).

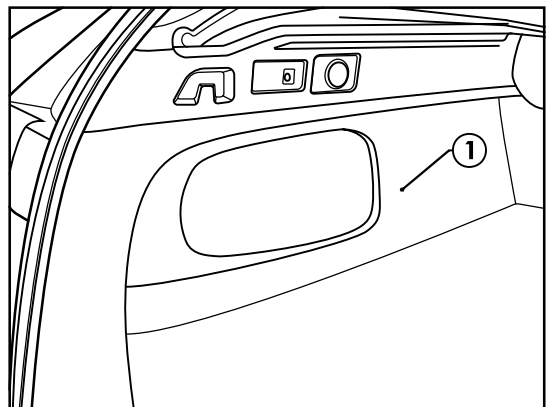

Hayman Reese (Cequent)
PO Box 4050, Dandenong South VIC 3164
Phone 1800 812 017 Email info@haymanreese.com.au

www.haymanreese.com.au



HAYMAN REESE

PART No: 03240RW

HOLDEN COMMODORE ZB CL4

INSTALLATION INSTRUCTIONS

PLEASE ENSURE THAT INSTRUCTIONS ARE UNDERSTOOD PRIOR TO FITMENT
PLACE THESE INSTRUCTIONS IN THE VEHICLE'S GLOVEBOX AFTER INSTALLATION IS COMPLETED

20. For V6 AWD variants: In the boot, disconnect the negative battery terminal (1).
21. In the LHS rear quarter panel in front of the battery towards the tail light, locate the vehicle grey prewire connector (2).
22. Connect the trailer patch (101996-WL) 13-way grey connector to the vehicle pre-wire connector (2).

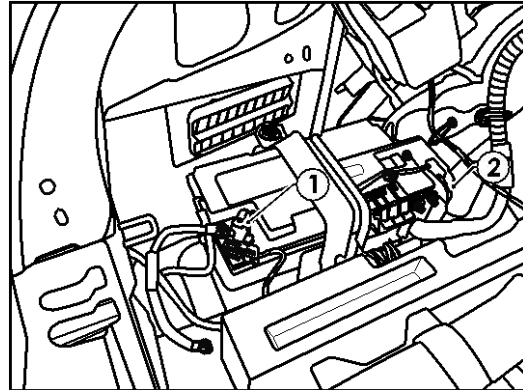

23. For I4 FWD variant: In the engine bay, disconnect the negative battery terminal.
24. In the LHS rear quarter panel towards the tail light, locate the vehicle grey pre-wire connector (1).
25. Connect the trailer patch (101996-WL) 13-way grey connector to the vehicle pre-wire connector (1).

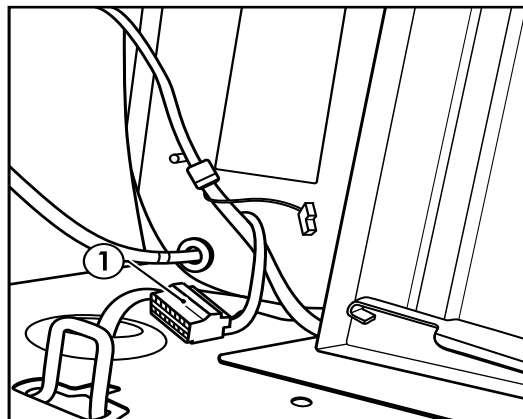

26. Using an alcohol wipe, clean a suitable area of the LHS inner sheet metal (1) and the underside of the ECU (04839) (2).
27. Connect the trailer patch 22-way connector (3) to the ECU.
28. Apply double sided tape (4) to the ECU (2) and secure it to the vehicle sheet metal.

Note: Mount the ECU, ensuring the connector is orientated downwards.

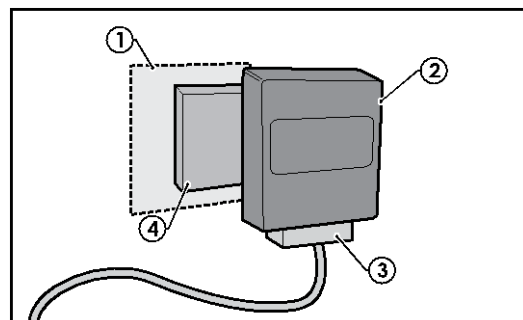

Hayman Reese (Cequent)
PO Box 4050, Dandenong South VIC 3164
Phone 1800 812 017 Email info@haymanreese.com.au

www.haymanreese.com.au



HAYMAN REESE
PART No: 03240RW
HOLDEN COMMODORE ZB CL4
INSTALLATION INSTRUCTIONS

PLEASE ENSURE THAT INSTRUCTIONS ARE UNDERSTOOD PRIOR TO FITMENT
PLACE THESE INSTRUCTIONS IN THE VEHICLE'S GLOVEBOX AFTER INSTALLATION IS COMPLETED

29. With the rear bumper removed, secure tail harness (Part No: 04936) to towbar.

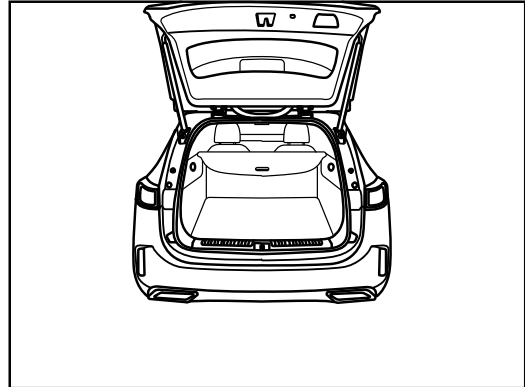

30. Connect the tail harness 8-way connector (1) to the trailer patch mating 8-way connector (2).
31. Cut-off, crimp and tail harness GREY and GREY/BLACK wires (3) to the trailer patch matching WHITE and GREY/BLACK wires (4).
32. Apply silicone grease (not supplied) (5) to waterproof connector.

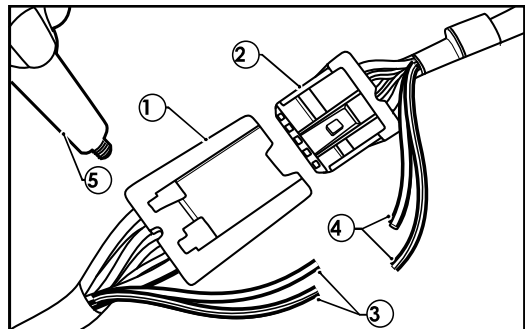

33. Under the vehicle LHS, locate the vehicle trailer harness pre-wire connector (1).
34. Remove the blanking plug sealing the connector and connect the black and purple connector on the patch harness to the vehicle pre-wire connector.

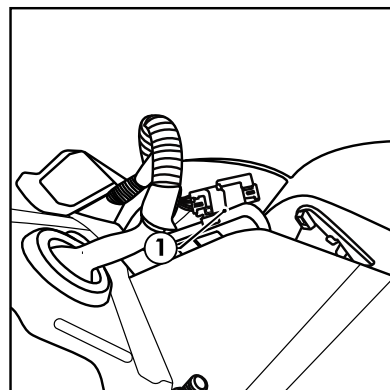

Hayman Reese (Cequent)
PO Box 4050, Dandenong South VIC 3164
Phone 1800 812 017 Email info@haymanreese.com.au

www.haymanreese.com.au



HAYMAN REESE

PART No: 03240RW

HOLDEN COMMODORE ZB CL4

INSTALLATION INSTRUCTIONS

PLEASE ENSURE THAT INSTRUCTIONS ARE UNDERSTOOD PRIOR TO FITMENT
PLACE THESE INSTRUCTIONS IN THE VEHICLE'S GLOVEBOX AFTER INSTALLATION IS COMPLETED

35. Test the trailer patch function using a light board or multi-meter.
36. Secure all harness using supplied Cable Ties.
37. Re-fit all removed parts and secure all fasteners, ensuring there are no squeaks or rattles.
38. The RPA function can be disabled via a switch (1) next to the transmission lever (2).

Note: Keep harness routing clear of all sharp edges, moving parts and places of extreme heat.

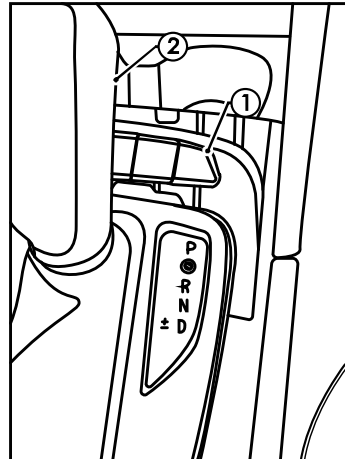

39. Refit the bumper and removed fasteners following steps 1-4 in reverse.
40. Secure the bumper brackets to the cross tube with 2 x tek screws.
41. Place the fitting instructions in the glove box after fitment.

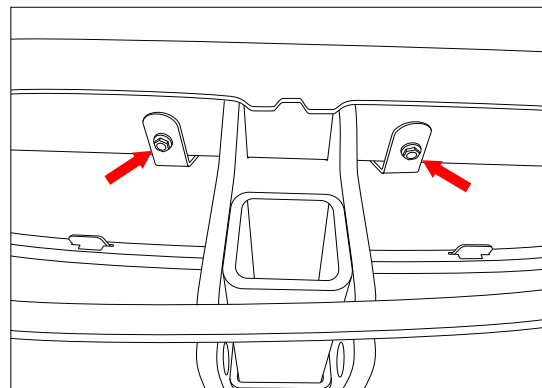

Hayman Reese (Cequent)
PO Box 4050, Dandenong South VIC 3164
Phone 1800 812 017 Email info@haymanreese.com.au

www.haymanreese.com.au





FITTING INSTRUCTIONS

Smart Pin (55070BL)

• These fitting instructions are supplied to ensure understanding of how the SMART PIN should be fitted and used correctly.

• Once installed, we recommend **ALL** instructions are kept and placed in the vehicle glove box.

NOTE: Routine maintenance and inspection of the towbar & SMART PIN is required. Regularly inspect for wear and check the tightness of the SMART PIN NUT. Follow instructions below to retighten the nut when necessary.

***Do not tow with your vehicle if the R CLIP or the SMART PIN NUT is loose or missing. Replacement parts are available from your Hayman Reese Distributor.**

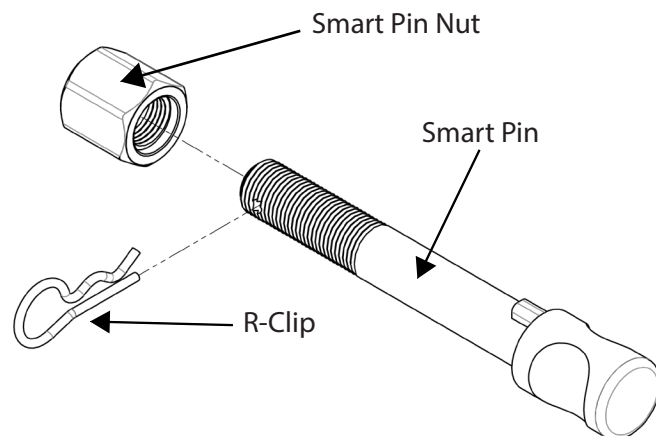
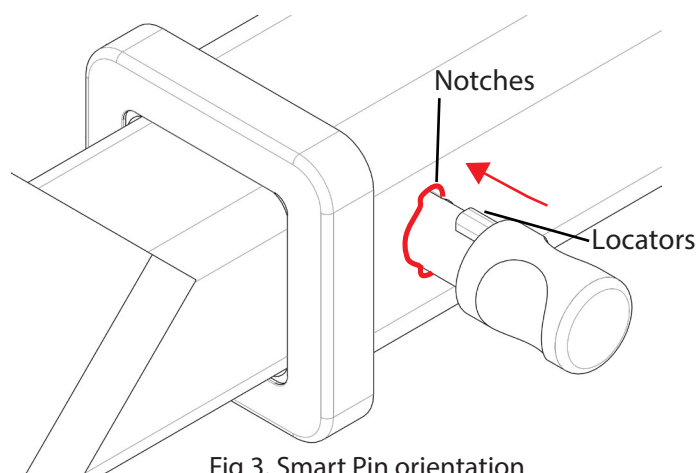
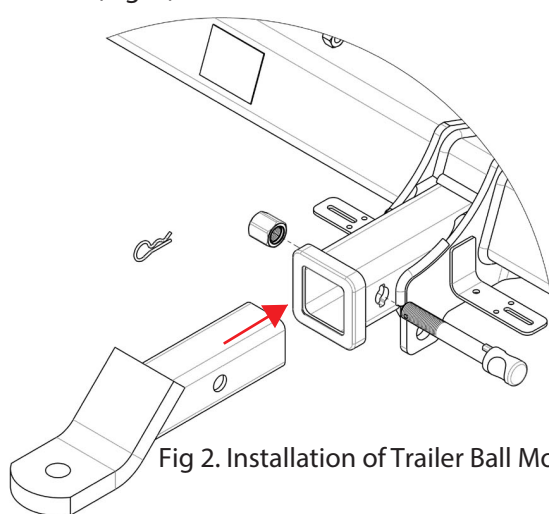

Fig 1. Smart Pin assembly

STEP 1 Insert Trailer Ball Mount (TBM) into towbar HITCHBOX, aligning hole in TBM SHANK with hole in HITCHBOX (Fig. 2).



STEP 2 Insert SMART PIN through hole in HITCHBOX and hole in TBM SHANK; ensure the LOCATORS are inserted into the NOTCHES in the HITCHBOX (Fig. 3).

STEP 3 Screw SMART PIN NUT onto SMART PIN; tighten SMART PIN NUT until finger tight, ensuring TBM is restrained from movement.

STEP 4 Tighten SMART PIN NUT by turning nut a further 1/8th of a turn in the clockwise direction using a 24mm spanner (Fig 4).

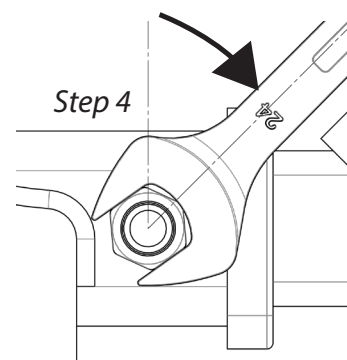

STEP 5 Install SMART PIN R CLIP through the hole on the SMART PIN (Fig. 1).

