



TOWBAR INSTALLATION INSTRUCTIONS

PART NUMBER 03361RW

JEEP GLADIATOR JT CL4



PRODUCT DETAILS:

Part Number:	03361RW	Maximum Towing Braked:	2721	kg
ECU Number:	04835	Maximum Towing Unbraked:	750	kg
Tail Harness Length Required:	1200 mm	Maximum Static Ball Load:	272	kg
TBM/Lug Part Number:	21325			
Wiring Part Number:	102526-WL			

FITTING DETAILS:

Towbar Installation Time:	40 Mins.	Hayman Reese SmartCODE Solution Required:	NO
Wiring Installation Time:	30 Mins.	RPA Disable/Other:	NO
Total Installation Time:	70 Mins.	Note:	
Bumper Cut Required:	No	<ul style="list-style-type: none">RPA Switch on Dash near hazard switch	



TOWBAR INSTALLATION INSTRUCTIONS

PART NUMBER 03361RW

JEEP GLADIATOR JT CL4

ENSURE THAT INSTRUCTIONS ARE UNDERSTOOD PRIOR TO FITMENT.

i BEFORE YOU START:

Hayman Reese recommends that instructions are read completely prior to fitment. Check all hardware items have been included refer to assembly diagram. Please ensure this towbar is only fitted to vehicle models as per Hayman Reese application guide (www.haymanreese.com.au).

Bumper Cuts



Vehicle and bumper variations can and do occur during vehicle manufacture after initial towbar design. Fitment of towbar to vehicle and accuracy of bumper cut must be assessed prior to any bumper modifications made. Incorrect bumper cuts are not covered under Hayman Reese warranty.

NOTE: Bumper cuts need to be approached with care, refer to notes below.

- Bumper centreline – where the centreline of the bumper needs to be determined, the installer must assess centre point by measurement of bumper width or determining two symmetrical reference points to give centreline.
- Bumper edge – To assist with accurate bumper cut measurement, reference to the start of the bumper edge is now being commonly used.
 - Measure from bottom edge along bumper and around corner to the 70 mm point (Figure 1).
 - Do not measure from visible bumper front of corner, upwards (Figure 2).

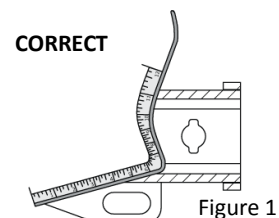

Figure 1

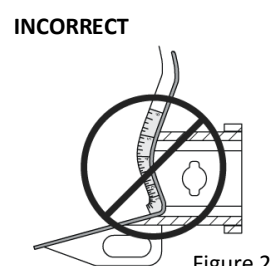

Figure 2

Drilling

- For any required drilling during installation, ensure that the area is clear of fuel, electrical & other components that may be damaged.
- All holes drilled into the body panels shall have all burrs & swarf removed then coated with a suitable rust preventative paint.

Bolts/Fasteners

- Ensure that all hardware is fastened to correct torque as specified in this fitting instruction.
- All fasteners supplied with this product are used to achieve a specified clamp loading. If replacement is required ensure that fasteners of the same grade and class are used.



NOTE: Achieving correct torque is critical to proper installation and responsibility of the installer. Towbar failures attributed to tension issues from over tightening or under tightening are not covered by Hayman Reese warranty.

Product Labels

- a. Towbar load rating sticker provided with this product shall be conspicuously located on inside rear end of the driver's door.
- b. Powertrain Control Module (PCM)/Body Control Module (BCM) upgrade warning label will be provided in towbar kit for vehicles as required. Affix warning label in door and owner's handbook.

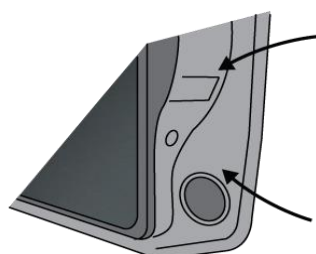

Place **Load Rating sticker** inside driver's door here

Place **Vehicle PCM/ BCM upgrade warning label** in door AND on front cover of owner's service handbook

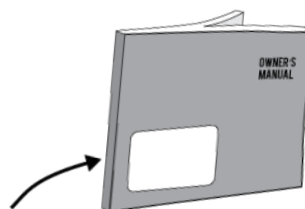

WARNING:

Do not, drill, cut, weld or otherwise modify the towbar.

FOR TOWING PURPOSES ONLY - This towbar is designed and tested by Hayman Reese to adhere to ADR 62/02 which provides only for the expected load demands of towing.



TOWBAR INSTALLATION INSTRUCTIONS

PART NUMBER 03361RW

JEEP GLADIATOR JT CL4

i TOWBAR ASSEMBLY DIAGRAM

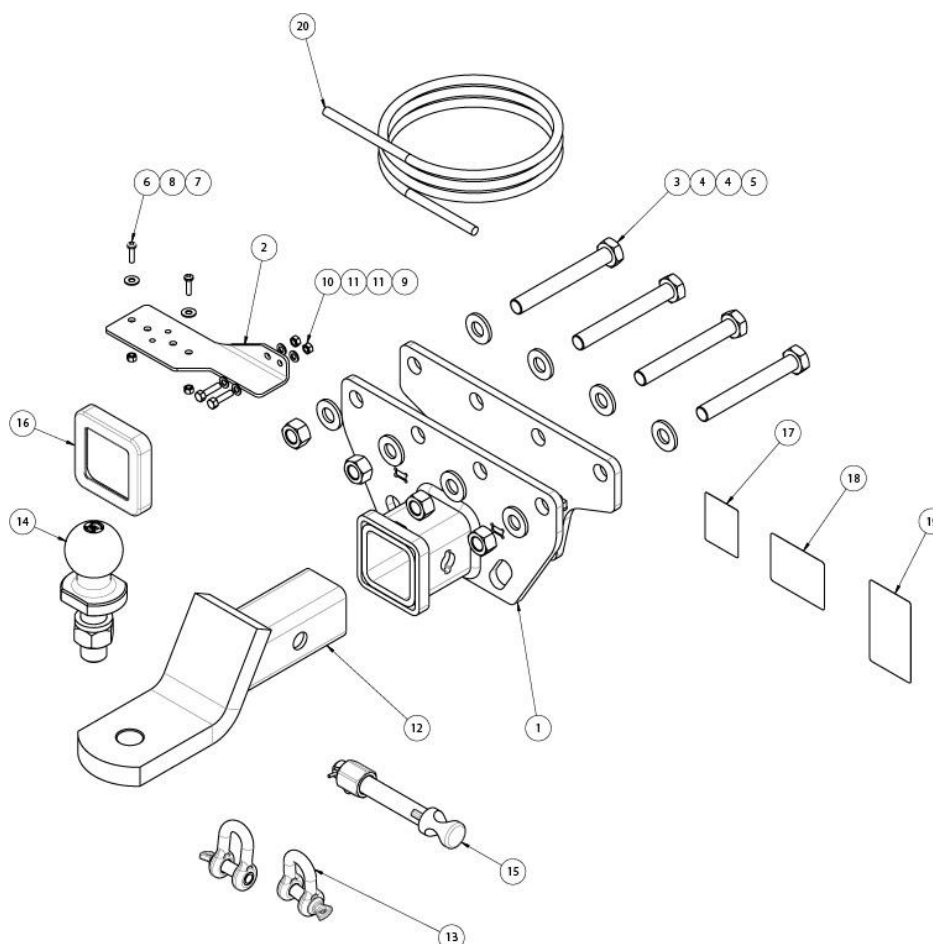

ITEM	DESCRIPTION	QTY
1	JEEP GLADIATOR JT CL4	1
2	PLUG MOUNT BRACKET	1
3	BOLT HEX HD M14x110x2.0P	4
4	WASHER PLAIN M14x28x3	8
5	NUT HEX M14x2.0P	4
6	SCREW PAN HD M4x16x0.7P	2
7	NUT NYLOC HEX HD M4x0.7P	2
8	WASHER PLAIN 3/16x1/2x20	2
9	SET SCREW HEX HD M5x20x0.8P	2
10	NUT HEX HD M5x0.8P	2

ITEM	DESCRIPTION	QTY
11	WASHER PLAIN M5	4
12	TRAILER BALL MOUNT	1
13	"D" SHACKLE 10mm	2
14	TOWBALL 50mm	1
15	SMART PIN GOLD	1
16	HITCH BOX COLLAR COVER	1
17	H.R STICKER	1
18	COMPLIANCE LABEL	1
19	LOAD RATING LABEL	1
20	WIRING LOOM	1



TOWBAR INSTALLATION INSTRUCTIONS

PART NUMBER 03361RW

JEEP GLADIATOR JT CL4

1. Refer to the user manual and lower the spare wheel.

The spare wheel tools are located under the right rear passenger seat.

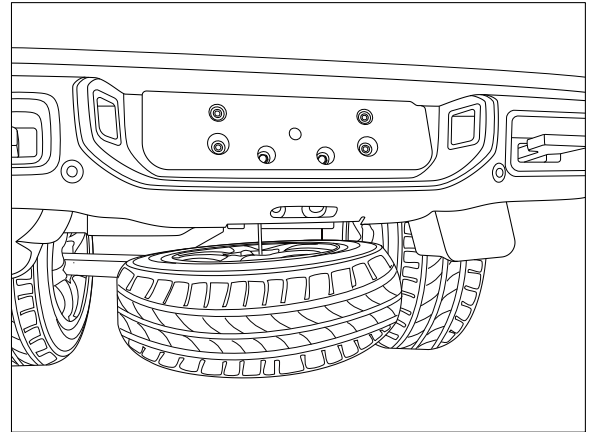

2. Position the towbar onto the vehicles cross beam and secure with 4 x M14 bolts complete with 2 x washers and 1 x nut per bolt.

For spanner clearance, it is advised to fit and torque the outer 2 fastener positions prior to the inner 2 fasteners.

Torque requirement M14 : 124Nm

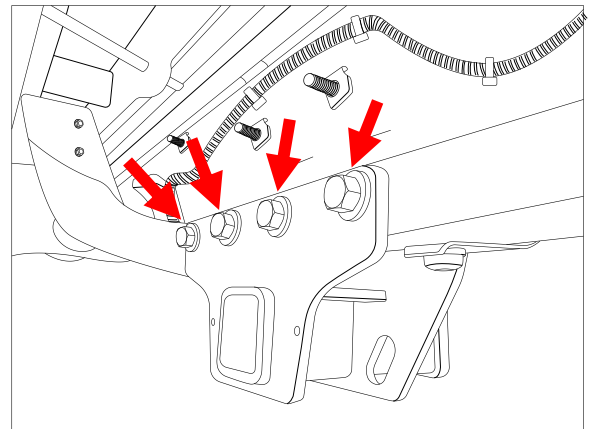

3. Position the plug mount bracket to the towbar back plate and secure with 2 x M5 screws complete with 2 x washers and 1 x nut per screw

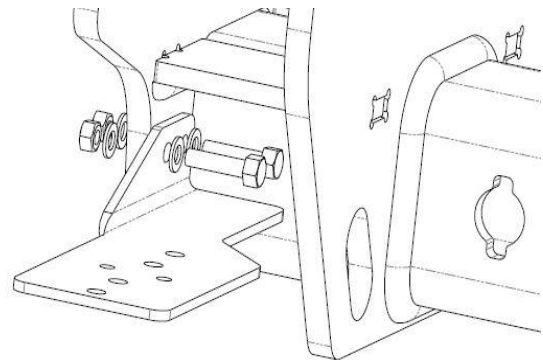



TOWBAR INSTALLATION INSTRUCTIONS

PART NUMBER 03361RW

JEEP GLADIATOR JT CL4

IMPORTANT

Due to possible vehicle variations, always confirm any noted vehicle colour wires with a multi-meter to ensure the correct function is identified before soldering or scotch locking. For vehicle wires denoted with two colours (example; RED/GREEN) the first colour will always be the main wire colour while the second colour is the thinner trace colour on the wire.

4. Under the vehicle RHS, locate the connectors (1) behind the wheel arch.
5. Patch in the Trailer Patch Harness (102526-WL) RHS branch between the vehicle connectors (1).

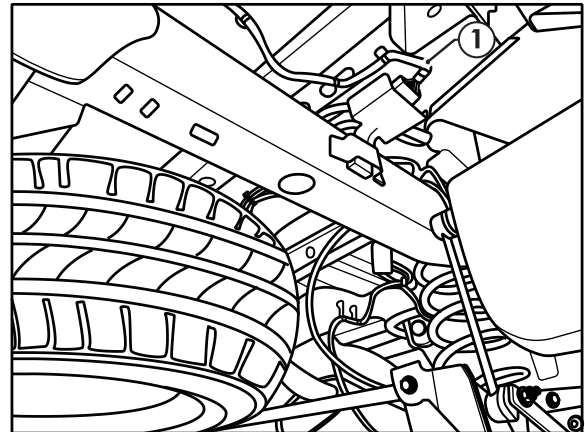

6. Route the trailer patch above the spare wheel towards the LHS
7. Connect the star ring terminal (1) to the vehicle earth point (2) above the rear of the spare tyre (3).

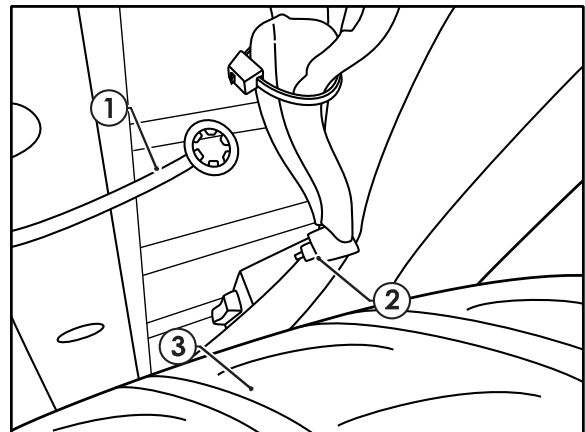



TOWBAR INSTALLATION INSTRUCTIONS

PART NUMBER 03361RW

JEEP GLADIATOR JT CL4

8. Under the vehicle LHS, locate the connectors behind the wheel arch.
9. Patch in the trailer patch harness LHS branch (1) between the vehicle connectors (2).
10. Connect the trailer patch ECU 24 way connector (3) to the ECU (04835) (4).
11. Using Cable Ties (5) secure the ECU to a suitable location above the chassis rail.

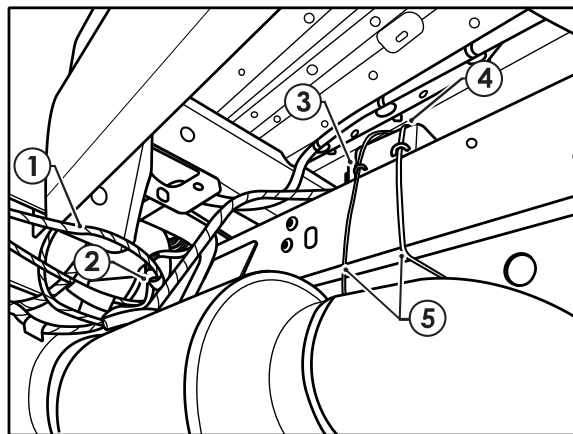

Note: Keep harness routing clear of all sharp edges, moving parts and places of extreme heat.

12. Connect the power harness (04835) (1) to the battery positive terminal (2) and route it down the firewall to the vehicle underbody.
13. Continue routing the power wire down the LHS towards the rear of the vehicle.
14. Connect the power harness 1 way connector to the mating connector on the trailer patch.

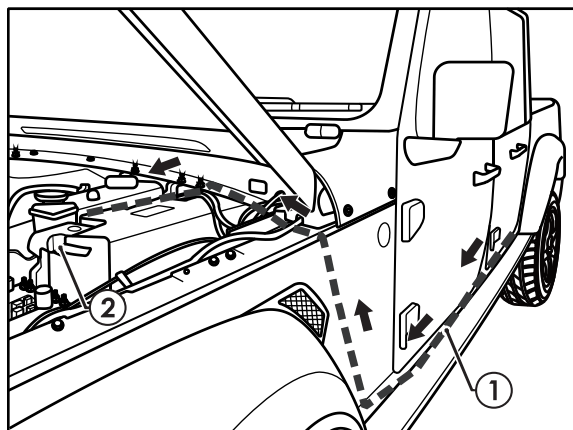

15. Connect the tail harness (tail length 1200mm) 8-way connector (1) to the trailer patch mating 8-way connector (2).
16. Secure all harness using supplied Cable Ties.

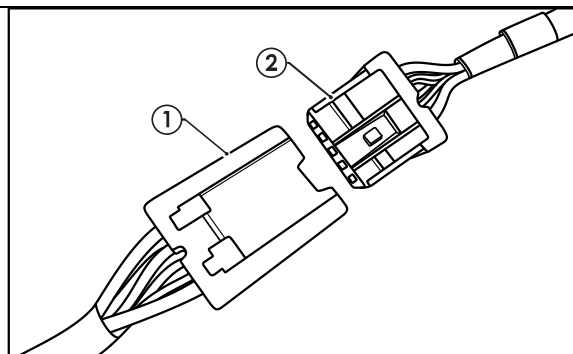



TOWBAR INSTALLATION INSTRUCTIONS

PART NUMBER 03361RW

JEEP GLADIATOR JT CL4

-
17. Test the trailer patch function using a light board or multi-meter.
 18. Re-fit all removed parts and secure all fasteners, ensuring there are no squeaks or rattles.
 19. Ensure to raise the spare wheel and replace the spare wheel tools under the right rear passenger seat if used.
 20. Place the fitting instructions in the glove box after fitment.
-



CUSTOMER INFORMATION

PLACE THESE INSTRUCTIONS IN THE
VEHICLE'S GLOVEBOX AFTER INSTALLATION

**THANK YOU FOR PURCHASING HAYMAN REESE.
WITH CORRECT MAINTENANCE AND CARE THIS PRODUCT WILL PROVIDE A
LIFETIME OF TROUBLE-FREE OPERATION.**

i TOWBAR MAINTENANCE AND CARE:

1. Hayman Reese recommend that the towbar LUG or TBM (tow ball Mount) Pull Pin and R-clip are removed and stored when not in use. Removal of LUG or TBM (tow ball mount) is advisable when not in use to assist with any of the following.
 - Ensure rear number plate is not obscured.
 - Allow maximum available departure angle and prevent any potential interference.
 - Prevent possible interference with vehicles reverse sensors or camera detecting a tow ball mount as an obstruction during reversing.
 - Removes towball mount as an obstruction for when moving around the rear of the vehicle.
2. Hayman Reese recommends routine inspection of your towbar to ensure trouble free towing.
 - Bolt security and tension should be regularly inspected and checked for correct tension. Replace any worn or defective parts with suitable grade & class fasteners. Inspection should be requested to coincide with vehicle major services.
3. It is the owner's responsibility to ensure towing and down ball weight capacities of the towing vehicle are not exceeded.
 - Towing and down ball weights allowable may differ according to model variations. Please refer to owner's manual or vehicle dealer to confirm exact rating for your vehicle model variant.
 - It is not uncommon for the vehicle tow rating to differ from the towbar rating. When this occurs, the lesser rating must be adhered to.
 - For vehicles fitted with enhanced vehicle functions that may be altered/changed when towing i.e Trailer sway mitigation, blind spot detection, adaptive cruise control etc. Please consult owner's manual to understand changes enabled when towing and after towing.

i WARRANTY INFORMATION:

Hayman Reese Towbars are covered by a Lifetime Warranty.

Our goods come with guarantees that cannot be excluded under the Australian Consumer Law. You are entitled to a replacement or refund for a major failure and for compensation for any other reasonably foreseeable loss or damage. You are also entitled to have the goods repaired or replaced if the goods fail to be of acceptable quality and the failure does not amount to a major failure.

For further details please visit www.haymanreese.com.au/warranty or contact customer service on 1800 812 017 or info@haymanreese.com.au.



CUSTOMER INFORMATION

PLACE THESE INSTRUCTIONS IN THE VEHICLE'S GLOVEBOX AFTER INSTALLATION

HAYMAN REESE SMART PIN

Your Hayman Reese towbar is equipped with Smart Pin technology to help reduce towbar tongue rattle in most driving conditions. Please ensure below instructions are understood and routine maintenance is carried out to ensure best towing experience.

i Regularly inspect for wear and check the tightness of the Smart Pin Nut. Follow instructions below to re-tighten the nut as necessary when movement and noise in the tow ball mount is noted.

- Before towing, ensure R-Clip is properly installed and Smart pin nut is installed and tensioned. Replacement parts are available from your Hayman Reese Distributor.

TOWBALL MOUNT REMOVAL/INSTALLATION

STEP 1

Insert Trailer Ball Mount (TBM) (a) into towbar hitchbox (b), aligning hole in TBM shank (c) with hole in hitchbox (d) (Fig. 1)

STEP 2

Insert Smart Pin (e) through hole in hitchbox and hole in TBM shank (g); ensure the locators are inserted into the notches in the hitchbox (Fig. 2)

STEP 3

Screw Smart Pin Nut (f) onto Smart Pin (g); tighten Smart Pin Nut until finger tight, ensuring TBM is restrained from up and down movement.

STEP 4

Tighten Smart Pin Nut by turning nut a further 1/8th of a turn in the clockwise direction using a 24mm spanner (Fig. 4).

STEP 5

Install Smart Pin R-Clip through the hole that provides best clearance or easiest access. (Fig. 5)

STEP 6

Install towball onto TBM and tighten to **350 Nm** using a calibrated torque wrench (Fig. 6).

