



TOWBAR INSTALLATION INSTRUCTIONS

PART NUMBER 03412W

MAZDA CX-3



PRODUCT DETAILS:

Part Number:	03412W	Maximum Towing Braked:	1200	kg
ECU Number:	04836	Maximum Towing Unbraked:	640	kg
Tail Harness Length Required:	1800 mm	Maximum Static Ball Load:	120	kg
TBM/Lug Part Number:	07756			
Wiring Part Number:	101292-WL			

FITTING DETAILS:

Towbar Installation Time:	90 Mins.	Hayman Reese SmartCODE Solution Required:	NO
Wiring Installation Time:	30 Mins.	RPA Disable/Other:	NO
Total Installation Time:	120 Mins.		
Bumper Cut Required:	No		



TOWBAR INSTALLATION INSTRUCTIONS

PART NUMBER 03412W

MAZDA CX-3

ENSURE THAT INSTRUCTIONS ARE UNDERSTOOD PRIOR TO FITMENT.

i BEFORE YOU START:

Hayman Reese recommends that instructions are read completely prior to fitment. Check all hardware items have been included refer to assembly diagram. Please ensure this towbar is only fitted to vehicle models as per Hayman Reese application guide (www.haymanreese.com.au).

Bumper Cuts



Vehicle and bumper variations can and do occur during vehicle manufacture after initial towbar design. Fitment of towbar to vehicle and accuracy of bumper cut must be assessed prior to any bumper modifications made. Incorrect bumper cuts are not covered under Hayman Reese warranty.

NOTE: Bumper cuts need to be approached with care, refer to notes below.

- Bumper centreline – where the centreline of the bumper needs to be determined, the installer must assess centre point by measurement of bumper width or determining two symmetrical reference points to give centreline.
- Bumper edge – To assist with accurate bumper cut measurement, reference to the start of the bumper edge is now being commonly used.
 - Measure from bottom edge along bumper and around corner to the 70 mm point (Figure 1).
 - Do not measure from visible bumper front of corner, upwards (Figure 2).

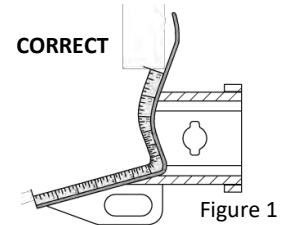

Figure 1

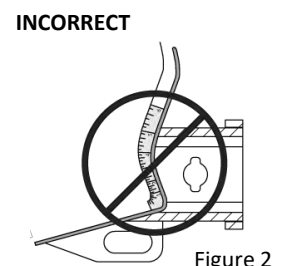

Figure 2

Drilling

- For any required drilling during installation, ensure that the area is clear of fuel, electrical & other components that may be damaged.
- All holes drilled into the body panels shall have all burrs & swarf removed then coated with a suitable rust preventative paint.

Bolts/Fasteners

- Ensure that all hardware is fastened to correct torque as specified in this fitting instruction.
- All fasteners supplied with this product are used to achieve a specified clamp loading. If replacement is required ensure that fasteners of the same grade and class are used.



NOTE: Achieving correct torque is critical to proper installation and responsibility of the installer. Towbar failures attributed to tension issues from over tightening or under tightening are not covered by Hayman Reese warranty.

Product Labels

- a. Towbar load rating sticker provided with this product shall be conspicuously located on inside rear end of the driver's door.
- b. Powertrain Control Module (PCM)/Body Control Module (BCM) upgrade warning label will be provided in towbar kit for vehicles as required. Affix warning label in door and owner's handbook.

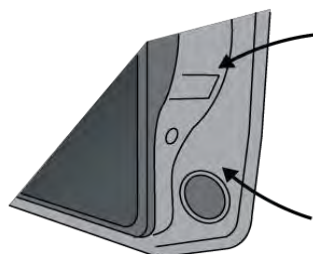

Place **Load Rating sticker** inside driver's door here

Place **Vehicle PCM/ BCM upgrade warning label** in door AND on front cover of owner's service handbook

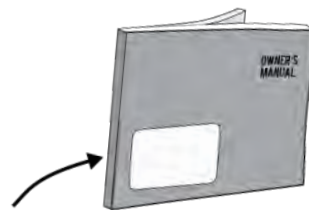

WARNING:

Do not, drill, cut, weld or otherwise modify the towbar.

FOR TOWING PURPOSES ONLY - This towbar is designed and tested by Hayman Reese to adhere to ADR 62/02 which provides only for the expected load demands of towing.



TOWBAR INSTALLATION INSTRUCTIONS

PART NUMBER 03412W

MAZDA CX-3

i TOWBAR ASSEMBLY DIAGRAM

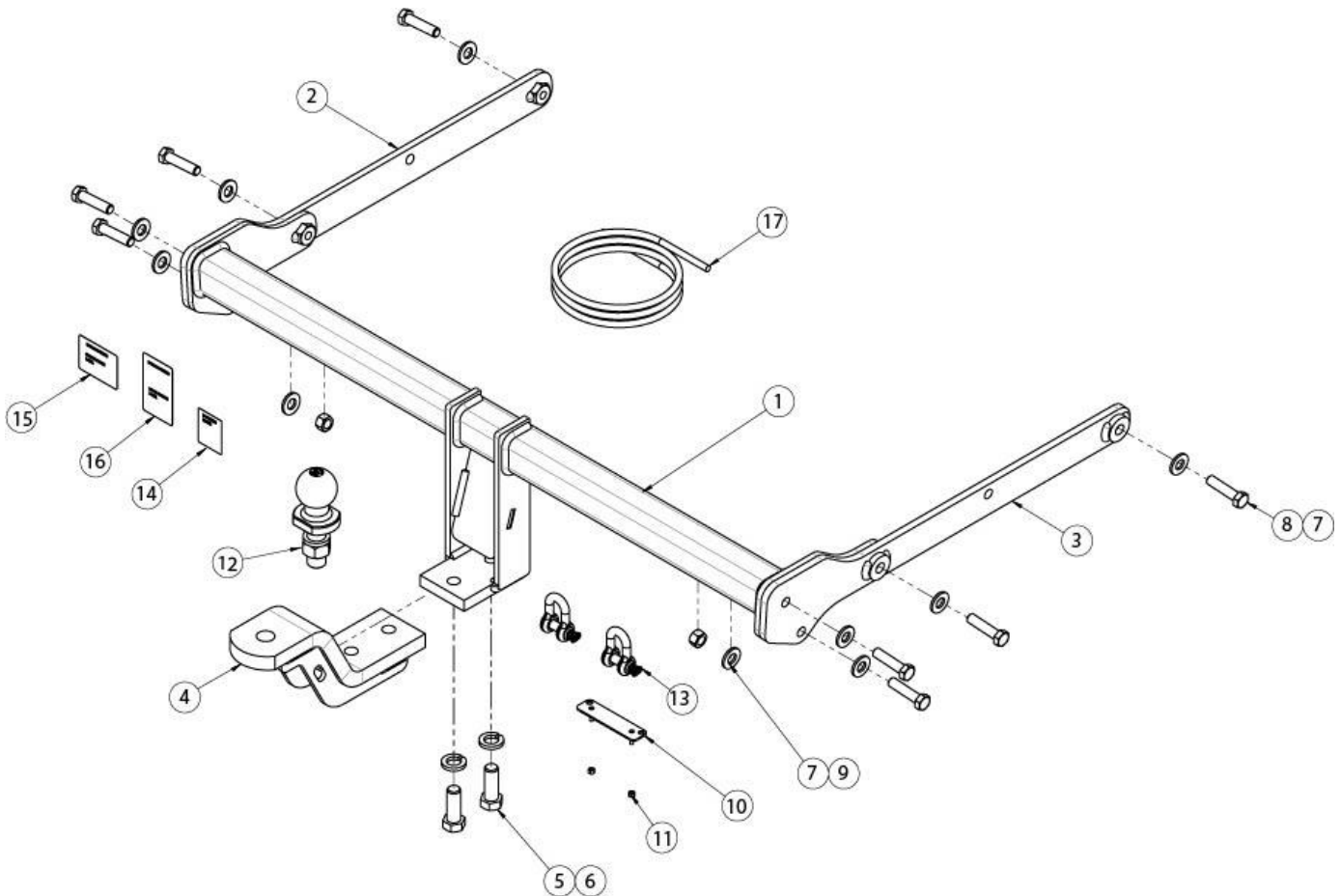

ITEM	DESCRIPTION	QTY
1	WELDED ASSEMBLY	1
2	LH SIDEARM	1
3	RH SIDEARM	1
4	LUG ASSEMBLY	1
5	BOLT HEX HD M16x45x2.0P	2
6	SPRING WASHER M16x5x3.5	2
7	WASHER PLAIN M14x28x3	10
8	BOLT HEX HD M12x50x1.75P	8
9	NUT HEX HD M12x1.75P	2

ITEM	DESCRIPTION	QTY
10	PLUG BRACKET	1
11	NUT NYLOC HEX HD M4x0.7P	2
12	TOWBALL 50mm	1
13	"D" SHACKLE 10mm	2
14	HAYMAN REESE LOGO STICKER	1
15	COMPLIANCE LABEL	1
16	LOAD RATING LABEL	1
17	WIRING LOOM	1



TOWBAR INSTALLATION INSTRUCTIONS

PART NUMBER 03412W

MAZDA CX-3

1. Release tailgate to expose boot cabin.

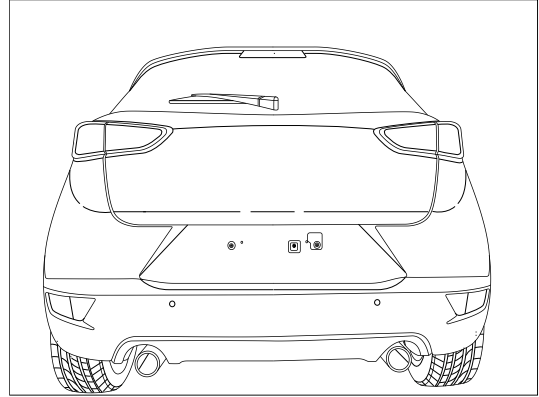

2. Remove 4 x Screws on both Passenger and Drivers side. Where 2 x Screws secure the tail light and a further 2 x Screws secure the bumper to the vehicle.

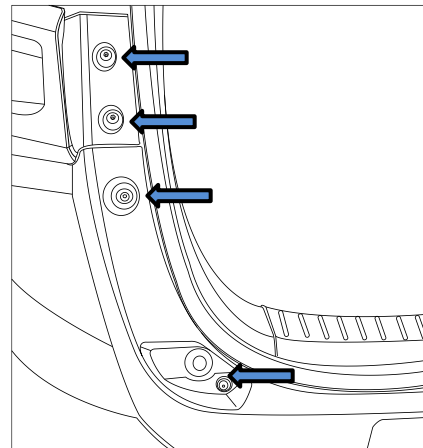

3. Carefully remove tail light and disconnect wiring loom. Repeat for Passenger and Driver side.

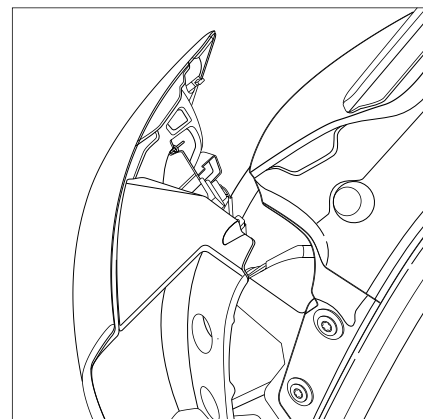



TOWBAR INSTALLATION INSTRUCTIONS

PART NUMBER 03412W

MAZDA CX-3

4. On the underside of the vehicle remove 2 x Screws where the bumper joins with the guard liner. Repeat for Passenger and Driver side.

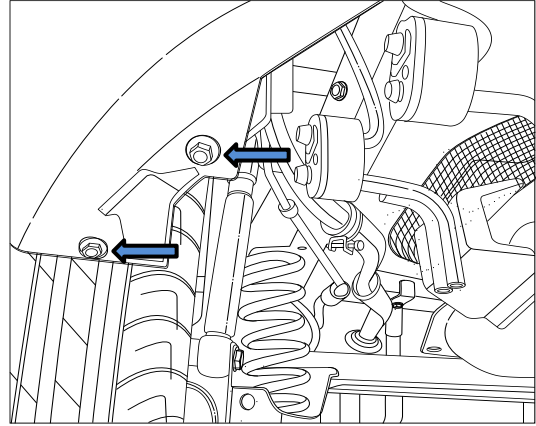

5. Remove 4 x trim clips on the underside of the bumper. Detach the plastic centre garnish from the bumper.

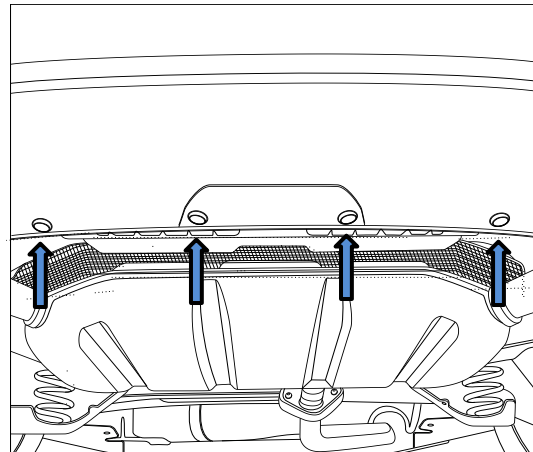

6. Remove 2 x Torx screws on the centre of the bumper where the licence plate holder is located.

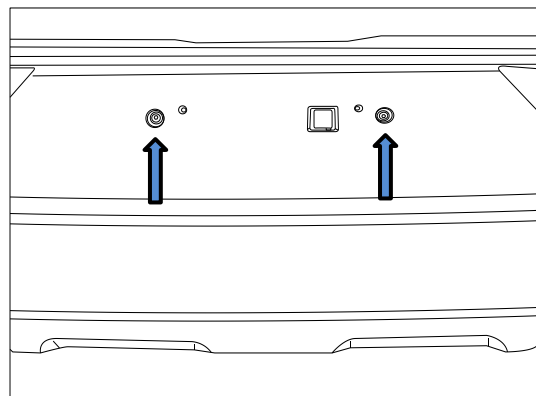



TOWBAR INSTALLATION INSTRUCTIONS

PART NUMBER 03412W

MAZDA CX-3

-
7. On the inside of the guard liner remove 6 x Trim Clips and 2 x Screws. Repeat for Passenger and Driver side.

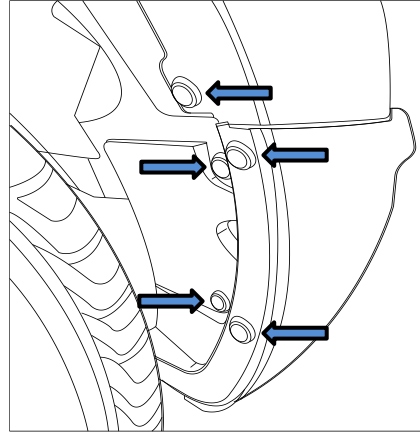

-
8. On the underside of the guard moulding remove the male trim clip located above of the centre of the wheel. Repeat for Passenger and Driver side.

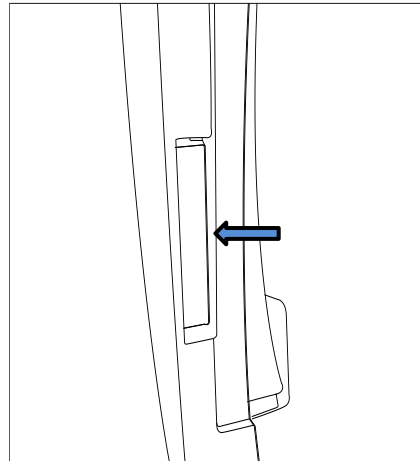

-
9. On the underside of the guard moulding remove the second male trim clip located rear of the centre of the wheel. Repeat for Passenger and Driver side.

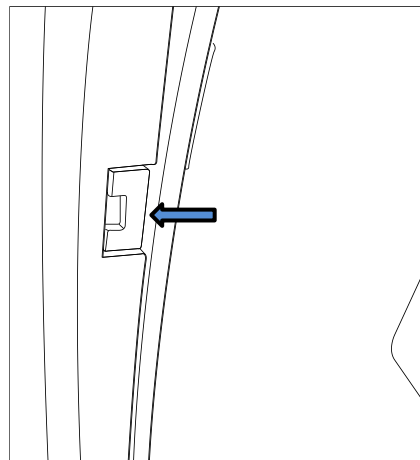



TOWBAR INSTALLATION INSTRUCTIONS

PART NUMBER 03412W

MAZDA CX-3

10. Carefully remove the outer guard moulding. Then remove 1 x trim Clip and 1 x Set Screw securing the bumper to the reinforcement. Repeat for Driver and Passenger side.

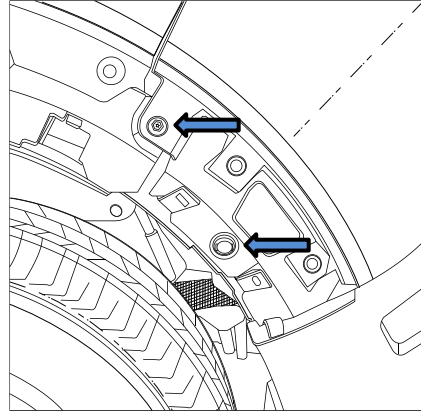

11. Carefully remove the bumper by first peeling away at the sides. Then lift the bumper up to clear the keyway-locking tab to release the bumper. Carefully disconnect any factory fitted reverse parking sensors.

Note: It may be easier to remove the bumper by partially detaching the boot seal.

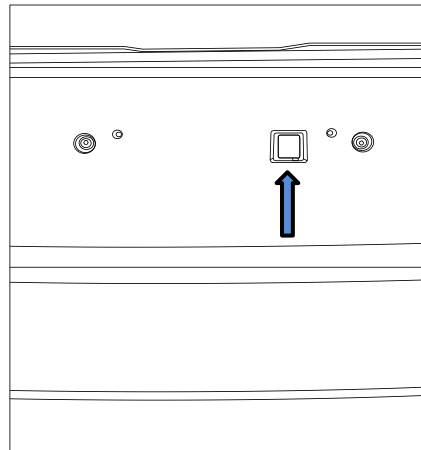

12. Remove 8 x Hex Flange nuts to detach the factory impact beam and discard.

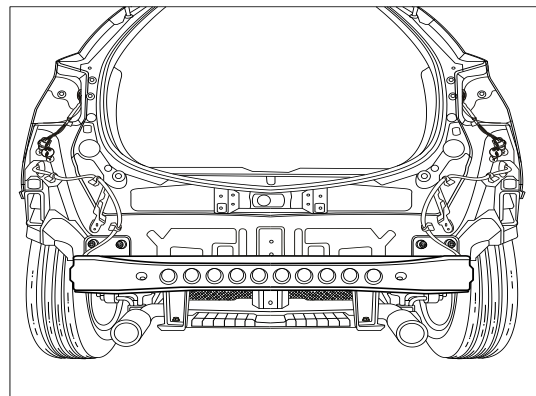



TOWBAR INSTALLATION INSTRUCTIONS

PART NUMBER 03412W

MAZDA CX-3

13. Remove and discard the horizontal plastic protector secured with 2 x Trim clips.

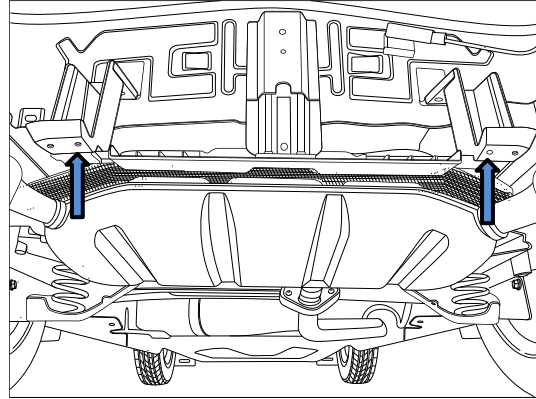

14. Slide Sidearm into the chassis rail.

Repeat for the other side.

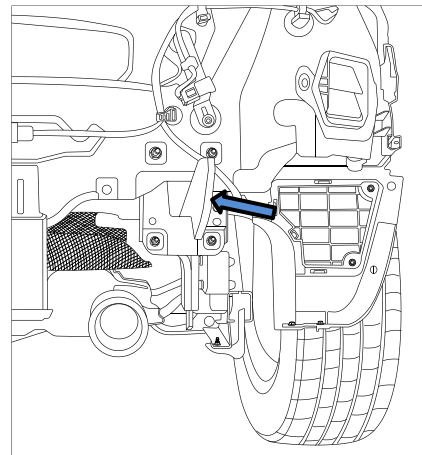

15. Peel off the tape covering the two holes in the chassis rail. Aligning with the holes in the side arm.

Loosely secure side arm using 1 x M12 x 50 x 1.75P Bolts per side.

Repeat for the other side.

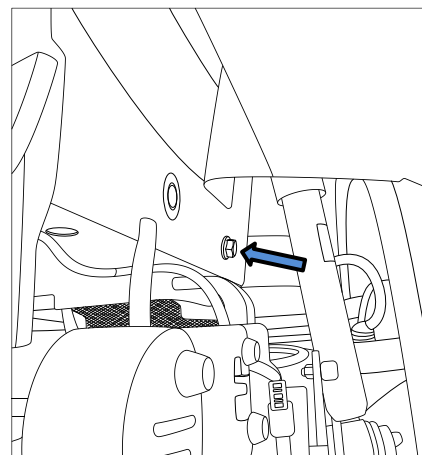



TOWBAR INSTALLATION INSTRUCTIONS

PART NUMBER 03412W

MAZDA CX-3

-
16. Fit the towbar to the side arms and loosely secure using 3 x M12 x 50 x 1.75P Bolts, 4 x M12 Washers and 1 x M12 x 1.75P Nut Per Side

Fit the Lug Assy using 2 x M16 x 45 x 2.0P

Torque Fasteners Specifications listed below:

M12 x 50 x 1.75P Bolt: 77Nm

M16 x 45 2.0P Bolt: 197Nm

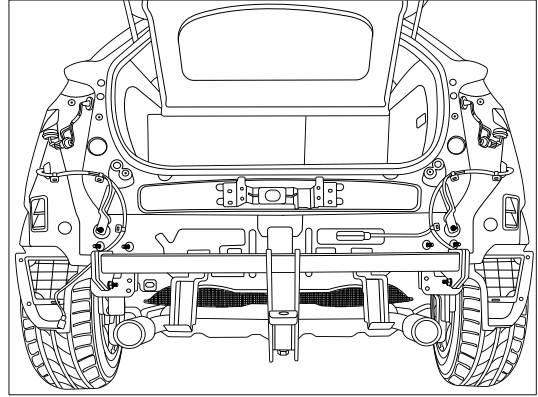

-
17. Determine an appropriate position for the plug bracket. Mark out and drill 2 x \varnothing 5mm holes 69mm apart on bumper skin to support plug bracket.

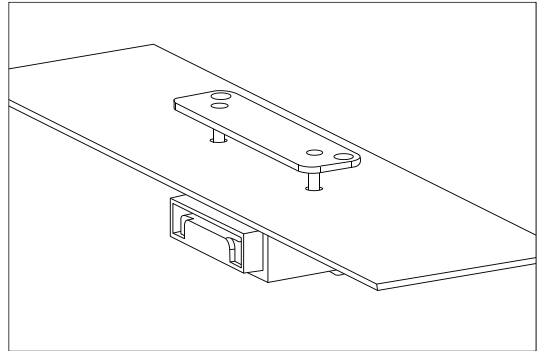



TOWBAR INSTALLATION INSTRUCTIONS

PART NUMBER 03412W

MAZDA CX-3

IMPORTANT

Due to possible vehicle variations, always confirm any noted vehicle colour wires with a multi-meter to ensure the correct function is identified before soldering or scotch locking. For vehicle wires denoted with two colours (example; RED/GREEN) the first colour will always be the main wire colour while the second colour is the thinner trace colour on the wire.

18. In the luggage compartment, remove the parcel shelf (1) and fold the rear seats forwards (2).
19. Remove both the floor cover carpets (3).

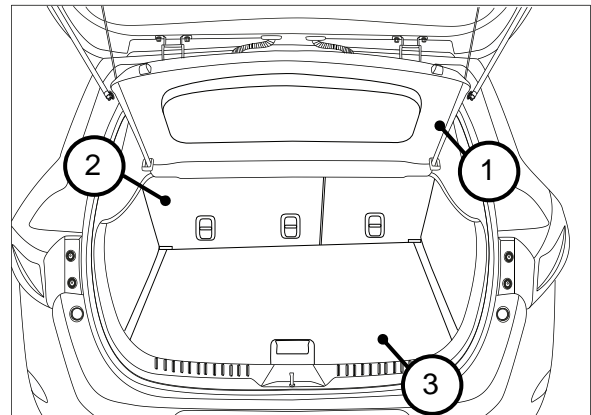

20. Remove the foam inserts (1).

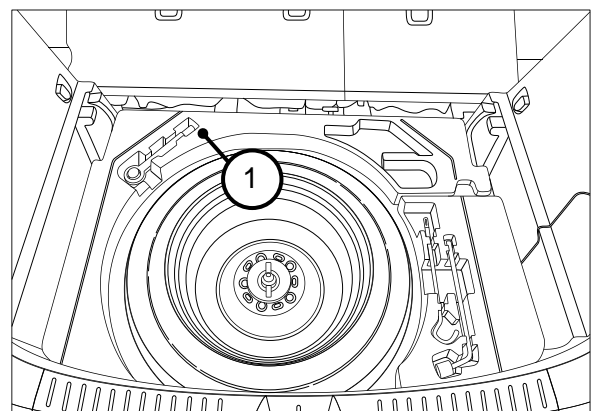

21. On the rear luggage compartment trim (1), remove the two clips (2).
22. Remove the rear luggage compartment trim (1) by pulling in an upwards direction.

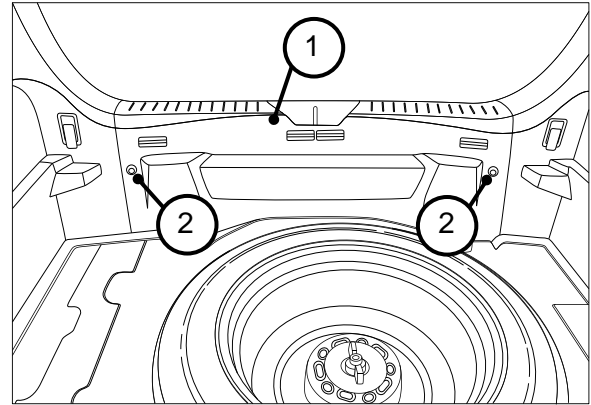

23. On the RHS luggage compartment trim (1) remove the clip (2).
24. Remove the RHS cargo hooks (3) by first removing the 10mm bolt (4).
25. Dislodge the RHS luggage compartment trim (1) and disconnect the light connector (5).
26. Remove the RHS luggage compartment trim (1).

Repeat for the LHS.

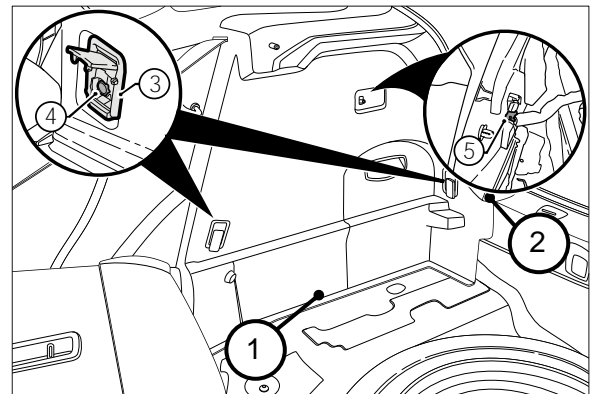

27. Drill grommet hole (1) out to 30mm using a step drill.

Ensure the interior area being drilled into is clear of any obstructions. Apply rust inhibitor after drilling.

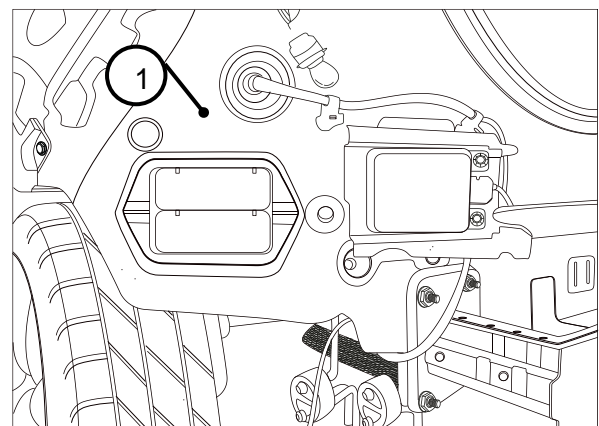



TOWBAR INSTALLATION INSTRUCTIONS

PART NUMBER 03412W

MAZDA CX-3

28. Connect the 6-way connectors (1) from the vehicles tail lamp wiring harness, to the 6-way mating connectors (2) on the Trailer Wiring Harness.
29. Secure the Trailer Wiring Harness ground ring terminal (3) to the vehicle earth point using the existing fastener.

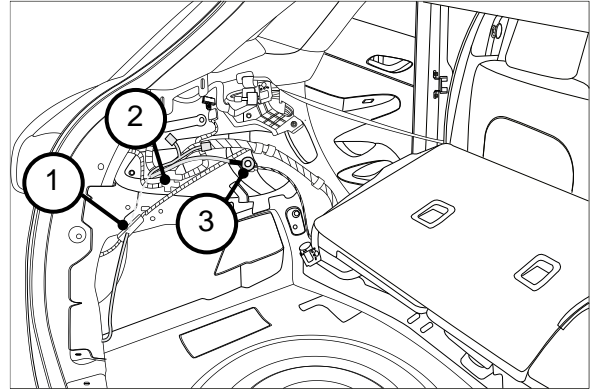

30. Route the Trailer Wiring Harness (1) towards the RHS of the vehicle following existing harness where possible.

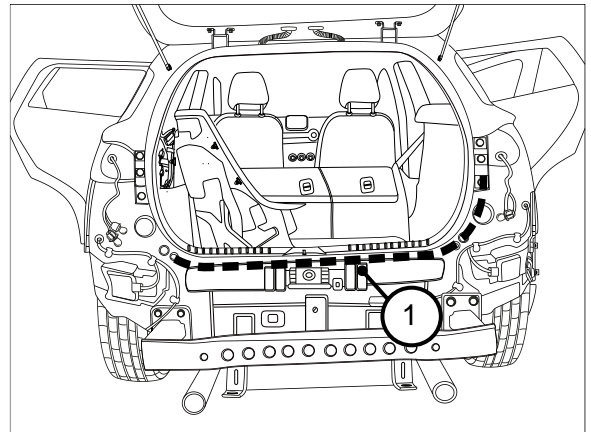

31. On the RHS of the luggage compartment, connect the 6-way connectors (1) from the vehicle's tail lamp wiring harness to the 6-way connector patch (2) on the Trailer Wiring Harness.

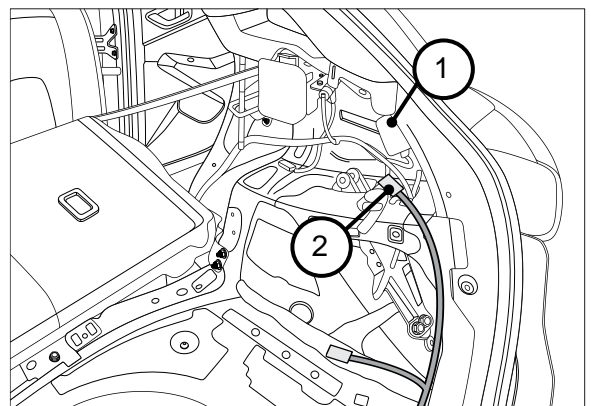



TOWBAR INSTALLATION INSTRUCTIONS

PART NUMBER 03412W

MAZDA CX-3

32. At the rear exterior of the vehicle, mount the tail harness socket (1) to the towbar mounting bracket using M4 fasteners (not supplied).
33. Route the tail harness (tail length 1200mm) (2) across the LHS and up into the exposed grommet hole (3).
34. Adjust the trailer patch harness grommet so that it is seated correctly and cable tie (not supplied) in place.

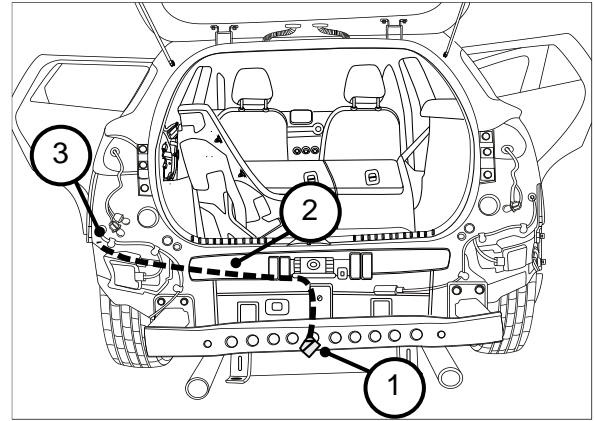

35. Connect the tail harness 8-way connector (1) to the trailer patch 8-way mating connector (2).

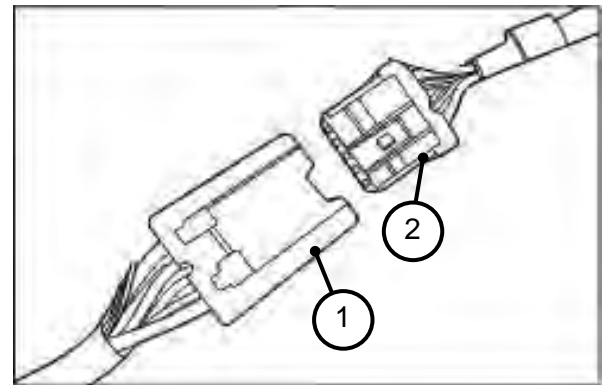

36. Reattach bumper and lights by following steps 1-11, 18-26 in reverse.

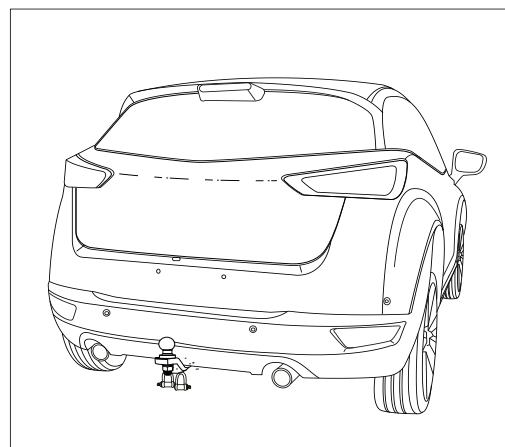



TOWBAR INSTALLATION INSTRUCTIONS

PART NUMBER 03412W

MAZDA CX-3

-
37. Test the trailer wiring harness function using a light board or multi-meter. Secure all harnesses using cable ties (not supplied).
 38. Re-fit all removed parts and secure all fasteners, ensuring there are no squeaks or rattles.
 39. Place the fitting instructions in the glove box after fitment.

-
40. Reattach bumper and lights by following steps 1-11 in reverse.

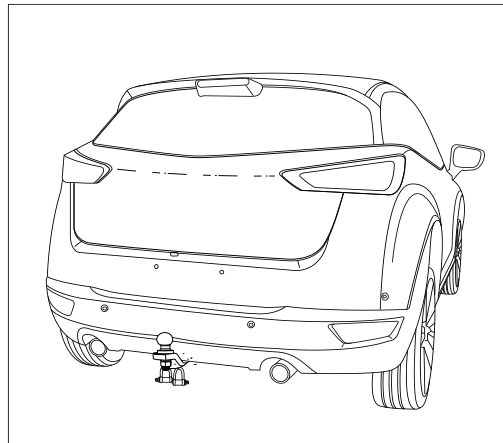



CUSTOMER INFORMATION

PLACE THESE INSTRUCTIONS IN THE
VEHICLE'S GLOVEBOX AFTER INSTALLATION

**THANK YOU FOR PURCHASING HAYMAN REESE.
WITH CORRECT MAINTENANCE AND CARE THIS PRODUCT WILL PROVIDE A
LIFETIME OF TROUBLE-FREE OPERATION.**

i TOWBAR MAINTENANCE AND CARE:

1. Hayman Reese recommend that the towbar LUG or TBM (tow ball Mount) Pull Pin and R-clip are removed and stored when not in use. Removal of LUG or TBM (tow ball mount) is advisable when not in use to assist with any of the following.
 - Ensure rear number plate is not obscured.
 - Allow maximum available departure angle and prevent any potential interference.
 - Prevent possible interference with vehicles reverse sensors or camera detecting a tow ball mount as an obstruction during reversing.
 - Removes towball mount as an obstruction for when moving around the rear of the vehicle.
2. Hayman Reese recommends routine inspection of your towbar to ensure trouble free towing.
 - Bolt security and tension should be regularly inspected and checked for correct tension. Replace any worn or defective parts with suitable grade & class fasteners. Inspection should be requested to coincide with vehicle major services.
3. It is the owner's responsibility to ensure towing and down ball weight capacities of the towing vehicle are not exceeded.
 - Towing and down ball weights allowable may differ according to model variations. Please refer to owner's manual or vehicle dealer to confirm exact rating for your vehicle model variant.
 - It is not uncommon for the vehicle tow rating to differ from the towbar rating. When this occurs, the lesser rating must be adhered to.
 - For vehicles fitted with enhanced vehicle functions that may be altered/changed when towing i.e Trailer sway mitigation, blind spot detection, adaptive cruise control etc. Please consult owner's manual to understand changes enabled when towing and after towing.

i WARRANTY INFORMATION:

Hayman Reese Towbars are covered by a Lifetime Warranty.

Our goods come with guarantees that cannot be excluded under the Australian Consumer Law. You are entitled to a replacement or refund for a major failure and for compensation for any other reasonably foreseeable loss or damage. You are also entitled to have the goods repaired or replaced if the goods fail to be of acceptable quality and the failure does not amount to a major failure.

For further details please visit www.haymanreese.com.au/warranty or contact customer service on 1800 812 017 or info@haymanreese.com.au.



CUSTOMER INFORMATION

PLACE THESE INSTRUCTIONS IN THE VEHICLE'S GLOVEBOX AFTER INSTALLATION

HAYMAN REESE SMART PIN

Your Hayman Reese towbar is equipped with Smart Pin technology to help reduce towbar tongue rattle in most driving conditions. Please ensure below instructions are understood and routine maintenance is carried out to ensure best towing experience.

i Regularly inspect for wear and check the tightness of the Smart Pin Nut. Follow instructions below to re-tighten the nut as necessary when movement and noise in the tow ball mount is noted.

- Before towing, ensure R-Clip is properly installed and Smart pin nut is installed and tensioned. Replacement parts are available from your Hayman Reese Distributor.

TOWBALL MOUNT REMOVAL/INSTALLATION

STEP 1

Insert Trailer Ball Mount (TBM) (a) into towbar hitchbox (b), aligning hole in TBM shank (c) with hole in hitchbox (d) (Fig. 1)

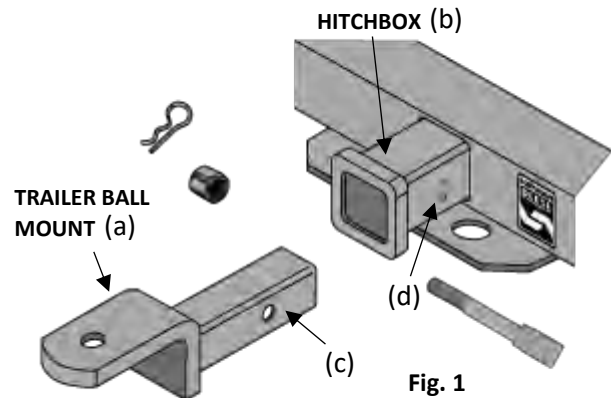

STEP 2

Insert Smart Pin (e) through hole in hitchbox and hole in TBM shank (g); ensure the locators are inserted into the notches in the hitchbox (Fig. 2)

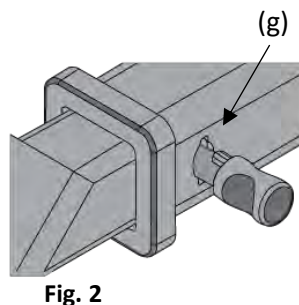

STEP 3

Screw Smart Pin Nut (f) onto Smart Pin (g); tighten Smart Pin Nut until finger tight, ensuring TBM is restrained from up and down movement.

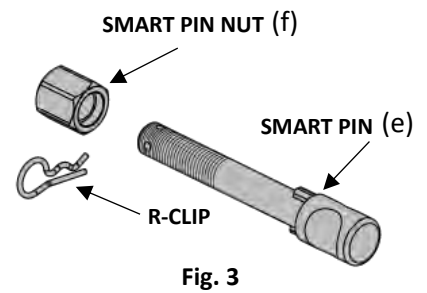

STEP 4

Tighten Smart Pin Nut by turning nut a further 1/8th of a turn in the clockwise direction using a 24mm spanner (Fig. 4).

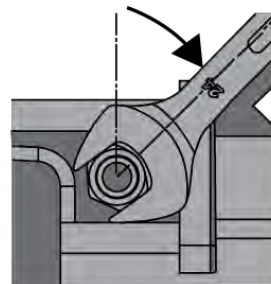

STEP 5

Install Smart Pin R-Clip through the hole that provides best clearance or easiest access. (Fig. 5)

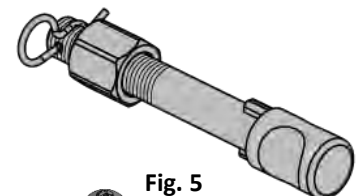

STEP 6

Install towball onto TBM and tighten to **350 Nm** using a calibrated torque wrench (Fig. 6).

