

VEHICLE: Mazda CX-5 KE/KF SUV 02/2012 - On
PART NUMBER: 130184

TOWRITE
TOWBARS AUSTRALIA

TOWBAR FITTING INSTRUCTIONS

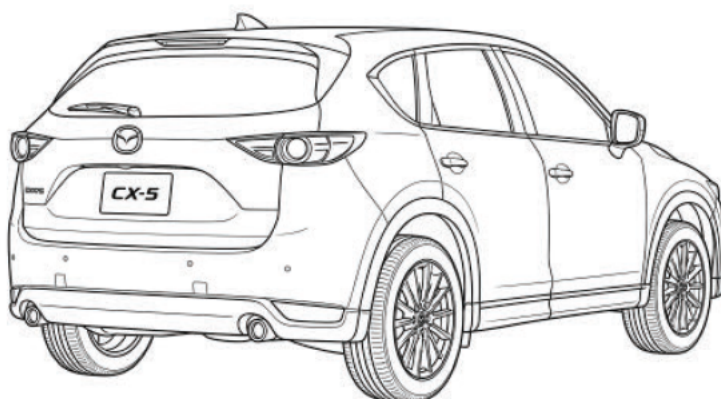
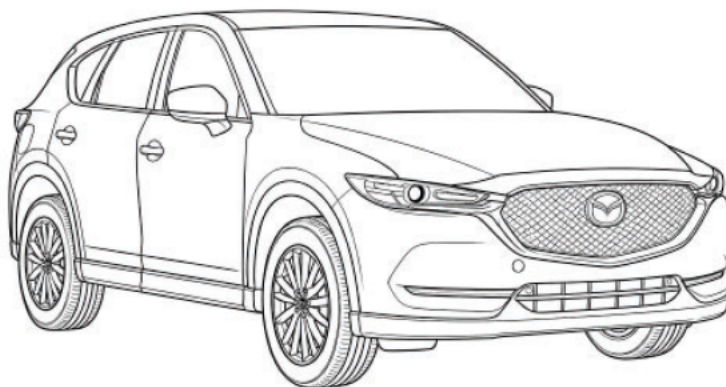

- ▶ **CX5 SUV KF** 02/2017 - On
Max Towing Braked: 2000 kg, Max Down Ball Weight: 200 kg
- ▶ **CX5 SUV KE** 02/2012 - 01/2017
Max Towing Braked: 1800 kg, Max Down Ball Weight: 180 kg

For Trailer Towing Only

Approximate Installation Time: 1.5 hrs
Maximum Towing Capacity Braked: 2000 kg
Maximum Down Ball Weight: 200 kg

Vehicles towing capacity may vary refer to owners handbook

TowRite Towbars Australia
9 Deakin Street
Brendale Qld 4500
AUSTRALIA
1800 869 748

WARNING

- This product is designed solely for towing and must be loaded exactly as outlined in your vehicle's Owner's Manual.
- If used with a bike carrier there is a 25% reduction in the towbar or vehicle ball weight capacity whichever is lowest.
- Do NOT drill, cut, weld, or modify this towbar under any circumstances.
- You might need to drill into the vehicle to install the parts. Before you drill, take a quick look behind the chassis rail and body panels to make sure nothing is in the way.
- The stated load ratings apply only where the trailer is equipped with an appropriately rated and functioning braking system.
- If installed in any position other than what is shown in these instructions, the towball mount may interfere with or obstruct certain vehicle features (such as tailgate operation or chassis clearance).

GENERAL

- Before installing this towbar, read the fitting instructions thoroughly and ensure all installation hardware is correct.
- Confirm the towbar is compatible with your vehicle, and consider any modifications or accessories (tray, canopy, suspension, etc.) that may affect installation.
- After drilling, clear away all metal filings, remove burrs, and apply a rust inhibitor to any exposed metal surfaces.
- The supplied high-tensile fasteners are essential to achieving the specified rating. If replacements are needed, ensure they are of the same grade (refer parts table on Page 3) and quality.
- Routinely check towball is tight before towing.
- Check all fasteners routinely and regularly.
- Be aware of changes in vehicle shape and bumper designs as well as any accessories that may alter the installation of this product.
- Bumper cut instructions are a guide only, ensure correct area is marked out prior to cutting.
- TowRite advises the removal of the ball mount when not in use to provide a clear view of the vehicle's registration plate if obscured.
- These instructions are provided as a guide only. TowRite accepts no responsibility for any changes to vehicle or fitment.
- Check the towball is securely tightened before towing.
- The towbar comes with 2 x compliance labels - one goes on the towbar and one in the driver's side door well
- A two-person lift is recommended for installation.
- It is recommended that installation is carried out by a trained professional.

Ensure that all lights and systems are functioning properly. Check the vehicle dash for any warning lights and visually inspect the vehicle for any damage before commencing work.

Torque Settings 8.8 Grade High Tensile Bolts

Bolt Size	Torque
M8	22 Nm \pm 10%
M10	46 Nm \pm 10%
M12	77 Nm \pm 10%
M14	146 Nm \pm 10%
M16	190 Nm \pm 10%
Tow Ball	350 Nm \pm 10%

CONTENTS

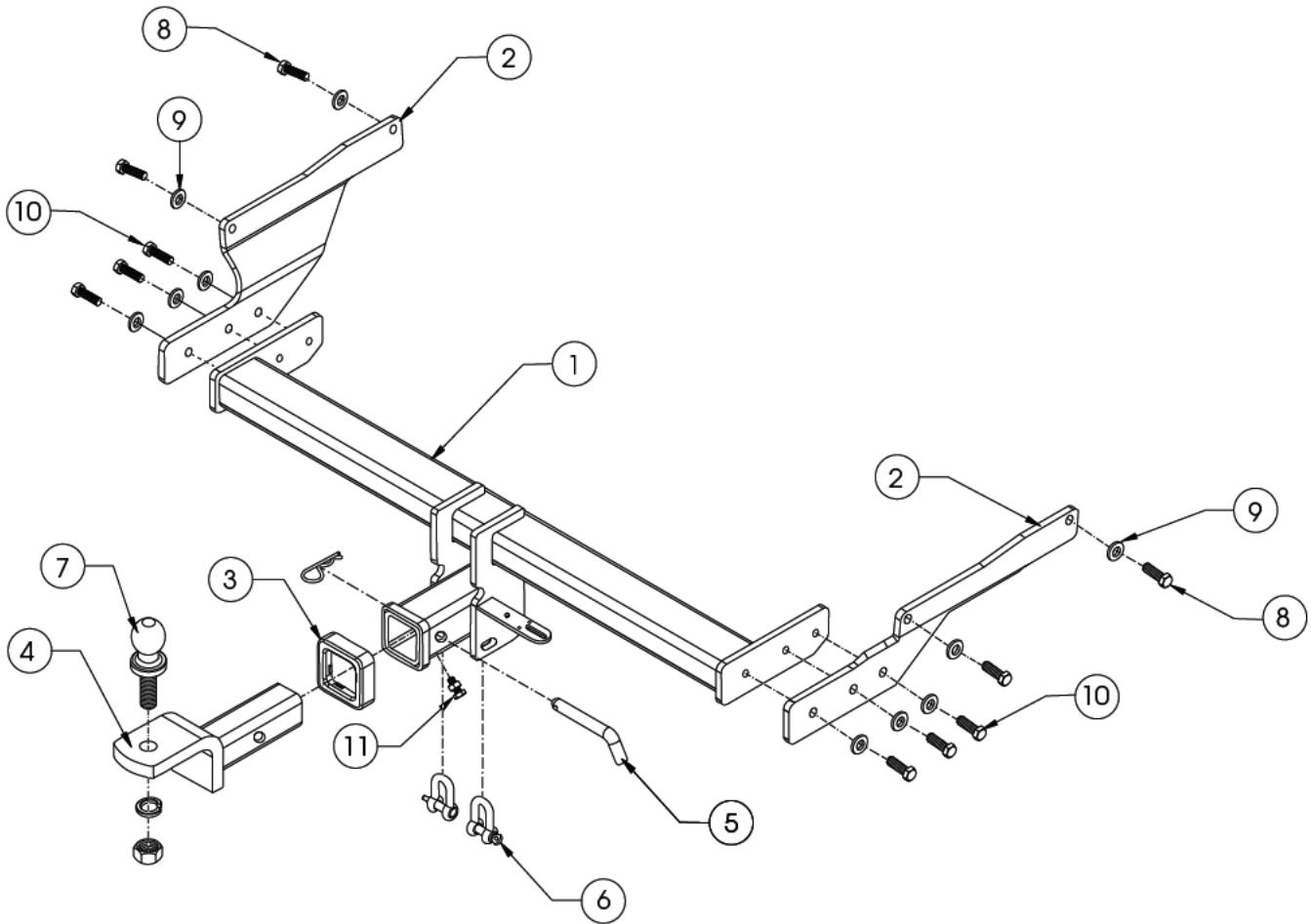

ITEM NO.	PART DESCRIPTION	QTY
1	TOWBAR ASSEMBLY	1
2	SIDE PLATE	2
3	PLASTIC SHROUD	1
4	TB01 BALLMOUNT	1
5	HITCH PIN AND CLIP	1
6	D SHACKLE	2
7	50 mm TOWBALL	1
8	M12 X 1.25 X 35 mm BOLT	4
9	M12 WASHER	10
10	M12 X 1.75 X 35 mm BOLT	6
11	ANTI RATTLE BOLT WITH LOCKING NUT	1

TOWBAR INSTALLATION

1 Remove the four rear exhaust rubbers to lower the exhaust, supporting it on the ground or an exhaust stand, and ensure it is not left hanging from the front rubbers as this may cause damage or wear.

2 Fit 1 x side plate assembly **2** to the chassis. Loosely secure using 2 x M12 bolts **8** with 1 x M12 washer **9** per bolt.

NOTE: On some models, pre-existing holes on the outer chassis may be covered with tape; locate and remove it, keeping in mind they may also be coated with body deadener.

Repeat for the other side.

LHS

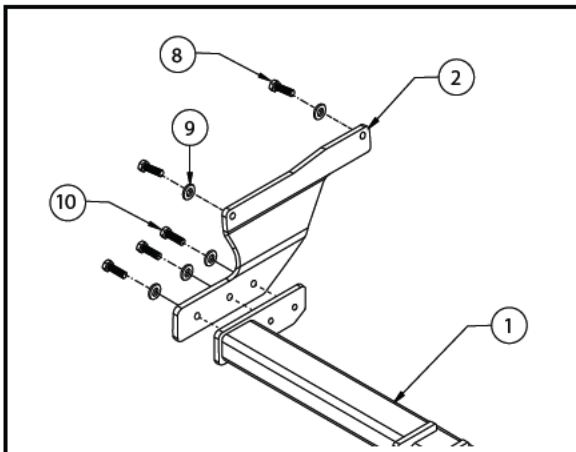

RHS

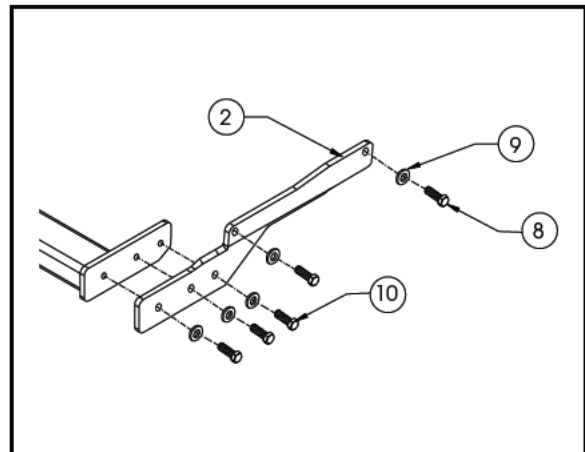

3 Fit the towbar assembly **1** between the 2 x side plates **2**. Loosely secure each side using 3 x M12 bolts **10** with 1 x M12 washer **9** per bolt.

4 Ensure all fasteners are tightened according to the torque settings on Page 2.

5 Refit exhaust back to hangers.

BALLMOUNT INSTALLATION

6

Fit the plastic shroud ③ and ballmount ④ into the receiver.
Fasten with hitch pin & clip ⑤.

Attach the anti rattle bolt with locking nut ⑪ and D shackles ⑥.

NOTE: This bolt is only to be tightened when not towing.

Fit the towball ⑦ to the ballmount ④.

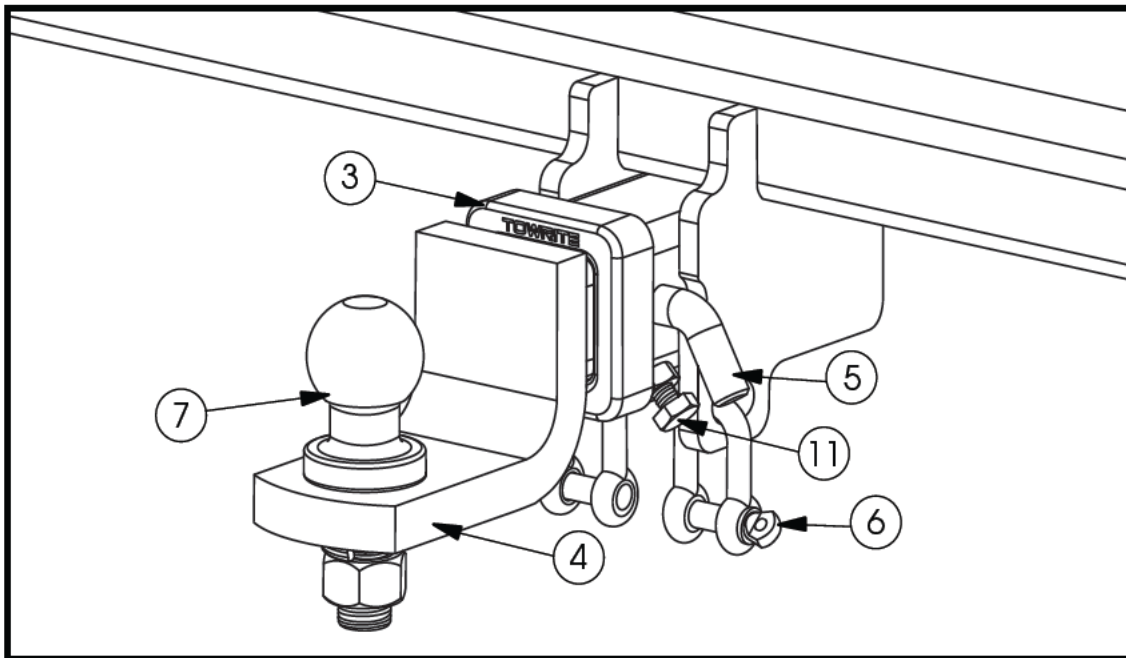

Please see below for Ballmount installation video.



Maintenance and Care

Here are some maintenance and care tips to allow for trouble free operation of your towbar for years to come.

- A) TowRite recommend removal of the ball mount/tongue when not in use.
- B) Check all fasteners regularly and tighten if necessary. If any fasteners are worn or damaged use the same grade replacements.
- C) Ensure towing and down ball weights do not exceed manufacturers specifications (this may differ between vehicles - check owners handbook). This is the driver's responsibility.
- D) Use a spray lubricant on contacts for wiring connections as well as removable and insert able parts regularly (ie. Trailer plug and ball mount and pin and clip).
- E) Check towball for wear and tear regularly, ensure towball is correctly fastened and torqued before towing.

WARRANTY INFORMATION

Your towbar comes with a limited lifetime warranty covered nationwide.
For warranty information please visit www.towritetowbars.com.au

Contact us at warranty@towritetowbars.com.au or call us on 1800 869 748

TOWRITE
TOWBARS AUSTRALIA

**TowRite Towbars Australia
9 Deakin Street
Brendale Qld 4500
AUSTRALIA
1800 869 748**

info@towritetowbars.com.au
www.towritetowbars.com.au