

VEHICLE: Skoda & Volkswagen
PART NUMBER: 145214

TOWRITE
TOWBARS AUSTRALIA

TOWBAR FITTING INSTRUCTIONS



SKODA



- ▶ **Kodiaq SUV (does not fit RS 2022 - On)** 02/2022 - On
Max Towing Braked: 2500 kg, Max Down Ball Weight: 200 kg
- ▶ **T-Roc SUV** 07/2020 - On
Max Towing Braked: 1700 kg, Max Down Ball Weight: 80 kg
- ▶ **Arteon Coupe** 06/2017 - On
Max Towing Braked: 2200 kg, Max Down Ball Weight: 90 kg
- ▶ **Kodiaq SUV (BC)** 02/2017 - 01/2022
Max Towing Braked: 2000 kg, Max Down Ball Weight: 80 kg
- ▶ **Tiguan SUV (inc. Allspace models)** 05/2016 - On
Max Towing Braked: 2500 kg, Max Down Ball Weight: 200 kg
- ▶ **Superb Wagon** 04/2016 - On
Max Towing Braked: 2200 kg, Max Down Ball Weight: 90 kg
- ▶ **Passat Sedan/Wagon** 06/2015 - On
Max Towing Braked: 2200 kg, Max Down Ball Weight: 90 kg
- ▶ **Octavia Hatch/Wagon** 11/2013 - On
Max Towing Braked: 1600 kg, Max Down Ball Weight: 75 kg
- ▶ **Golf Wagon** 08/2013 - 09/2019
Max Towing Braked: 1600 kg, Max Down Ball Weight: 75 kg

For Trailer Towing Only

Approximate Installation Time: 1.5 hrs
Maximum Towing Capacity Braked: 2500 kg
Maximum Down Ball Weight: 200 kg

Vehicles towing capacity may vary refer to owners handbook

TowRite Towbars Australia
9 Deakin Street
Brendale Qld 4500
AUSTRALIA
1800 869 748

WARNING

- This product is designed solely for towing and must be loaded exactly as outlined in your vehicle's Owner's Manual.
- If used with a bike carrier there is a 25% reduction in the towbar or vehicle ball weight capacity whichever is lowest.
- Do NOT drill, cut, weld, or modify this towbar under any circumstances.
- You might need to drill into the vehicle to install the parts. Before you drill, take a quick look behind the chassis rail and body panels to make sure nothing is in the way.
- The stated load ratings apply only where the trailer is equipped with an appropriately rated and functioning braking system.
- If installed in any position other than what is shown in these instructions, the towball mount may interfere with or obstruct certain vehicle features (such as tailgate operation or chassis clearance).

GENERAL

- Before installing this towbar, read the fitting instructions thoroughly and ensure all installation hardware is correct.
- Confirm the towbar is compatible with your vehicle, and consider any modifications or accessories (tray, canopy, suspension, etc.) that may affect installation.
- After drilling, clear away all metal filings, remove burrs, and apply a rust inhibitor to any exposed metal surfaces.
- The supplied high-tensile fasteners are essential to achieving the specified rating. If replacements are needed, ensure they are of the same grade (refer parts table on Page 3) and quality.
- Routinely check towball is tight before towing.
- Check all fasteners routinely and regularly.
- Be aware of changes in vehicle shape and bumper designs as well as any accessories that may alter the installation of this product.
- Bumper cut instructions are a guide only, ensure correct area is marked out prior to cutting.
- TowRite advises the removal of the ball mount when not in use to provide a clear view of the vehicle's registration plate if obscured.
- These instructions are provided as a guide only. TowRite accepts no responsibility for any changes to vehicle or fitment.
- Check the towball is securely tightened before towing.
- The towbar comes with 2 x compliance labels - one goes on the towbar and one in the driver's side door well
- A two-person lift is recommended for installation.
- It is recommended that installation is carried out by a trained professional.

Ensure that all lights and systems are functioning properly. Check the vehicle dash for any warning lights and visually inspect the vehicle for any damage before commencing work.

Torque Settings 8.8 Grade High Tensile Bolts

Bolt Size	Torque
M8	22 Nm \pm 10%
M10	46 Nm \pm 10%
M12	77 Nm \pm 10%
M14	146 Nm \pm 10%
M16	190 Nm \pm 10%
Tow Ball	350 Nm \pm 10%

CONTENTS

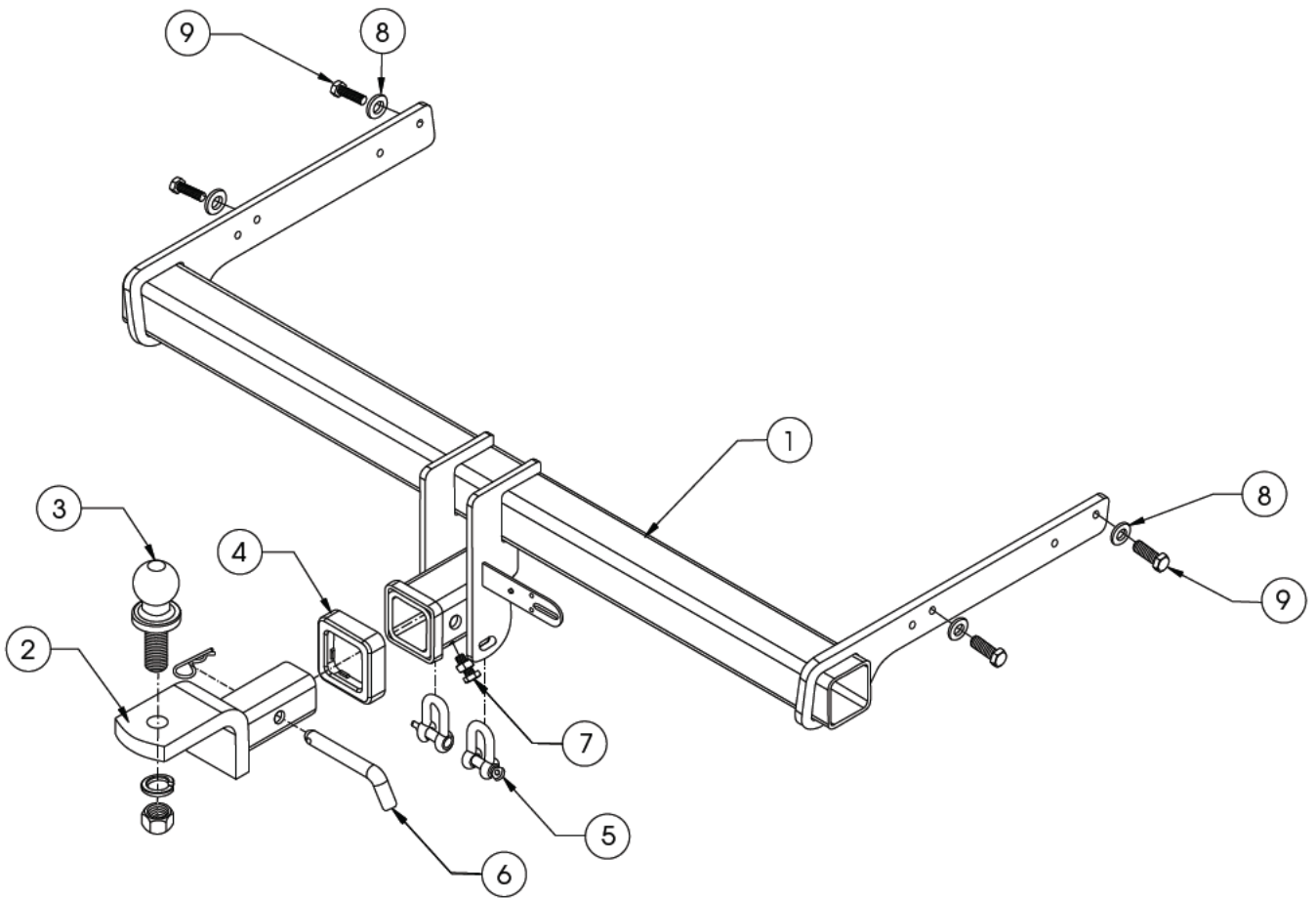

ITEM NO.	PART DESCRIPTION	QTY
1	TOWBAR ASSEMBLY	1
2	TB00 BALLMOUNT	1
3	50 mm TOWBALL	1
4	PLASTIC SHROUD	1
5	D SHACKLE	2
6	HITCH PIN AND CLIP	1
7	ANTI RATTLE BOLT WITH LOCKING NUT	1
8	M12 X WASHER	4
9	M12 X 1.25 X 35 mm BOLT	4

Note:

This towbar is designed as a multi-fit product and is compatible with multiple vehicle models. While the general removal and installation process is similar, some variations may occur between vehicles. Use these instructions as a guide and adjust as required for your specific model.

TOWBAR INSTALLATION

- 1** Apply masking between the tail lights and bumper bar to prevent damage.
- 2** Remove the tail light covers inside the vehicle and undo the plastic retaining screws securing the tail lights.
- 3** Unplug the tail light and carefully pull it straight back to remove.
- 4** On the LHS, remove 3 x Torx screws securing the wheel arch.
- 5** Remove 1 x Torx screw located at the bottom of the wheel arch flare.
- 6** Peel back the wheel arch flare to expose the Torx screw, then remove it.
- 7** Repeat Steps 4 to 6 for the RHS.
- 8** Remove 4 x plastic scrivenets from underneath the bumper bar.
- 9** Unclip and remove the bumper bar.
Tech Tip: Use a plastic trim tool to release the bumper from the clip rail underneath the area where the tail lights were removed.

10 Disconnect the reverse sensors (if applicable) and place the bumper bar in a safe area.

11 Remove the 7 x bolts securing the impact beam, (4 x on one side and 3 x on the other) then discard.

12 **Models with Adblue:** Lower the Adblue tank to allow access to the bolt holes on side of chassis.

13 Insert towbar side arms into chassis rails and secure each side using 2 x bolts ⑨ and 2 x washers ⑧.

NOTE: The holes may be covered by adhesive tape.

LHS

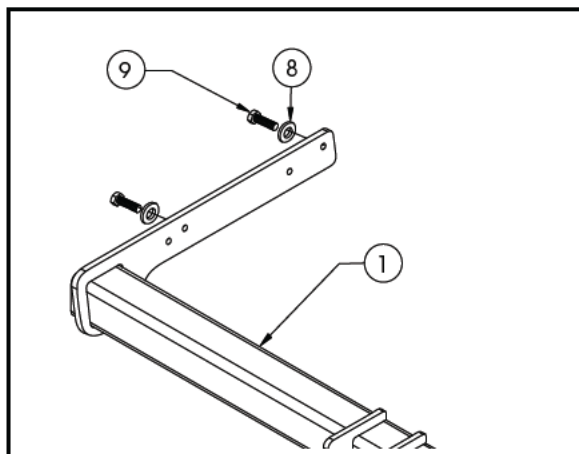

RHS

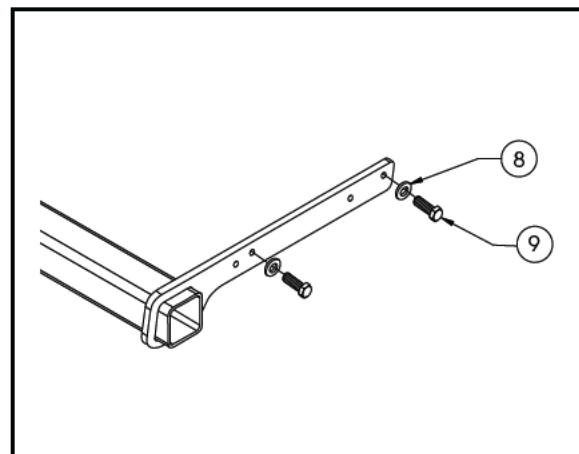

14 Ensure all fasteners are tightened according to the torque settings on Page 2.

15 Towbar protrudes through the factory cut-out in the bumper bar. Ensure edges are protected to prevent damage while passing the towbar through during installation.

NOTE: If the factory cut-out is not present, cut along the factory template located on the inside of the bumper. File down any rough edges after cutting.

16 Refit the bumper in the reverse order of removal.

BALLMOUNT INSTALLATION

17 Fit the plastic shroud (4) and ballmount (2) into the receiver.
Fasten with hitch pin & clip (6).

Attach the anti rattle bolt with locking nut (7) and D shackles (5).

NOTE: This bolt is only to be tightened when not towing.

Fit the towball (3) to the ballmount (2).

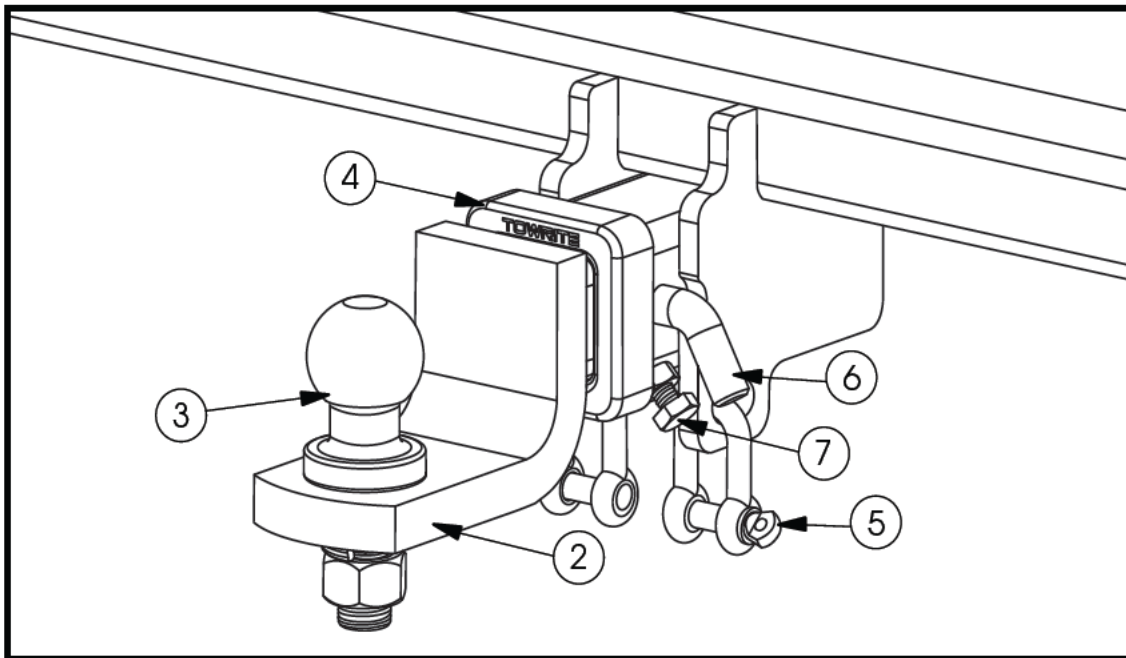

Please see below for Ballmount installation video.



LABEL INSTALLATION

CLEAN SURFACES

Attach 1 x compliance label on the towbar and the second on the drivers side door well.

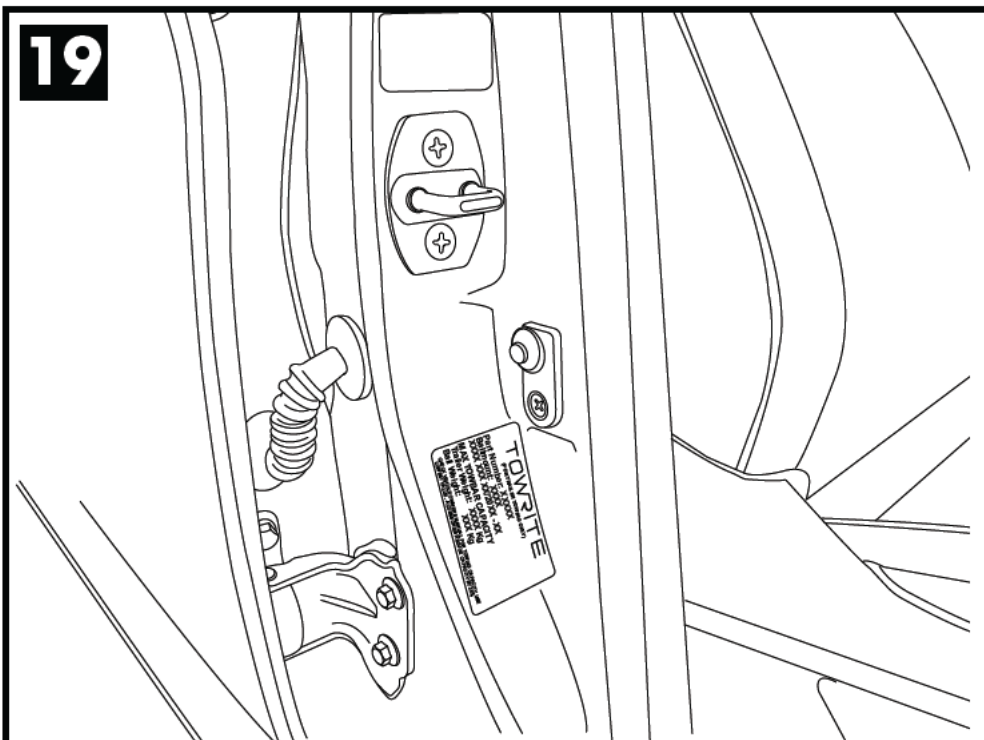
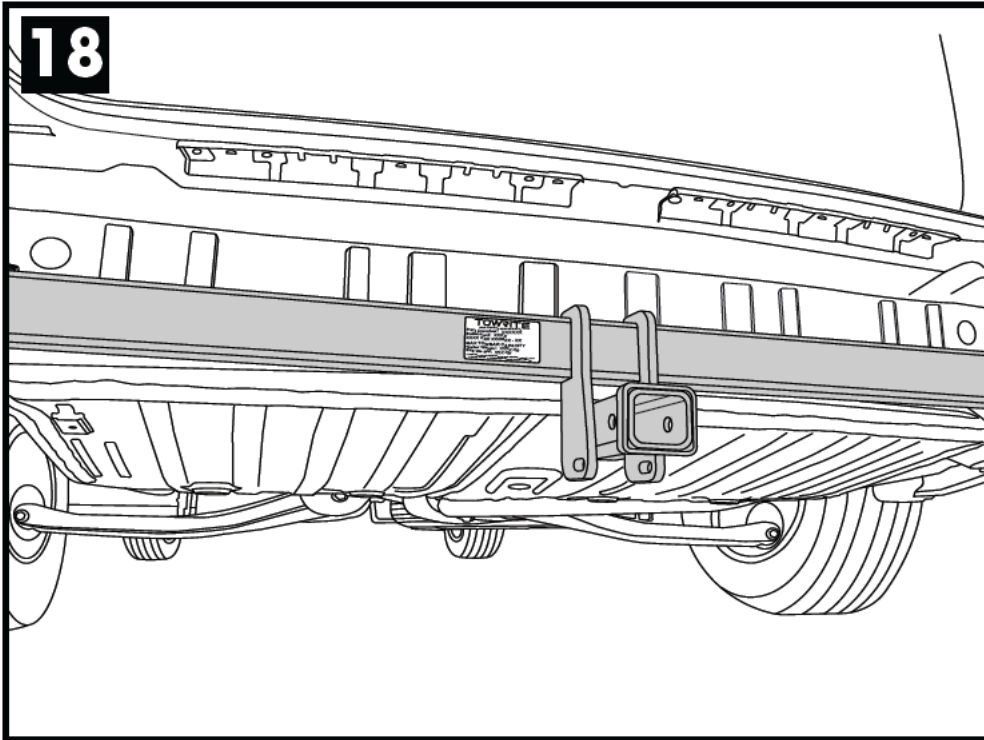

Maintenance and Care

Here are some maintenance and care tips to allow for trouble free operation of your towbar for years to come.

- A) TowRite recommend removal of the ball mount/tongue when not in use.
- B) Check all fasteners regularly and tighten if necessary. If any fasteners are worn or damaged use the same grade replacements.
- C) Ensure towing and down ball weights do not exceed manufacturers specifications (this may differ between vehicles - check owners handbook). This is the driver's responsibility.
- D) Use a spray lubricant on contacts for wiring connections as well as removable and insert able parts regularly (ie. Trailer plug and ball mount and pin and clip).
- E) Check towball for wear and tear regularly, ensure towball is correctly fastened and torqued before towing.

WARRANTY INFORMATION

Your towbar comes with a limited lifetime warranty covered nationwide.
For warranty information please visit www.towritetowbars.com.au

Contact us at warranty@towritetowbars.com.au or call us on 1800 869 748

TOWRITE
TOWBARS AUSTRALIA

**TowRite Towbars Australia
9 Deakin Street
Brendale Qld 4500
AUSTRALIA
1800 869 748**

info@towritetowbars.com.au
www.towritetowbars.com.au