

HOLDEN VF Wagon

07/13 - 12/17

750041

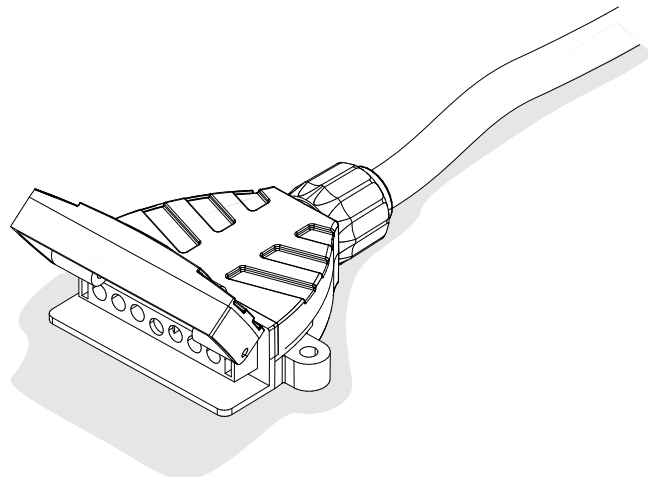

Installation instructions

Reference:

The following information must be reviewed before beginning the assembly:

The installation instructions are to be thoroughly read.
The installation should be carried out by qualified personnel with the relevant technical knowledge.
The vehicle manufacturers' current technical notices and information on retrofitting must be followed.
The removal and replacement instructions found in the current repair manuals must be followed.
It must be ensured that the vehicle is technically suitable for the installation of a trailer hitch.

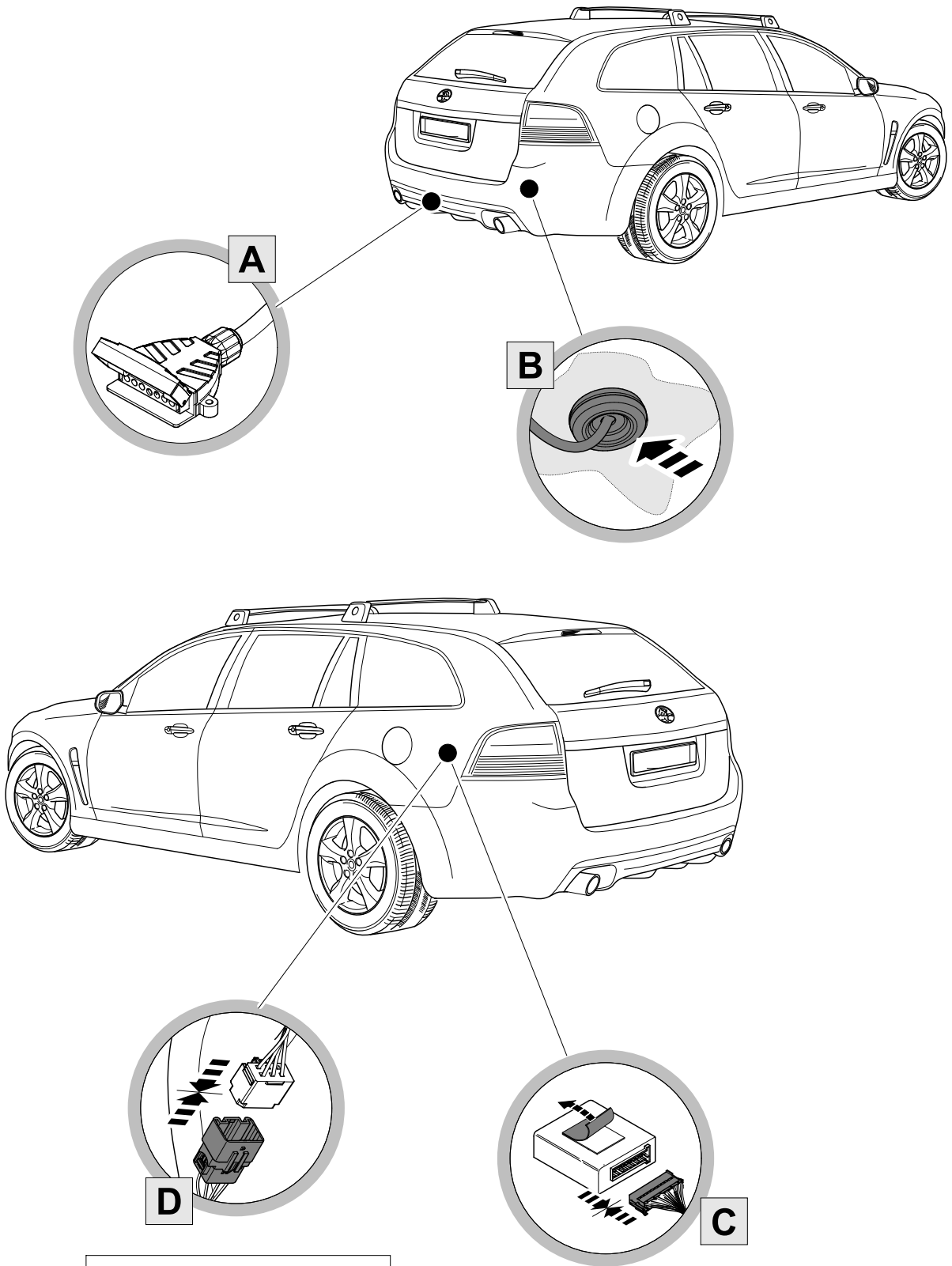

**trailer
breakout connector**

KIT

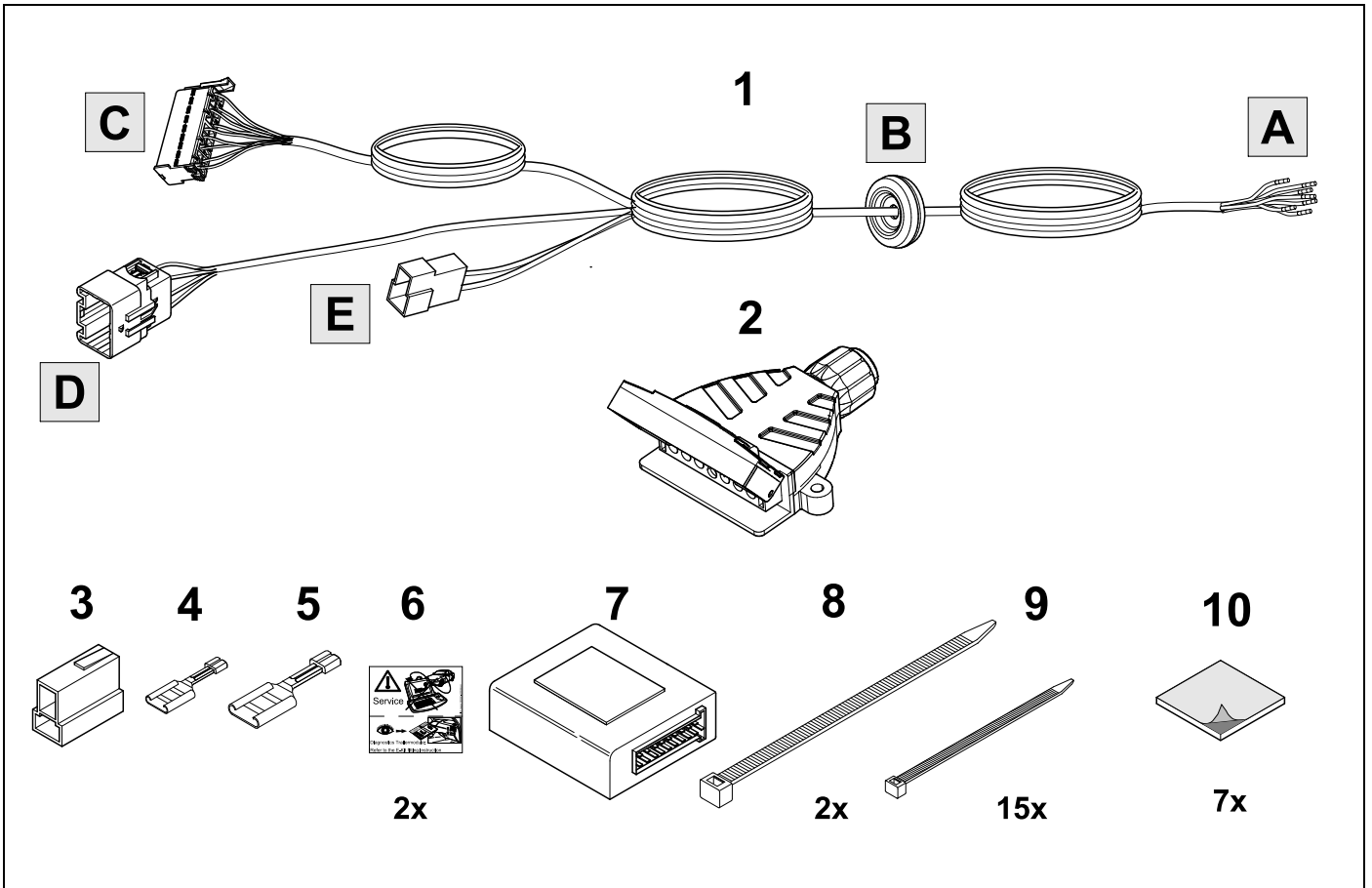

TOOLS

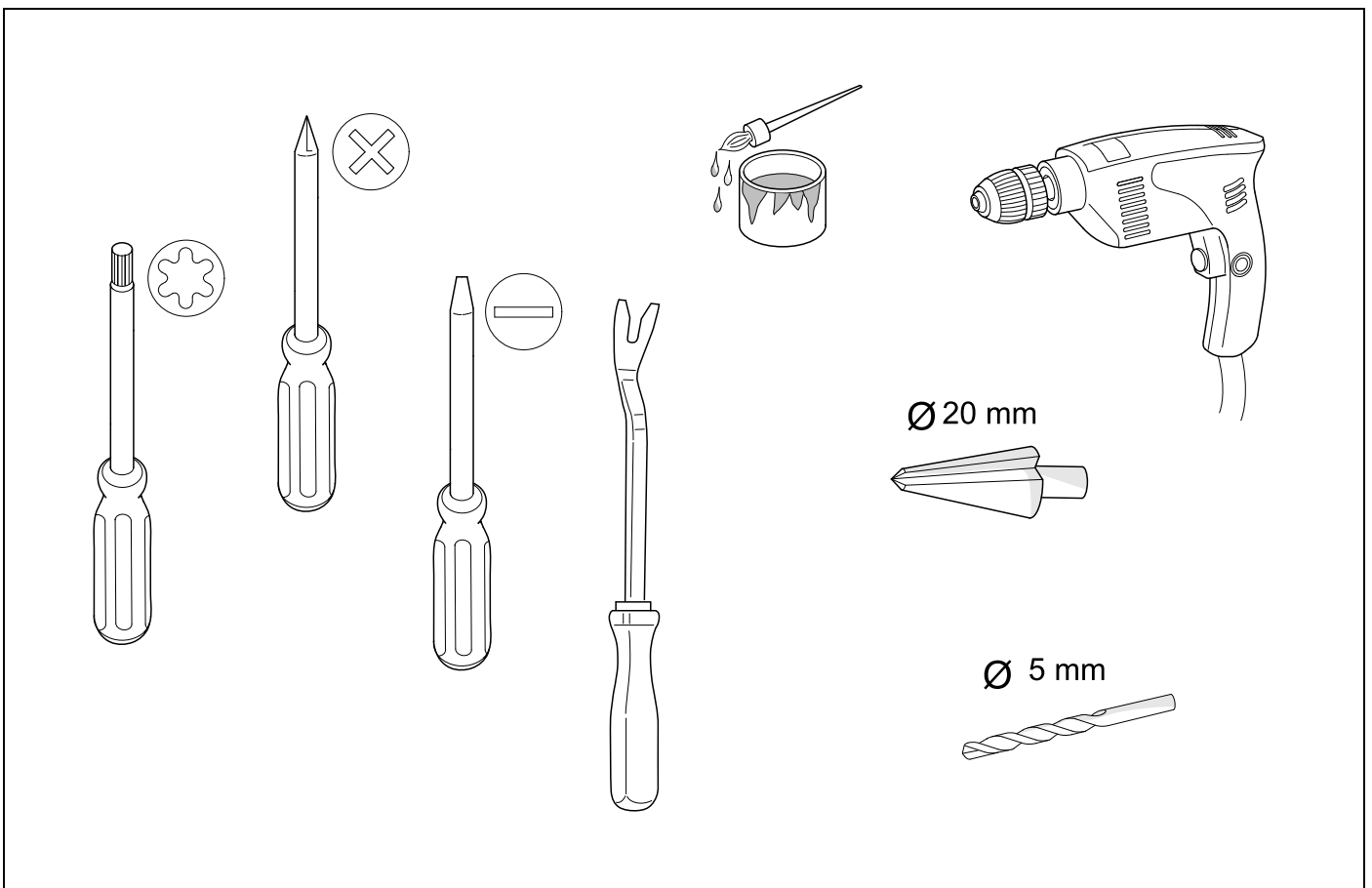

1

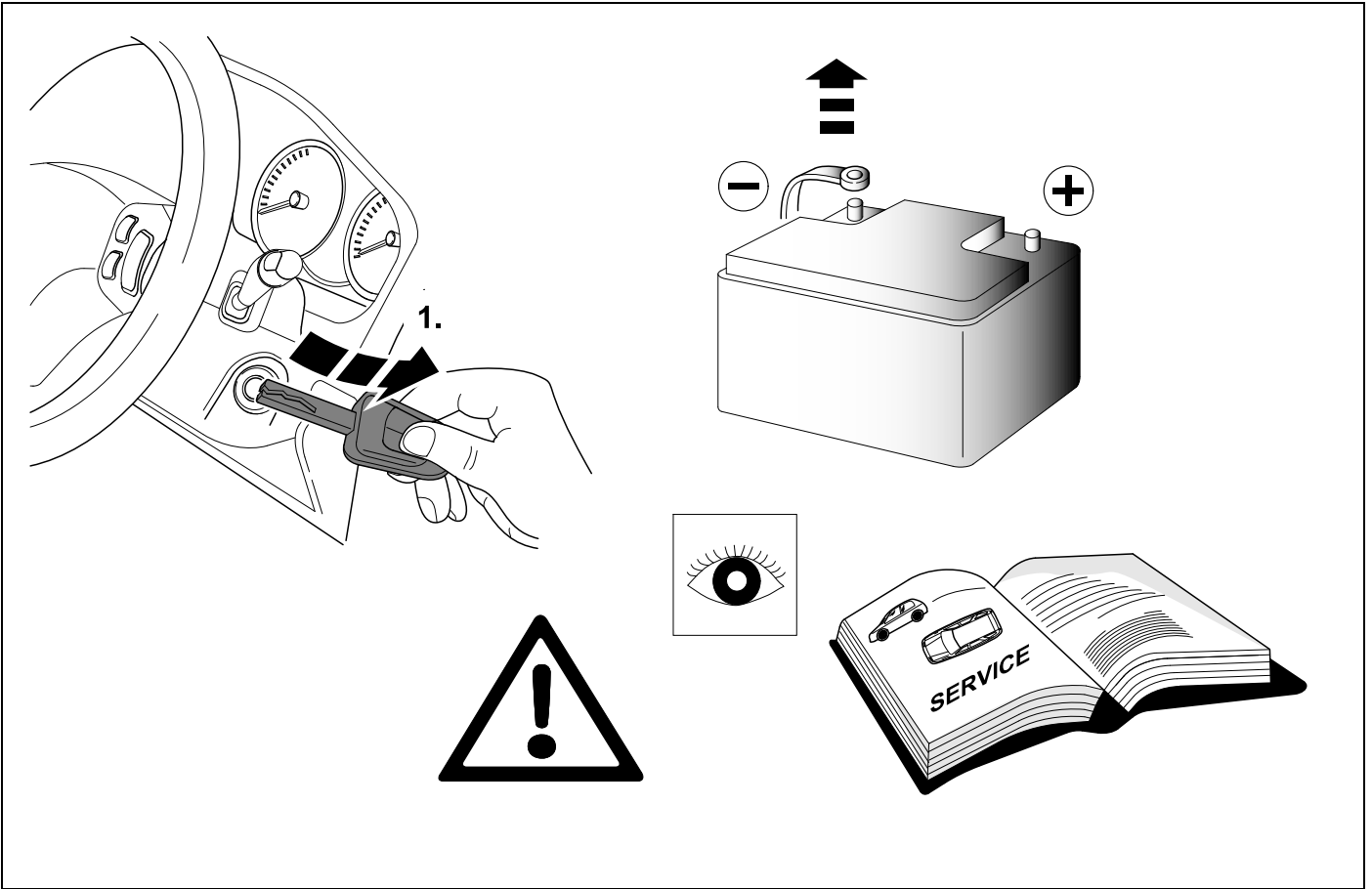

2

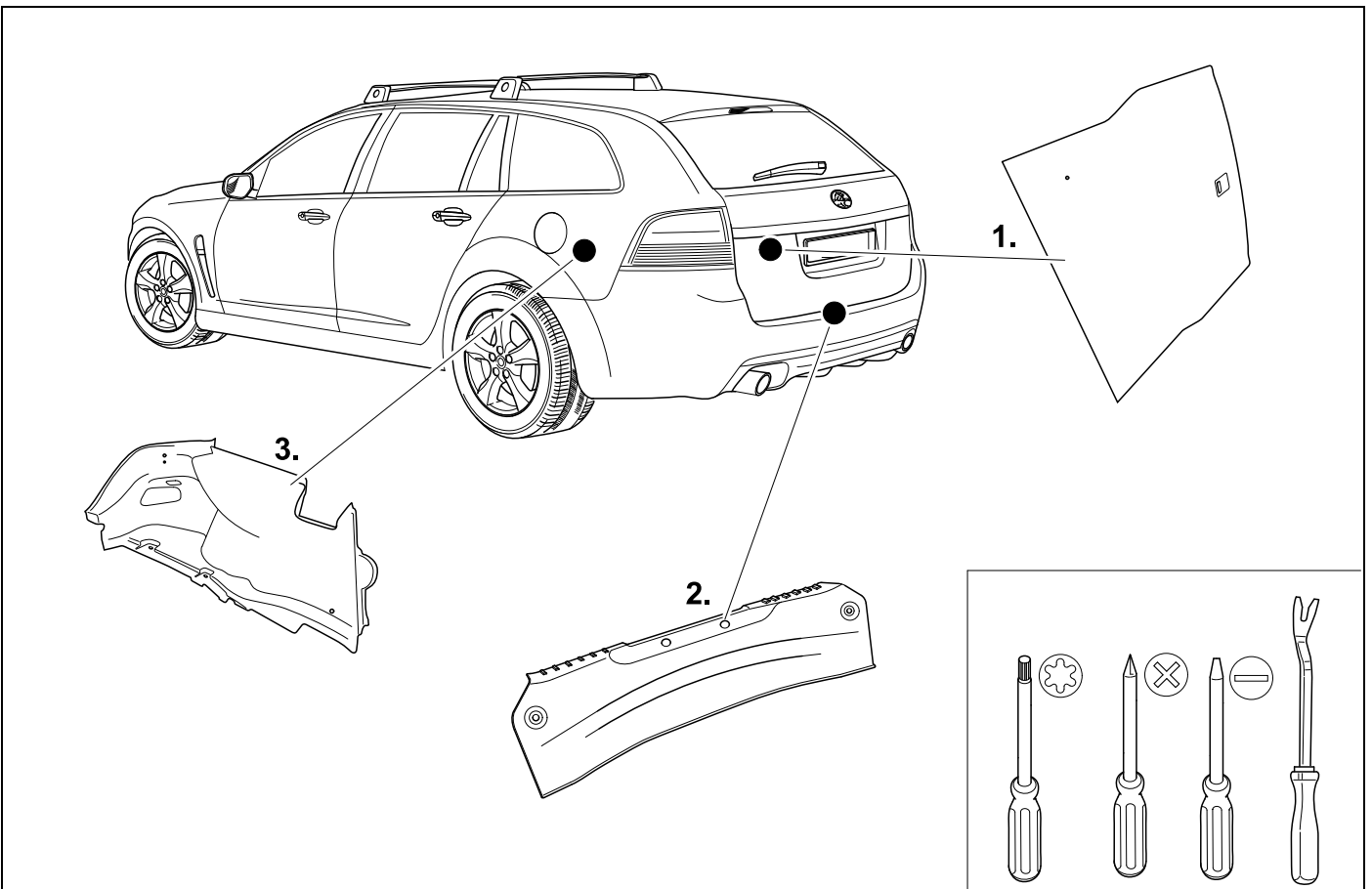

3

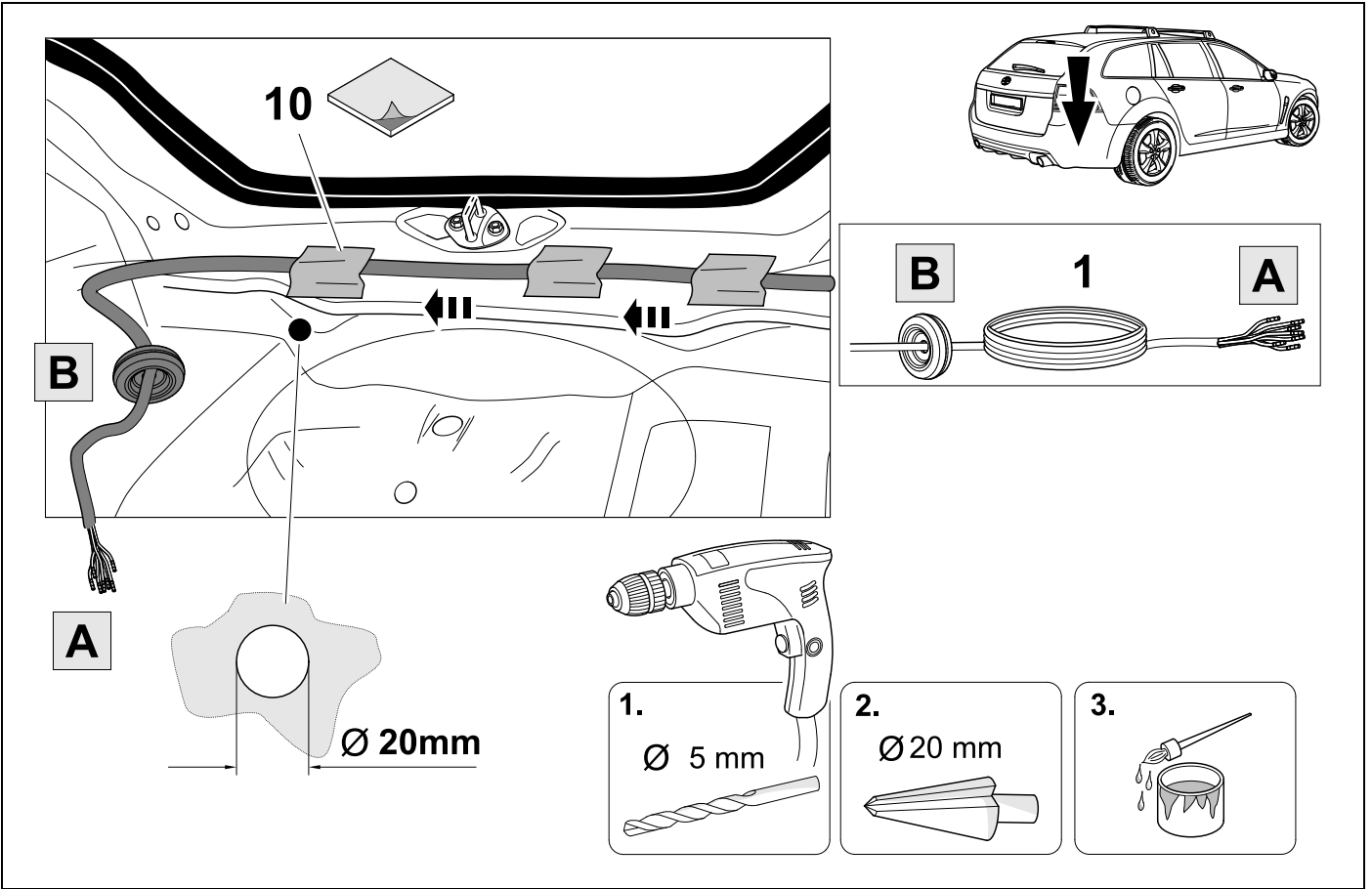

4

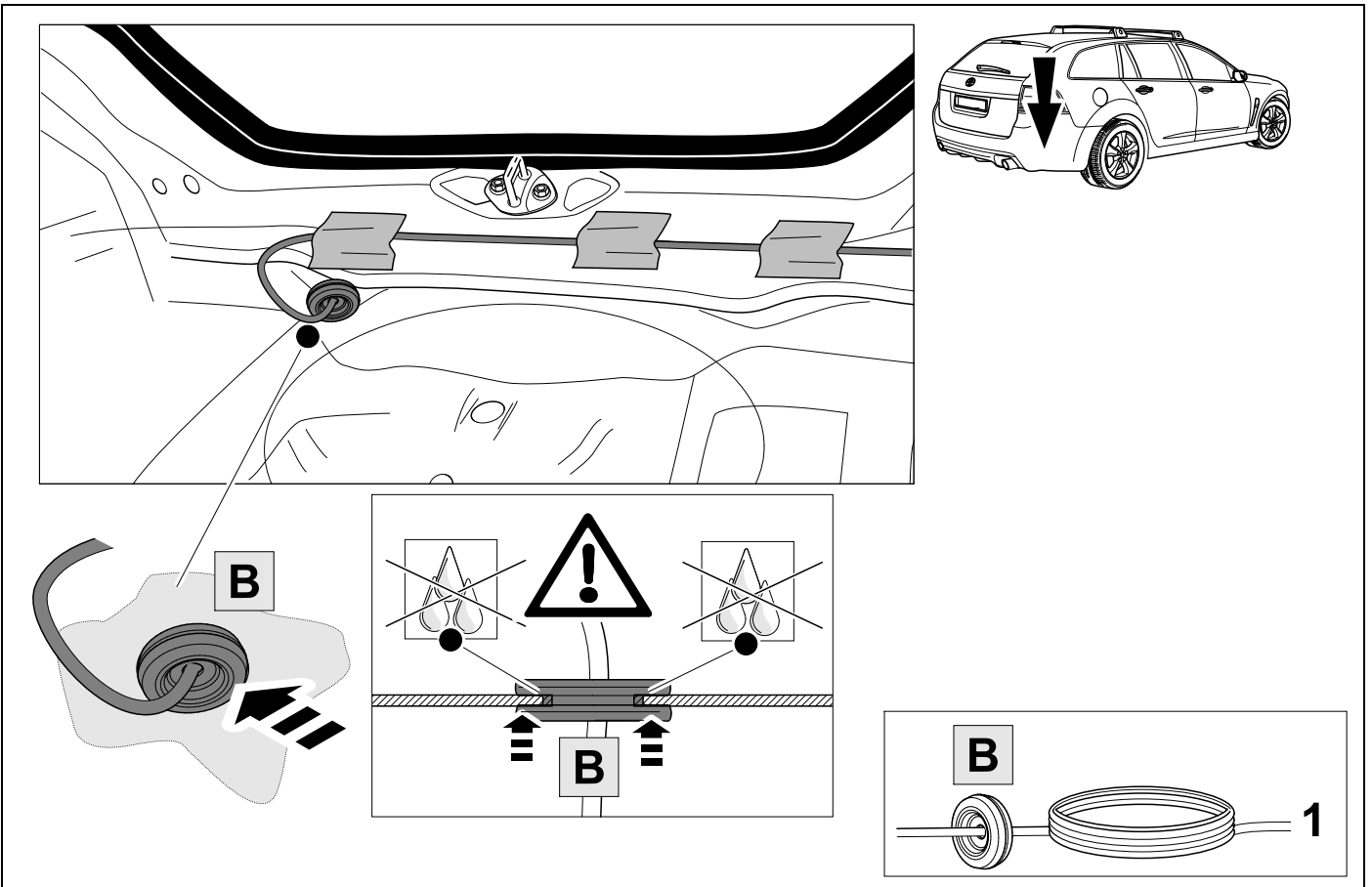

5

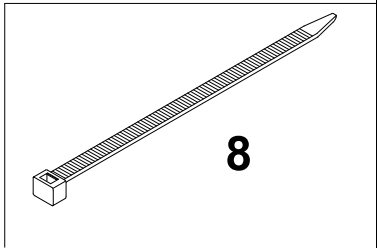
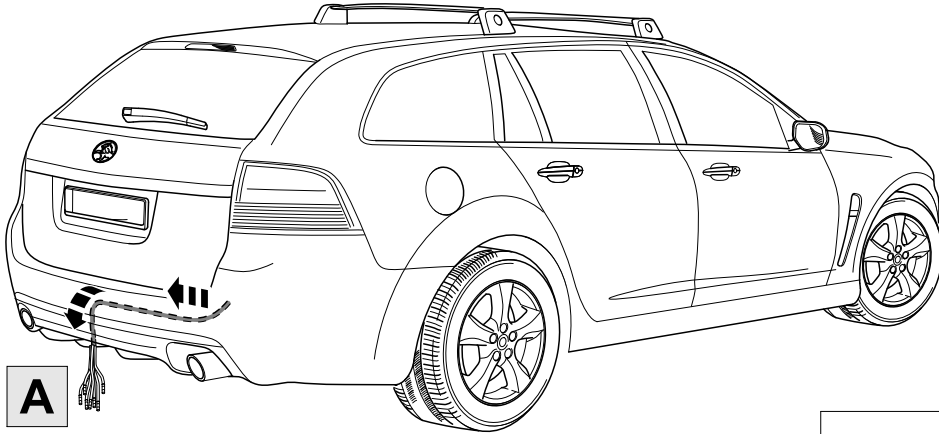
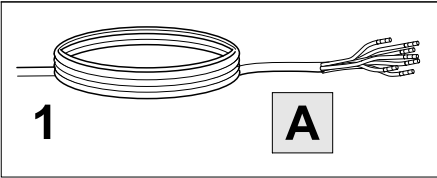

6



8

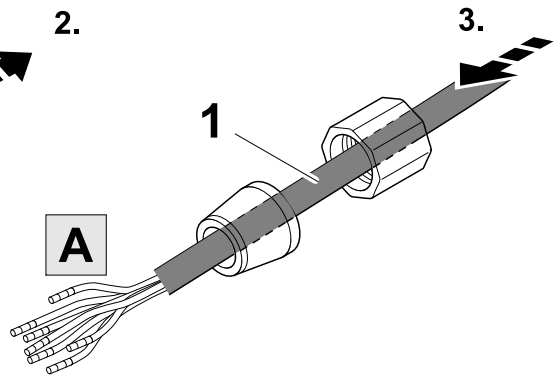
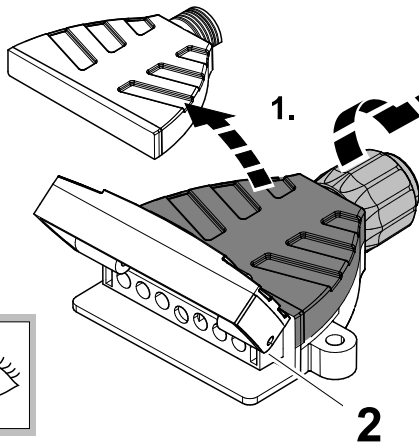
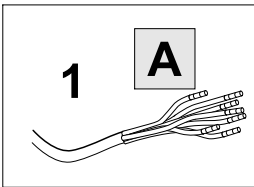

- gn 4
- bn 7
- bk 2
- wh 3
- bu 5
- rd 6
- ye 1

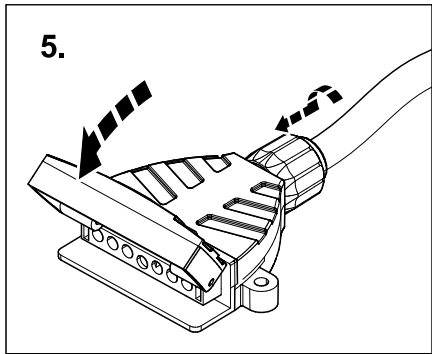
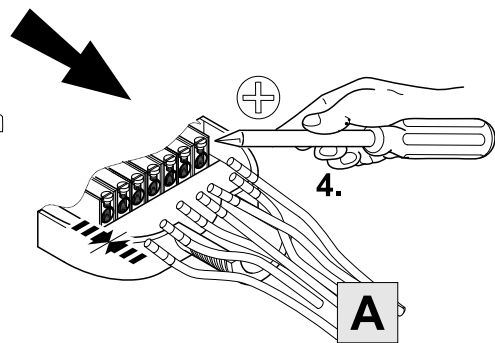
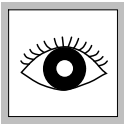

7

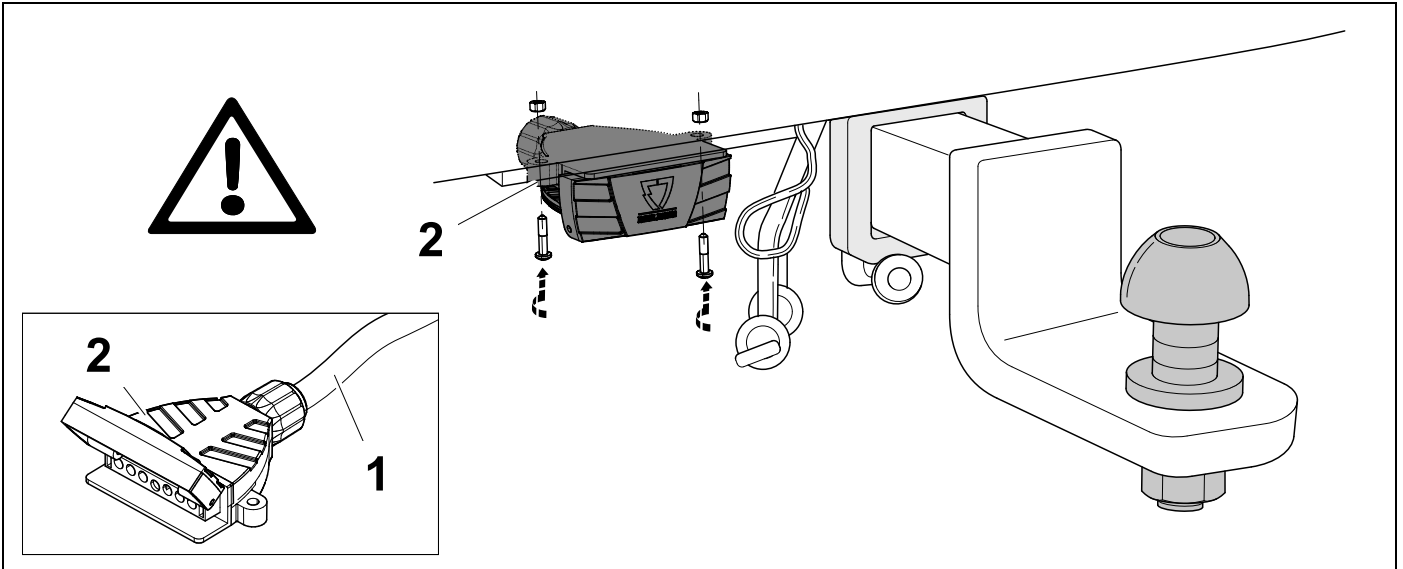

8



9

1	ye	
2	bk	
3	wh	
4	gn	
5	bu	
6	rd	
7	bn	

9	bk	wh	gy	gn	rd	bu	ye	bn	pu	or	no
	black	white	grey	green	red	blue	yellow	brown	purple	orange	not occupied

10

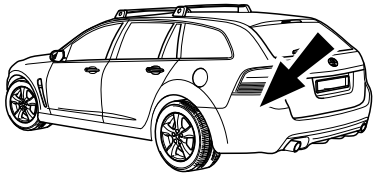

Trailer
breakout connector

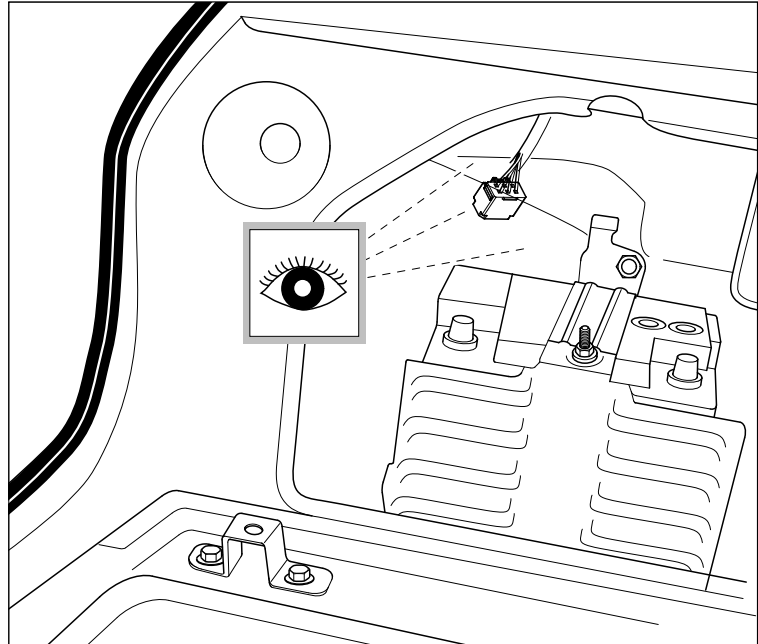
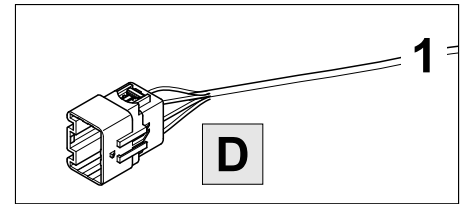
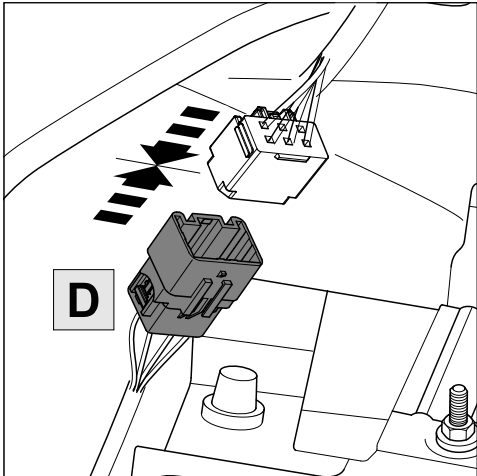

11

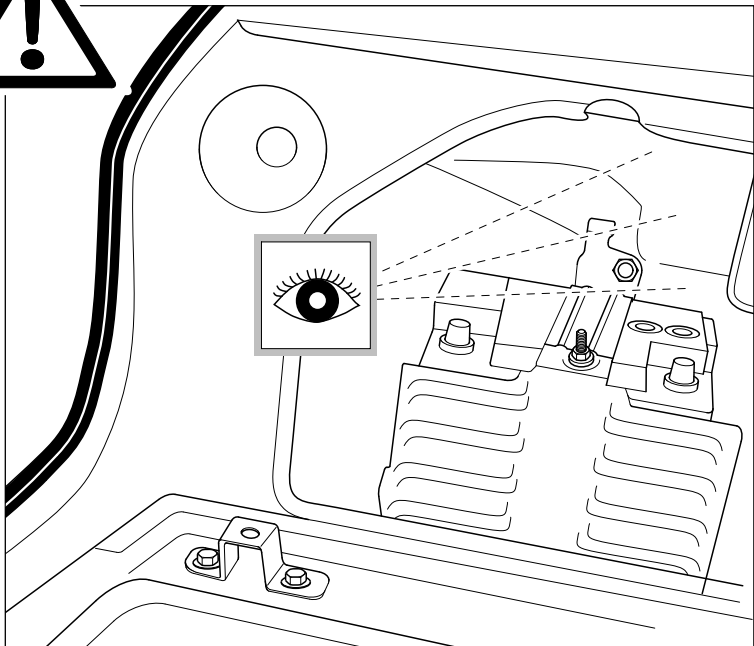
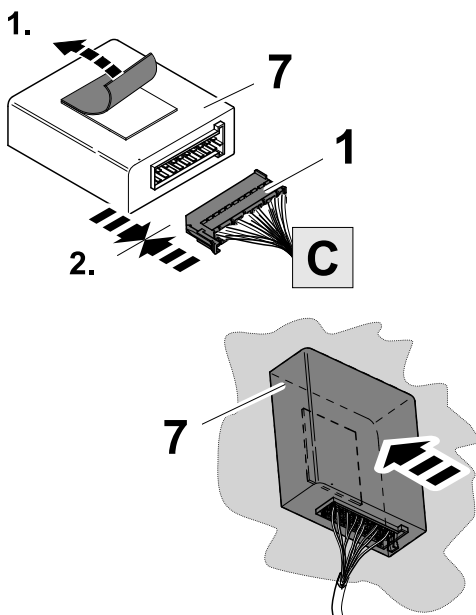
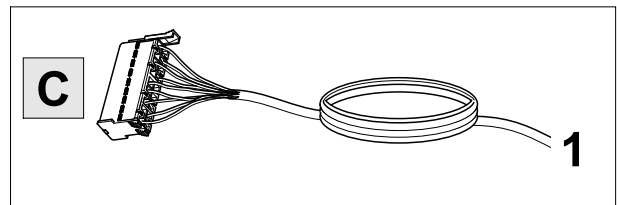
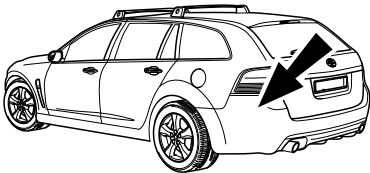



Trailer Brake Preparation

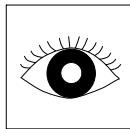
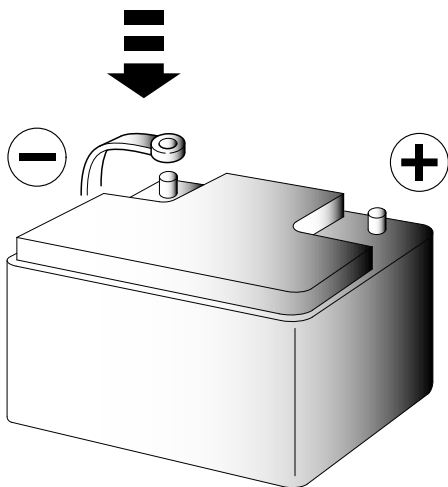
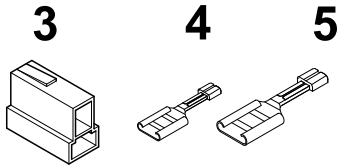
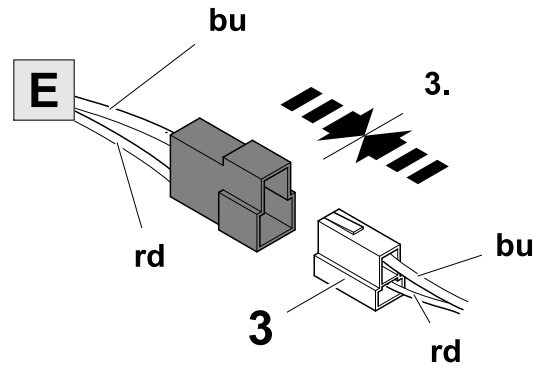
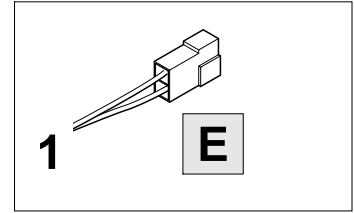
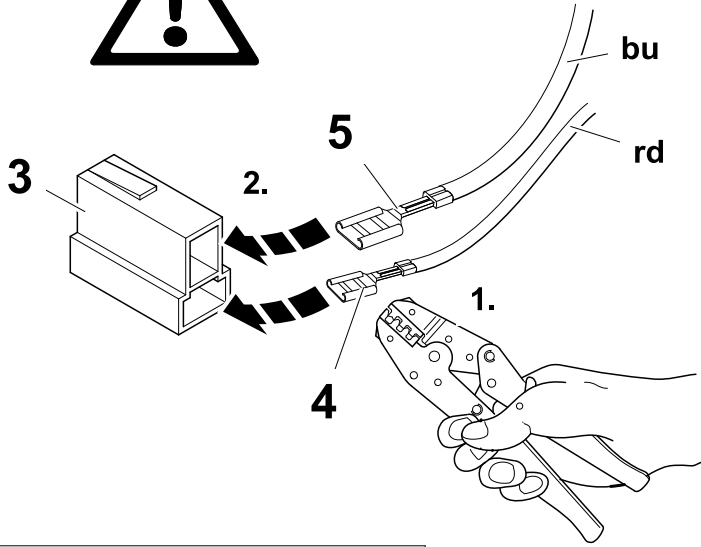

14

CHECK ALL LIGHTING FUNCTIONS

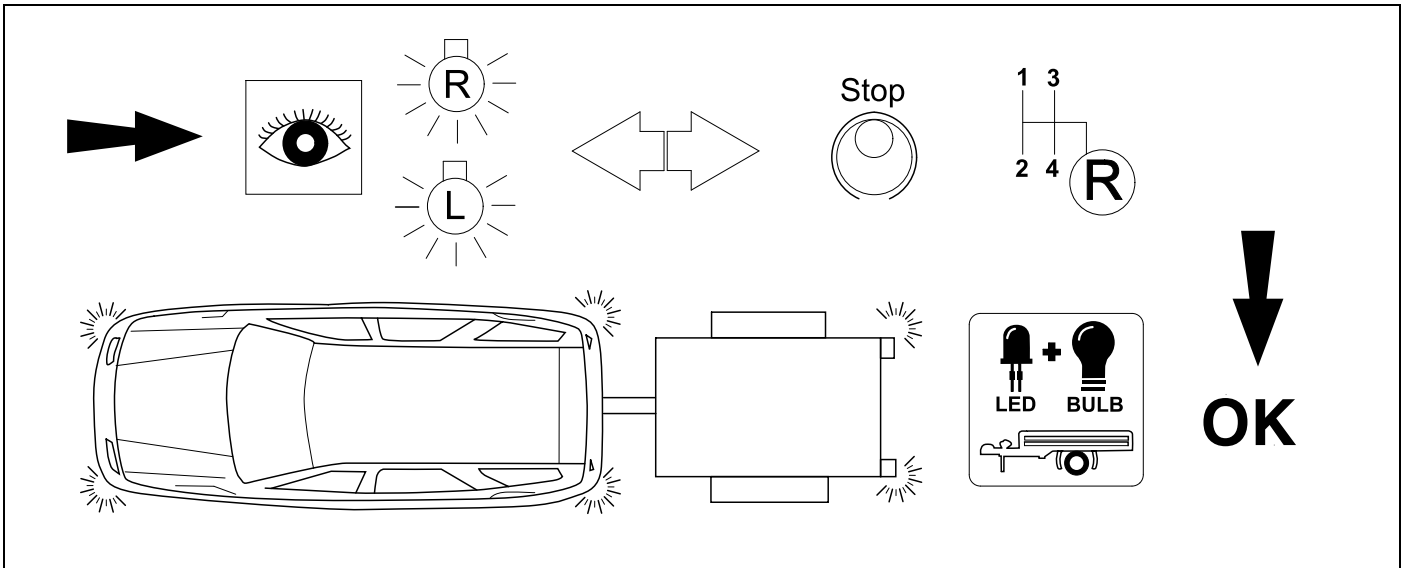

15

CHECK BULB OUT DETECTION

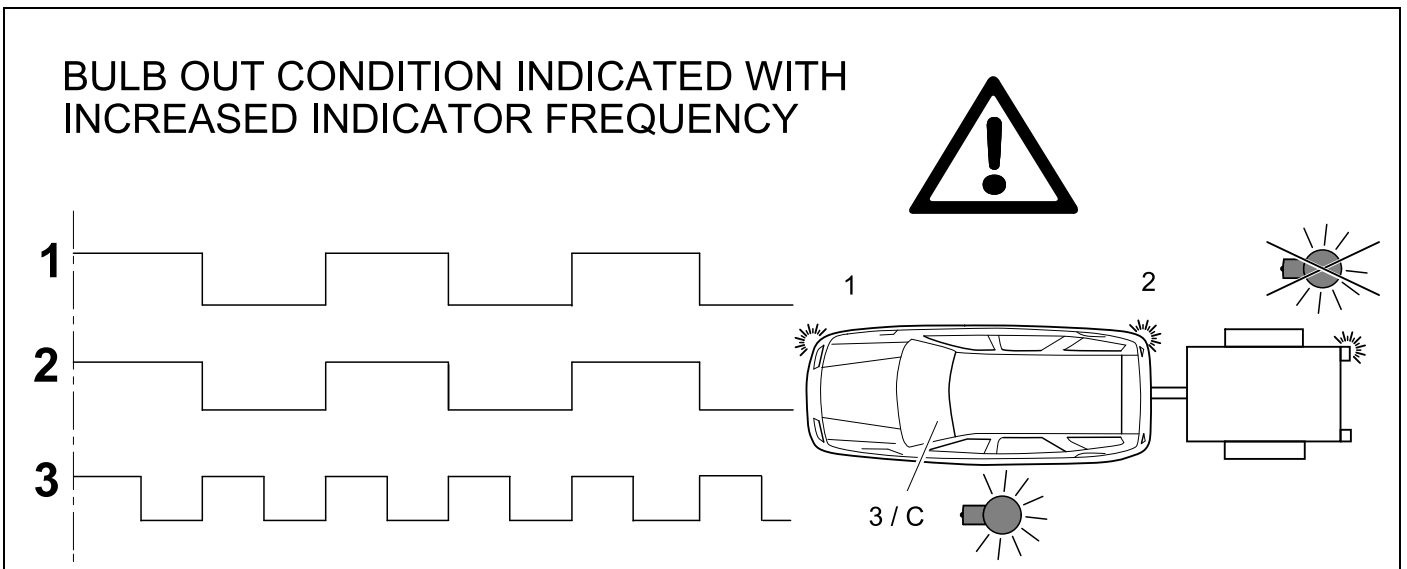

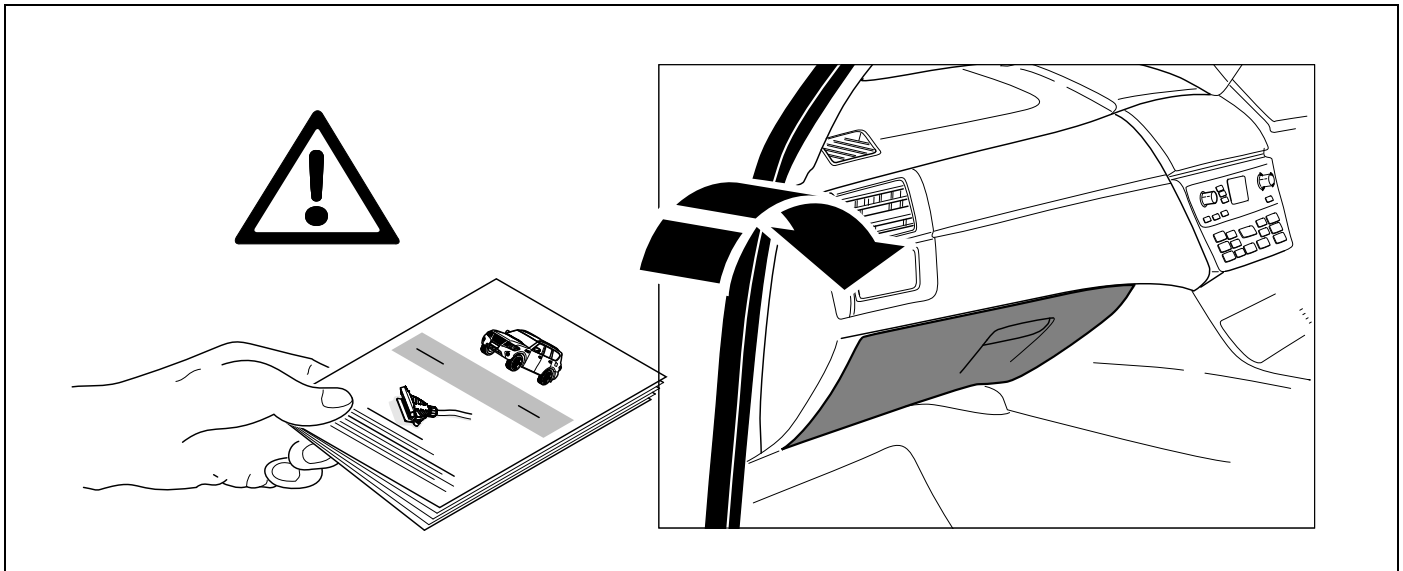
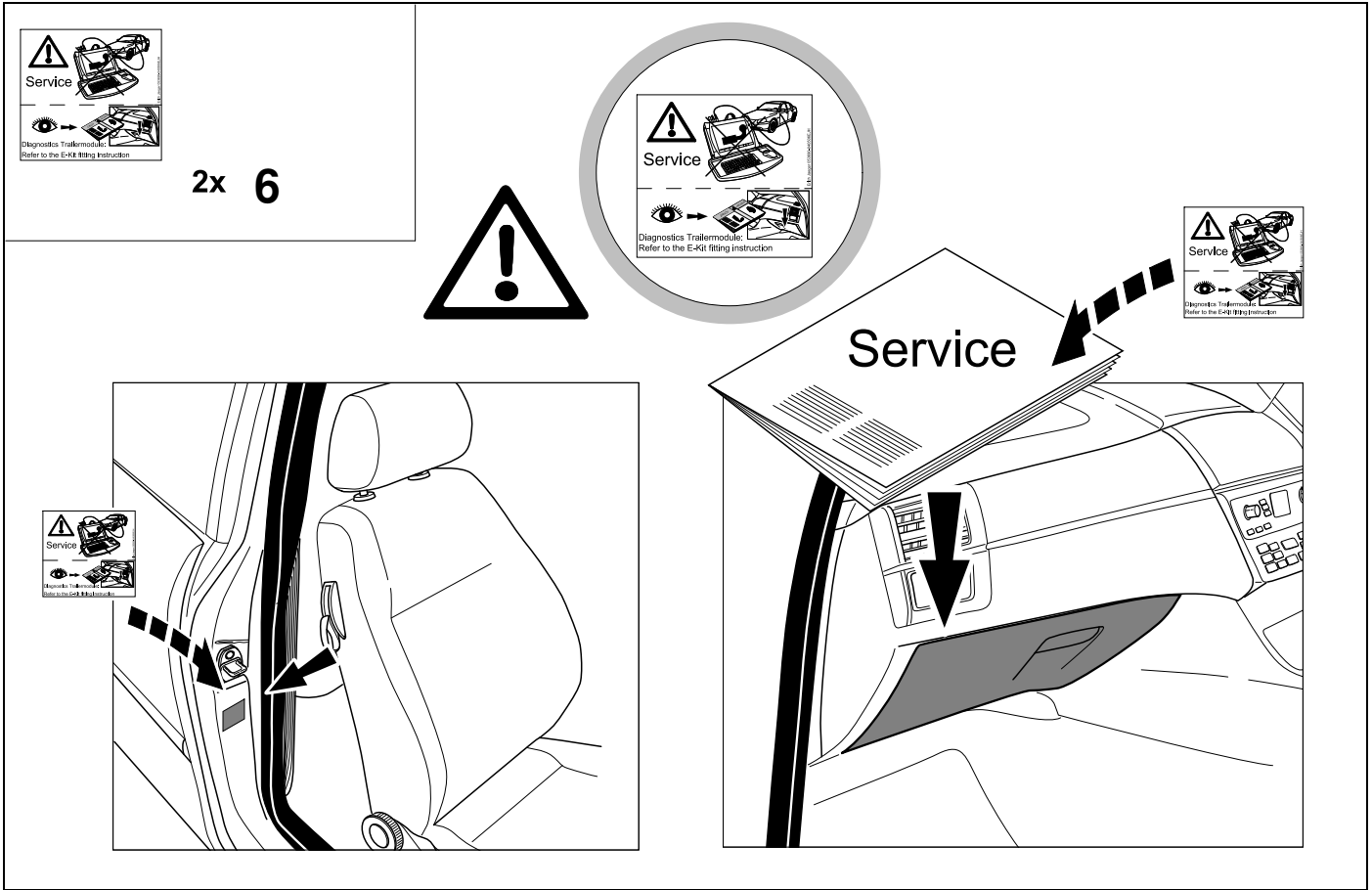

Subject to change in terms of construction, equipment and colour, and may contain errors.
The information and illustrations are non-binding.

Status LED for self-diagnosis

Operation Support

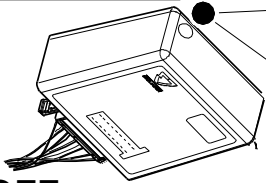
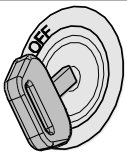

No CAN-Data =



Standby / Sleepmode



Ignition OFF

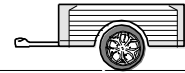
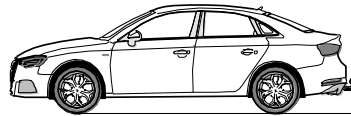
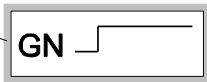
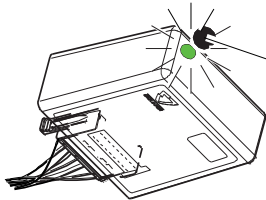

Ignition ON

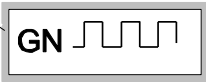
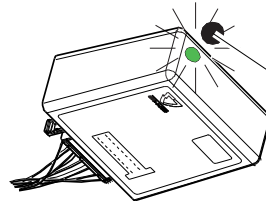

Ignition ON

Failure Support

CAN-Data Wire



1x max. 5 min.

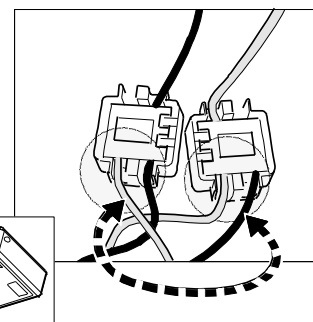
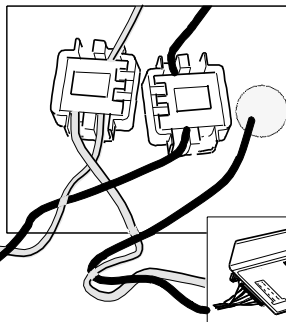
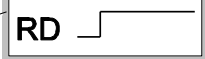
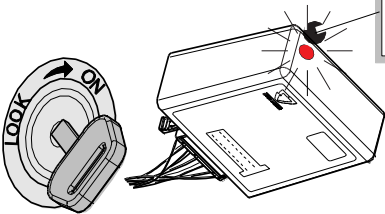

Ignition ON

Failure indicated by the module LED glowing red for a maximum of 5 minutes. If trailer connected the tail lights will also glow indicating failure of CAN signal.

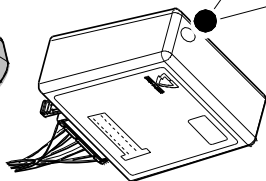
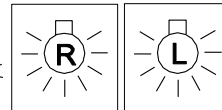

or

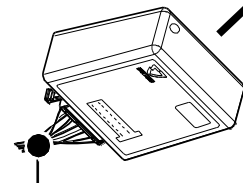
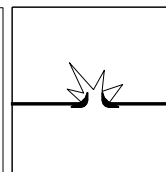
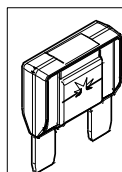
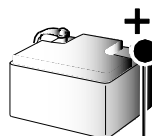
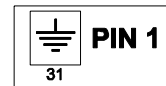

Ignition ON