

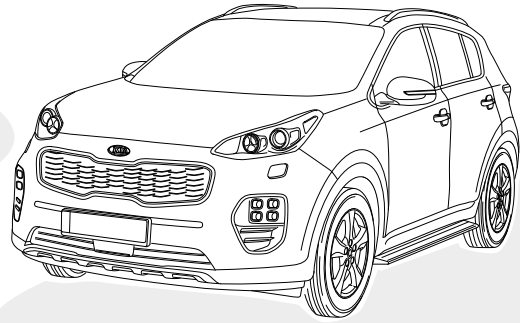

ERICH JAEGER

Installation instructions

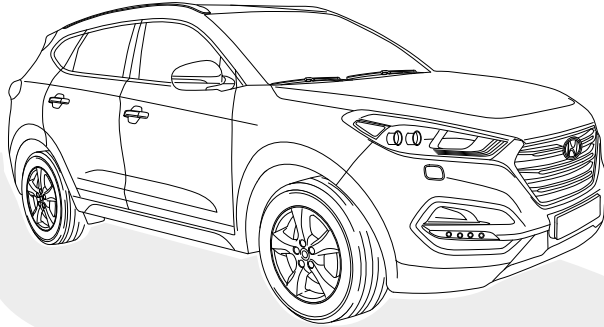

750064EJ

HYUNDAI Tucson
KIA Sportage

07/15 >>

01/16 >>



SCAN FOR
LATEST
INSTRUCTIONS

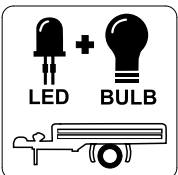
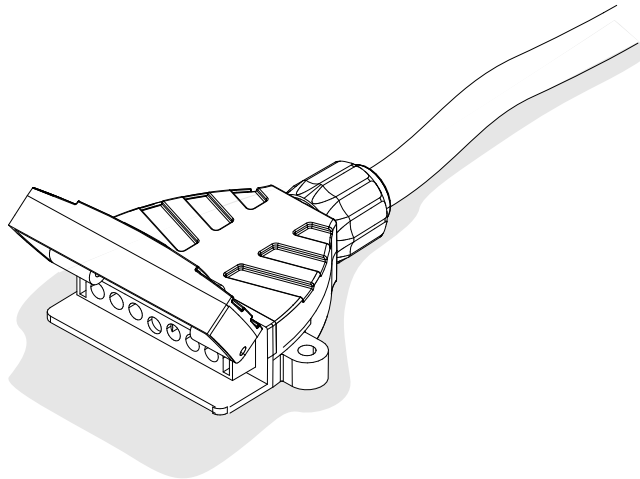

Reference:

The following information must be reviewed before beginning the assembly:

The installation instructions are to be thoroughly read.

The installation should be carried out by qualified personnel with the relevant technical knowledge. The vehicle manufacturers' current technical notices and information on retrofitting must be followed. The removal and replacement instructions found in the current repair manuals must be followed.

It must be ensured that the vehicle is technically suitable for the installation of a trailer hitch.

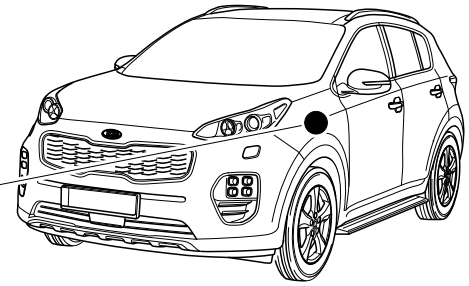
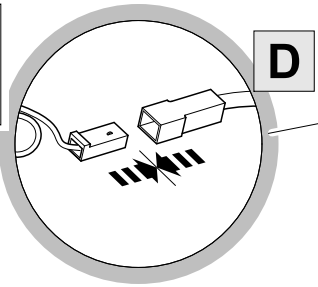
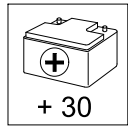

OPTION 1

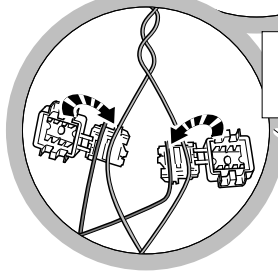
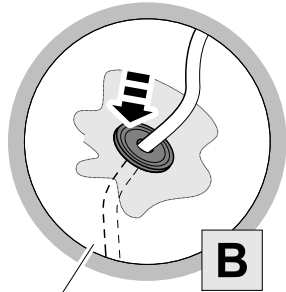
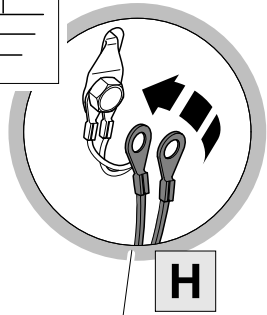
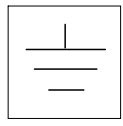
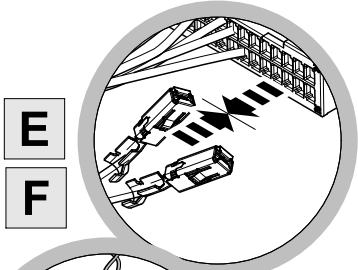

CAN

OPTION 2

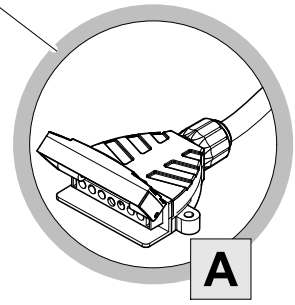
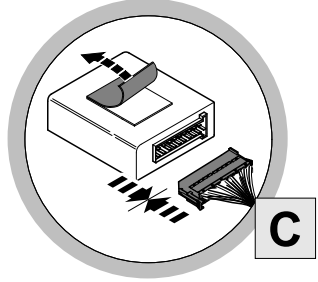
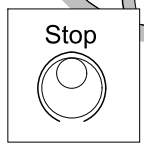
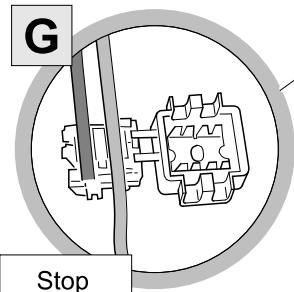
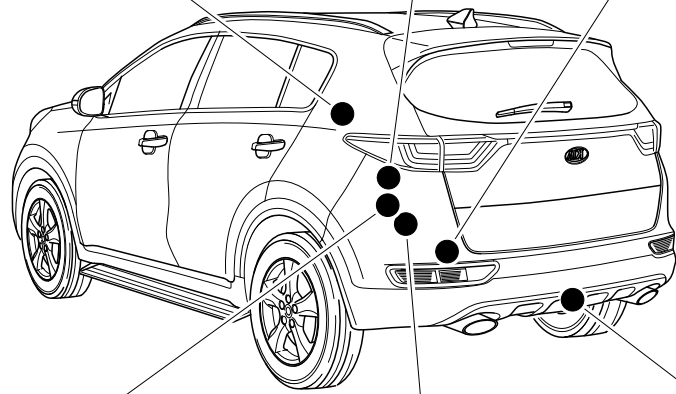

KIT

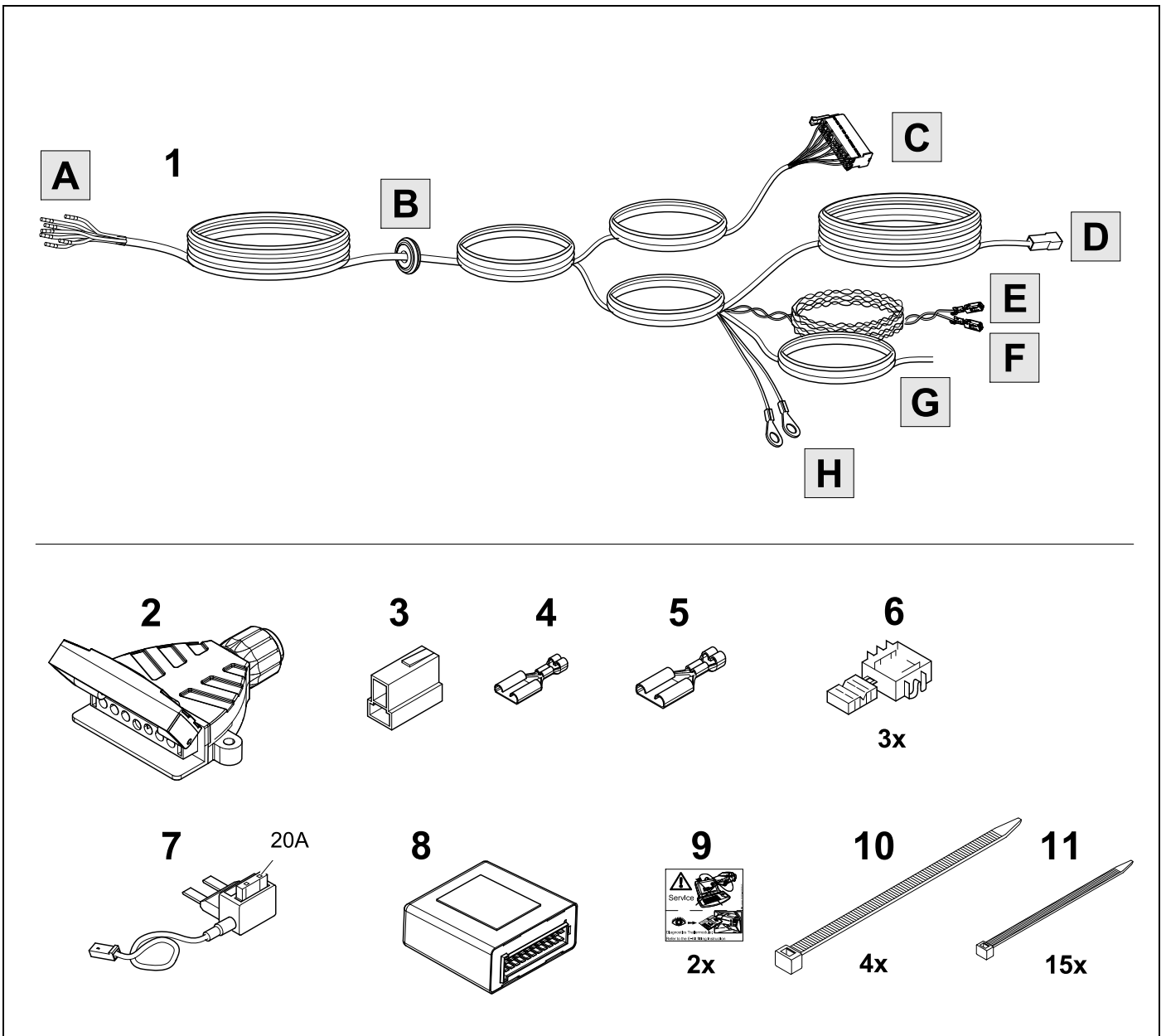

TOOLS

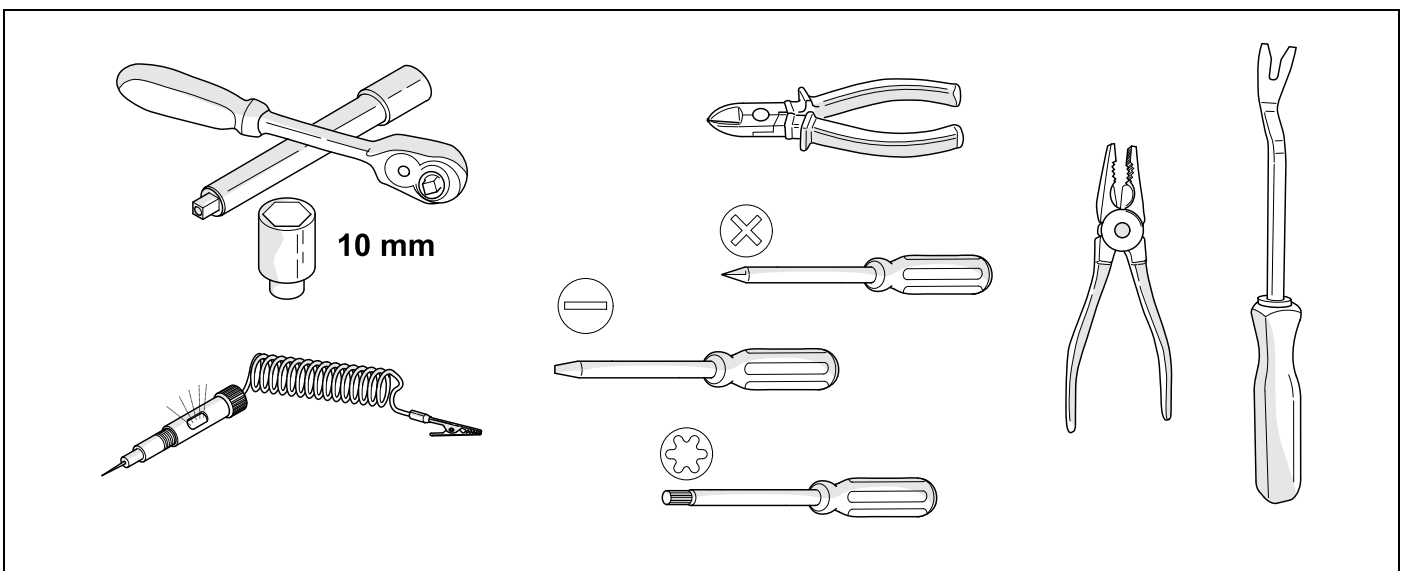

1

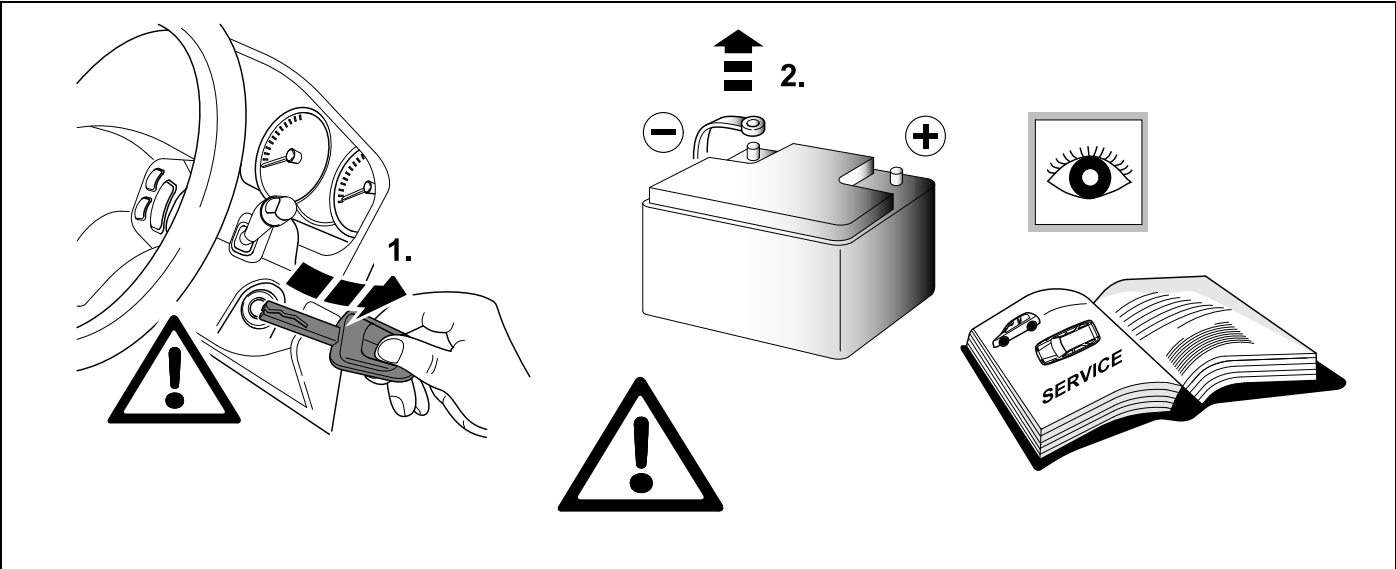

2

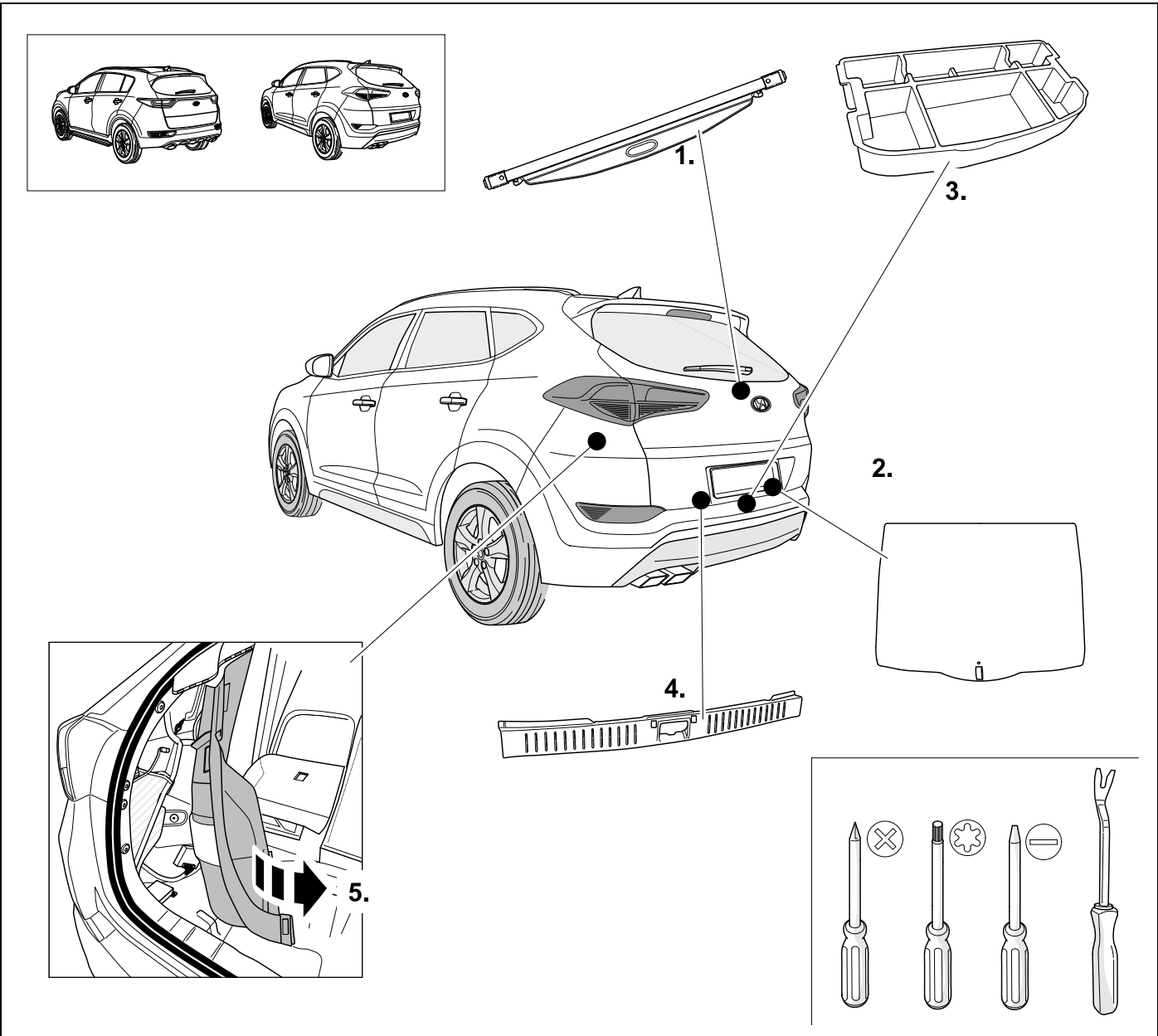

3

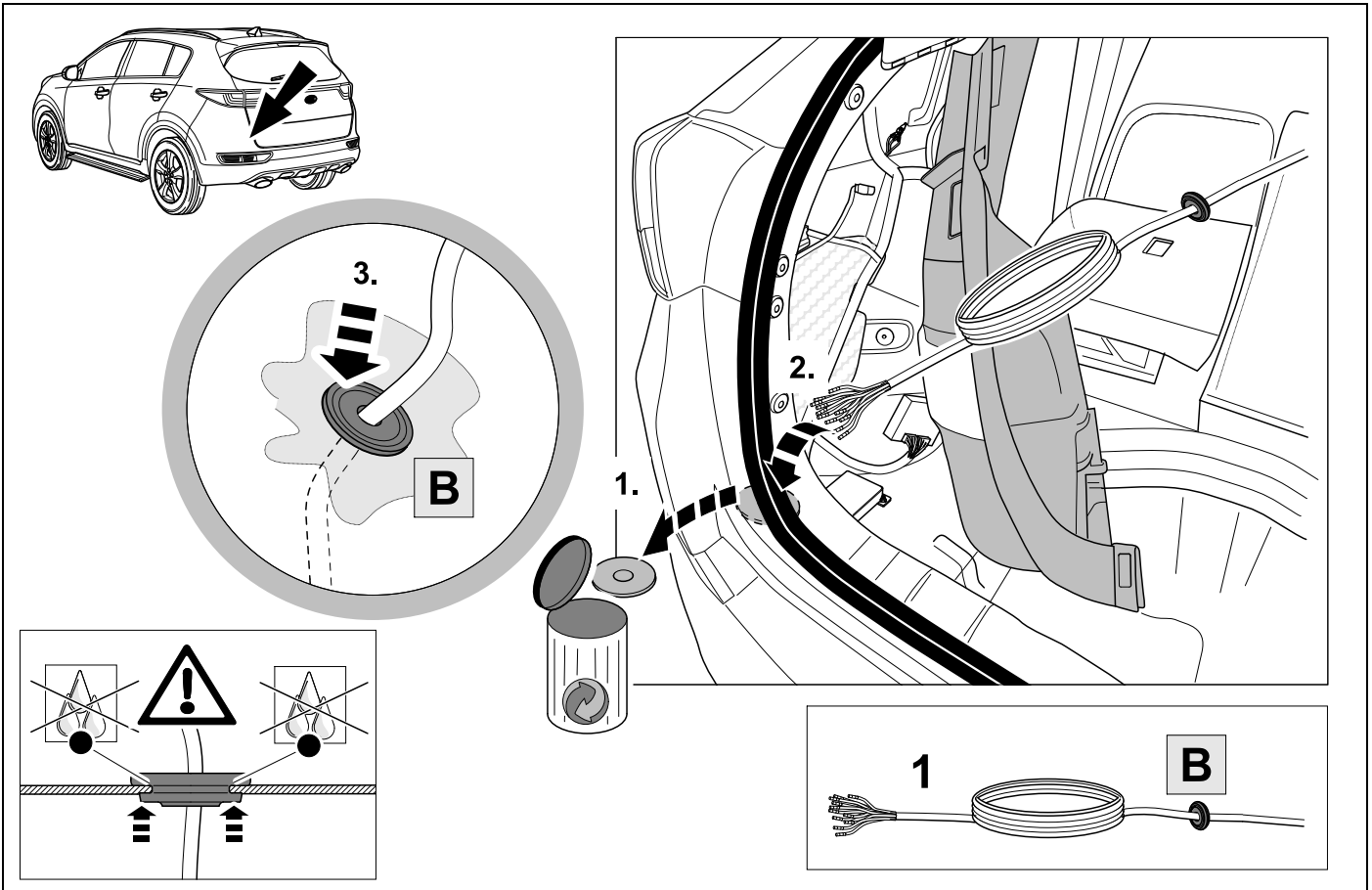

4

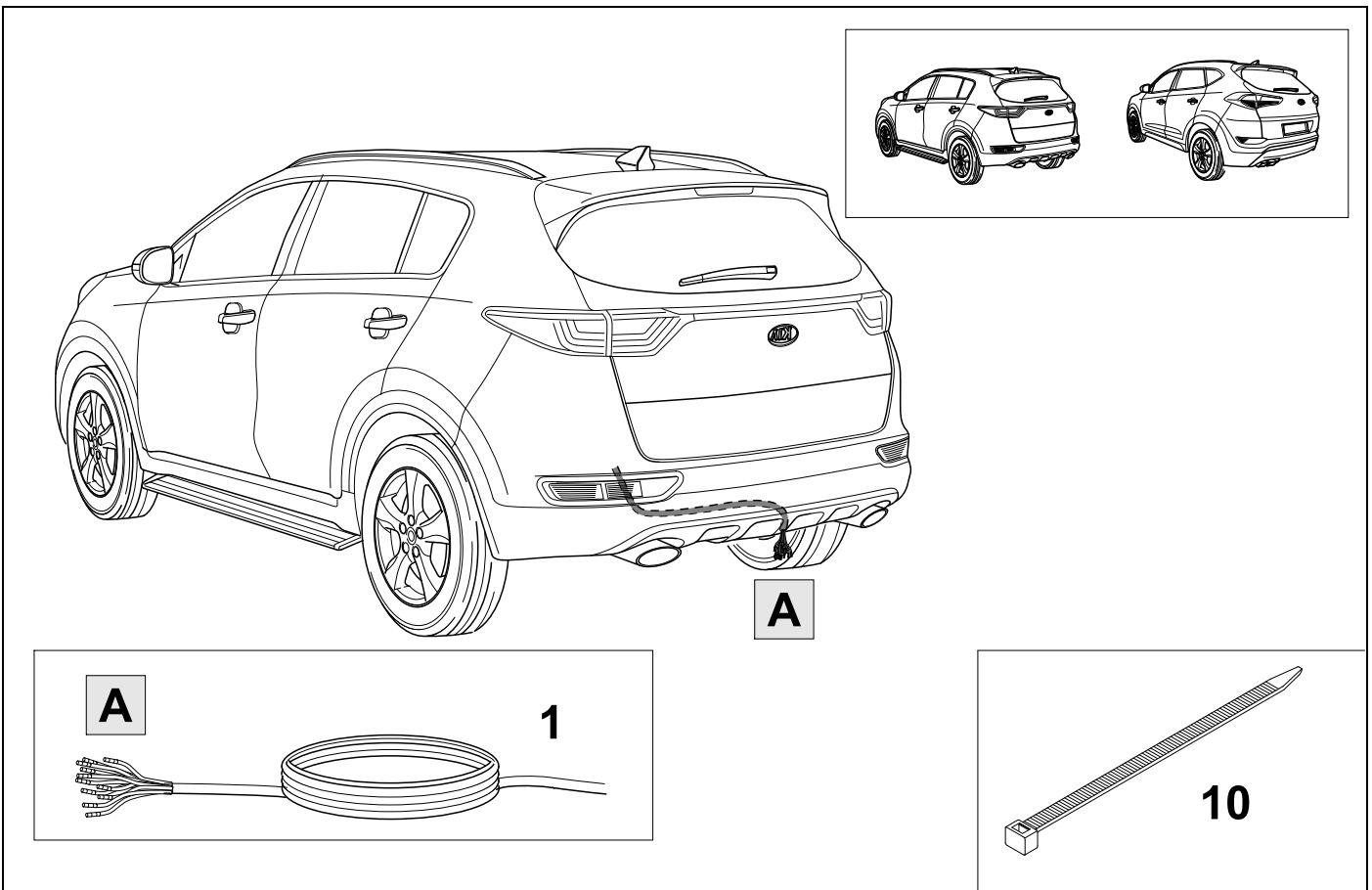

5



7

gn	4	
bn	7	
bk	2	
wh	3	
bu	5	
rd	6	
ye	1	

1.

2.

3.

4.

5.

6

2.

1.

7



1	ye	
2	bk	
3	wh	
4	gn	
5	bu	
6	rd	
7	bn	

8	bk	wh	gy	gn	rd	bu	ye	bn	pu	or	no
---	----	----	----	----	----	----	----	----	----	----	----

	black	white	grey	green	red	blue	yellow	brown	purple	orange	not occupied
--	-------	-------	------	-------	-----	------	--------	-------	--------	--------	--------------

9

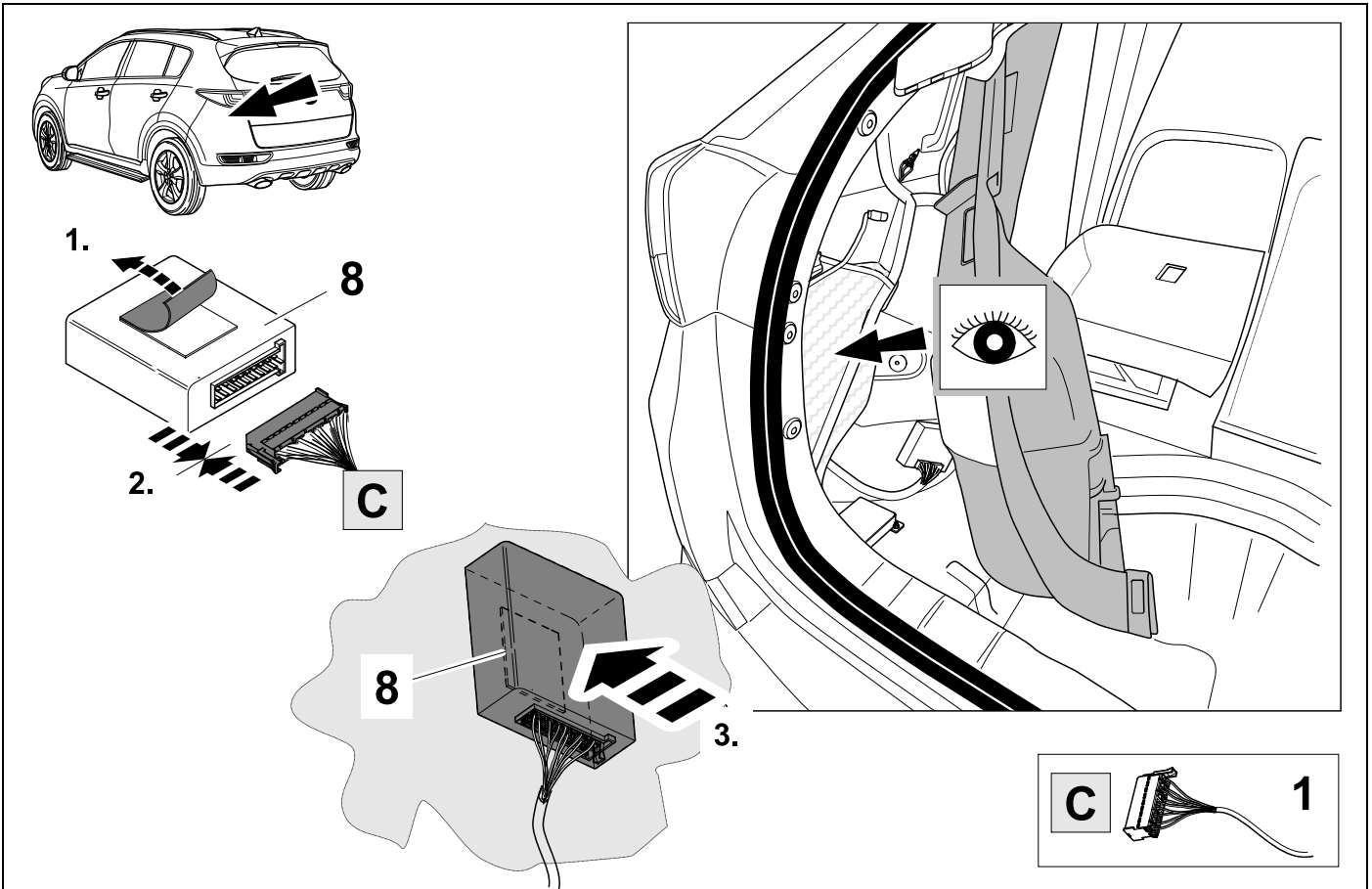

10

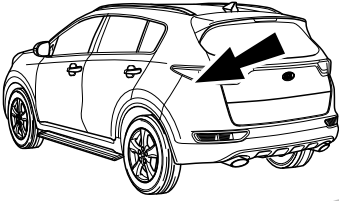

Ground!

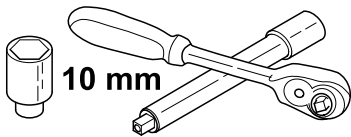
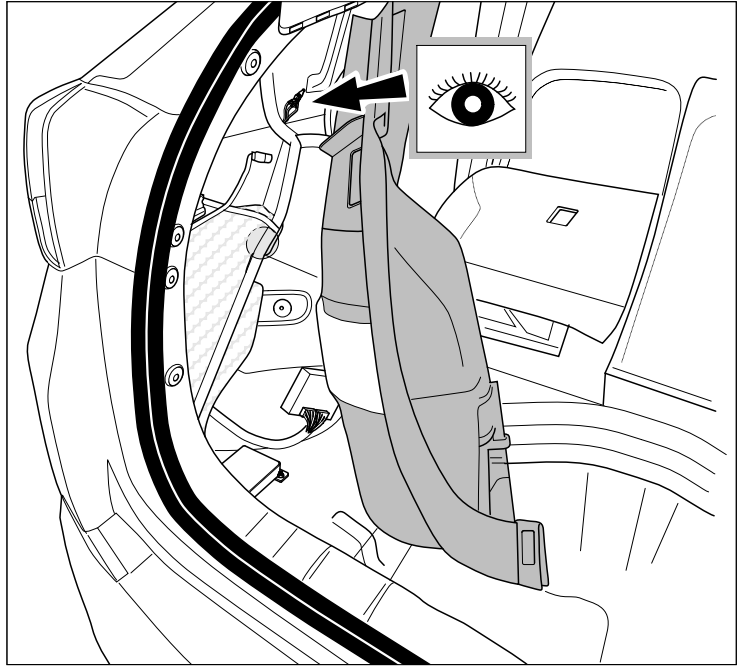
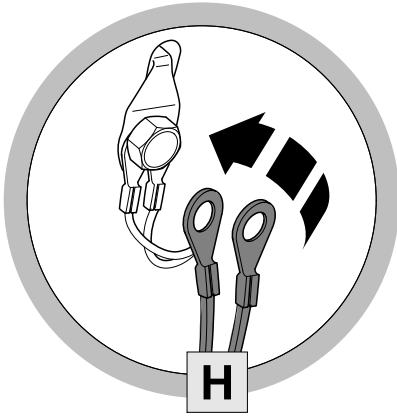
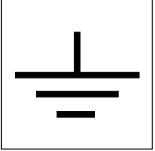

10 mm



11



8

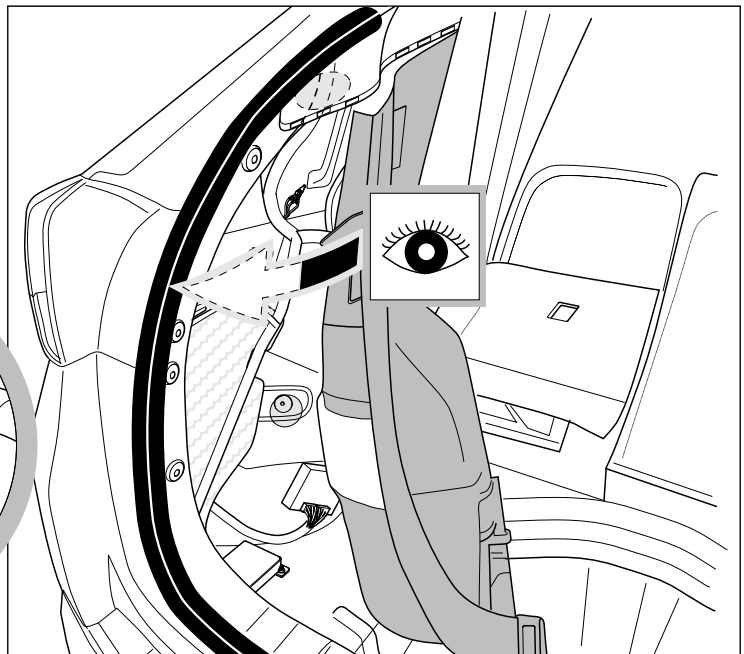
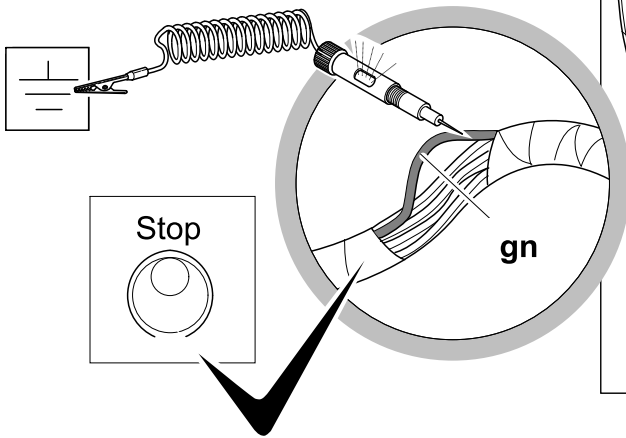
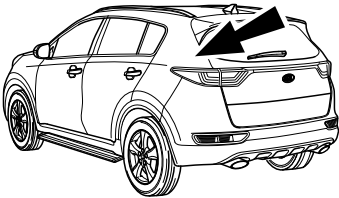

12



8

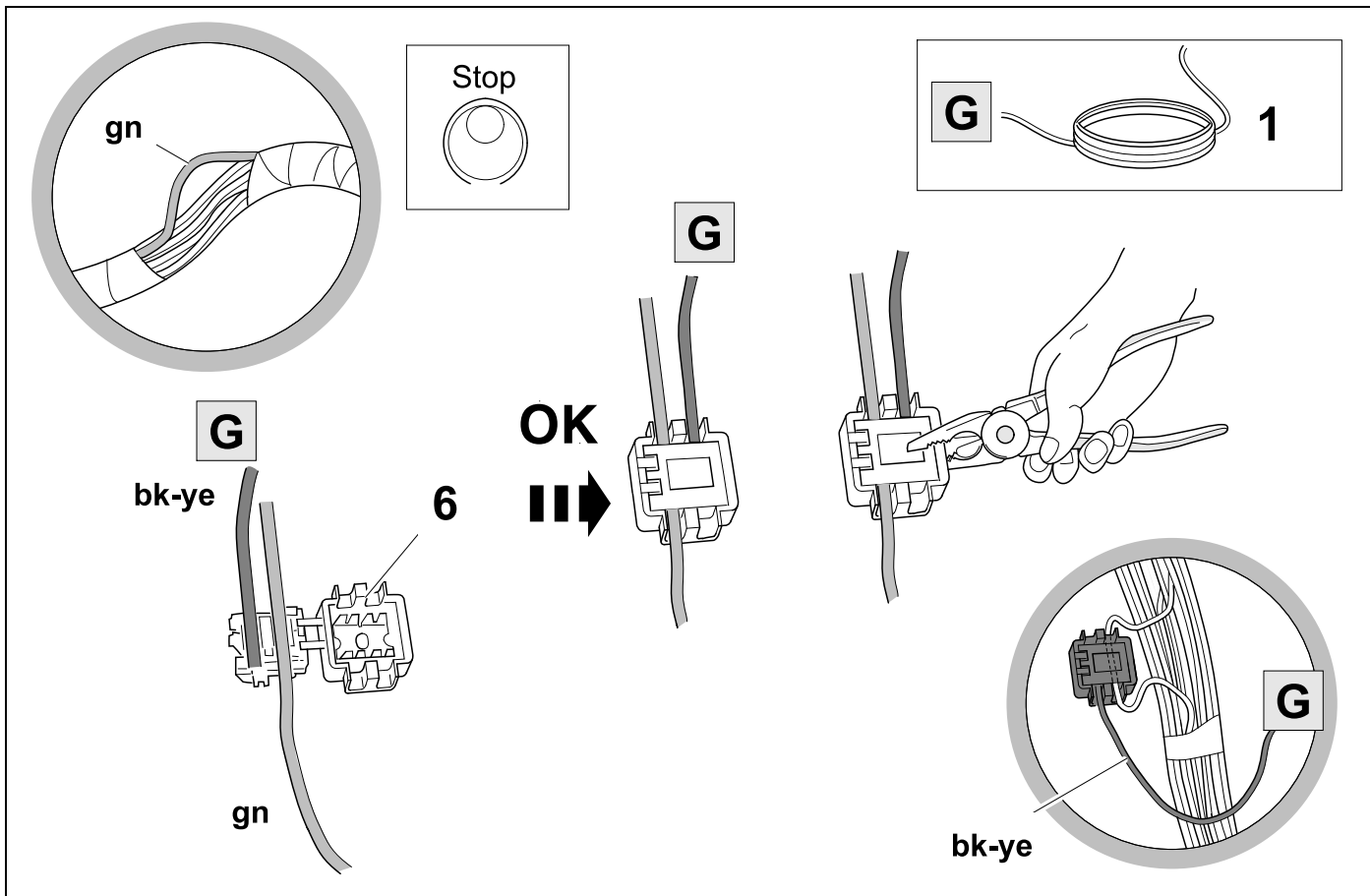

13

SPORTAGE 01/16 >> 09/18

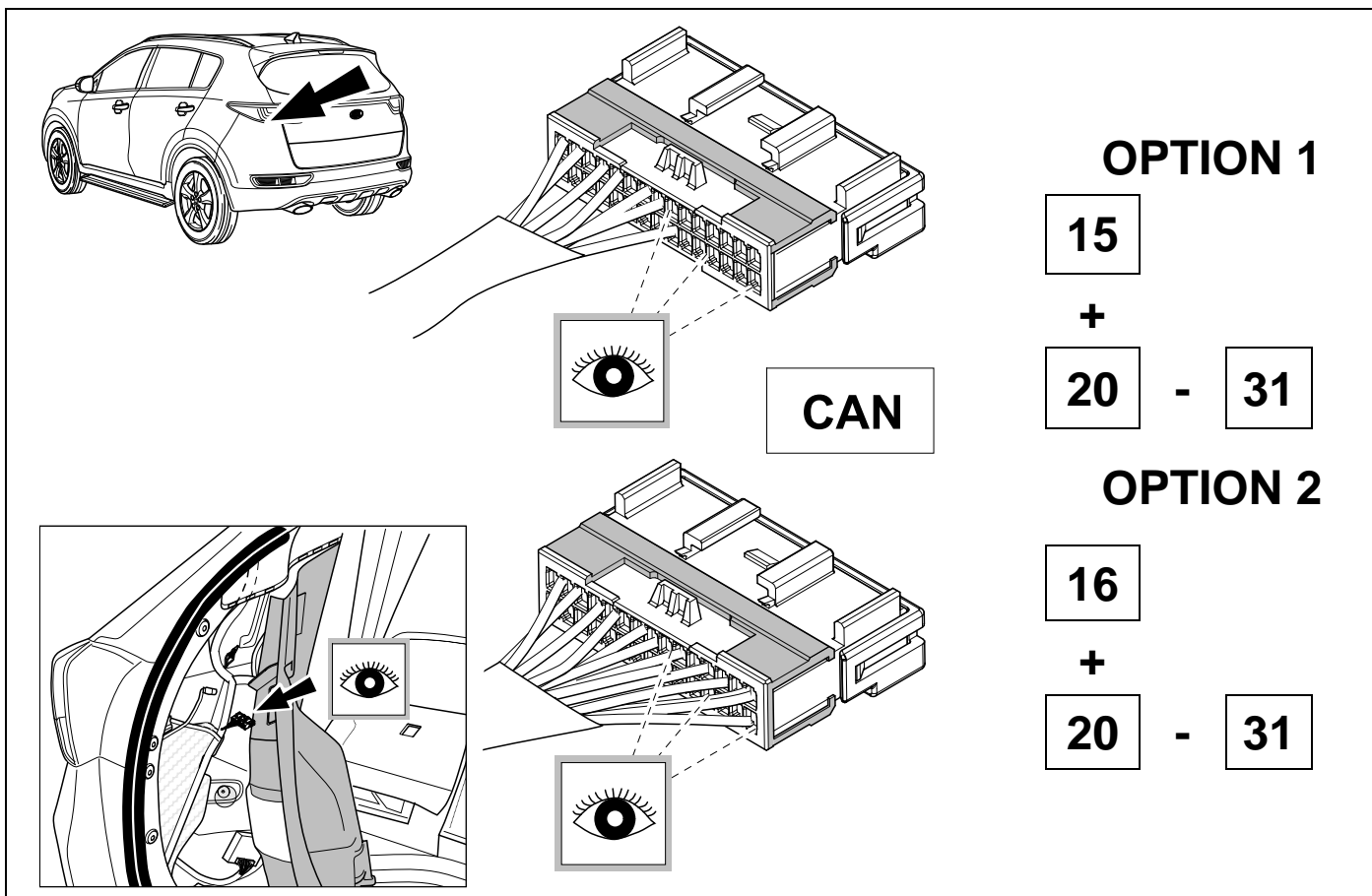

14



9

SPORTAGE 10/18 >>

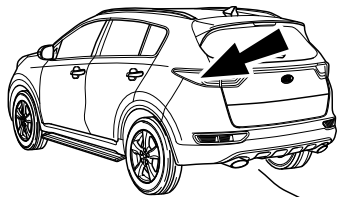

CAN

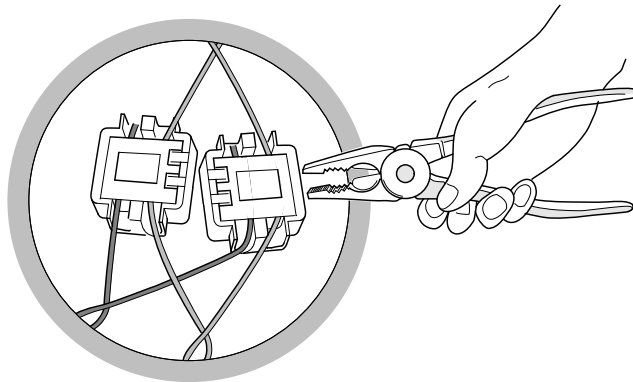
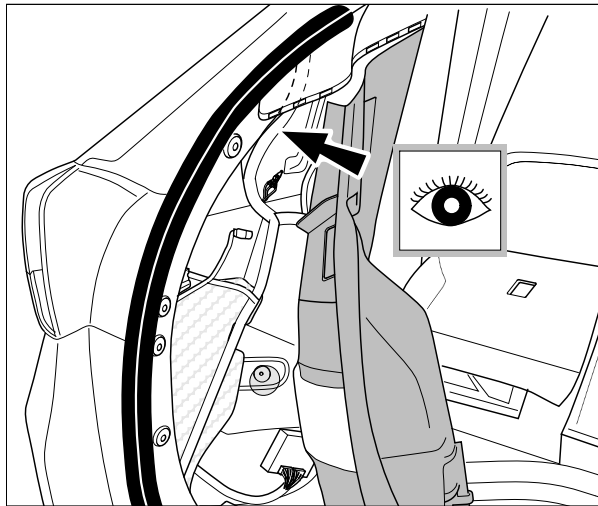
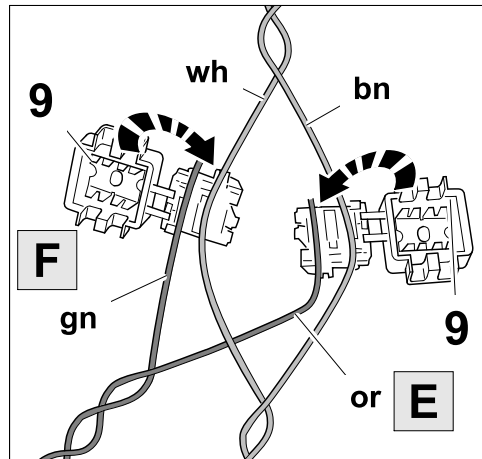
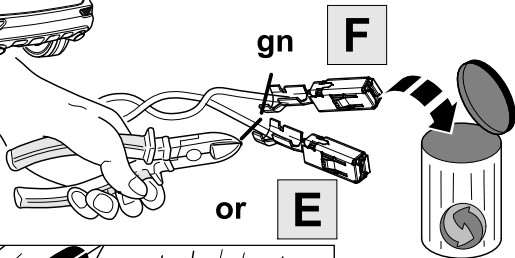

15 OPTION 1



9

SPORTAGE 01/16 >> 09/18

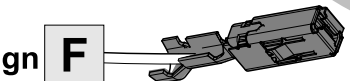
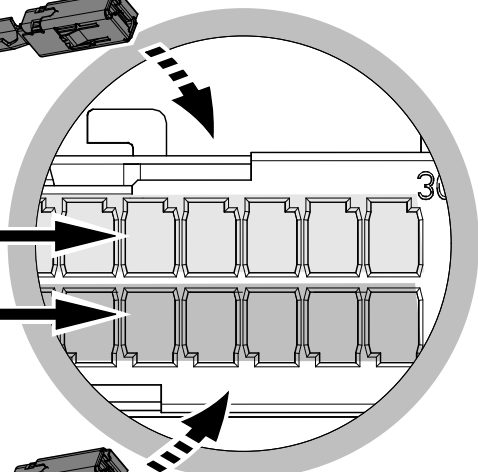
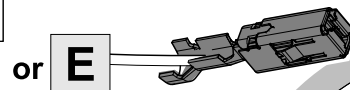
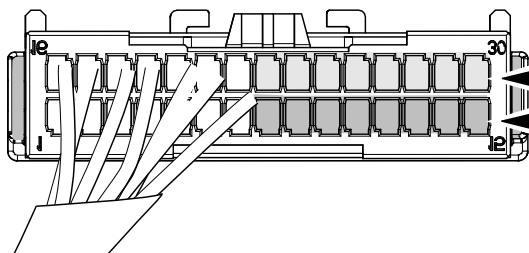
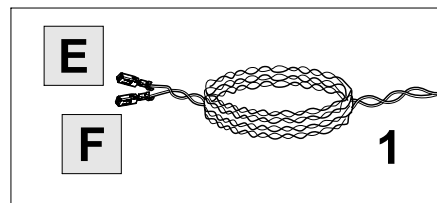
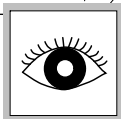
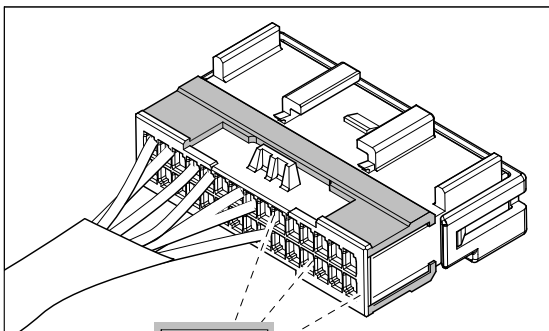

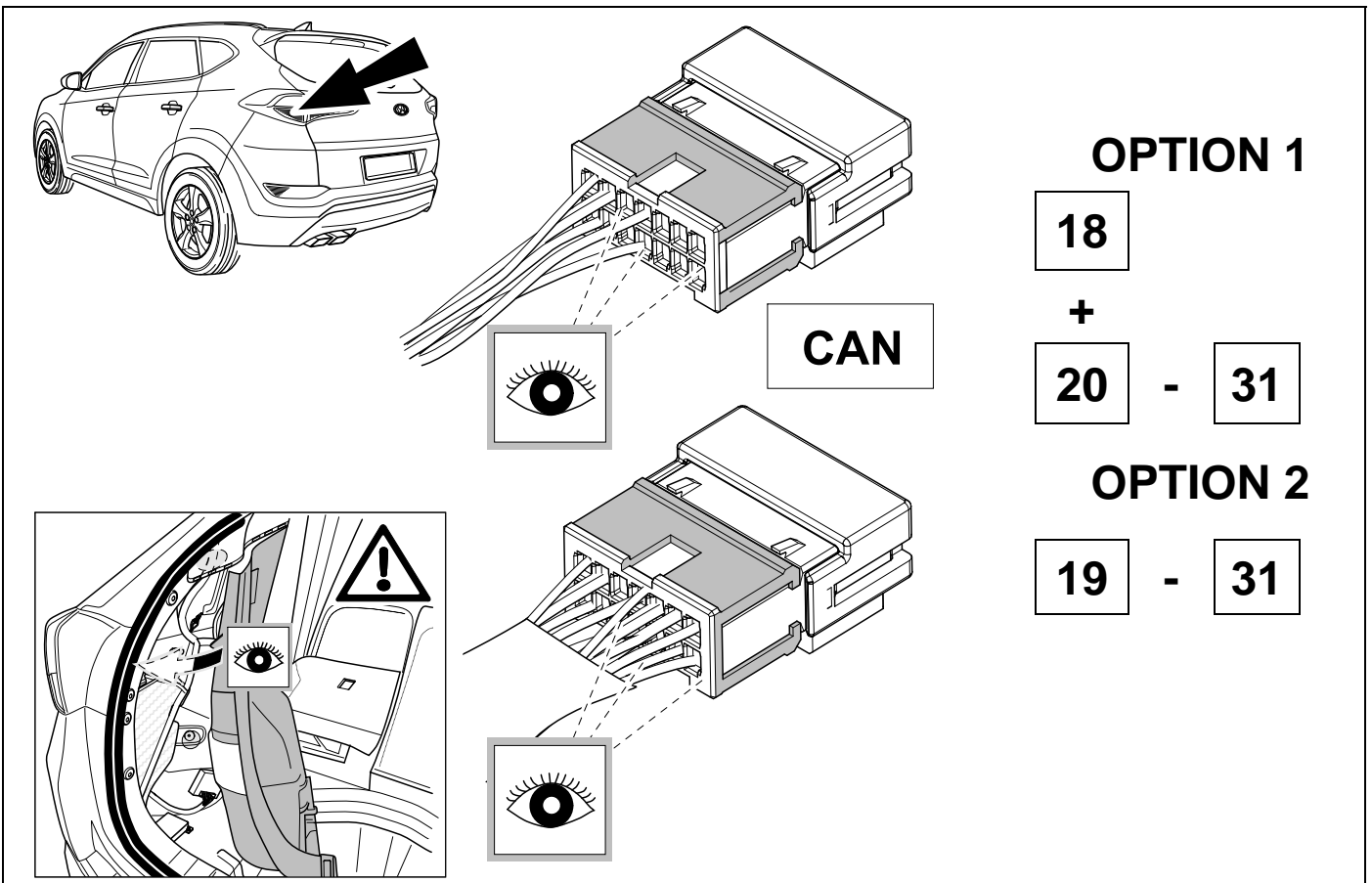
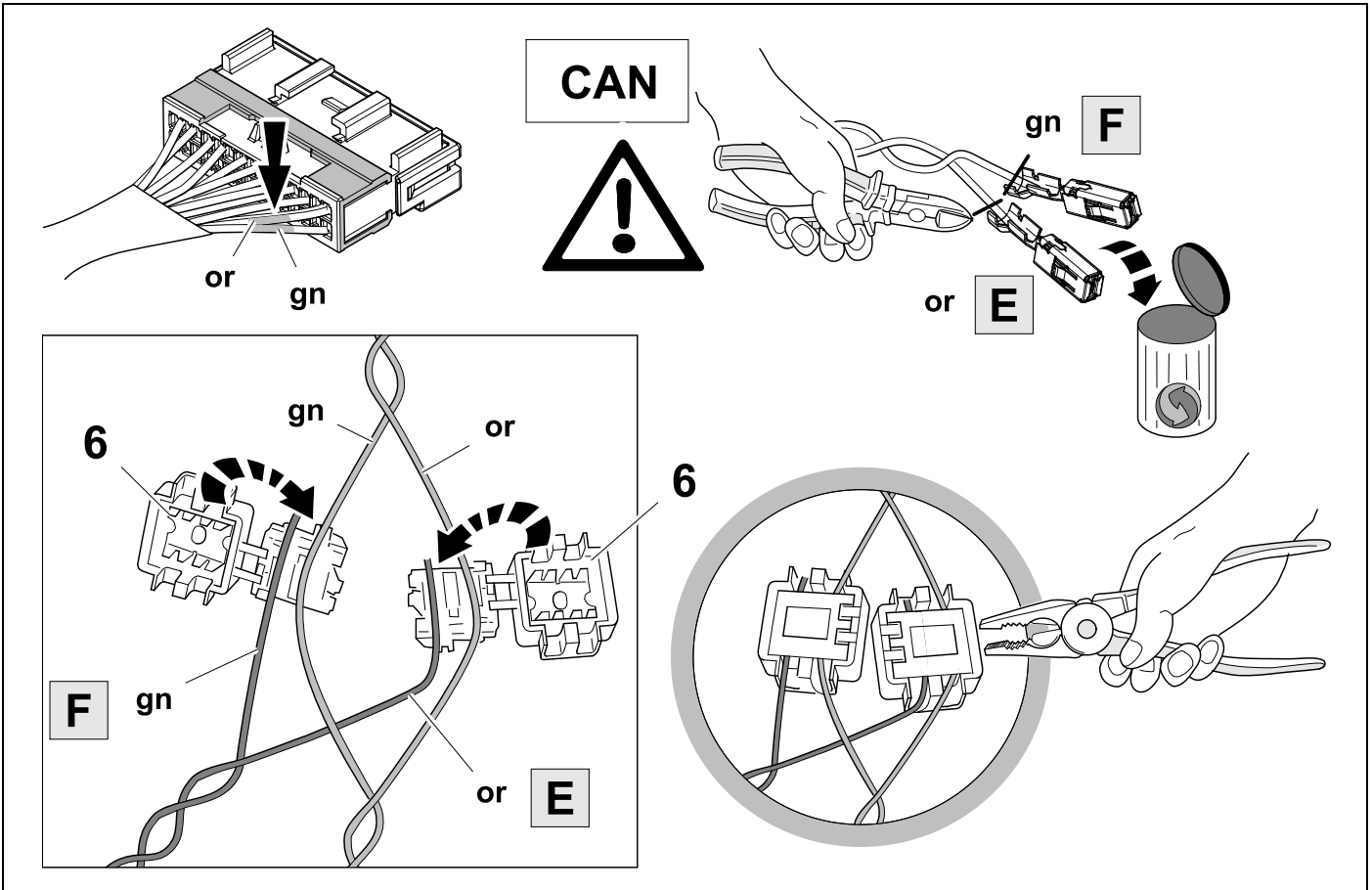

18 OPTION 1

TUCSON

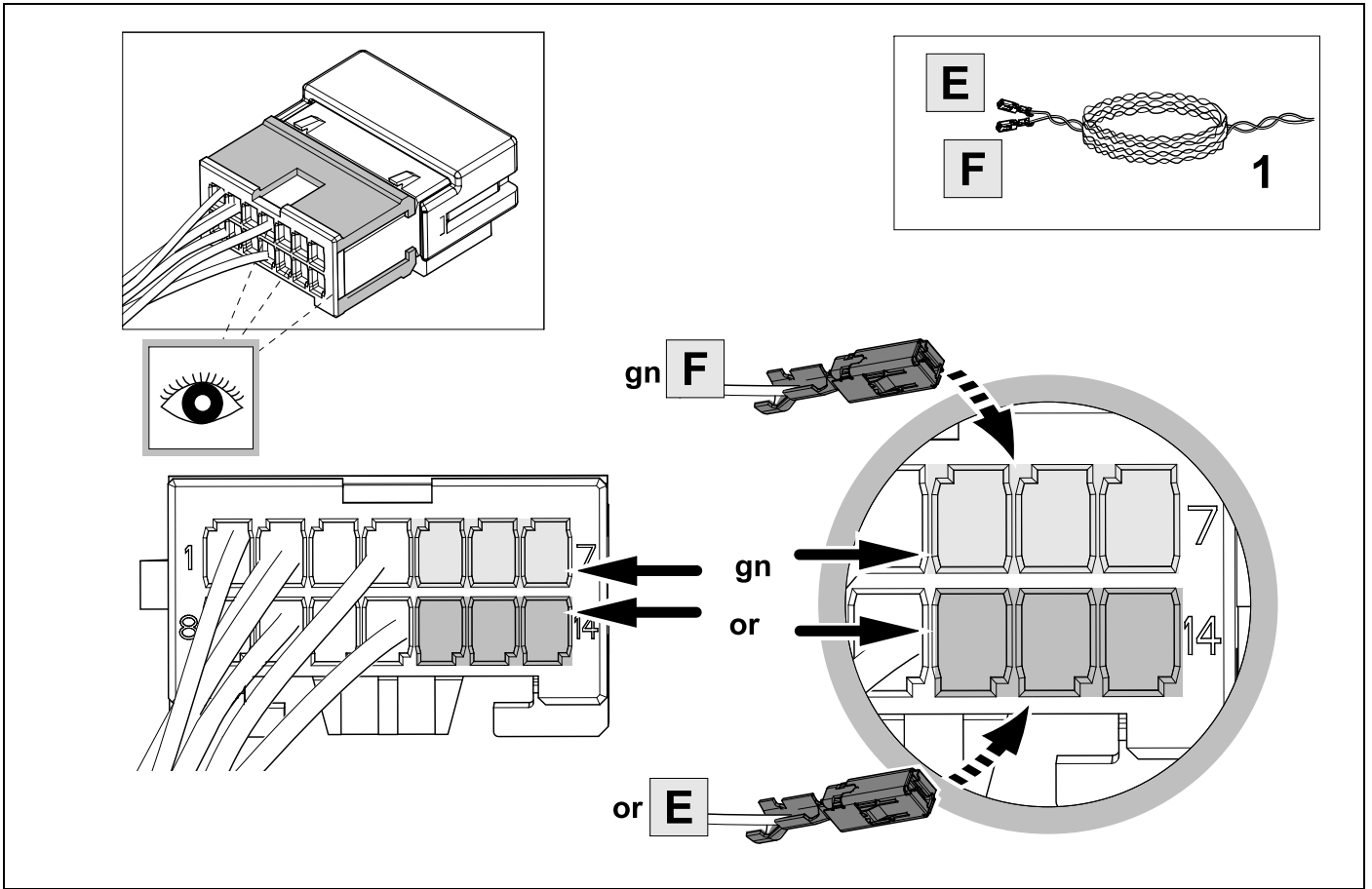

19 OPTION 2

TUCSON

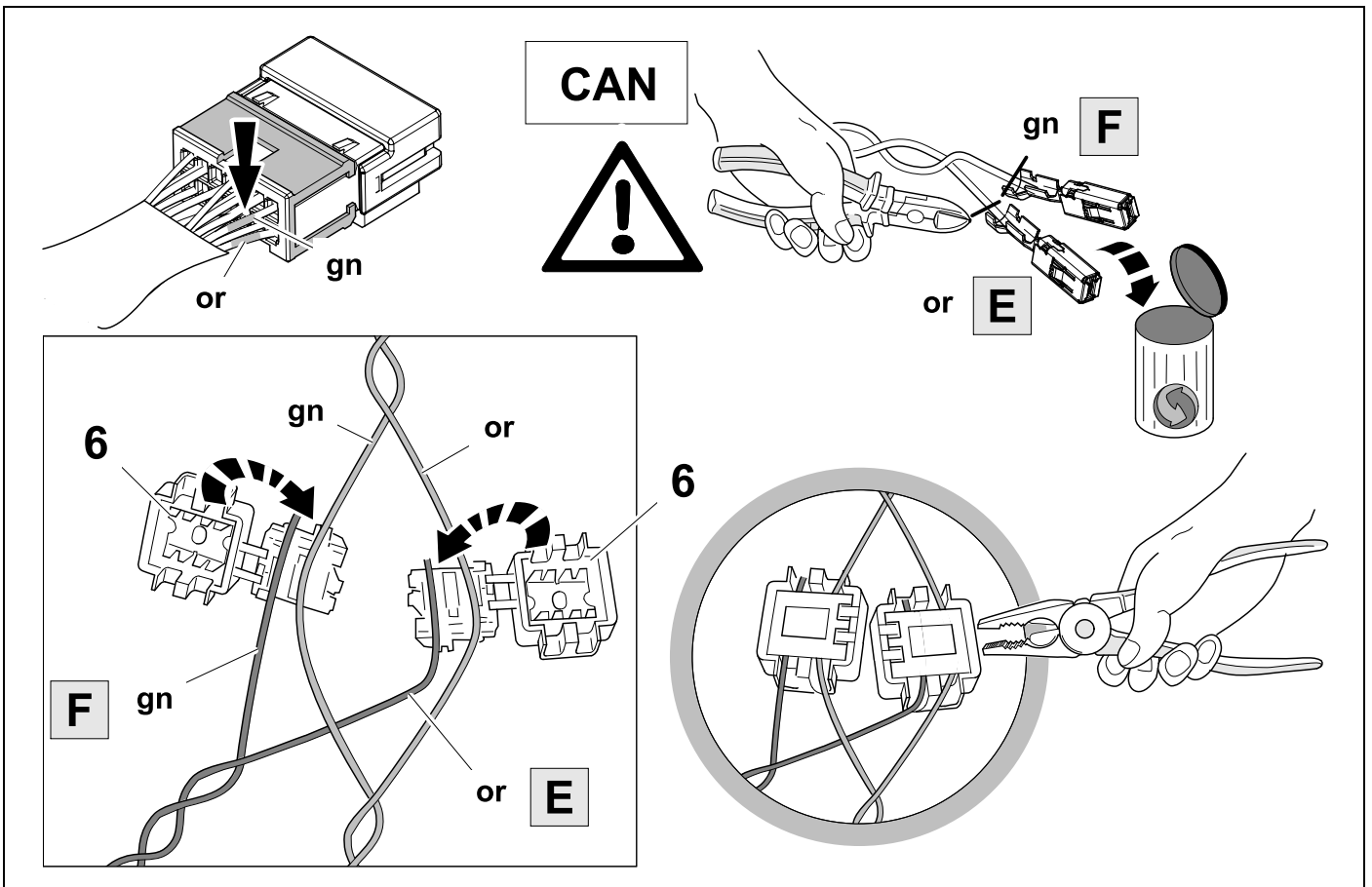

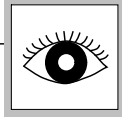
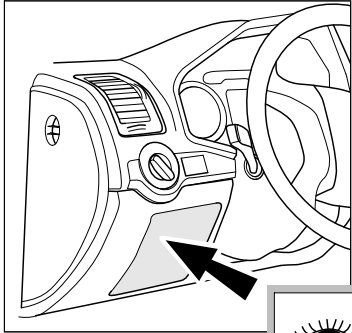

Hot all times!

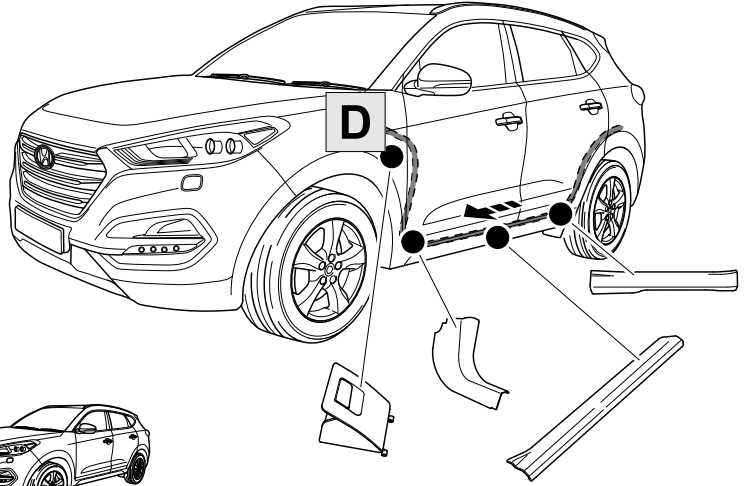
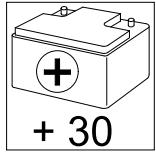

SPORTAGE

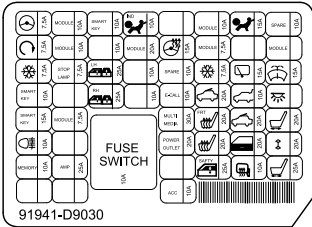

TUCSON

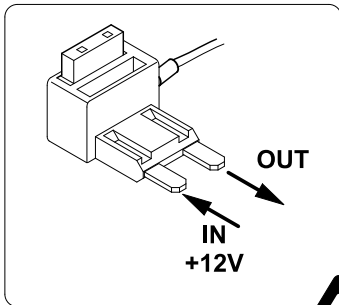
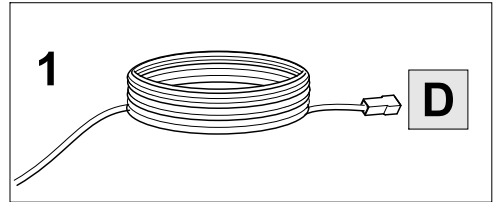
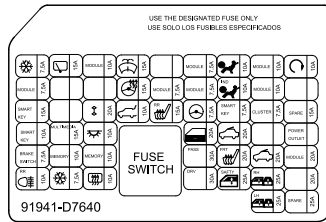

7

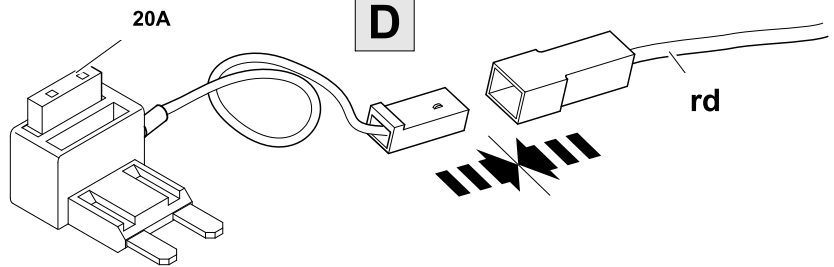

Hot all times!

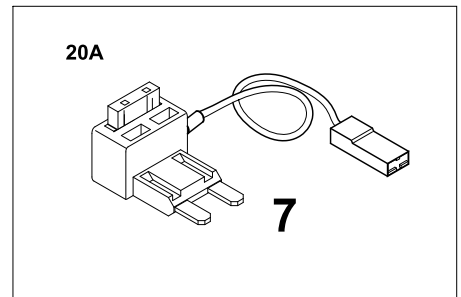
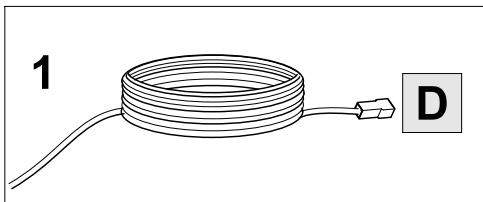
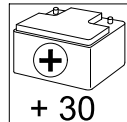

22



30

SPORTAGE 01/16 >> 09/18



Hot all times!

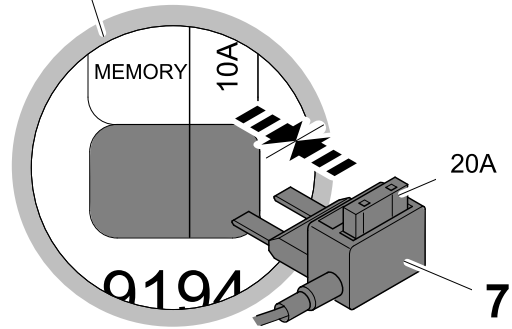
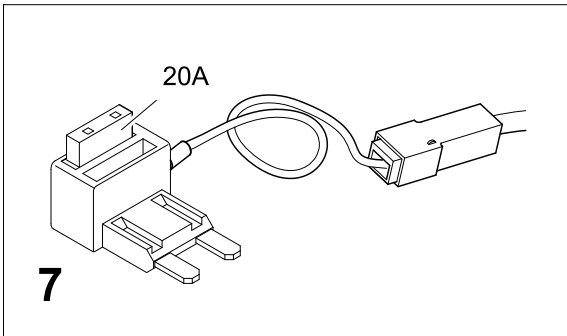
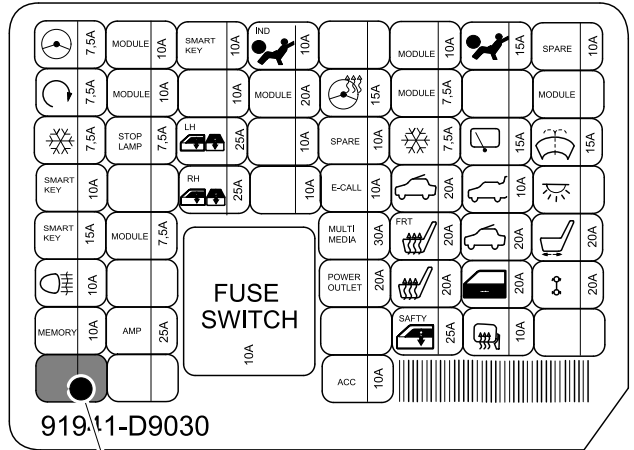
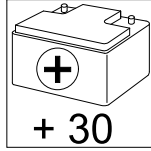

23



30

SPORTAGE 10/18 >>

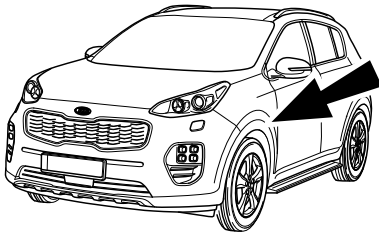

Hot all times!

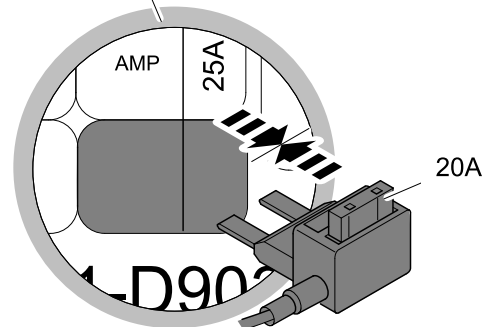
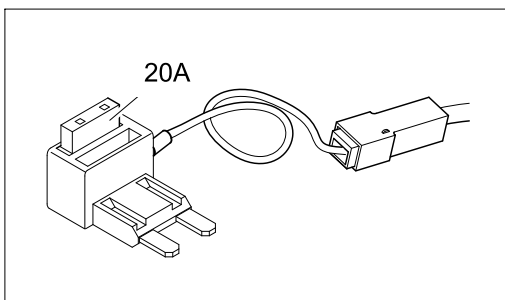
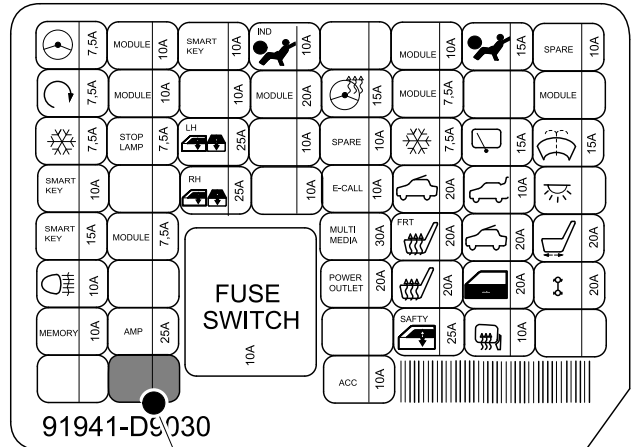
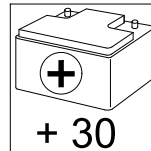

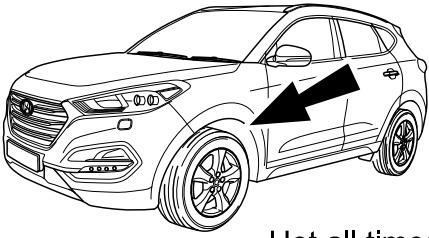

Hot all times!

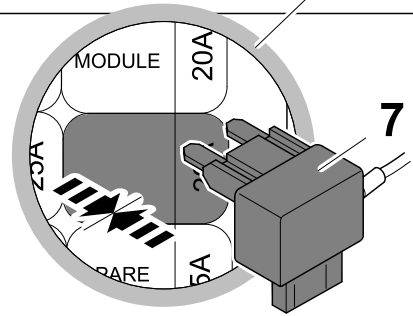
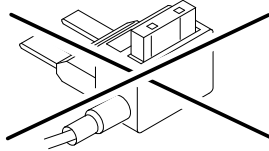
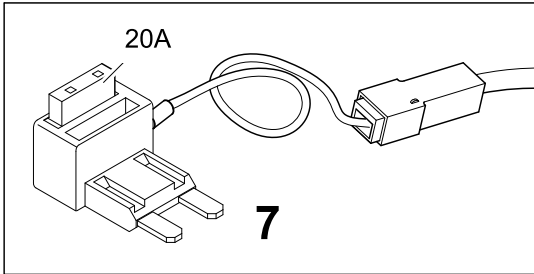
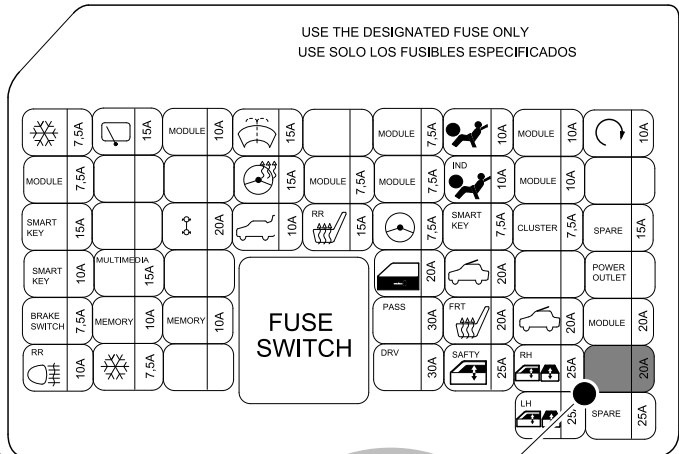
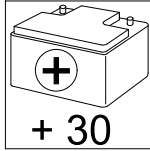

25 OPTIONAL

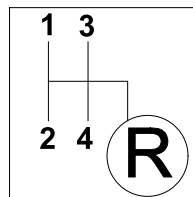
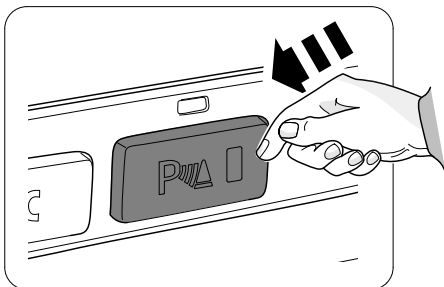
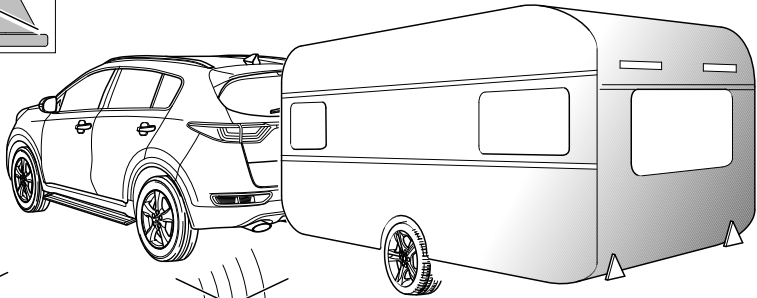
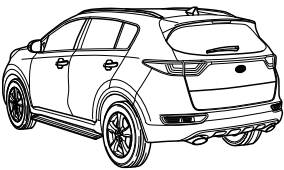
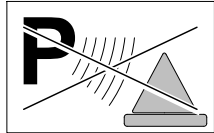



**BRAKE
CONTROLLER
PREPARED**

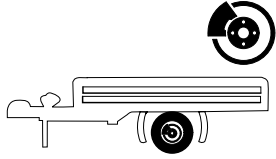

Trailer Brake Preparation

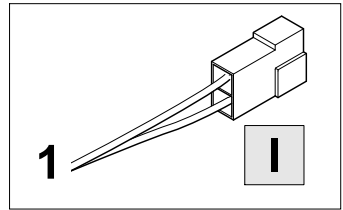

1.

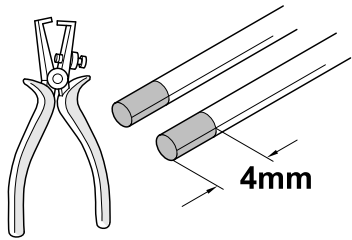

2.

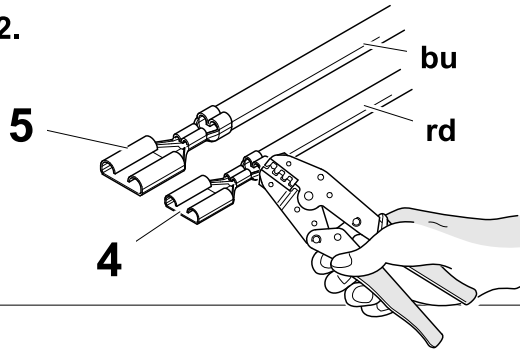

3.

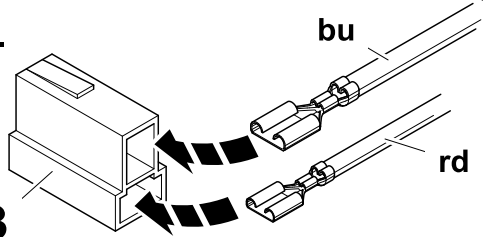

4.

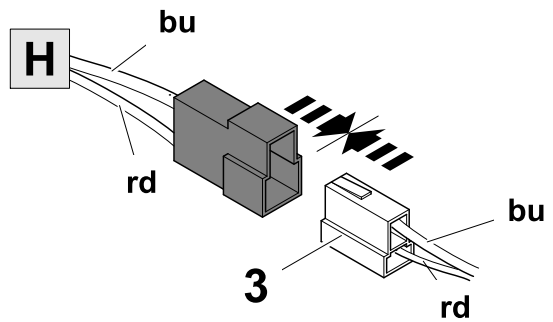

3

4

5

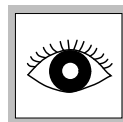
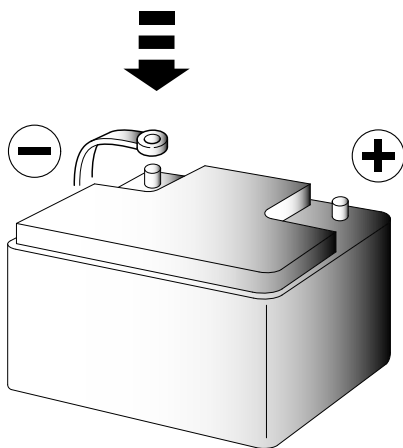
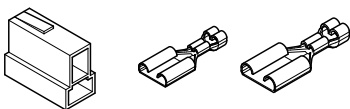

28

CHECK ALL LIGHTING FUNCTIONS

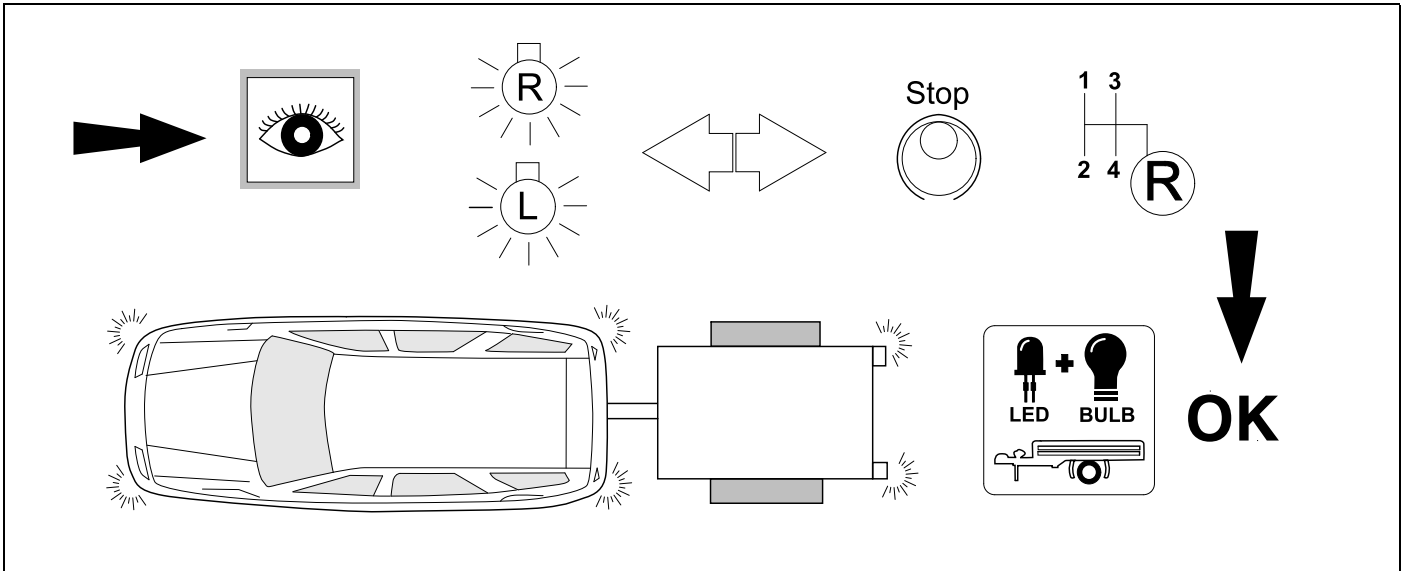

29

CHECK BULB OUT DETECTION

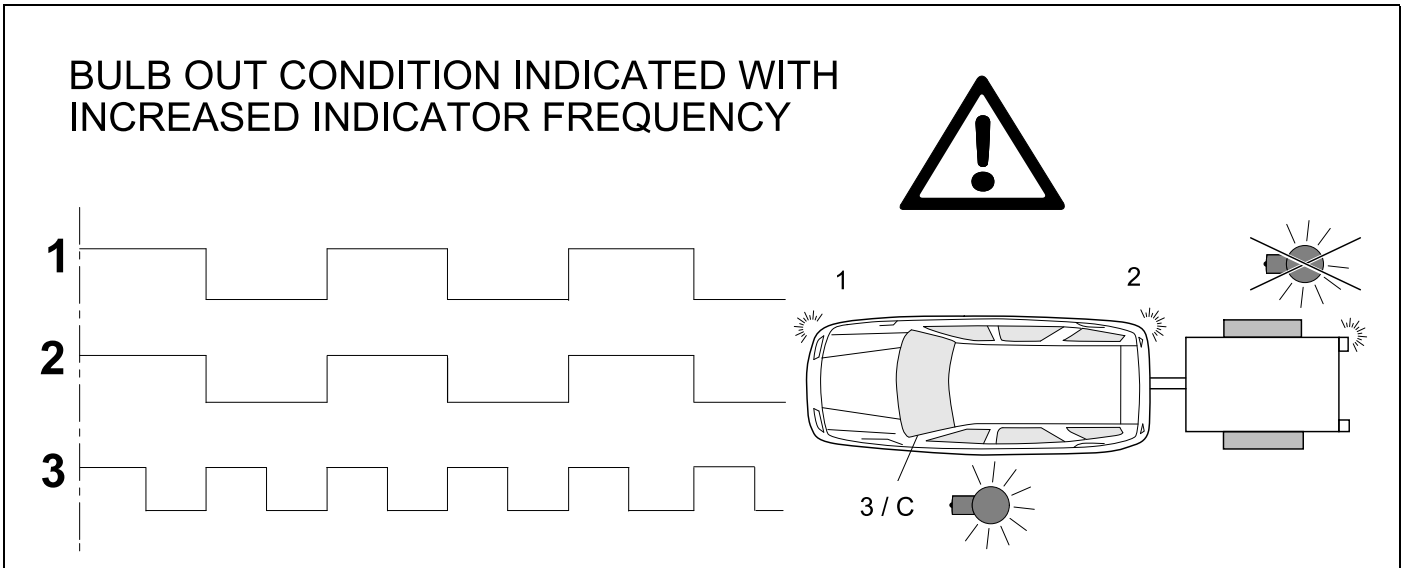

30



22

-

24

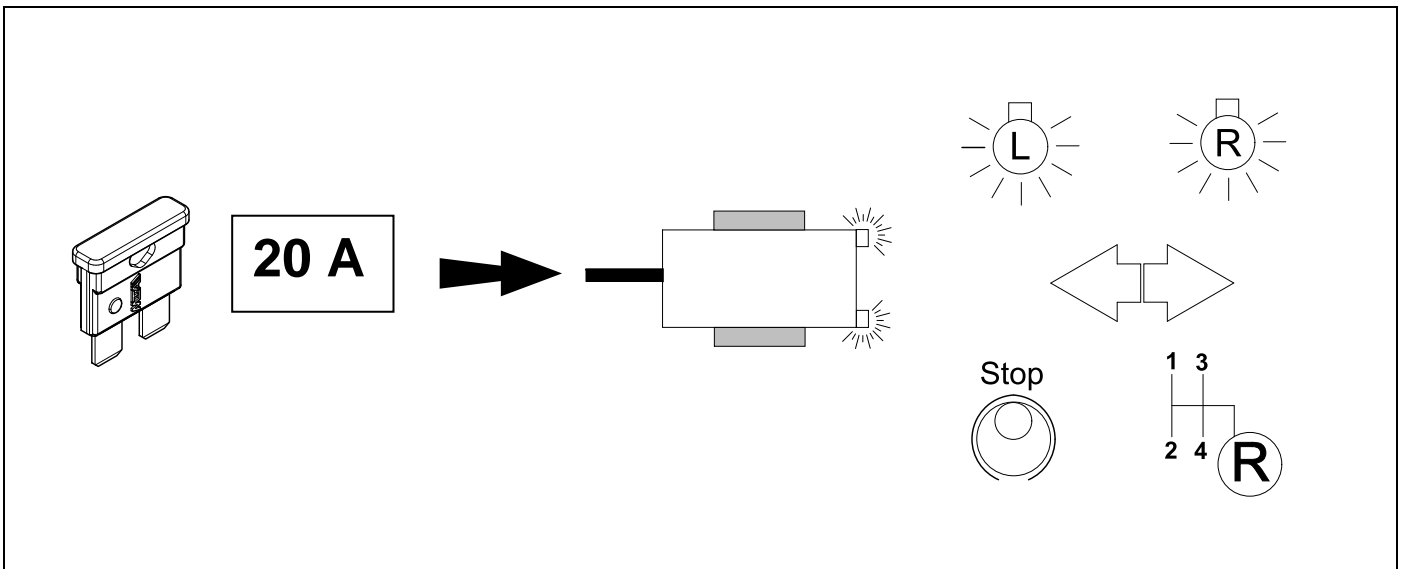

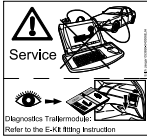

2x 9

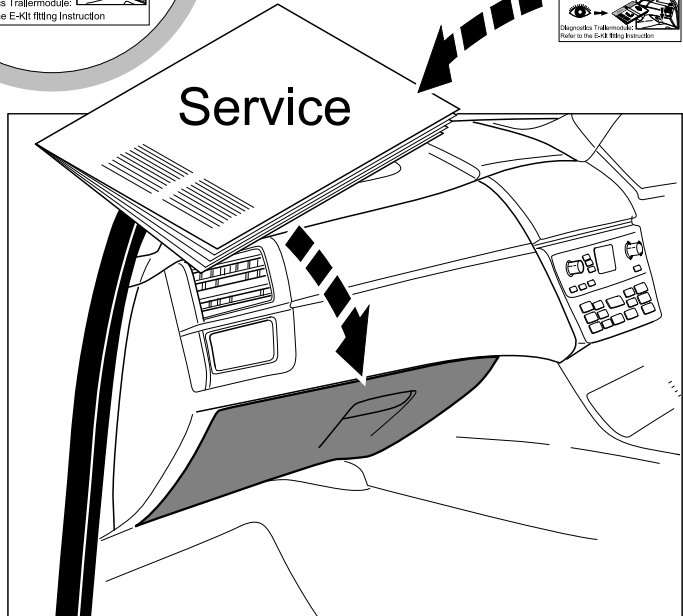
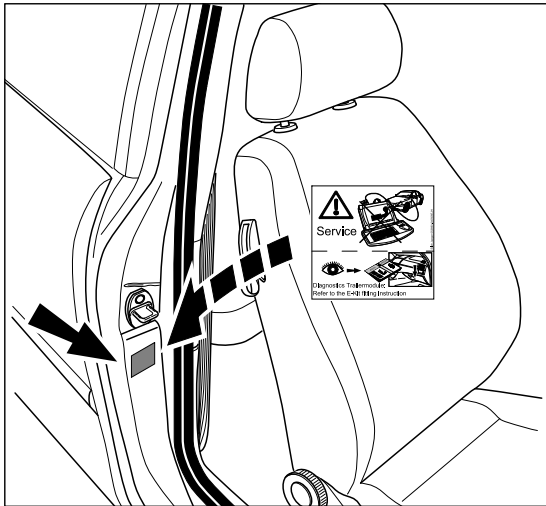
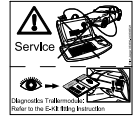
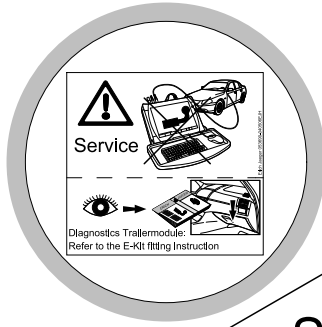

Status LED for self-diagnosis

Operation Support

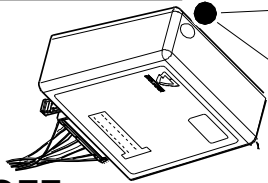
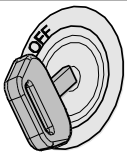

No CAN-Data =



Standby / Sleepmode



Ignition OFF

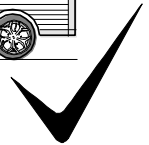
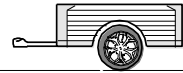
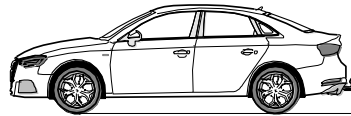
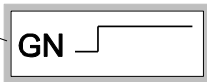
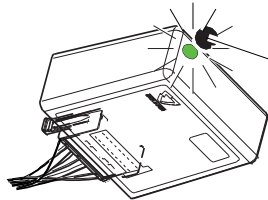

Ignition ON

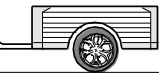
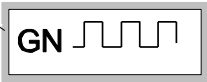
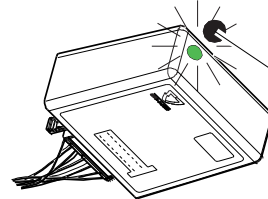

Ignition ON

Failure Support

CAN-Data Wire



1x max. 5 min.

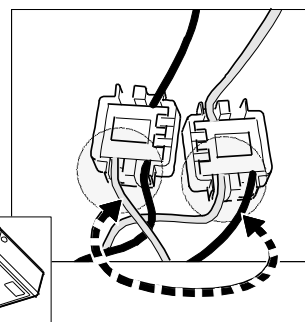
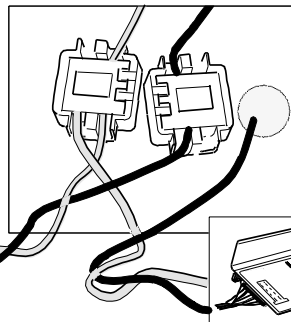
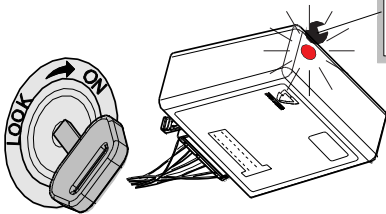

Ignition ON

Failure indicated by the module LED glowing red for a maximum of 5 minutes. If trailer connected the tail lights will also glow indicating failure of CAN signal.

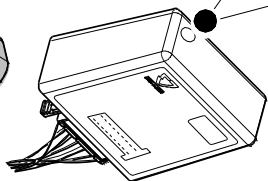
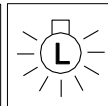
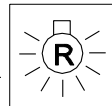

or

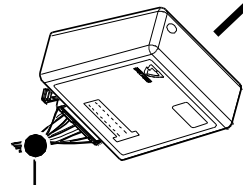
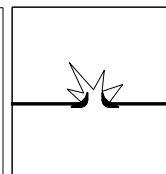
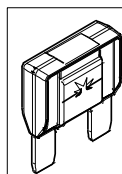
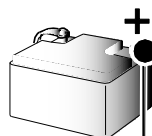

Ignition ON

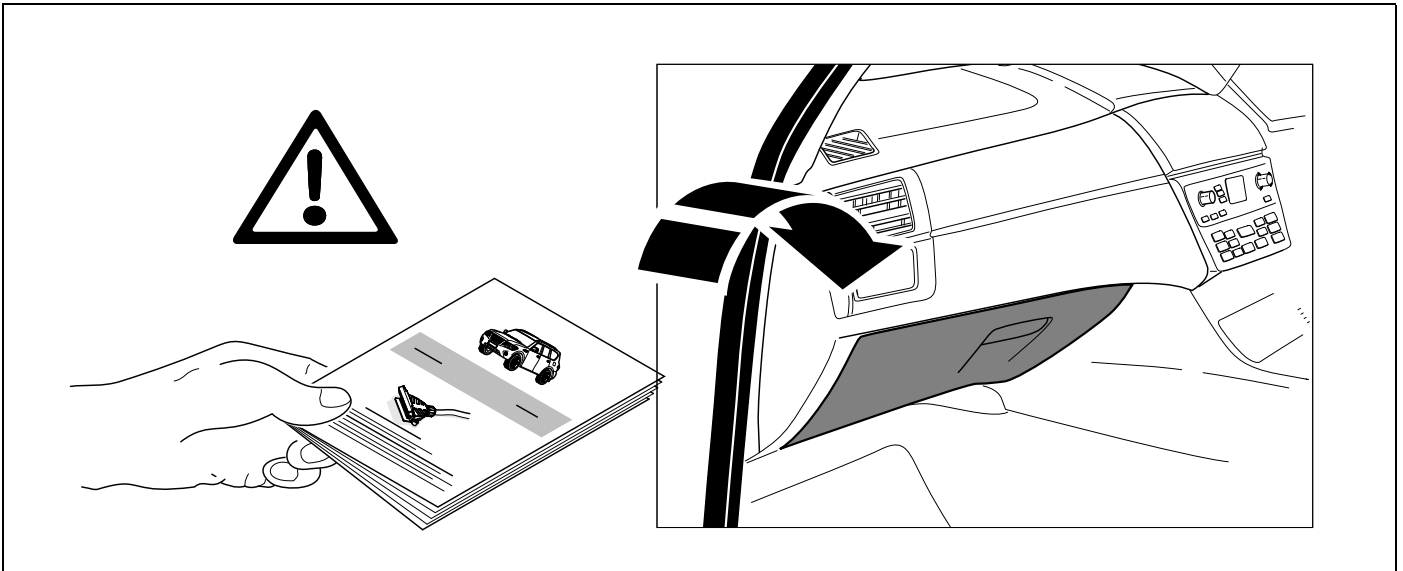

Subject to change in terms of construction, equipment and colour, and may contain errors.
The information and illustrations are non-binding.

Scan this for our full E-Kit catalogue

