

750122

BMW 2-Serie Active Tourer	F45	09/14 >>
MINI Clubman	F54	10/15 >>
MINI Cooper	F55	10/14 >>
MINI Cooper	F56	03/14 >>
MINI Countryman	F60	03/17 >>

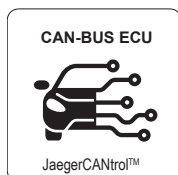

SCAN FOR
LATEST
INSTRUCTIONS

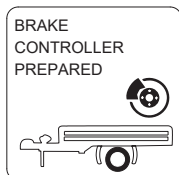
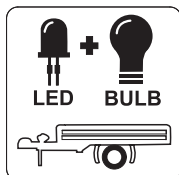
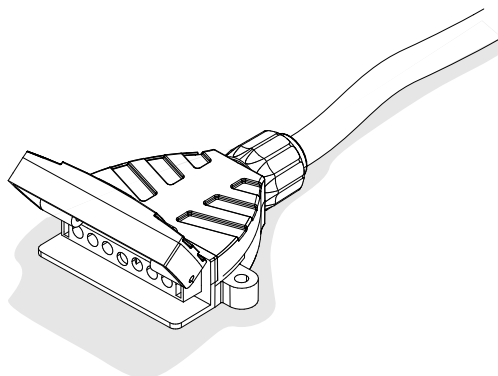

Reference:

The following information must be reviewed before beginning the assembly:

The installation instructions are to be thoroughly read.
The installation should be carried out by qualified personnel with the relevant technical knowledge.
The vehicle manufacturers' current technical notices and information on retrofitting must be followed.
The removal and replacement instructions found in the current repair manuals must be followed.
It must be ensured that the vehicle is technically suitable for the installation of a trailer hitch.

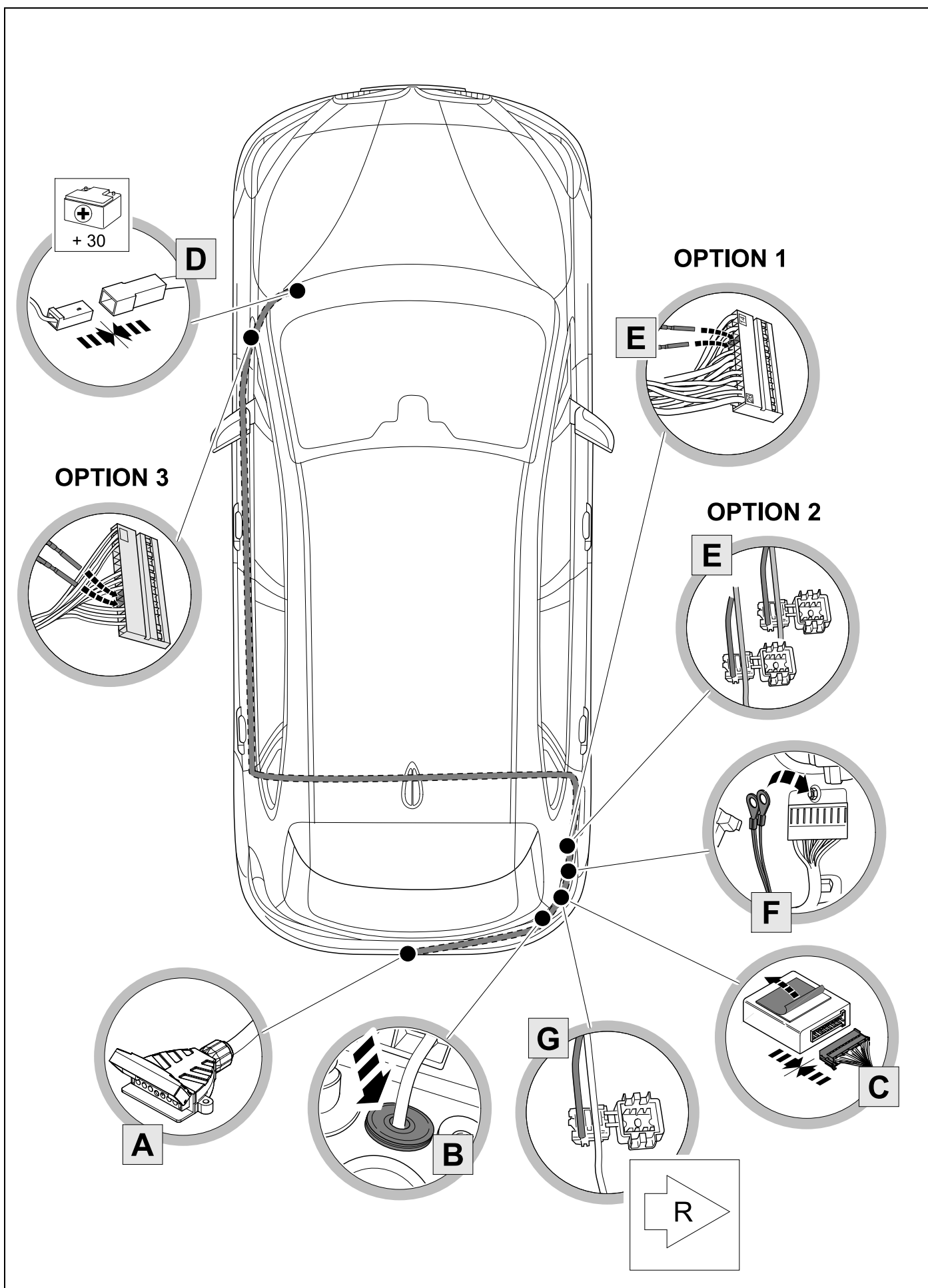

KIT

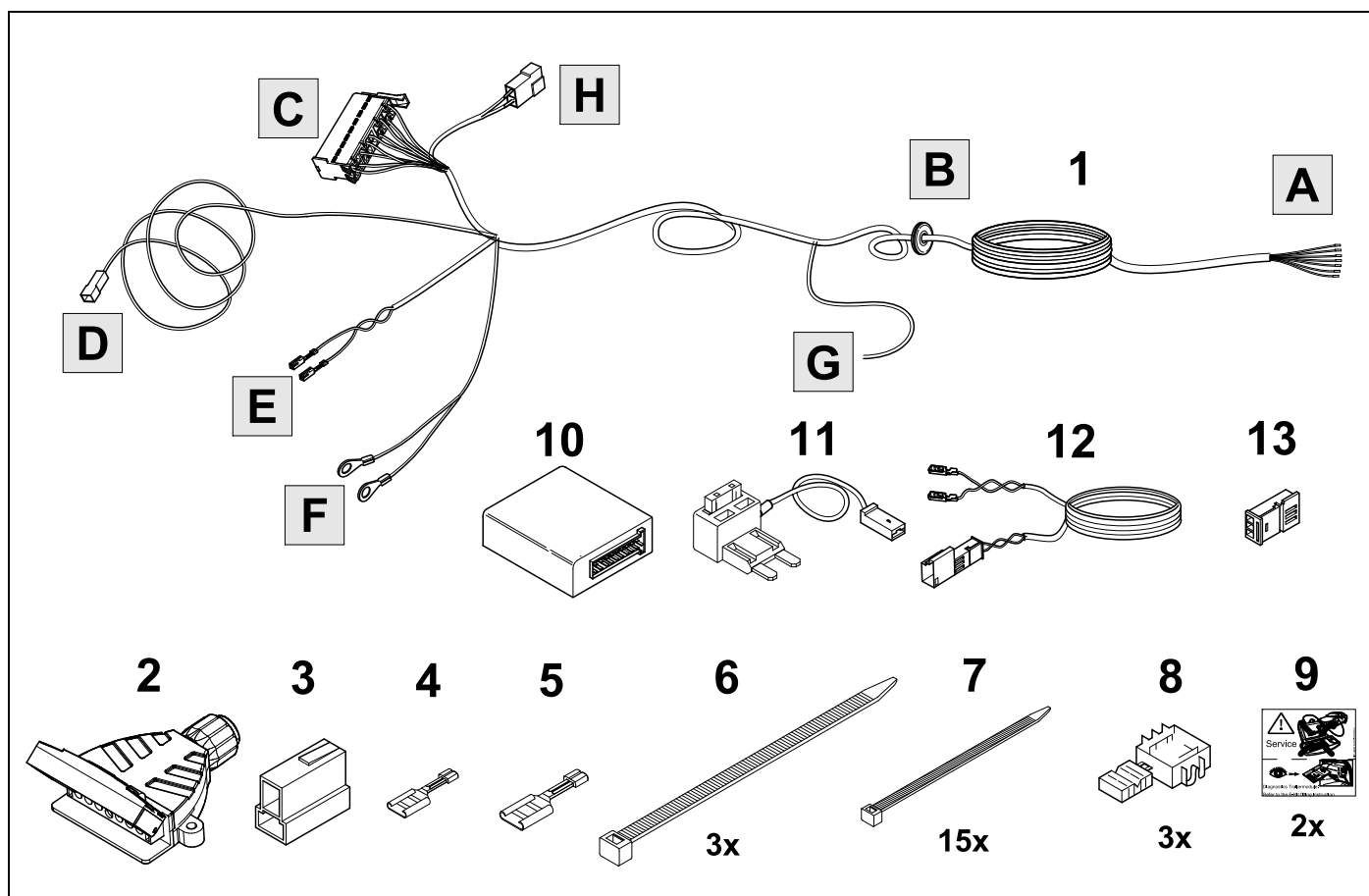

TOOLS

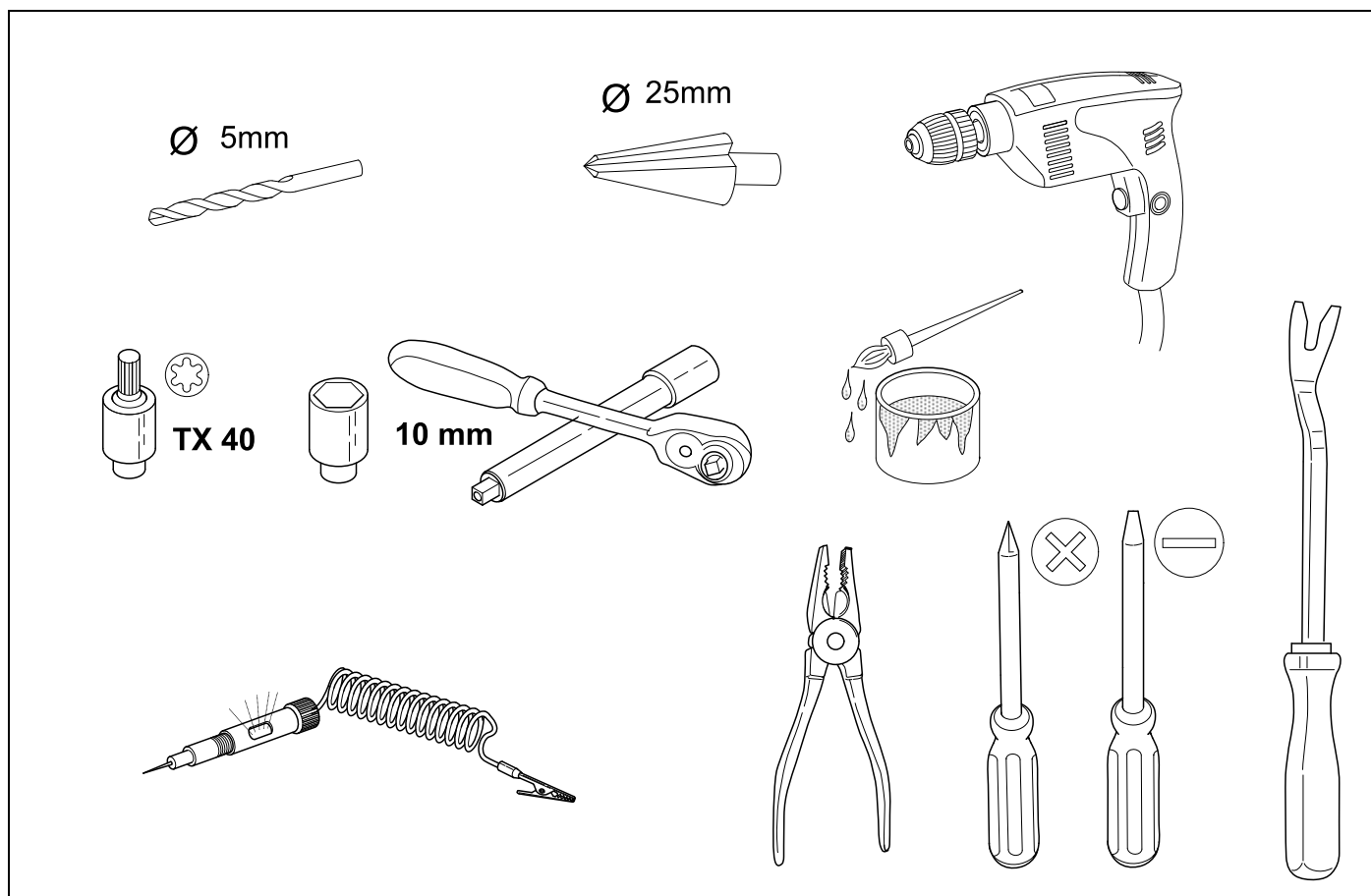

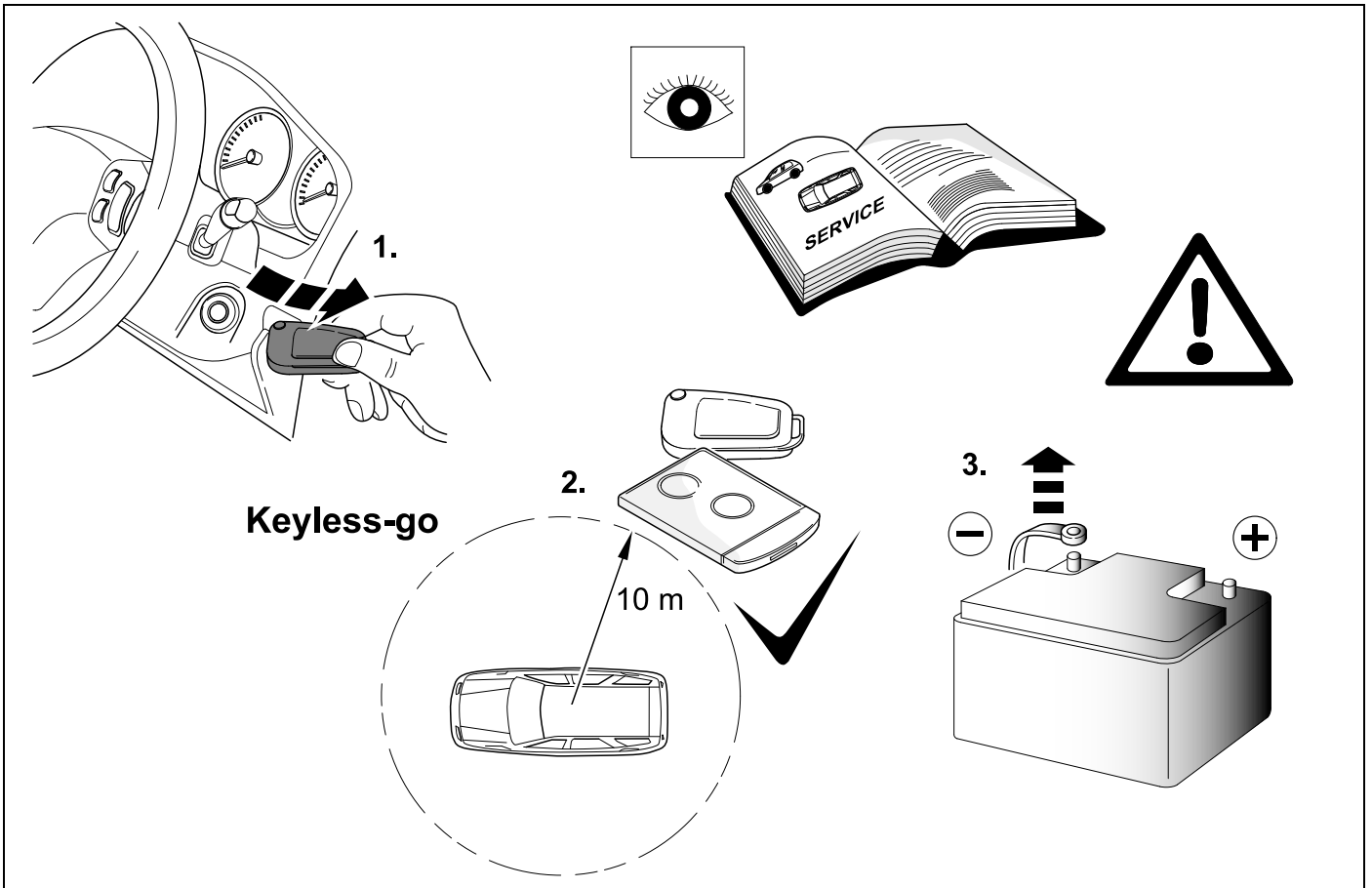

2 REMOVE

F45

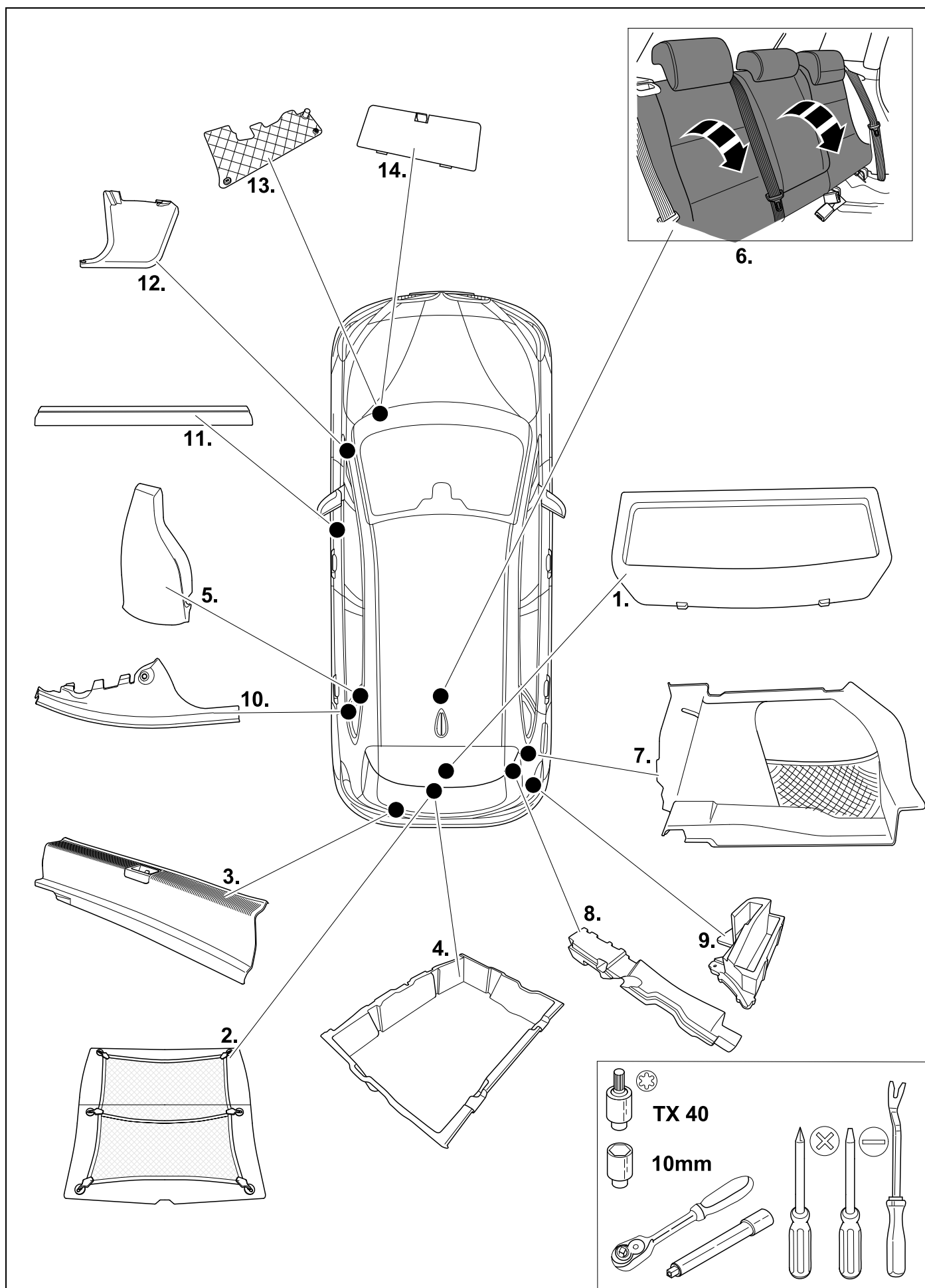

3 REMOVE

F54 + F55

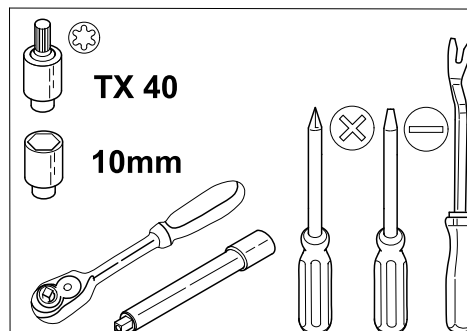
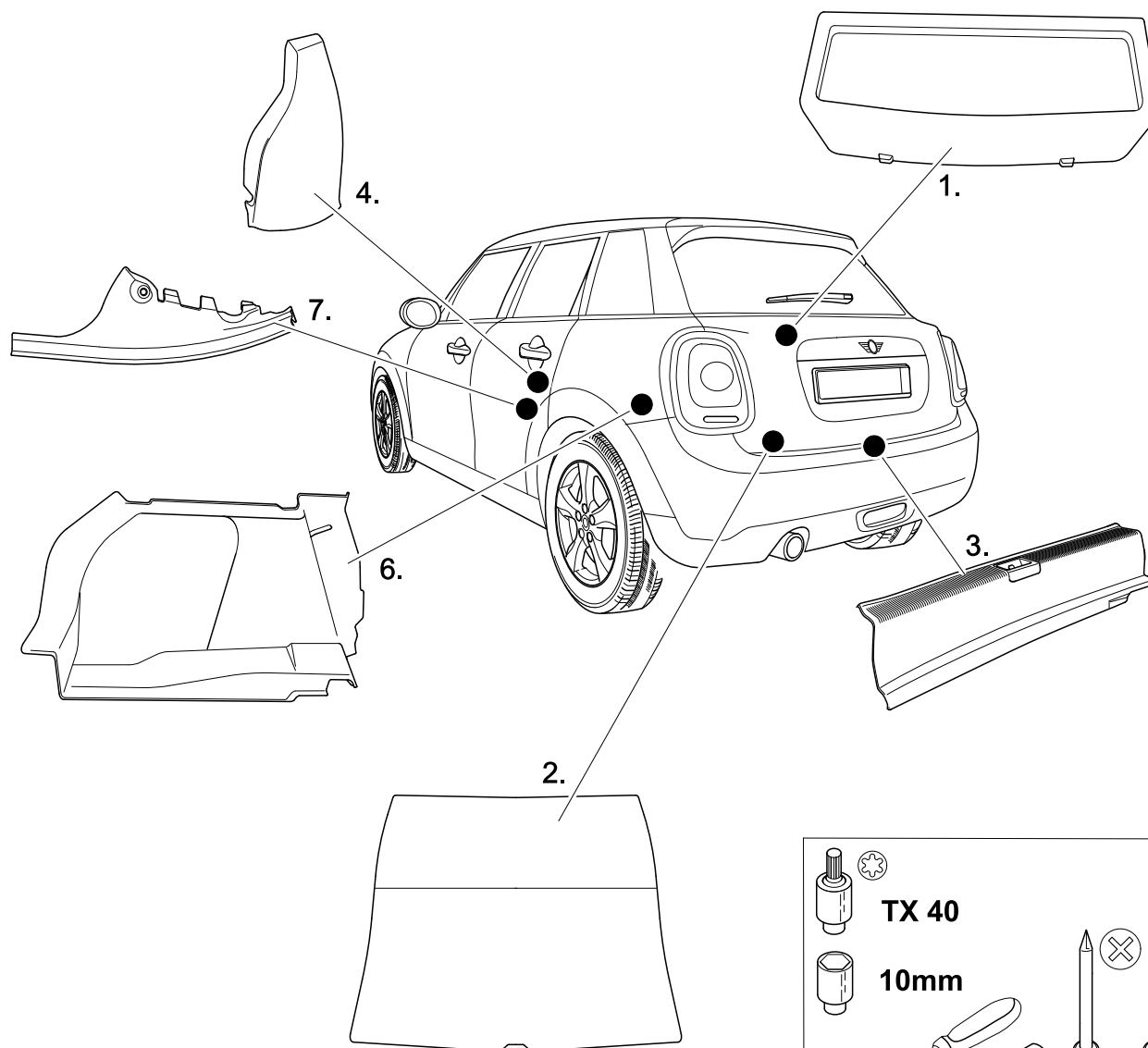
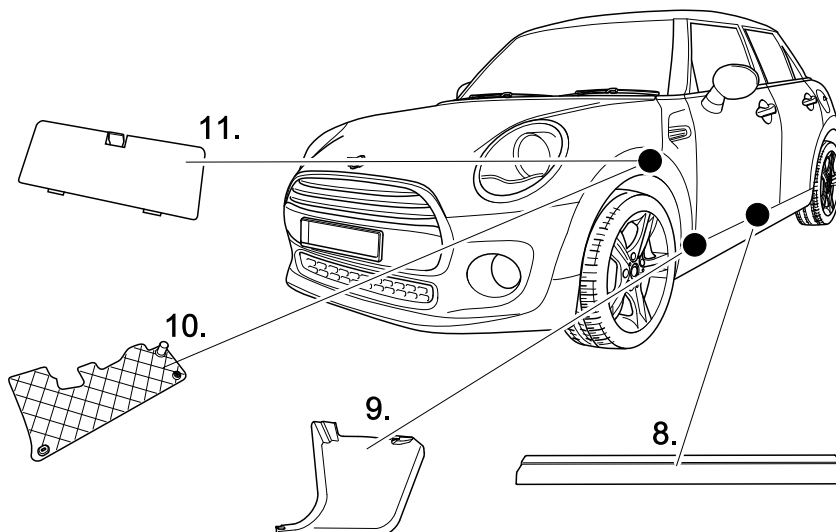
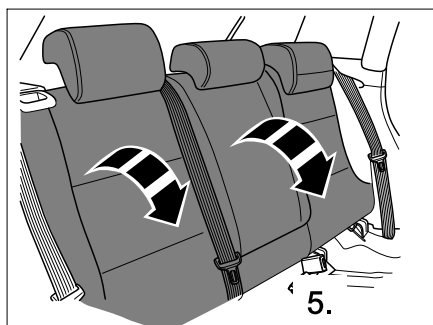

4

F56 + F60

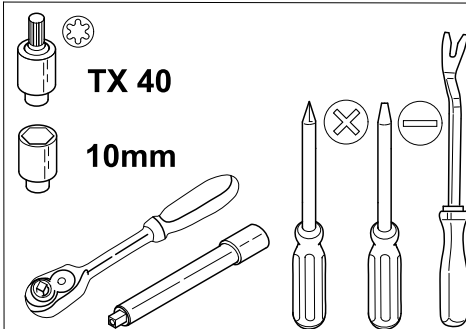
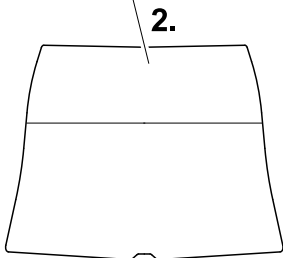
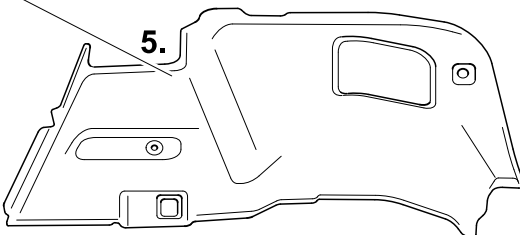
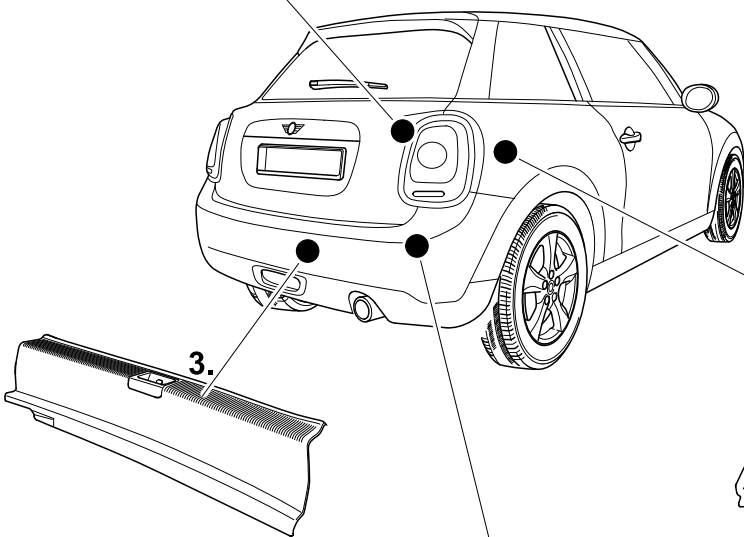
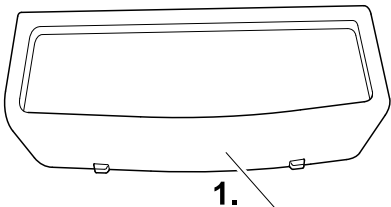
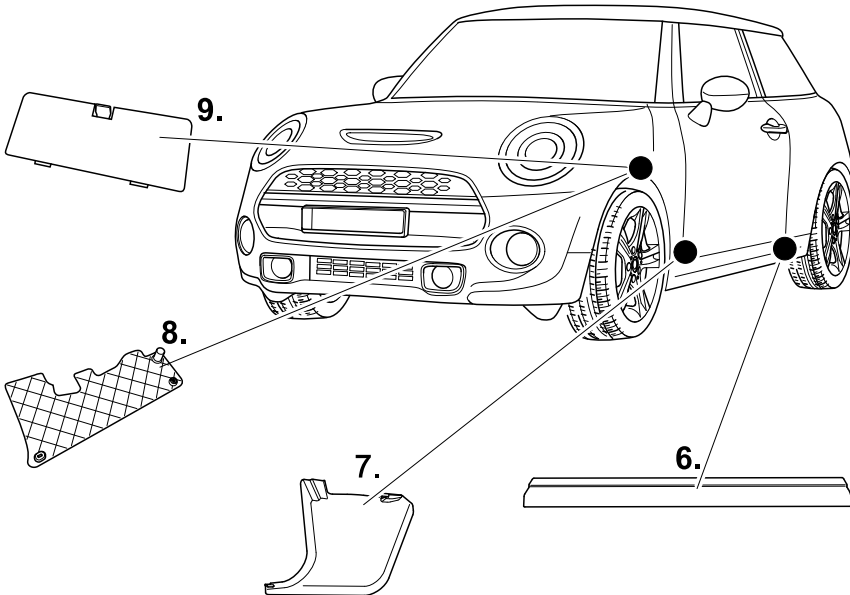
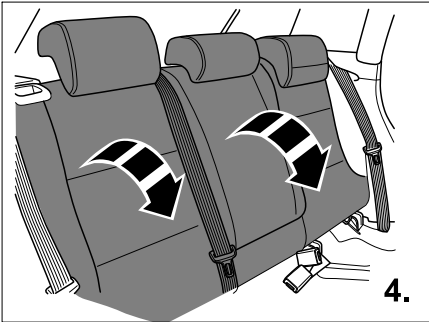

5

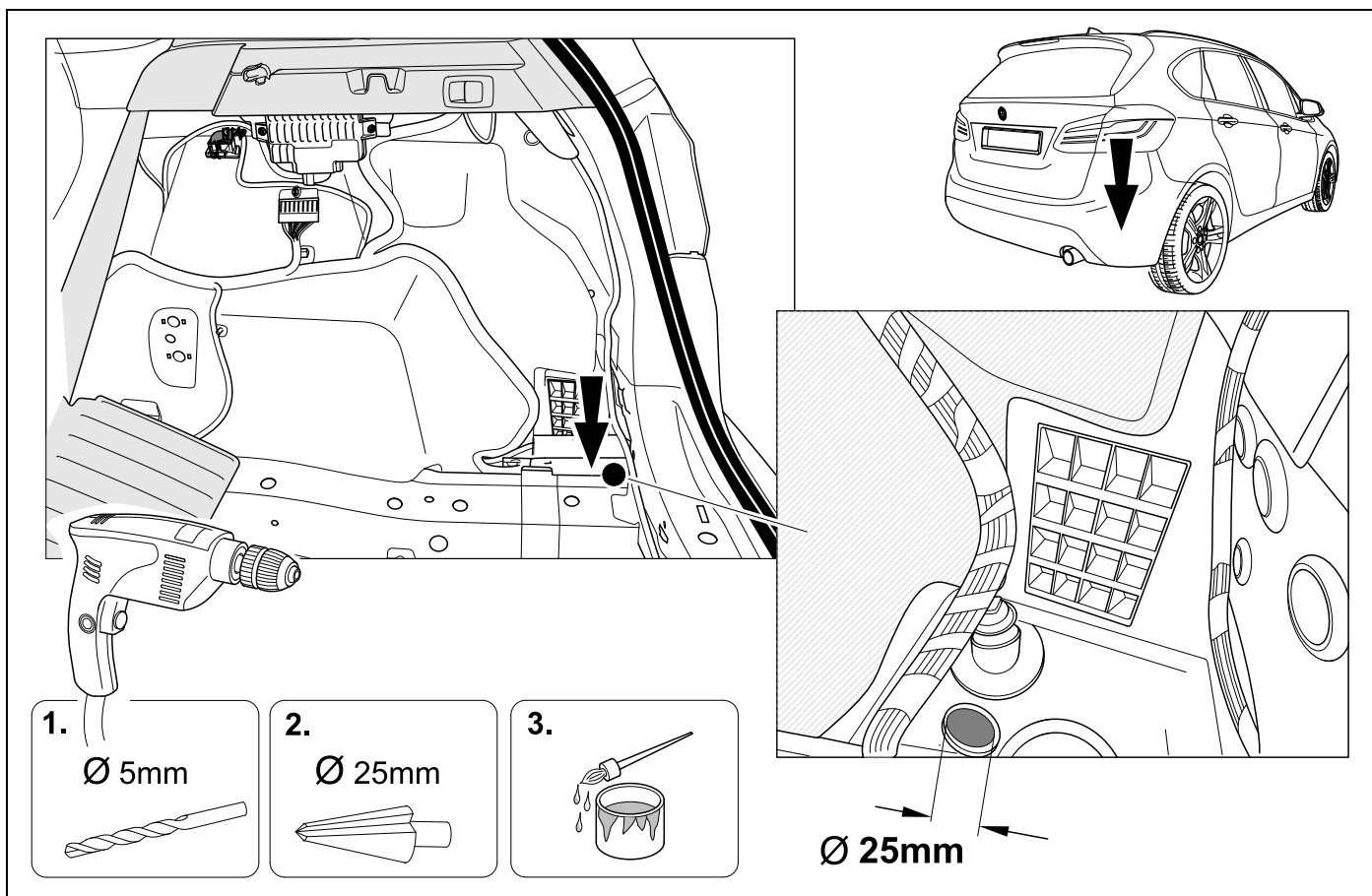

6

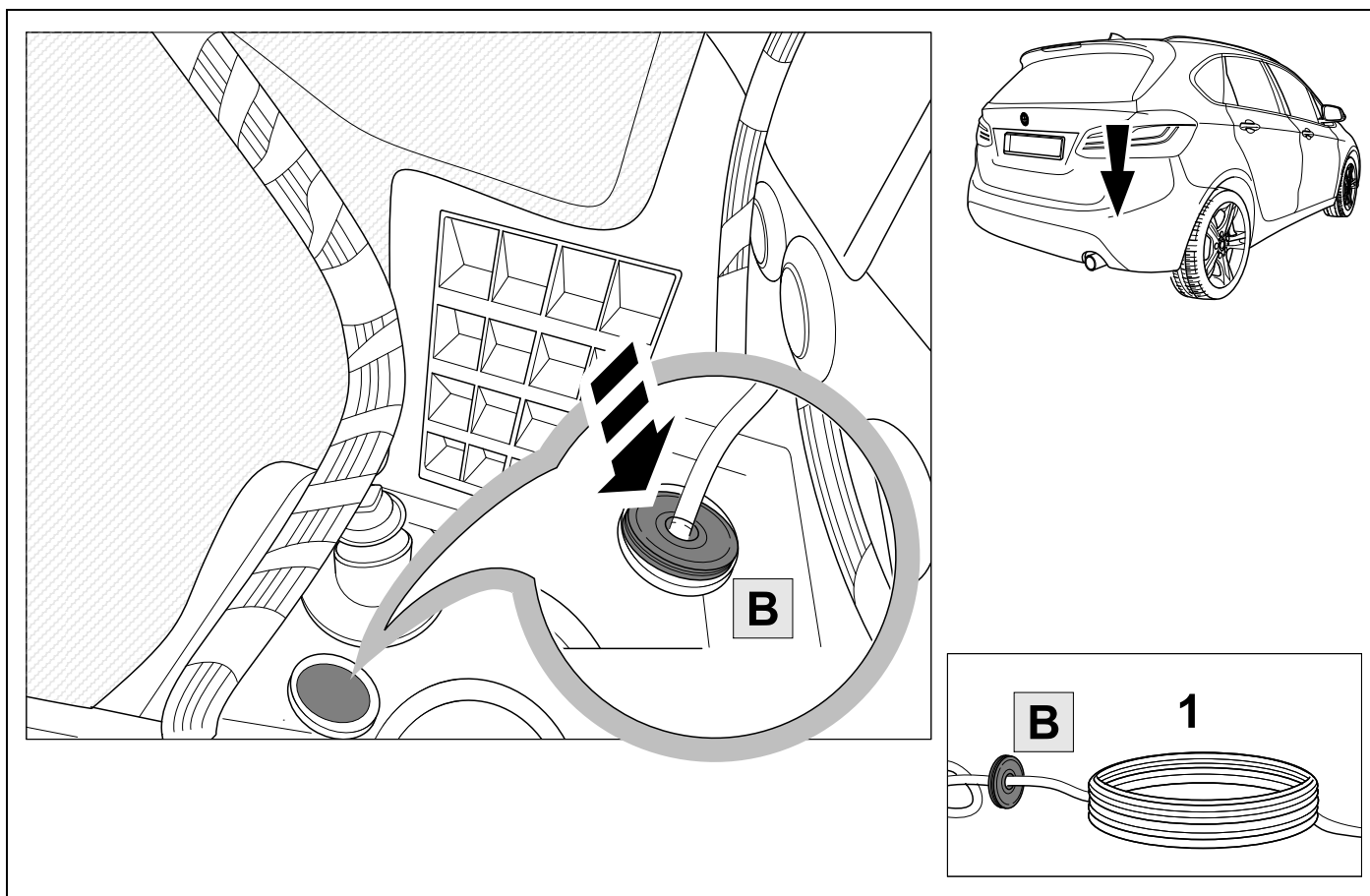

7

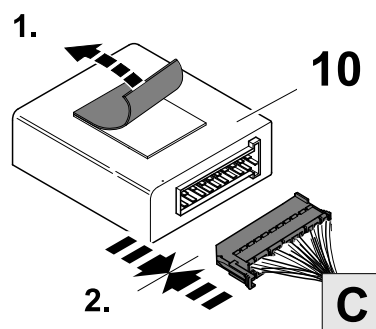
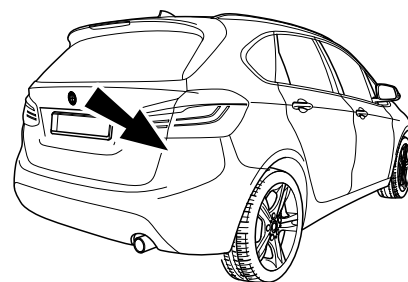
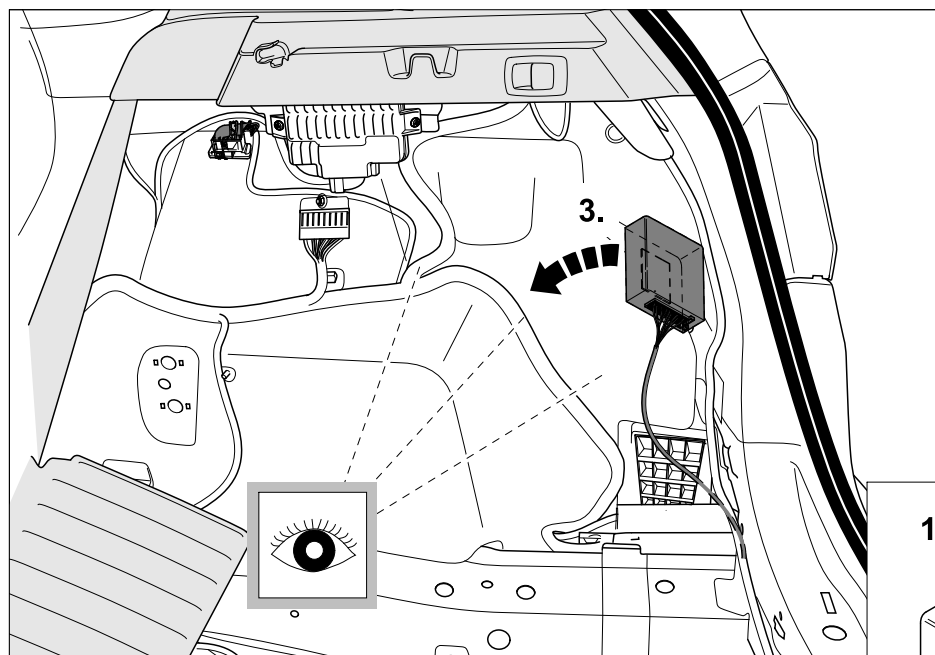

C

1



8

F45

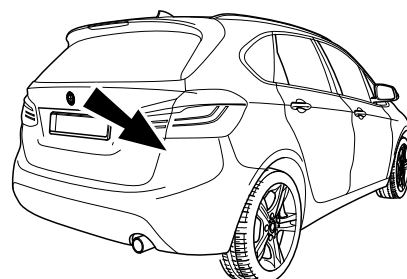
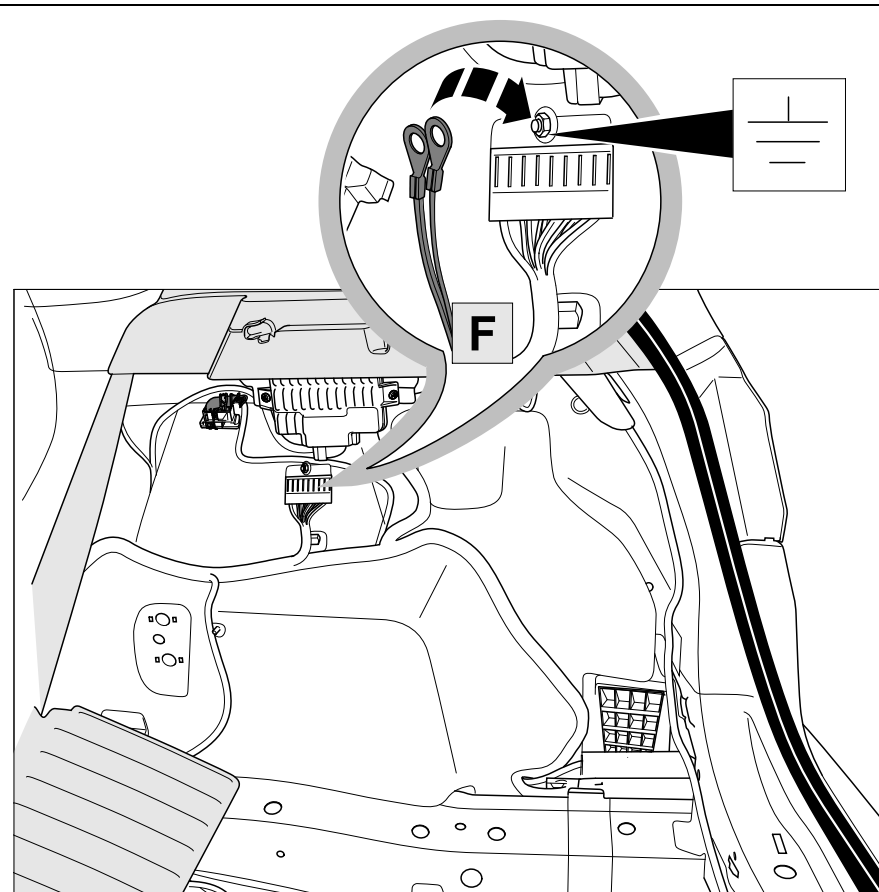

1

F

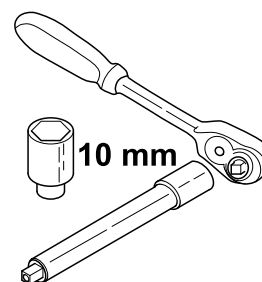

9

F55 + F56

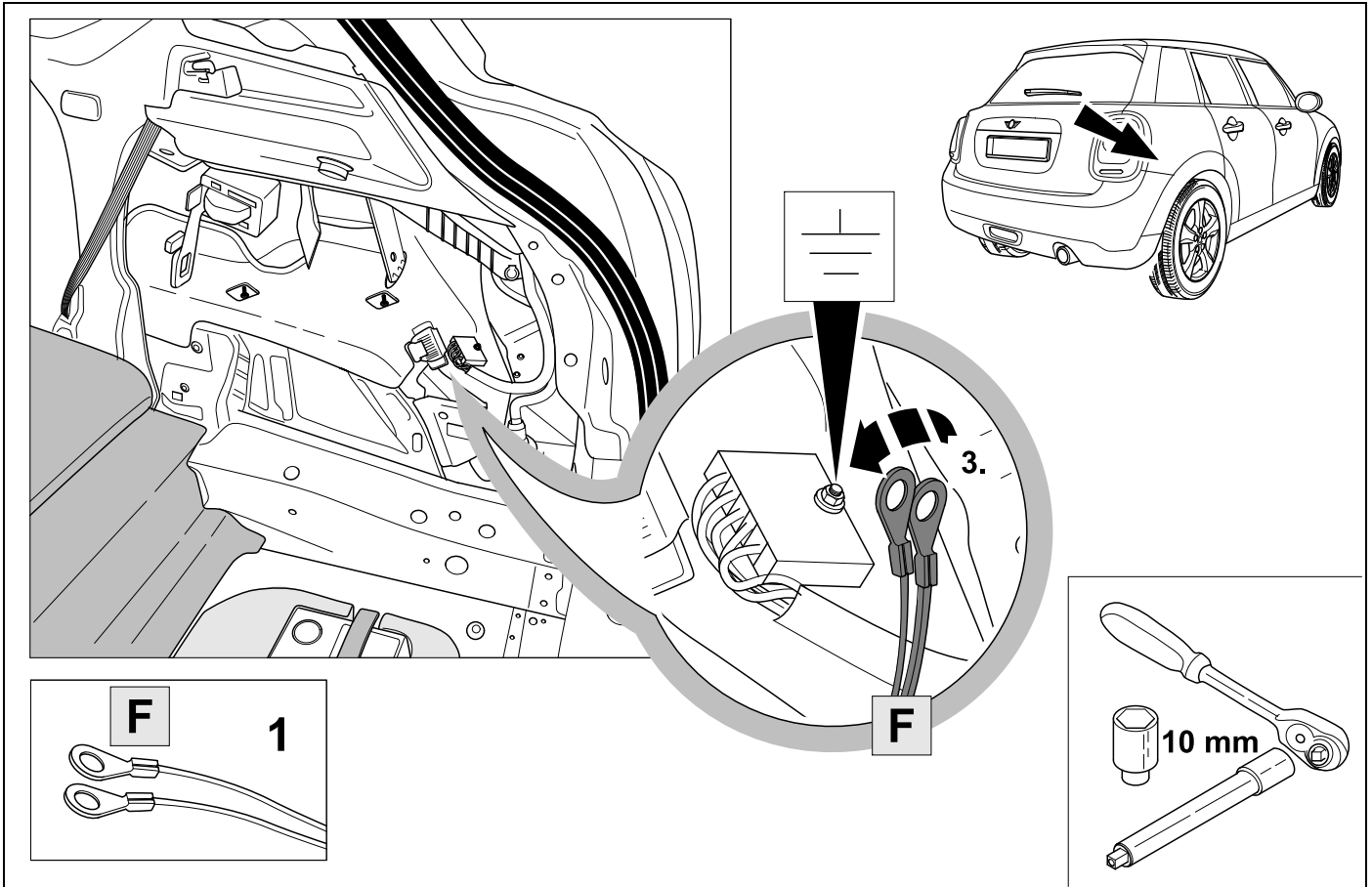

10

F54 + F60

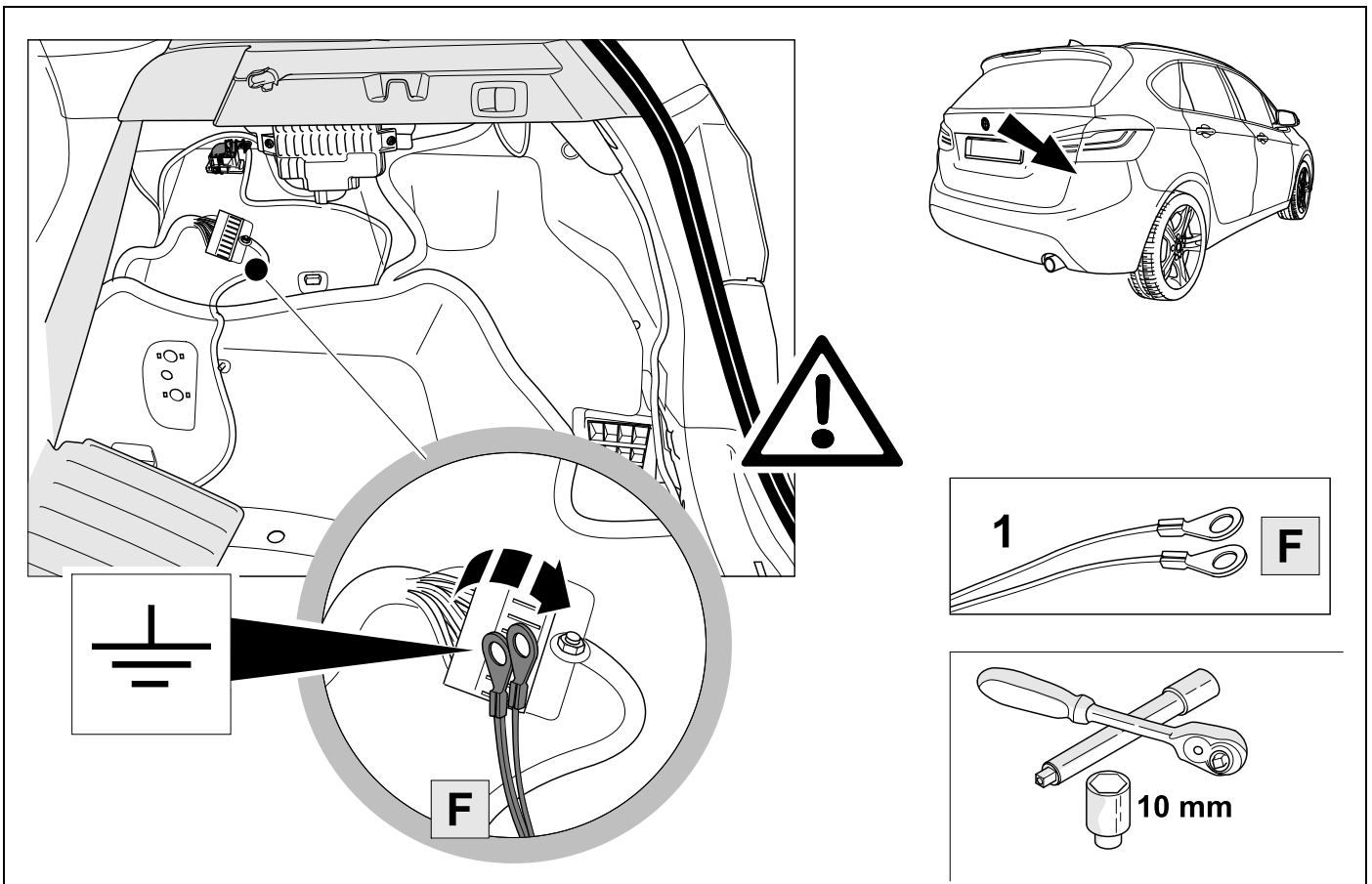

11



31

F45

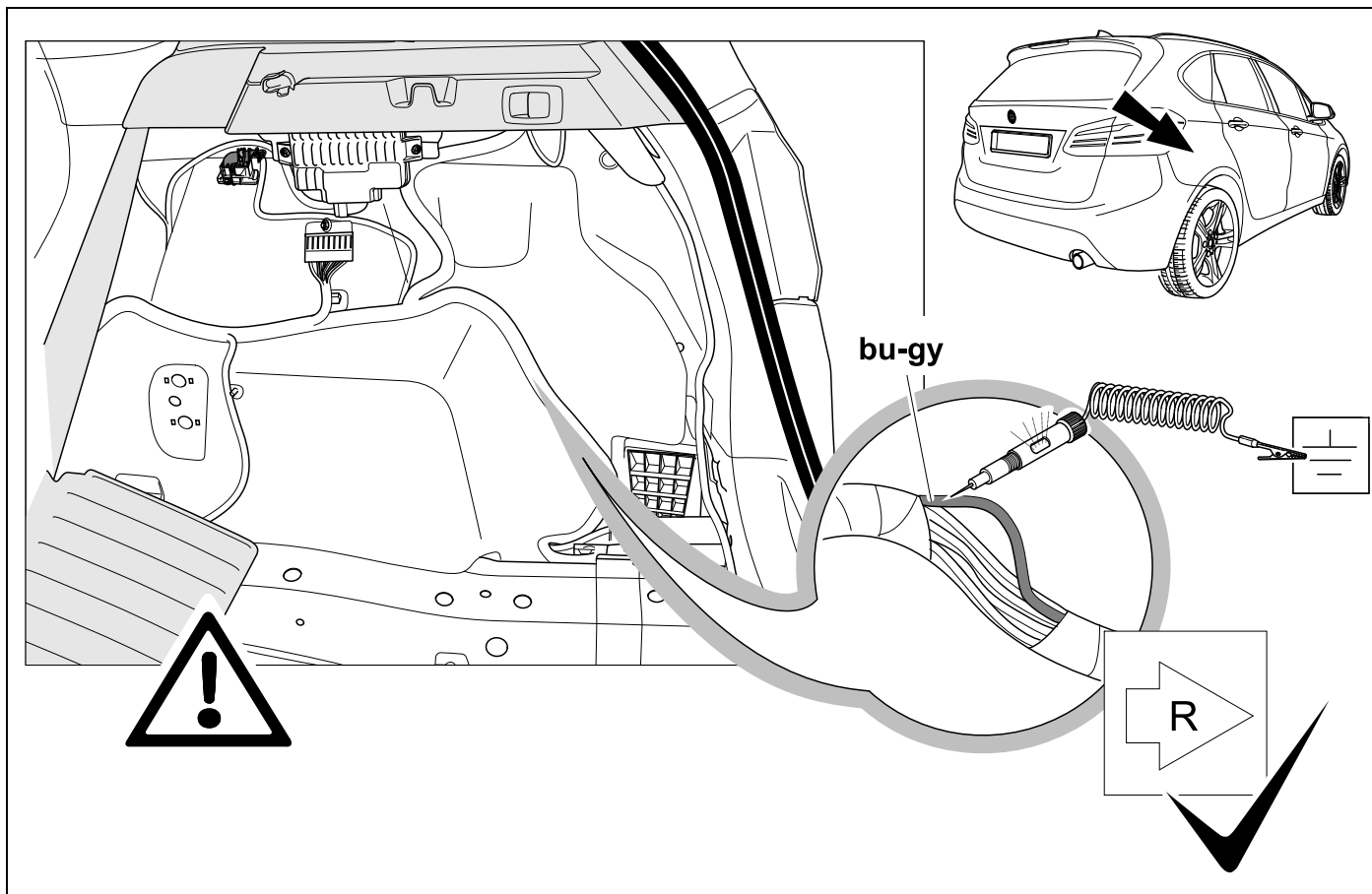

12



31

F54 + F55 + F56

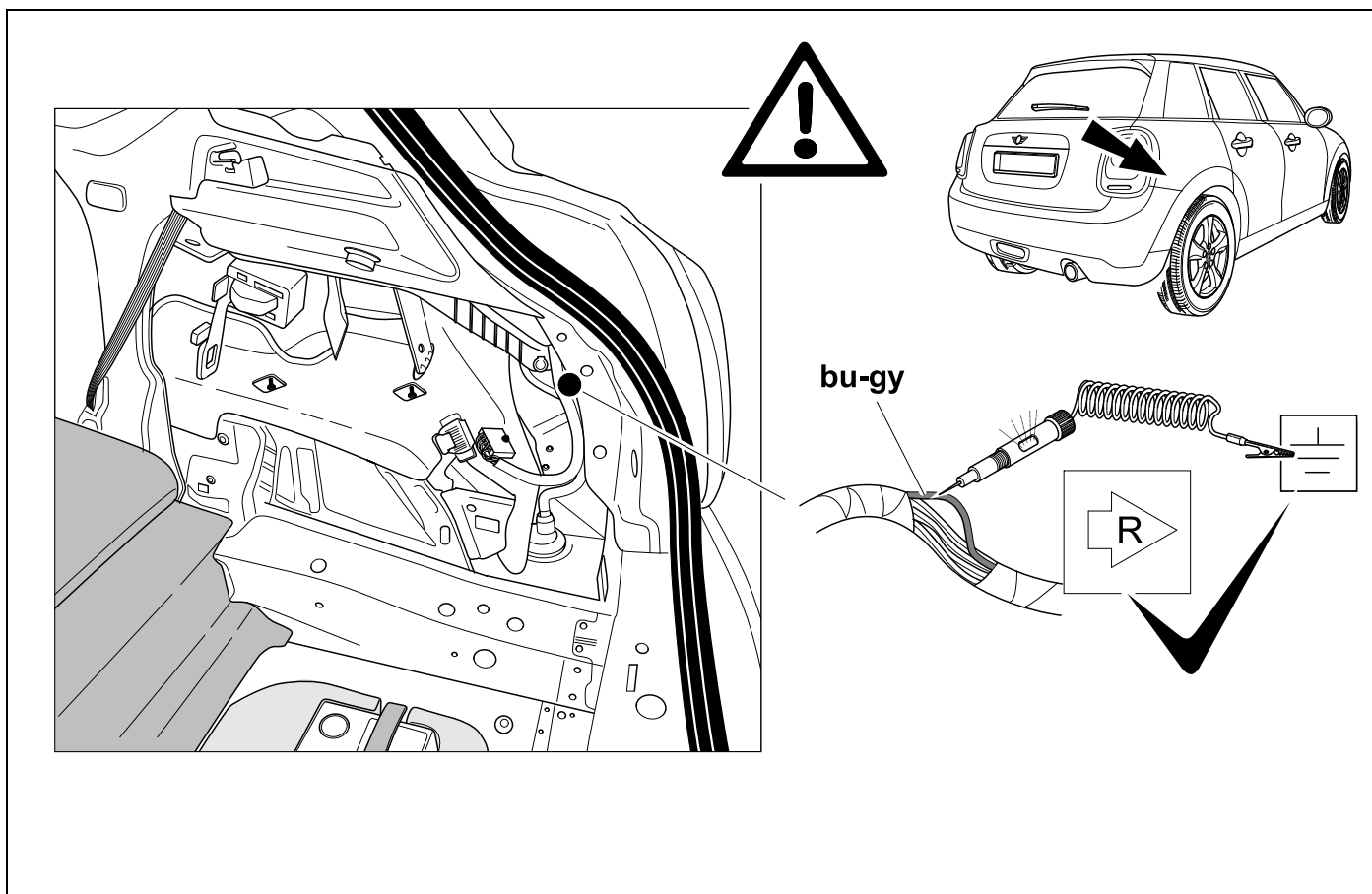

13



31

F60

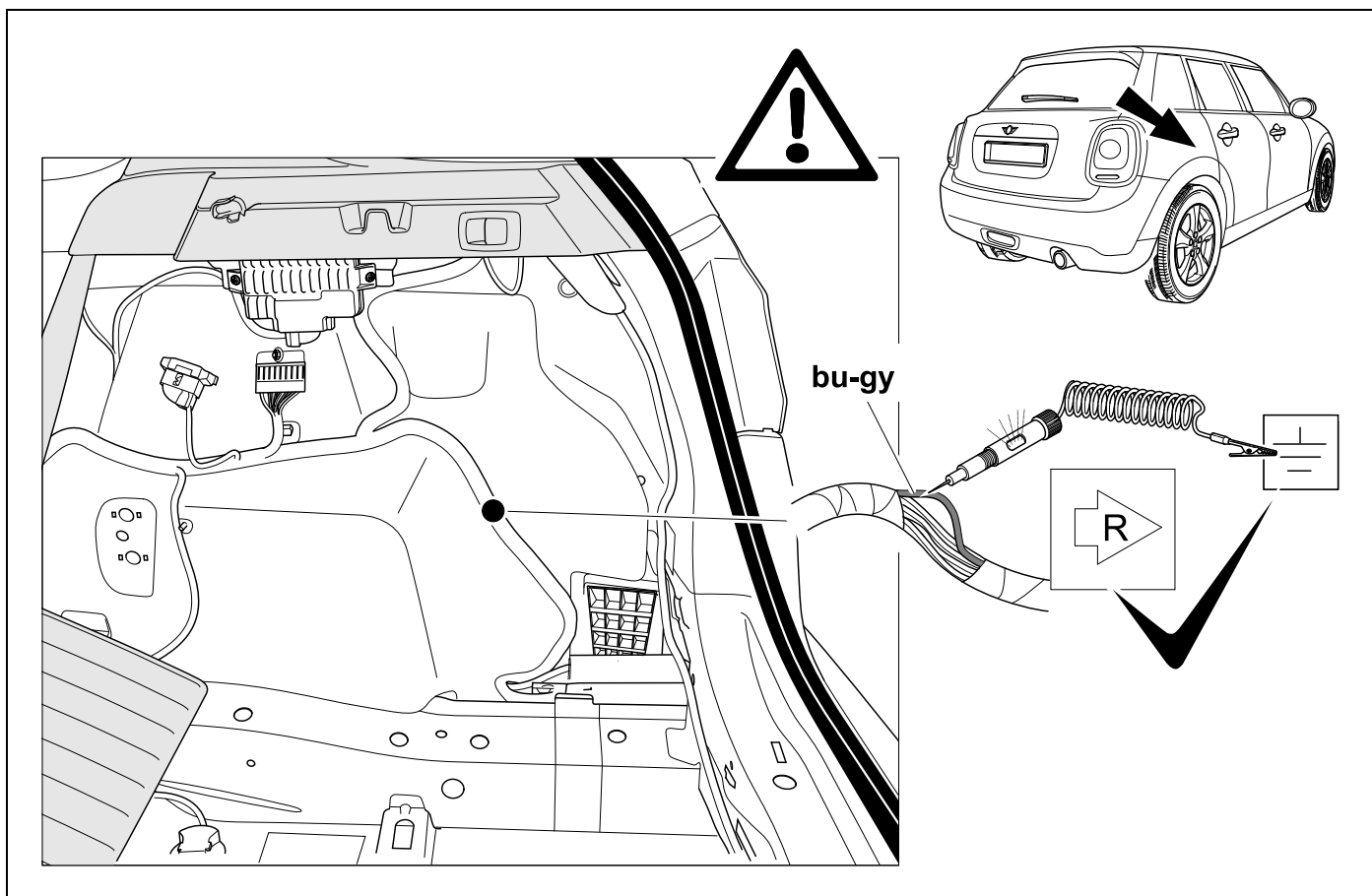

14



31

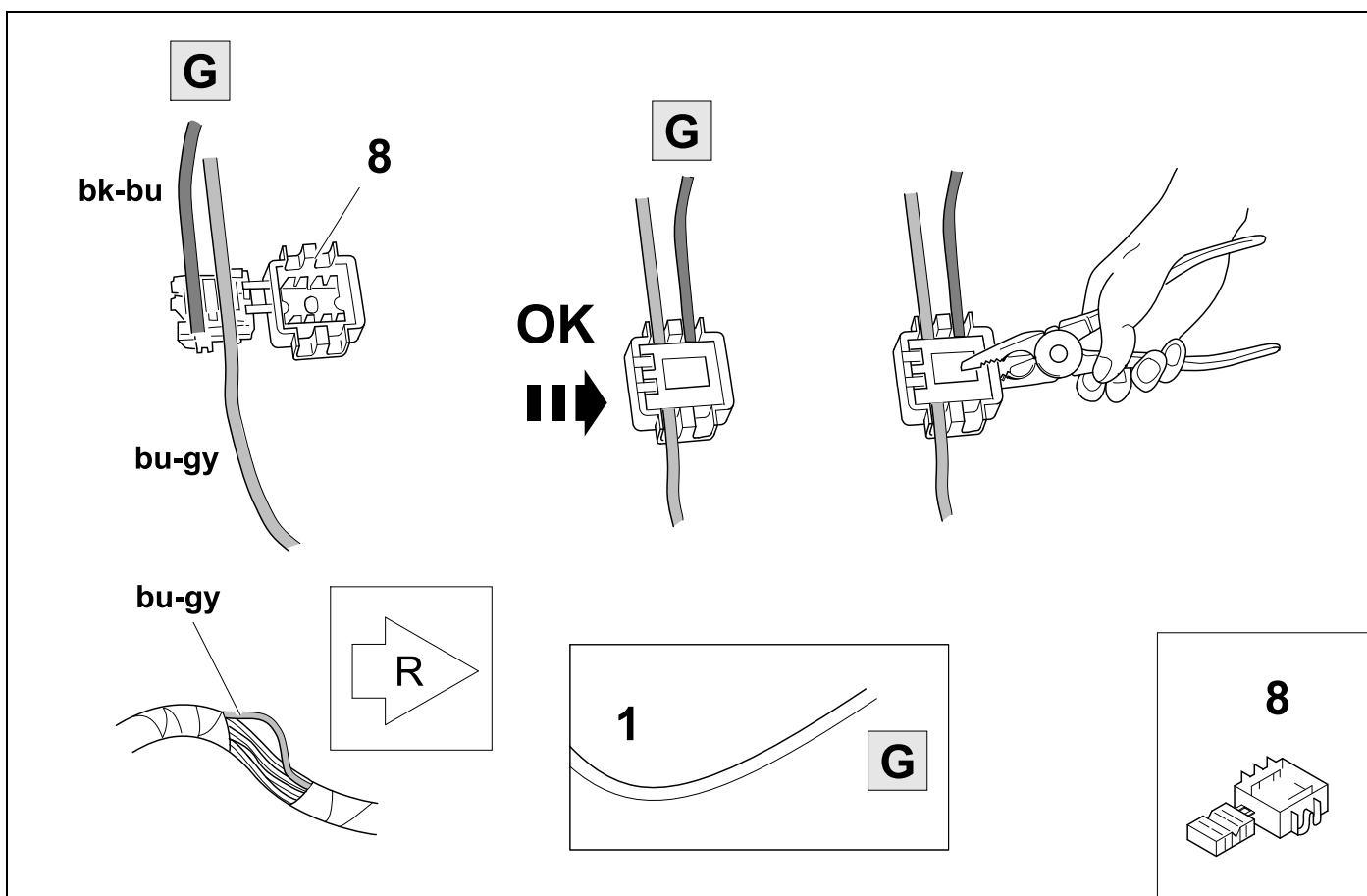

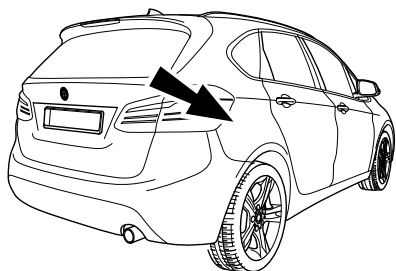

CAN WIRE

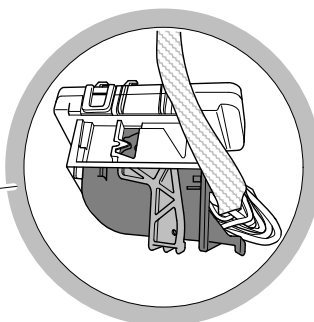
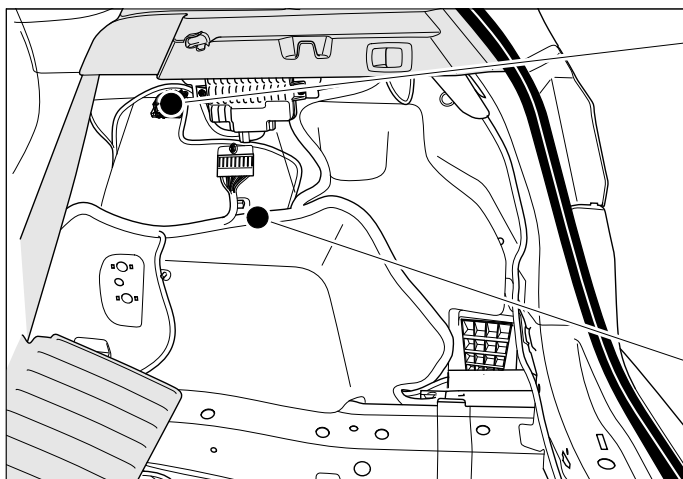

14 ⇒ **16**

22 ⇒ **36**

OPTION 2

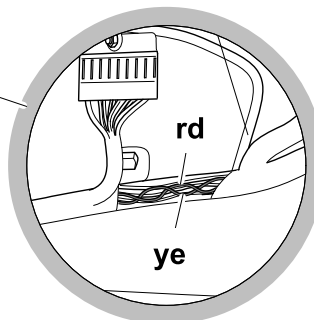

17 ⇒ **18**

22 ⇒ **36**

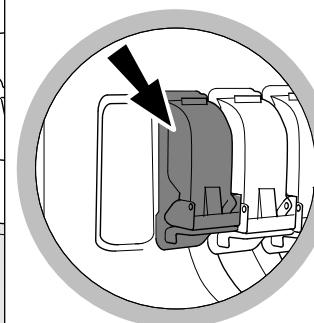
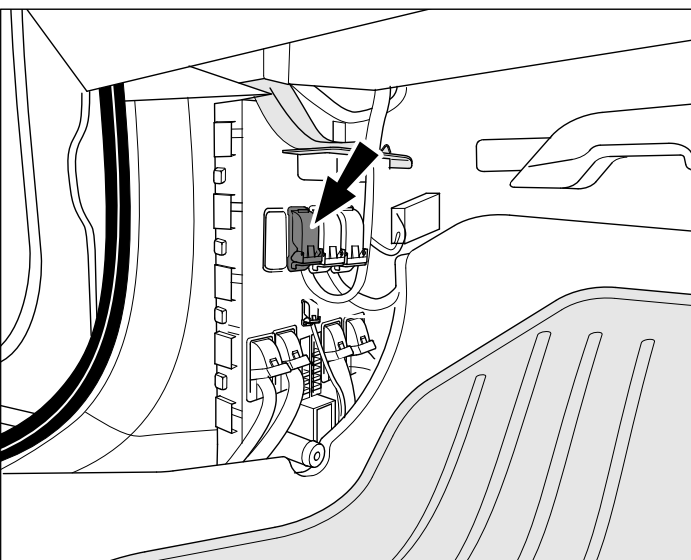
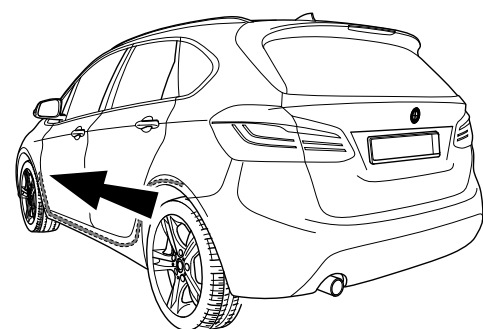

OPTION 3

19 ⇒ **36**

16 OPTION 1

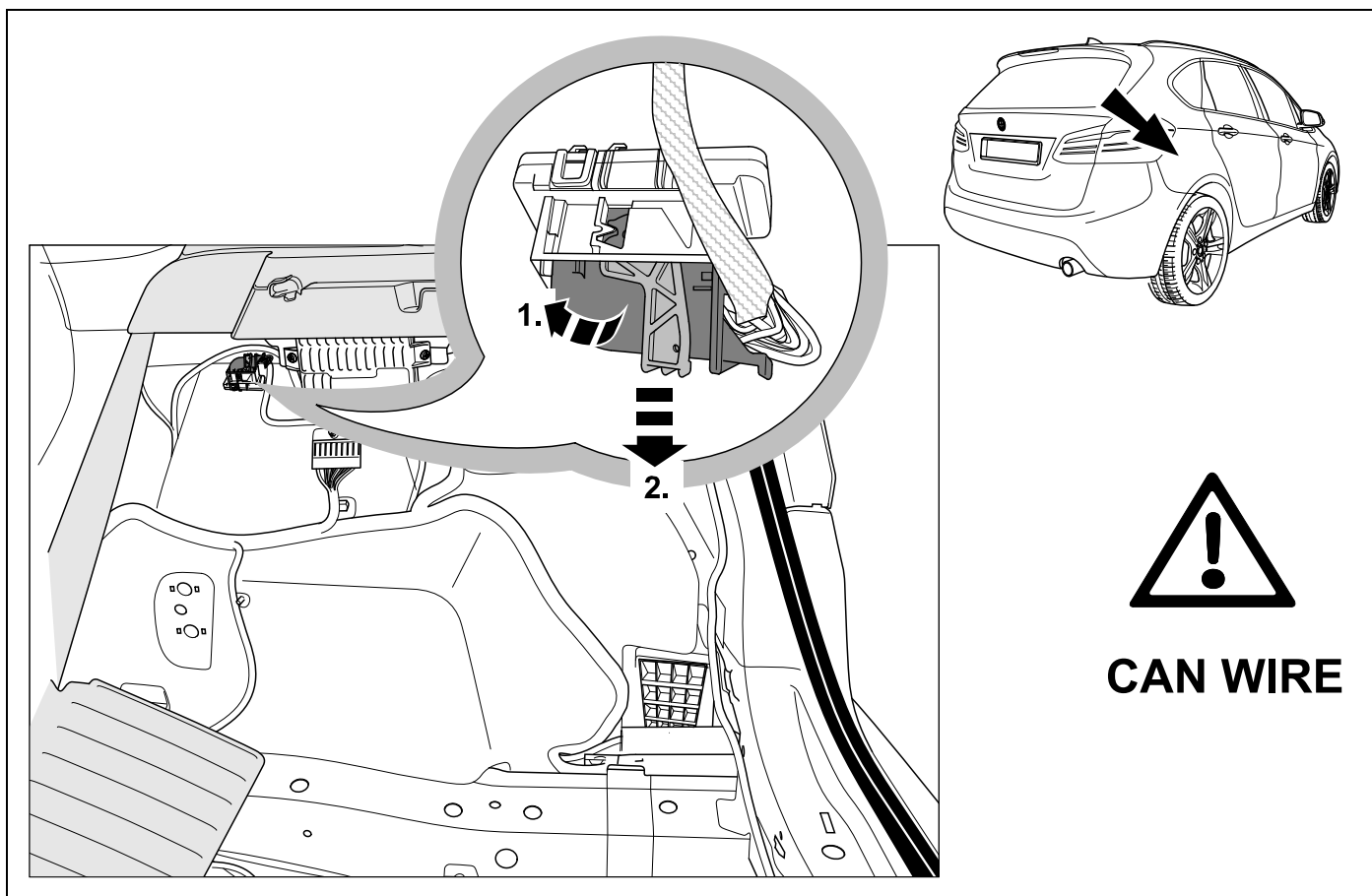

17 OPTION 1

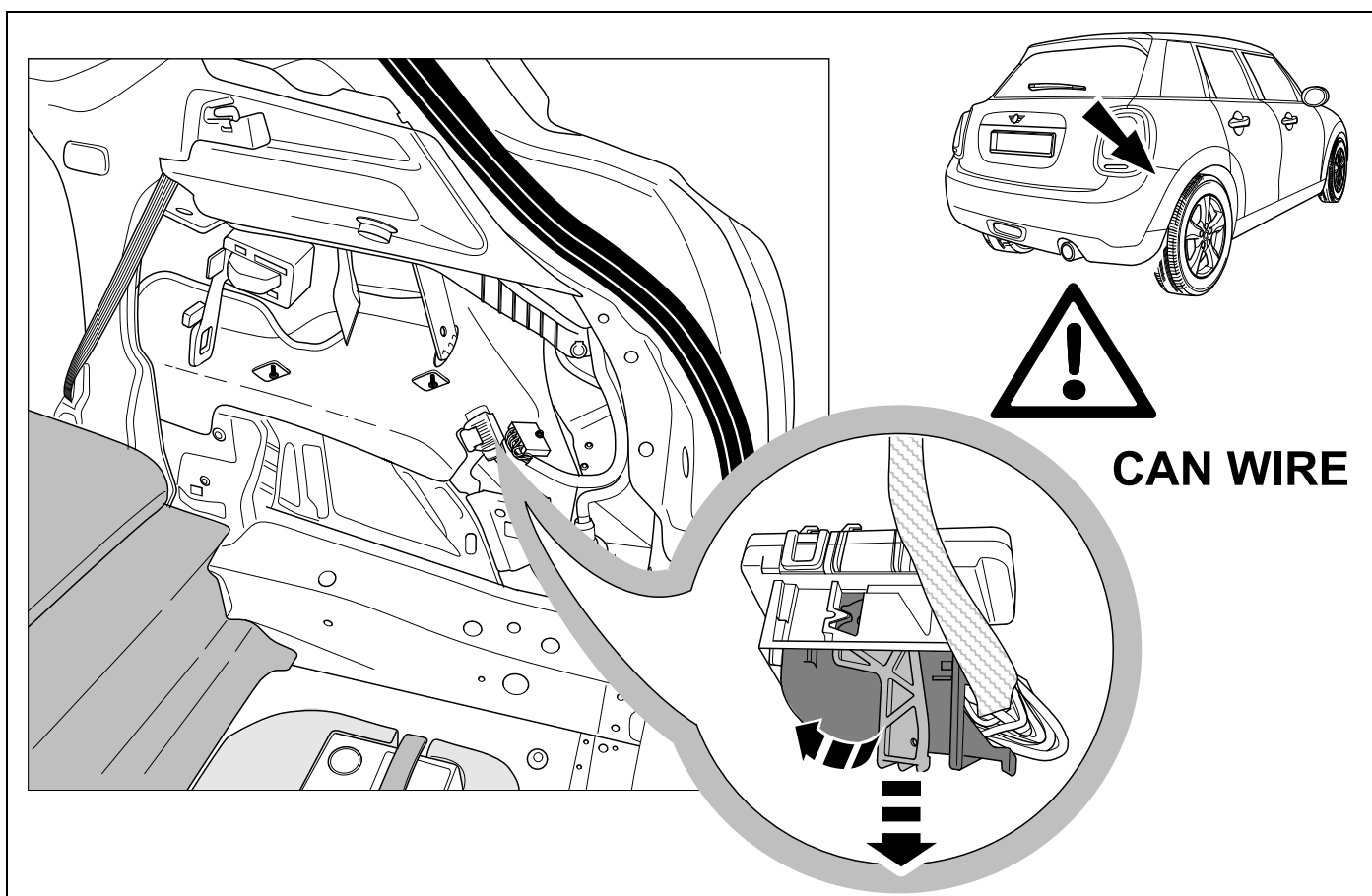

18 OPTION 1



31

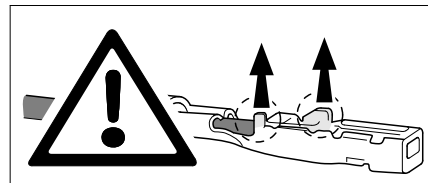
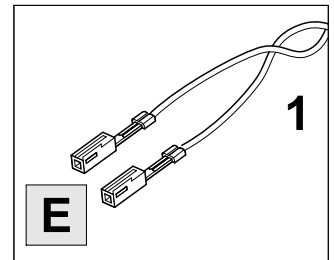
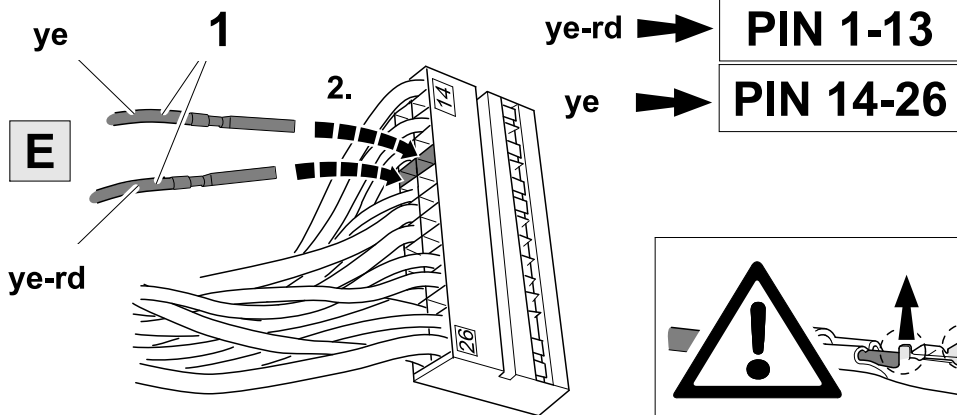
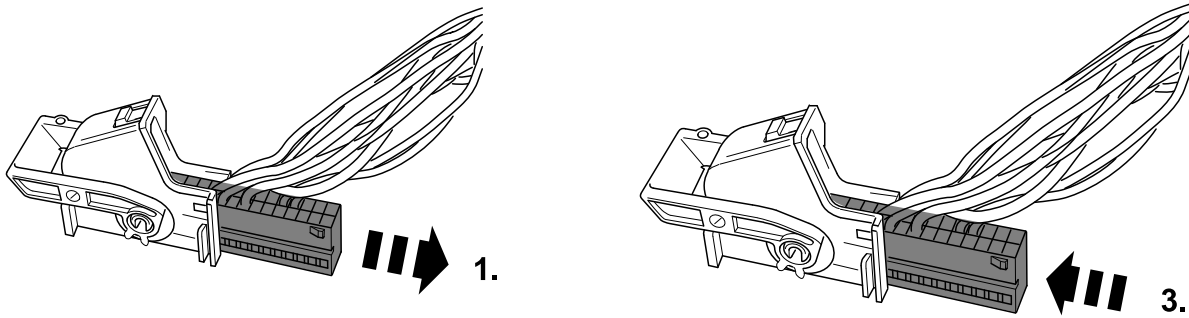

19 OPTION 2



31

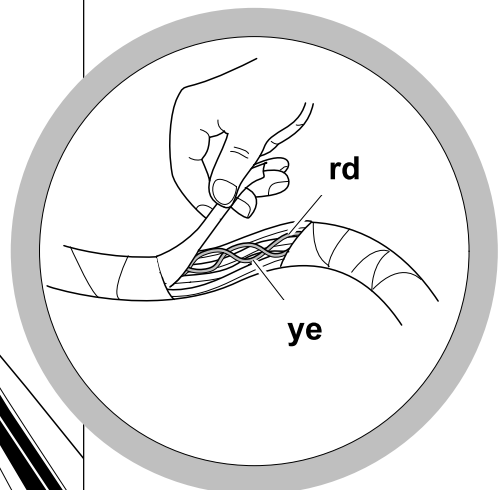
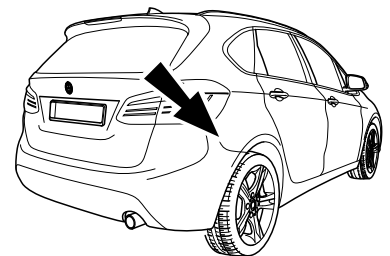
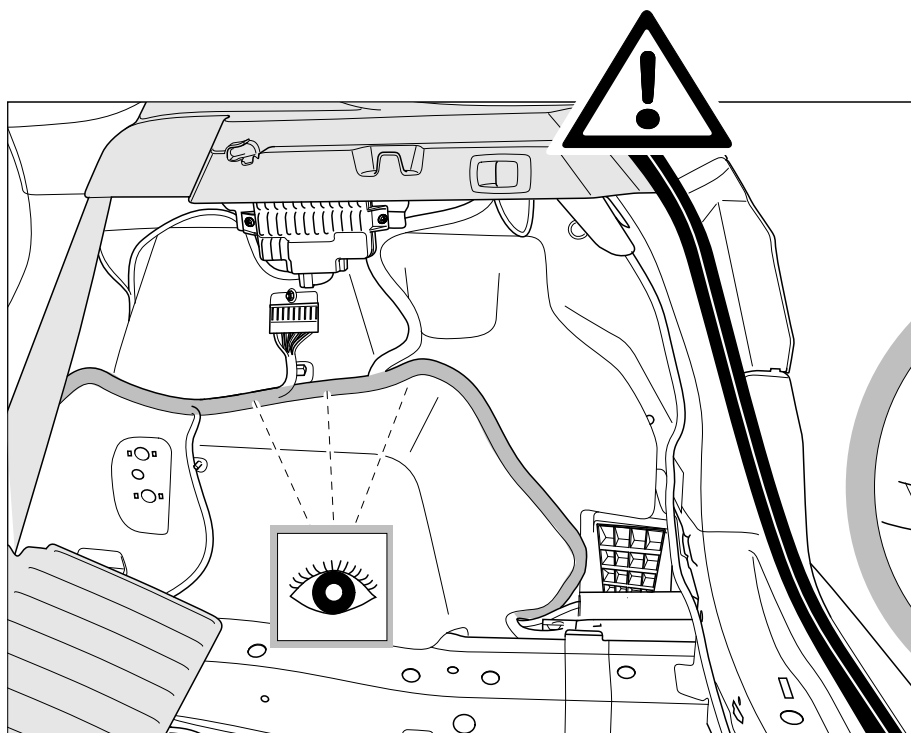

20 OPTION 2



31

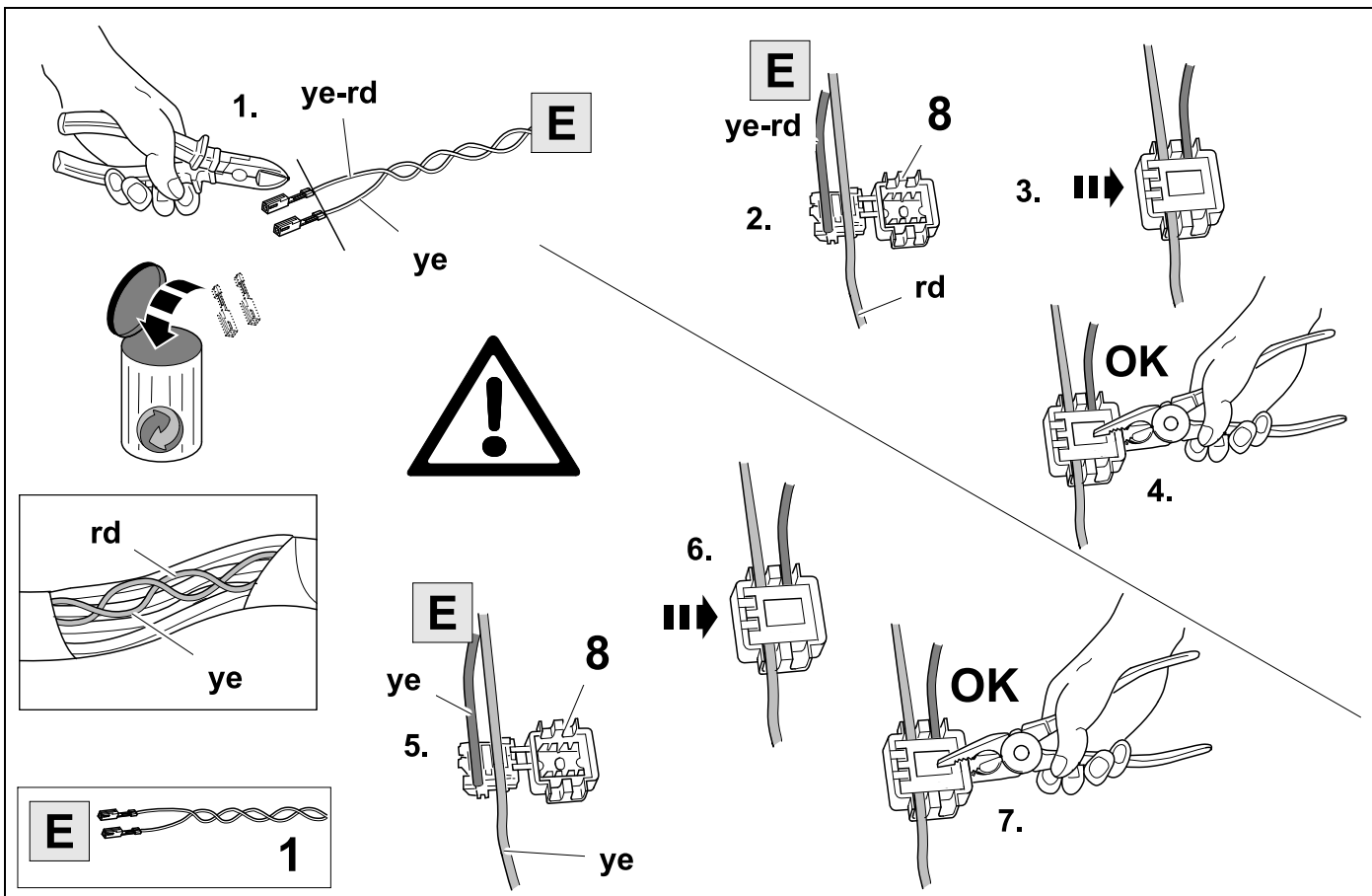

21 OPTION 3



31

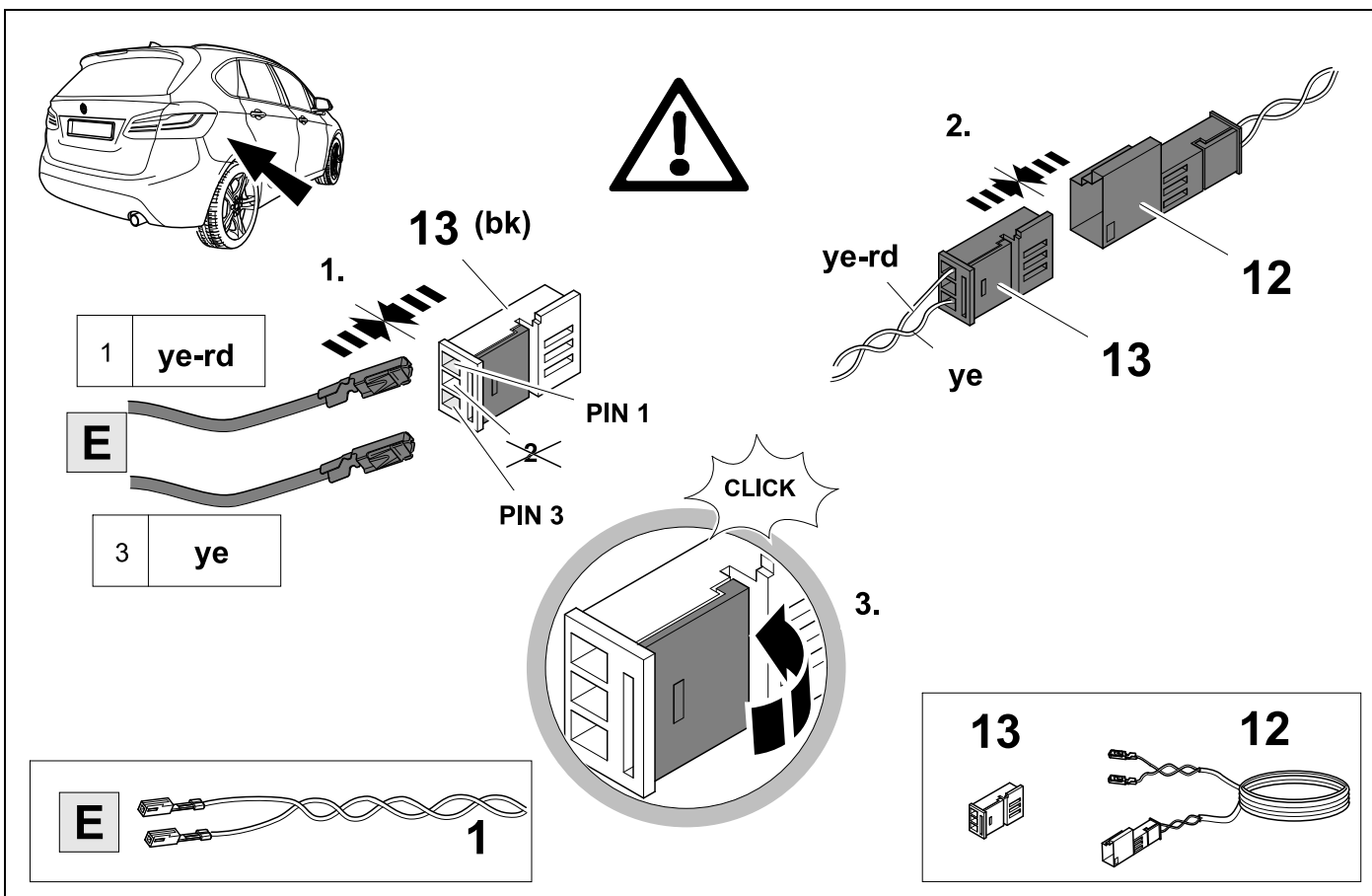

22 OPTION 3

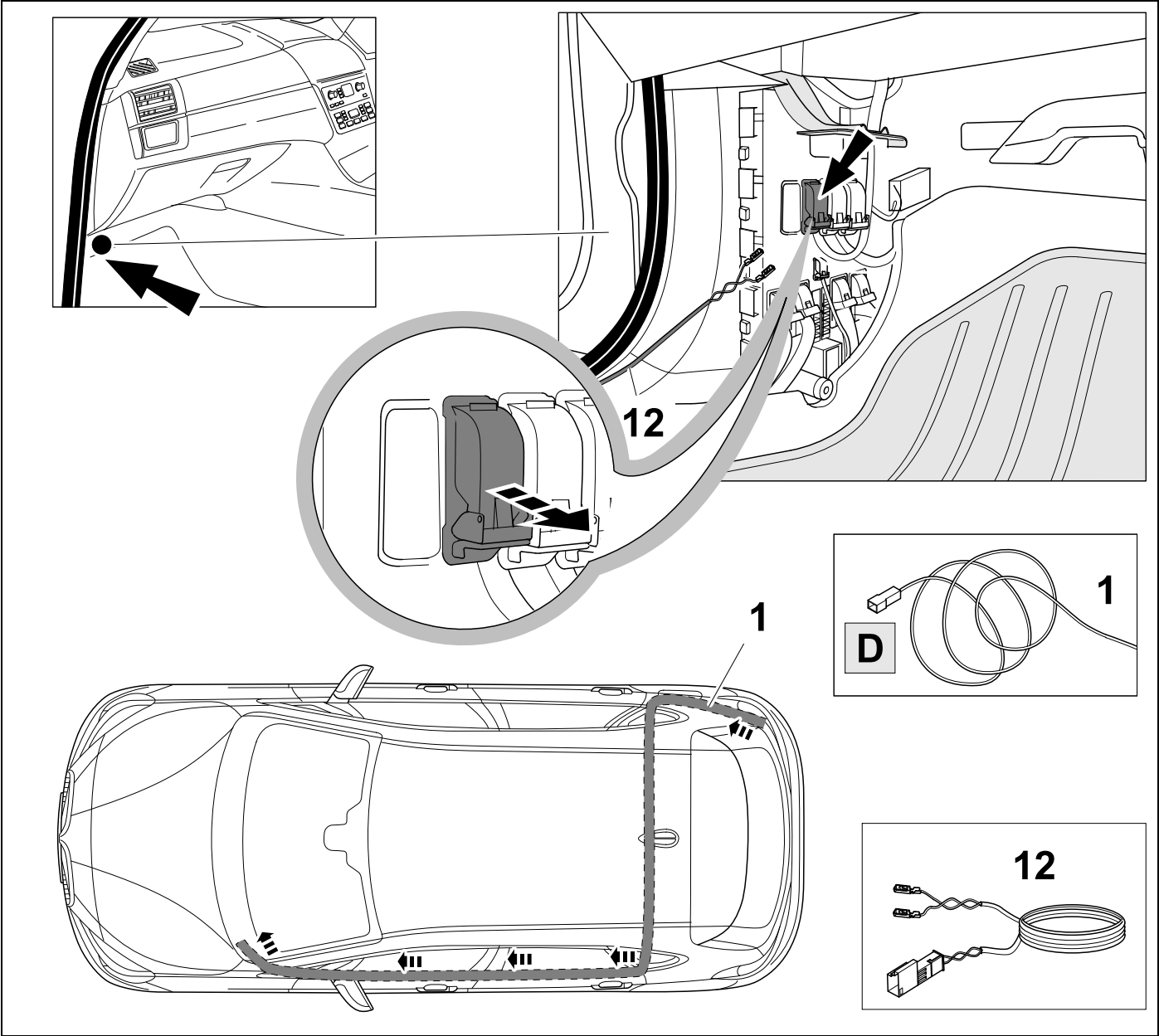

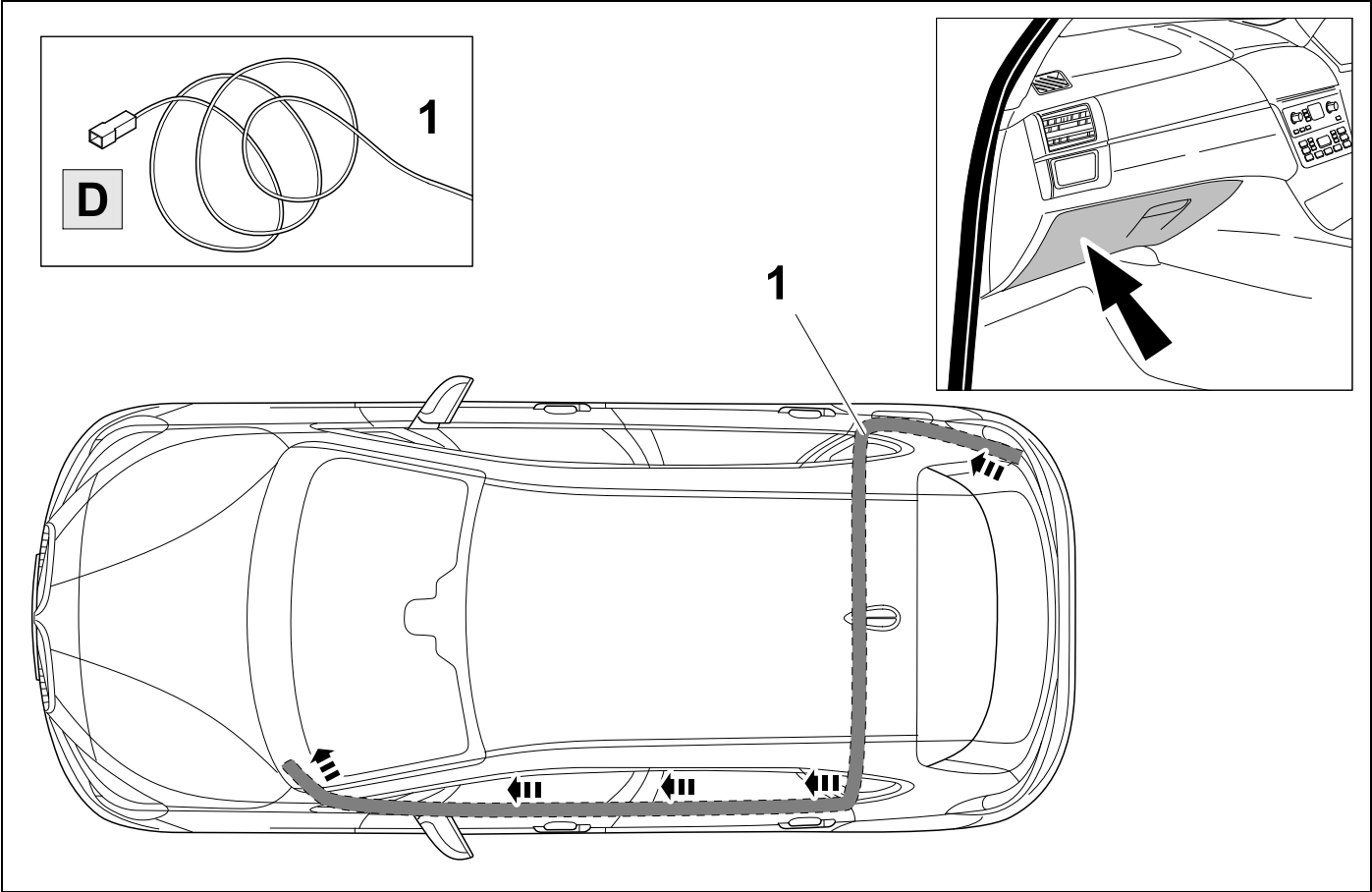
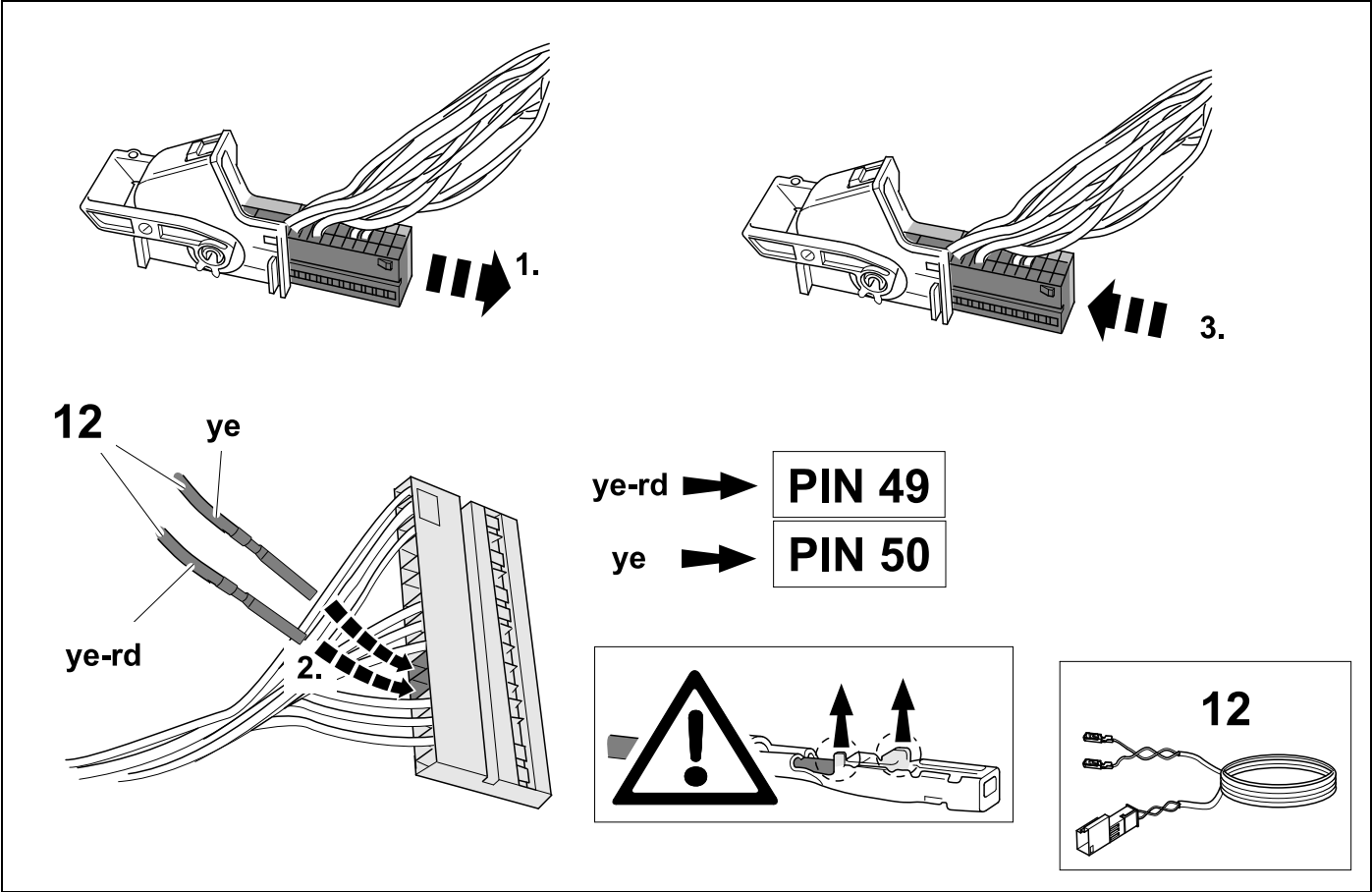

25



31

+

37

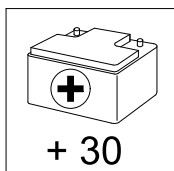

11

20A

D

1

rd

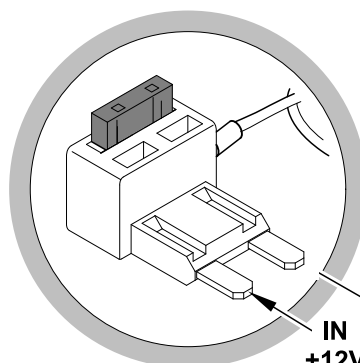
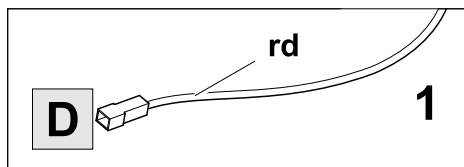

11

20A

26



37

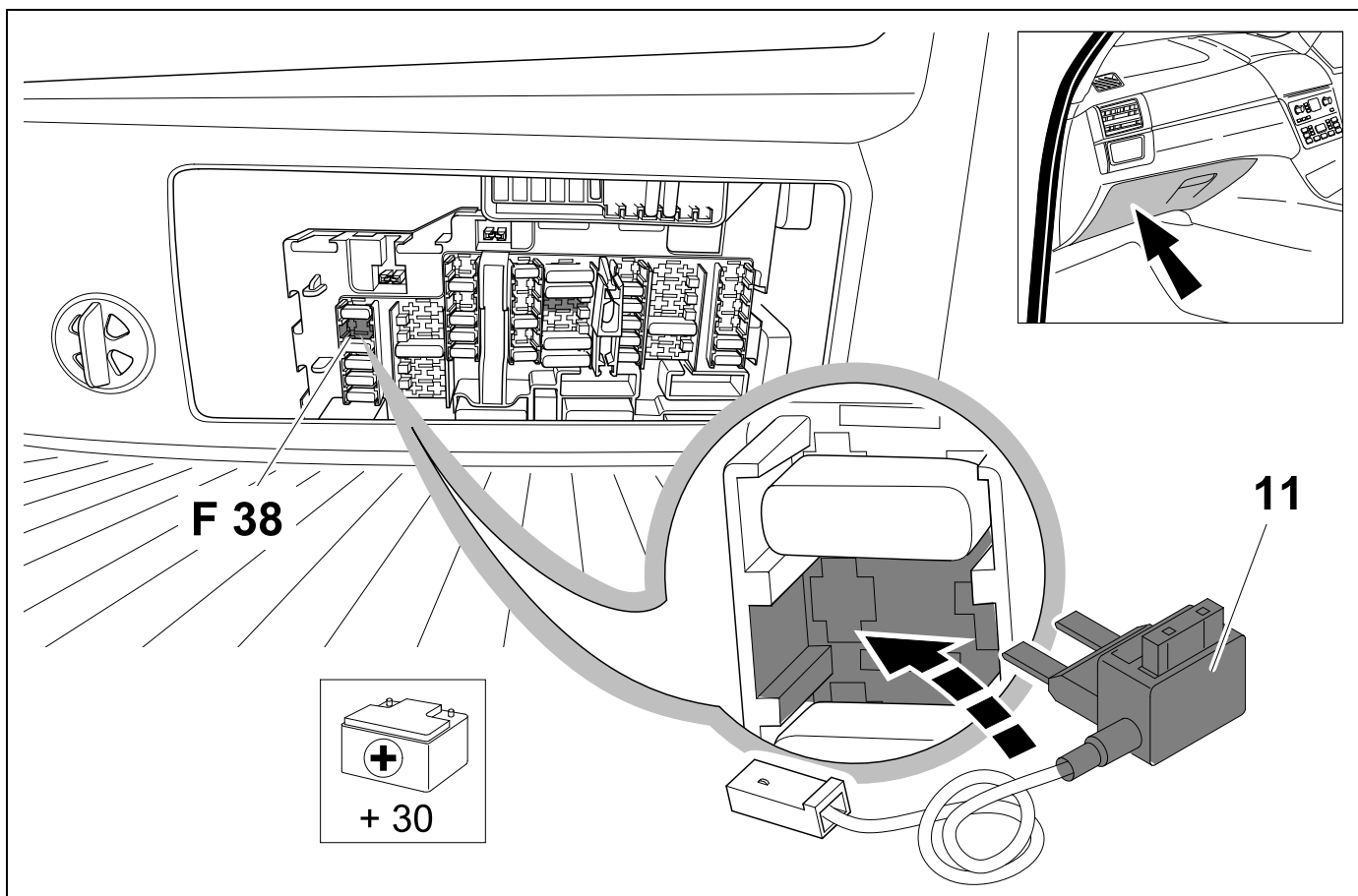

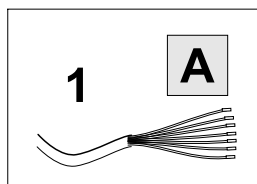
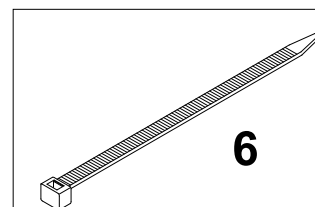
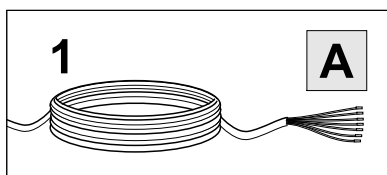
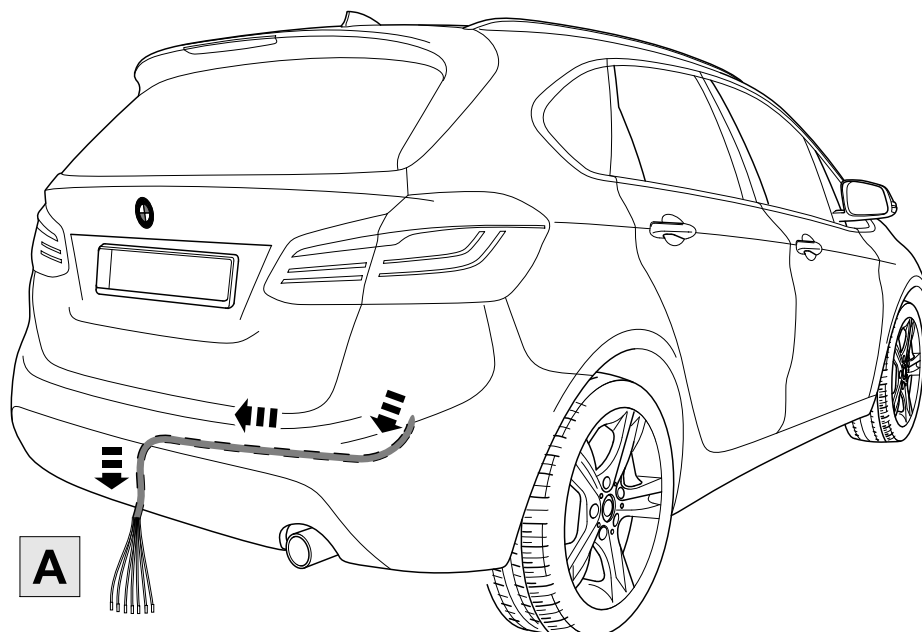

gn	4	
bn	7	
bk	2	
wh	3	
bu	5	
rd	6	
ye	1	

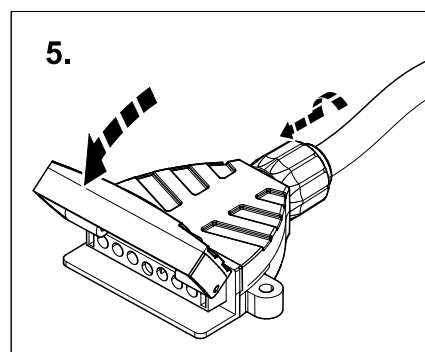
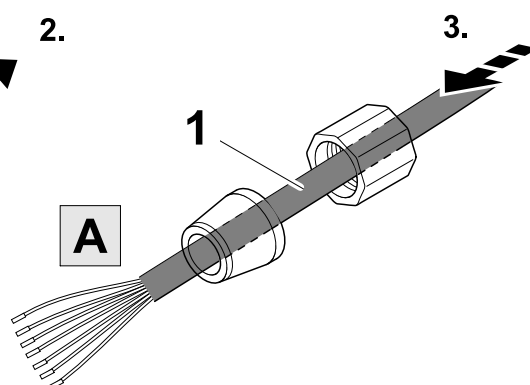
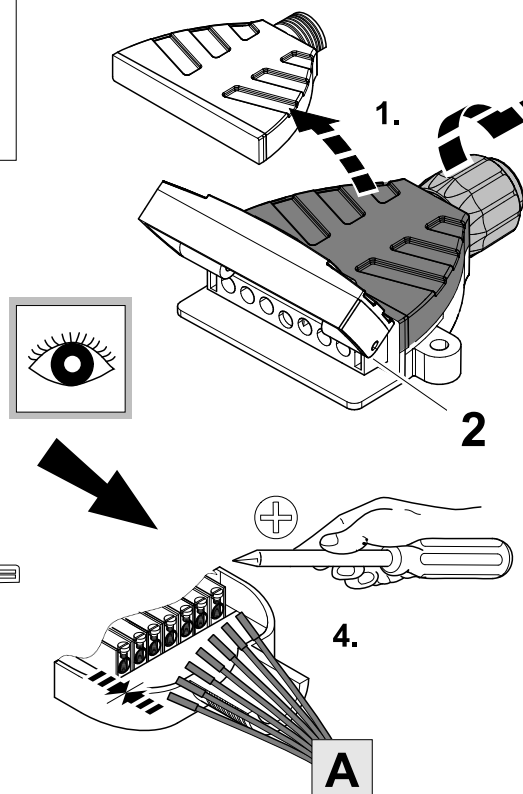

29

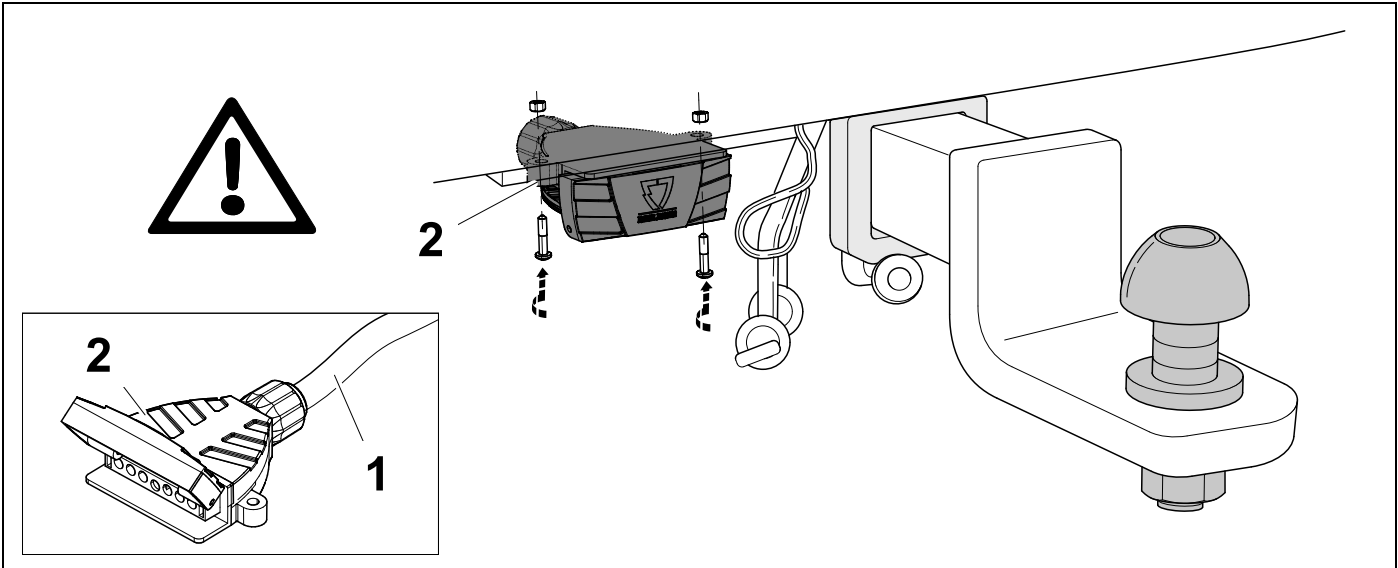

30



31

1	ye	
2	bk	
3	wh	
4	gn	
5	bu	
6	rd	
7	bn	

31	bk	wh	gy	gn	rd	bu	ye	bn	pu	or	no
	black	white	grey	green	red	blue	yellow	brown	purple	orange	not occupied



Trailer Brake Preparation

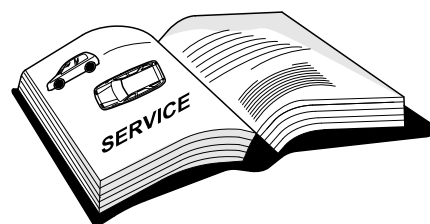
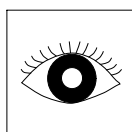
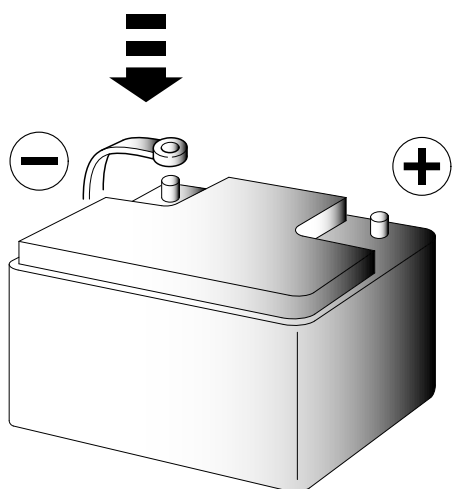
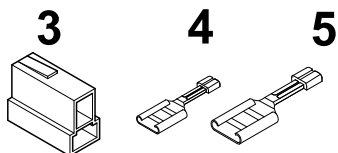
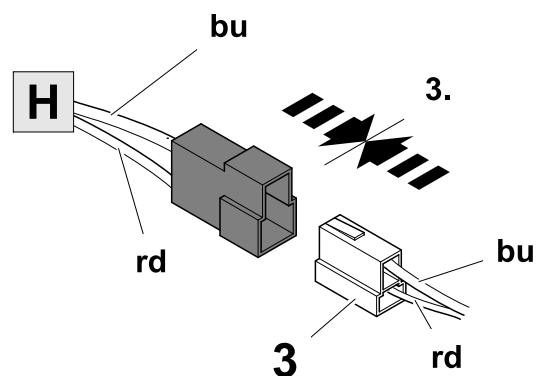
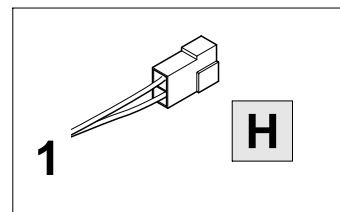
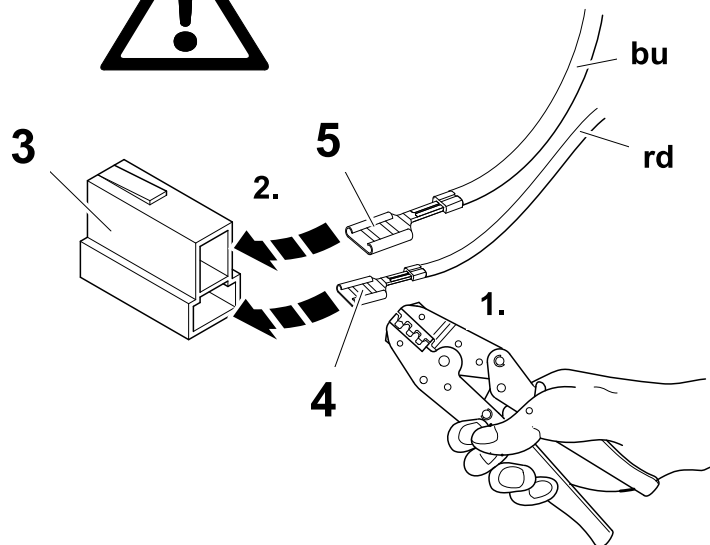



ISTA/P

Do not initialize Trailer Modul

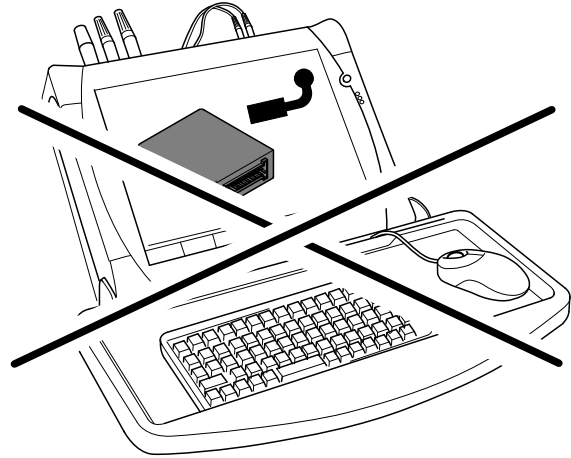

35 CHECK ALL LIGHTING FUNCTIONS

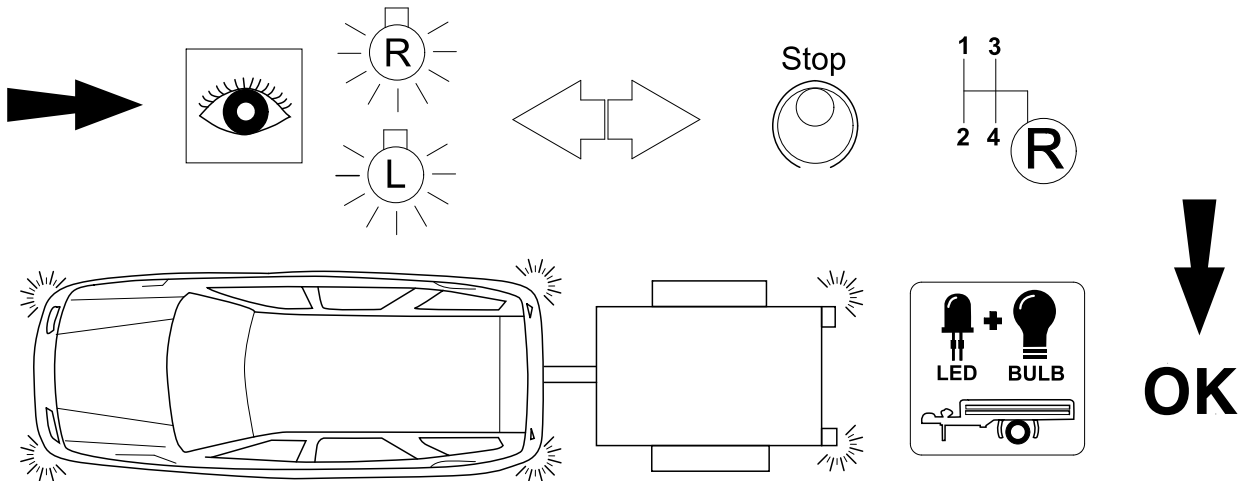

36 CHECK BULB OUT DETECTION

BULB OUT CONDITION INDICATED WITH
INCREASED INDICATOR FREQUENCY

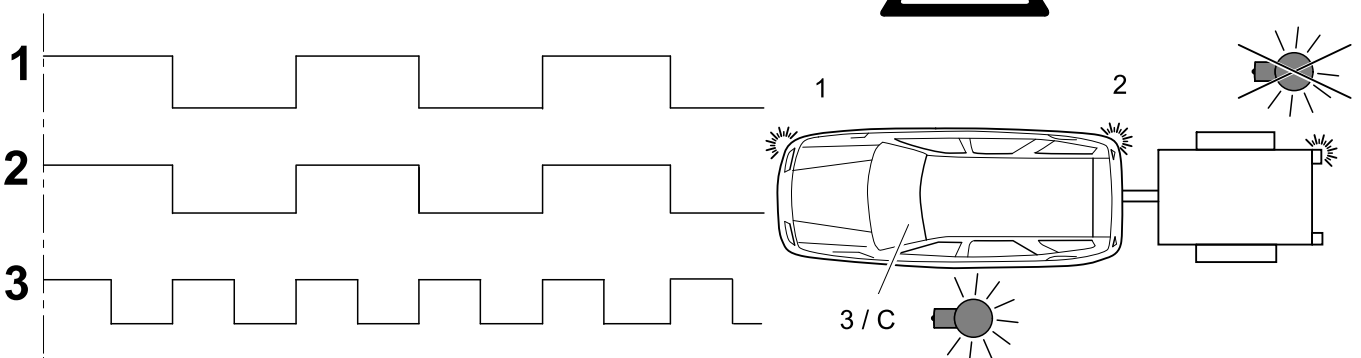

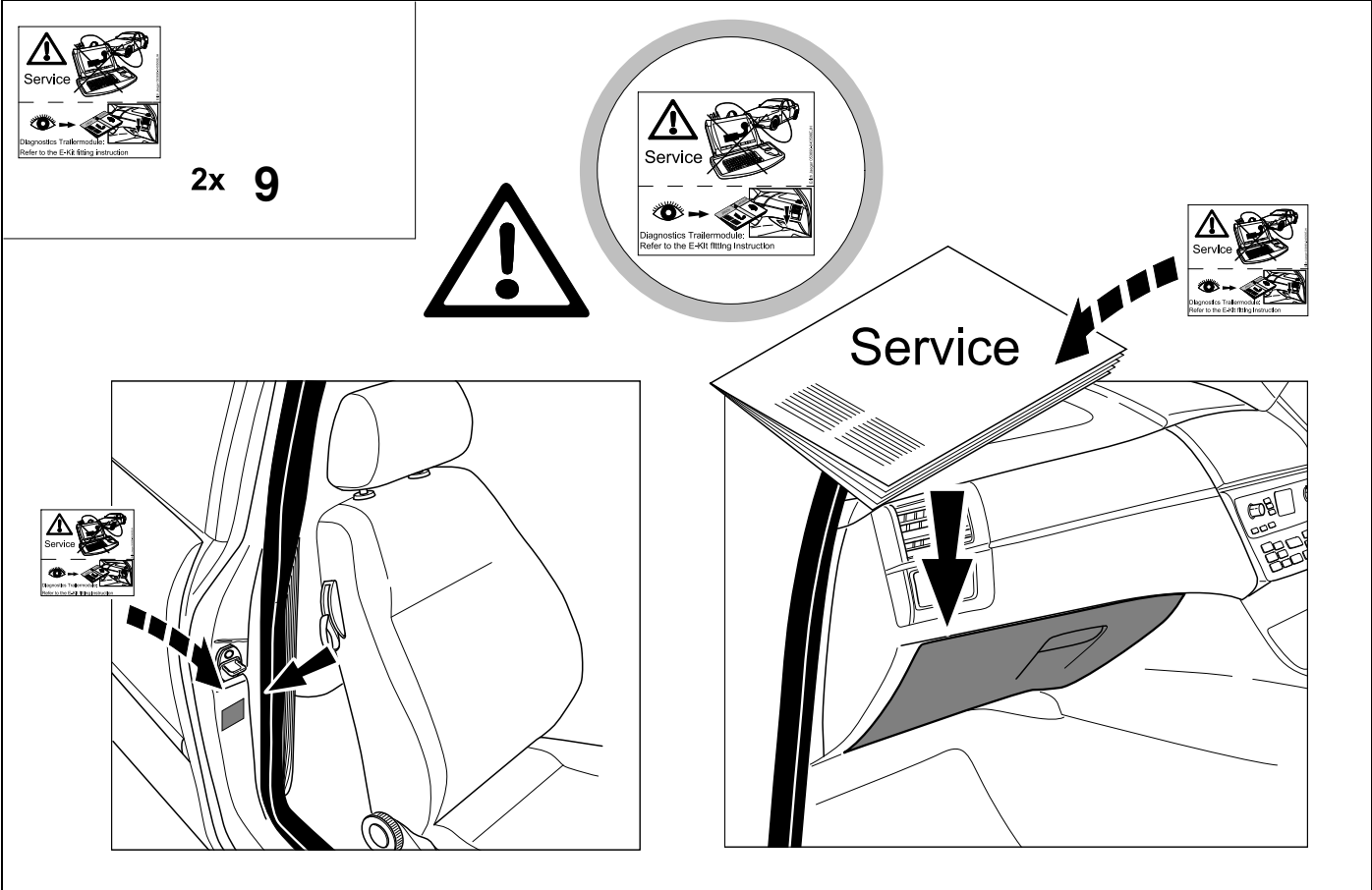
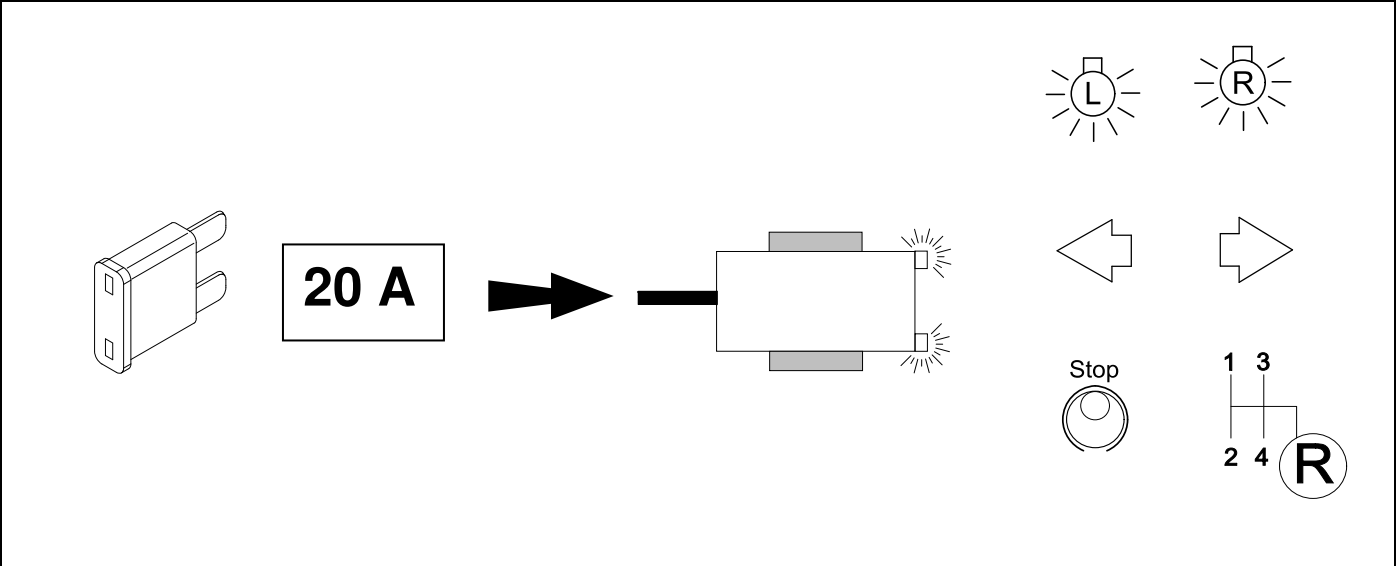

Operation Support

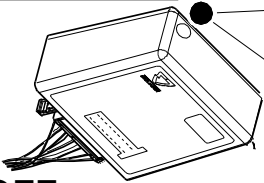
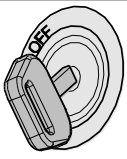

No CAN-Data =



Standby / Sleepmode



Ignition OFF

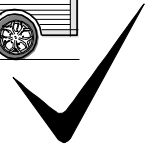
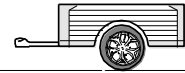
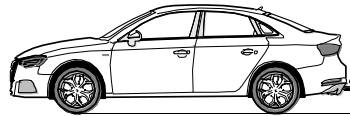
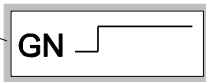
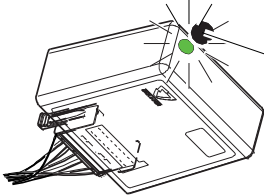

Ignition ON

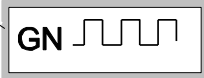
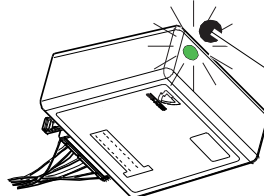

Ignition ON

Failure Support

CAN-Data Wire



1x max. 5 min.

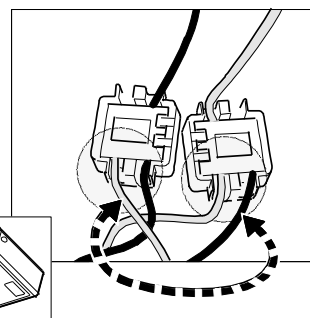
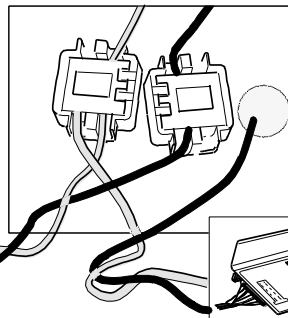
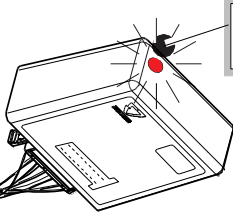
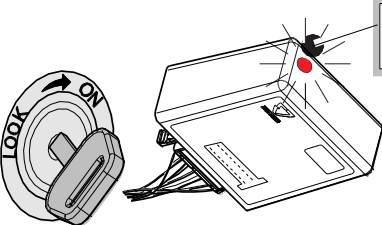

Ignition ON

Failure indicated by the module LED glowing red for a maximum of 5 minutes. If trailer connected the tail lights will also glow indicating failure of CAN signal.

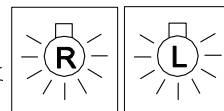

Ignition ON

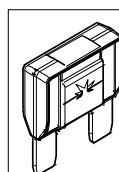
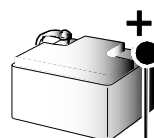
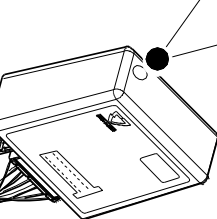

or

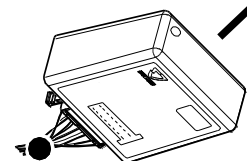
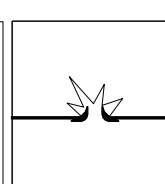
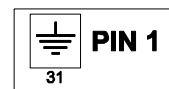

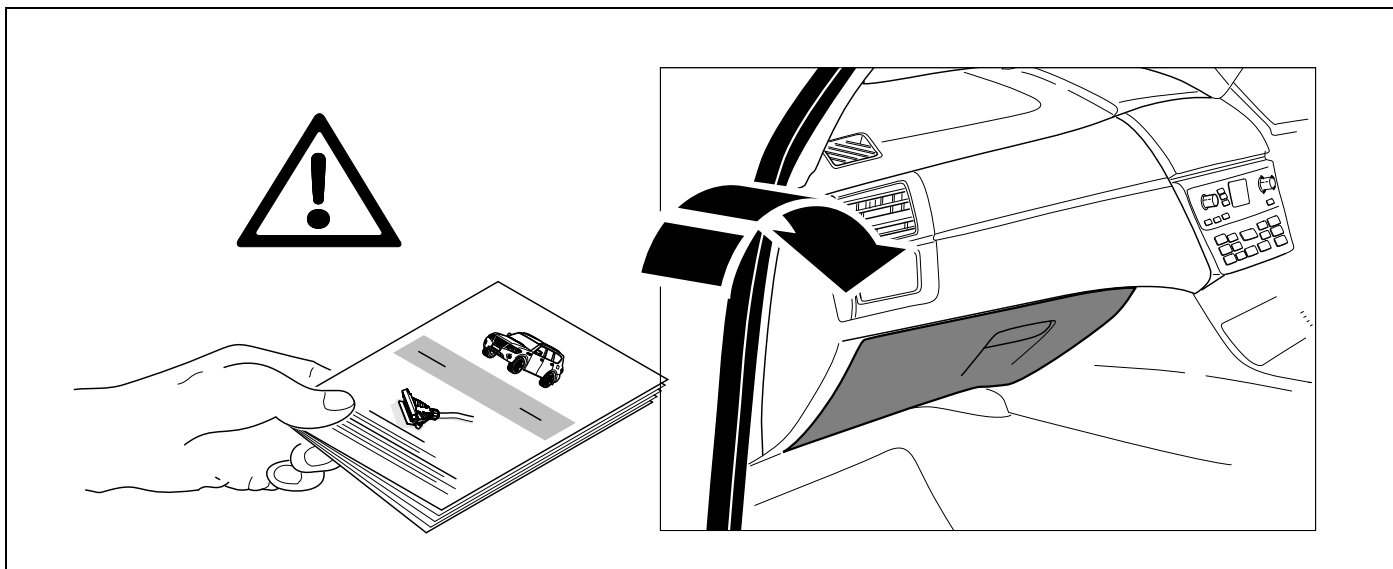

Subject to change in terms of construction, equipment and colour, and may contain errors.
The information and illustrations are non-binding.