



Towbar Fitting Instructions
To Suit BMW 3 SERIES E90 2009 ON (NOT M SERIES)
Part Number BM5L
Rating 1600/160kg

PLACE THESE INSTRUCTIONS IN THE VEHICLE'S GLOVEBOX AFTER INSTALLATION IS COMPLETE

WARNING:

1. Do not, drill, cut, weld or otherwise modify the tow bar.
2. If you are using electric welding on a motor vehicle, **always** check that the vehicle is not equipped with electronic engine or instrument management equipment. Failure to do so could **destroy** any onboard computers. If in doubt, check with the vehicle's manufacturer.
3. The high tensile fasteners supplied with this product were used to achieve the specified rating. If replacement is required ensure that fasteners of the same rating & quality are used. Contact an authorised **Trailboss** dealer if further information is required.

General:

1. Ensure all hardware items have been included refer to assembly diagram.
2. It is recommended that the instructions are read through and completely understood before making any attempt to fit this product.
3. Be wary of any changes to vehicle designs or other accessories that may conflict with the installation of this product.
4. Before drilling ensure that the area is clear of fuel, electrical & other components.
5. All holes drilled into the body panels shall have all burrs & swarf removed then coated with a suitable rust preventative paint.
6. For vehicles that require the bumper to be cut. Ensure cut out area is in correct position on the vehicle prior to cutting the bumper.
7. The high tensile fasteners supplied with this product were used to achieve the specified rating. If replacement is required ensure that fasteners of the same rating & quality are used. Contact an authorized **Trailboss** dealer if further information is required.
8. Ensure that all hardware is fastened to torque list below check fasteners on regular basis.
9. Tow bar load rating sticker provided with this product shall be conspicuously located on inside rear end of the driver's door. **(See diagram below).**
10. Trailboss recommends that you check your tow ball to ensure that it complies with the Australian standards **AS 4177.2.**
11. **PLEASE NOTE:** It is advised to remove your lug or tbm when not actually towing so as to produce a clear view of the vehicles registration plate if obscured, and to also provide maximum available departure angle
12. Pull Pin must be fit in down position.

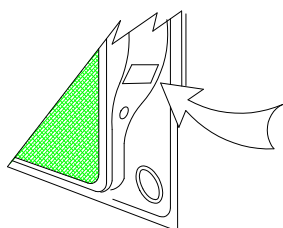

Place load rating sticker inside driver's door here

FOR TRAILER TOWING PURPOSES ONLY
 For towing capacity details please refer to vehicle owner's manual or to the manufacturer. Overloading can void your warranties.

RECOMMENDED ASSEMBLY TORQUE LISTING	
Diameter	Grade 8.8 Bolt
M6	9.5 Nm
M8	21.7 Nm
M10	43.4 Nm
M12	77.3Nm
M14	146 Nm
M16	189.8 Nm

Tow bar Maintenance and Care.

Trailboss recommends that bolt torque's, as listed below, are routinely and regularly inspected and checked for correct tension. Replace any worn or defective parts.
 We recommended to remove Tow Ball Mounts (TBM's, tongues or lugs) when not being used for any considerable length of time.
 So as to avoid injury, when not towing it is suggested that the tongue, Pull Pin and R-clip are removed then stored in a safe, clean and dry place, away from excessive moisture.
 Hitch Pull Pins and spring "R" clips are regularly checked for proper installation. Replace any worn or defective parts.



Towbar Fitting Instructions
 To Suit **BMW 3 SERIES E90 2009 ON (NOT M SERIES)**
 Part Number **BM5L**
 Rating **1600/160kg**

PLACE THESE INSTRUCTIONS IN THE VEHICLE'S GLOVEBOX AFTER INSTALLATION IS COMPLETE

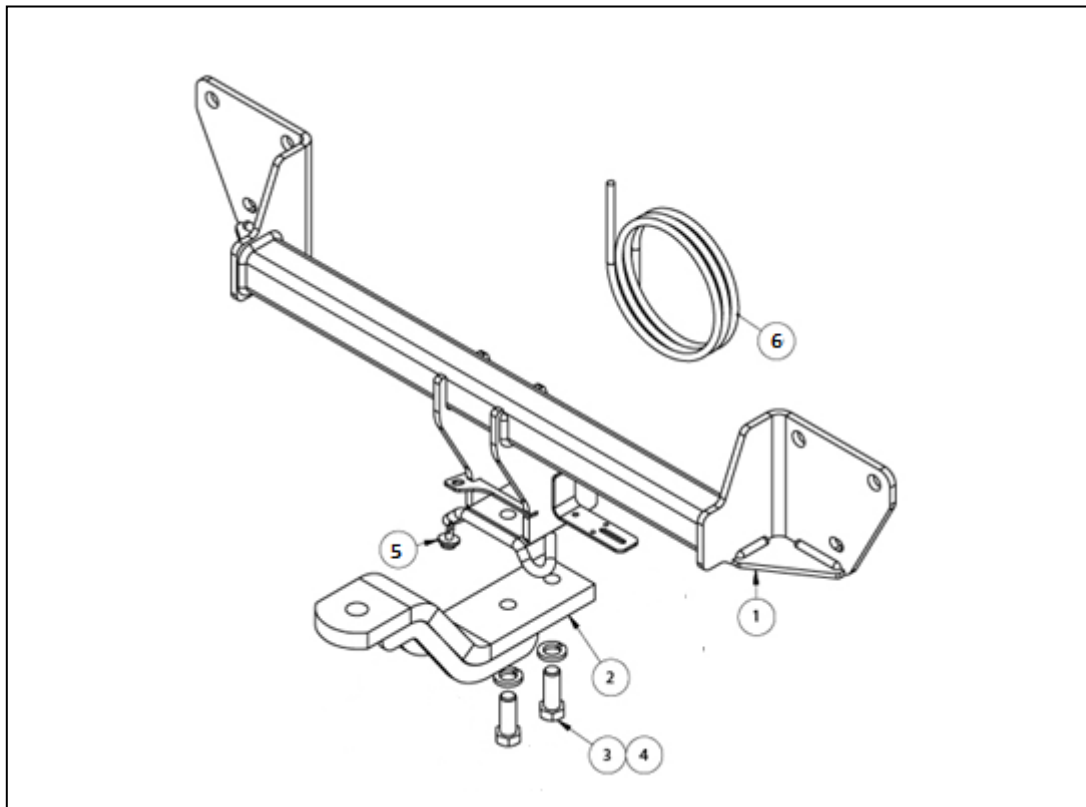

QTY	DESCRIPTION	ITEM NO
1	TOWBAR	1
1	LUG ASSEMBLY	2
2	BOLT M16x45 2.0P	3
2	SPRING WASHER M16	4
1	BUMPER SCRIVET	5
1	WIRING LOOM	6

ADDITIONAL ITEMS

 FITTING INSTRUCTION

 LR LABEL

 CP LABEL



Towbar Fitting Instructions
To Suit BMW 3 SERIES E90 2009 ON (NOT M SERIES)
Part Number BM5L
Rating 1600/160kg

PLACE THESE INSTRUCTIONS IN THE VEHICLE'S GLOVEBOX AFTER INSTALLATION IS COMPLETE

INSTRUCTION:

1. Remove Rear Trim from inside of boot to access RHS Tail Light assembly. Remove 3 Nuts and remove Tail Light, place in a safe place. Repeat for LHS.
2. Remove Plastic Cover on Bumper near RHS Tail Light to expose Torx Head Screw. Remove Screw. Repeat for LHS.
3. Remove 3 Screws from inside rear RHS Wheel Arch. Repeat for LHS.
4. Inside of LHS Wheel Arch, pull cover to the side to expose a vertical Screw. Remove and repeat for RHS.
5. Remove 5 Screws from underneath of Bumper on the RHS.
6. Remove 3 Screws from underneath of the Bumper on the LHS.
7. Remove 3 Screws from underneath of Bumper center. Remove 3 Screws to dislodge the small plastic under-body panel. (Plastic cover will not be fitted when Towbar is attached)
8. Carefully remove Bumper by dislodging it from Clips on rear Quarter Panel and underneath Tail Lights. Pull Bumper towards the rear of the car. To avoid breaking the bumper clips, do not pull away from the quarter panel and instead slide the fascia rearwards.
9. Once bumper is loose, disconnect any Rear Reverse Sensors. Place Bumper in a safe place.
10. Remove and retain 6 Nuts from Impact Beam and offer Towbar to M12 studs. Loosely fasten using M12 Nuts from Impact Beam.
11. Tighten fasteners to torque listed.
12. Re-attach bumper in reverse order. Use the supplied Scrivet to attach Bumper to Towbar Bracket.



Wiring Loom Fitting Instructions
To Suit BMW X1, 3 Series, X5 & X6
Part Number 100854-WL

Wiring Loom Installation Instructions

BMW X1, 3 Series, X5 & X6
Part No: 100854-WL

ECU Required For X1 (2009 – 2011), X5, X6: 04829
ECU Required For X1 (2011 – Onwards), 3 Series: 04838

X1, X5, X6 Tail Harness Length Required: 1800mm
3 Series Tail Harness Length Required: 1200mm

Wiring Loom Installation Time: Approx 50 Mins

X1 – Pages 2-3
3 Series – Pages 4-6
X5 & X6 – Pages 7-8



Wiring Loom Fitting Instructions
To Suit BMW X1, 3 Series, X5 & X6
Part Number 100854-WL

The following steps are for BMW X1 models only. For 3 Series models, please proceed to page 4. For X5 & X6, please proceed to page 7.

1. In the luggage compartment, remove the floor carpet cover.
2. Remove the storage compartment tray.
3. Remove the rear trim by first removing the fasteners from the cargo hook tie-downs.
4. Remove the RHS access panel cover.
5. Route the trailer patch (P/No: 100854-WL) underneath the RHS side trim towards the RHS tail light assembly connector.
6. Remove the LHS storage compartment.
7. Underneath the LHS storage compartment remove the vehicle grommet.
8. Drill out the grommet hole to Ø30mm. File any rough or sharp edges and spray on rust inhibitor.
9. Following the table below, connect the ezy-taps to the vehicle harness wires, then connect the trailer patch terminals to the corresponding wires.

Function	Trailer Patch	Vehicle Connector
R.IND	GREEN/BLACK	BLUE/BROWN
REVERSE	BLACK/WHITE	BLACK/PURPLE
TAIL/BRAKE	BROWN/BLACK X1 / 3 SERIES	BLACK/BLUE

10. Route the trailer patch across the rear of the luggage compartment towards the LHS of the vehicle.
11. Following the table below, connect the ezy-tap to the vehicle harness wire, then connect the trailer patch terminal to the corresponding wire.

Function	Trailer Patch	Vehicle Connector
L.IND	YELLOW / BLACK	BLUE / GREEN

12. Connect the trailer patch power ring terminal to the vehicle battery positive terminal.
13. Connect the trailer patch ground ring terminal to the vehicle battery negative terminal.
14. Connect the trailer patch 12-way connector to the ECU.
15. Slot the ECU into one of the vacant slots on the RHS foam compartment.
16. Route the tail harness (tail length 1800mm) through the previously drilled out grommet hole towards the towbar.
17. Mount the trailer socket to the towbar mounting bracket using M4 fasteners (not supplied).



Wiring Loom Fitting Instructions
To Suit BMW X1, 3 Series, X5 & X6
Part Number 100854-WL

18. Ensure the tail harness grommet is seated correctly and secured in place using a cable tie (not supplied).
19. Connect the trailer patch 8-way connector to the tail harness mating connector.
20. Test the trailer socket using a light board or multi-meter.
21. Secure the all harnesses using cables ties (not supplied).
22. Re-fit all removed parts and secure all fasteners.
23. Place instructions in glove box after fitment.

Wiring Loom Fitting Instructions To Suit BMW X1, 3 Series, X5 & X6 Part Number 100854-WL

The following steps are for BMW 3 Series models only. For X1 models, please refer to page 2. For X5 & X6, please proceed to page 7.

1. In the luggage compartment, remove the floor carpet cover.
2. Remove the rear luggage compartment trim by first removing the two screws and the four clips.
3. On the RHS of the luggage compartment, locate the storage tray clip, turn 90° to release and remove the storage tray.
4. Remove the two fasteners and dislodge the luggage compartment trim.

Repeat steps 3 & 4 for the LHS.

5. On the RHS rear quarter panel inside the luggage compartment, remove the vehicle blanking grommet.

Note: If existing grommet hole is occupied, drill a Ø30mm (1) in the location shown.

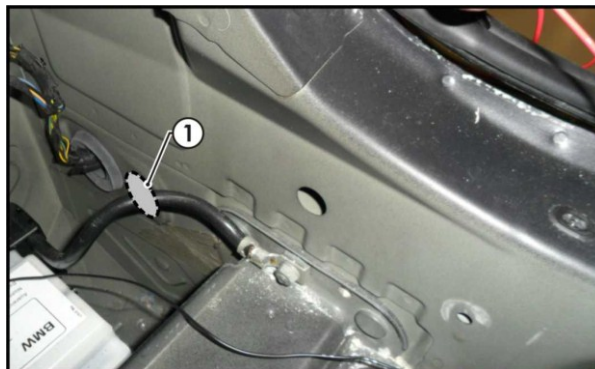

6. Following the table below, connect the ezy-tap (1) to the vehicle harness wire (2), then connect the trailer patch terminal (3) to the ezy-tap (1).

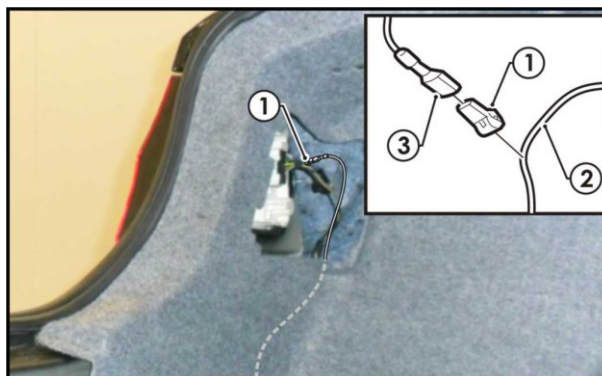

Function	Trailer Patch	Vehicle Connector
L.IND	YELLOW / BLACK	BLUE / GREEN

Wiring Loom Fitting Instructions To Suit BMW X1, 3 Series, X5 & X6 Part Number 100854-WL

7. Route the trailer patch (P/No:100854-WL) (1) along the rear of the luggage compartment towards the RHS.
8. On the RHS of the luggage compartment, following the table below, connect the ezy-taps (1) to the vehicle harness wires (2), then connect the trailer patch terminals (3) to the corresponding wires (2).

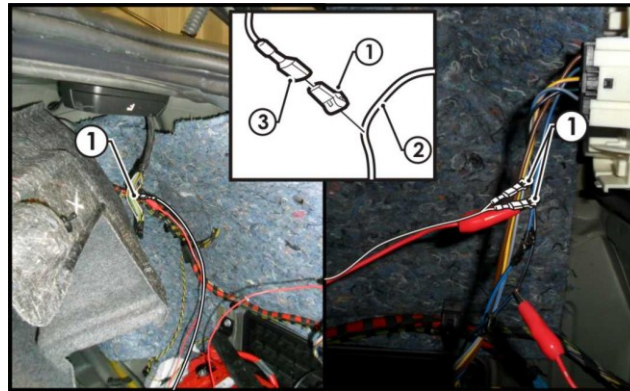

Function	Trailer Patch	Vehicle Connector
R.IND	GREEN/BLACK	BLUE/BROWN
REVERSE	BLACK/WHITE	BLACK/PURPLE
TAIL/BRAKE	BROWN/BLACK X1 / 3 SERIES	BLACK/BLUE

9. Connect the trailer patch power ring terminal to the vehicle battery positive terminal.
10. Connect the trailer patch ground ring terminal to the vehicle battery negative terminal.
11. Connect the trailer patch 12-way connector to the ECU (04838).
12. Apply double sided tape to the ECU and adhere it to the vehicle sheet metal on the RHS of the rear quarter panel of the luggage compartment.
13. Route the tail harness (tail length 1200mm) through the previously drilled out grommet hole towards the towbar.
14. Mount the trailer socket to the towbar mounting bracket using M4 fasteners (not supplied).
15. Ensure the tail harness grommet is seated correctly and secure in place using a cable tie (not supplied).
16. Connect the trailer patch 8-way connector to the tail harness mating connector.



Wiring Loom Fitting Instructions
To Suit BMW X1, 3 Series, X5 & X6
Part Number 100854-WL

17. Test the trailer patch function using a Light Board or multimeter.
18. Secure all harness using cable ties (not supplied).
19. Re-fit removed parts and secure all fasteners, ensuring there are no squeaks or rattles.
20. Place instructions in glove box after fitment.



Wiring Loom Fitting Instructions
To Suit BMW X1, 3 Series, X5 & X6
Part Number 100854-WL

The following steps are for BMW X5 & X6 models only. For X1 models, please refer to page 2. For 3 Series, please refer to page 4.

1. In the luggage compartment remove the floor carpet cover.
2. Remove the LHS & RHS access panel covers.
3. Remove the tool storage tray by first removing the fasteners.
4. Remove the LHS storage compartment.
5. Remove the RHS storage compartment.
6. In the RHS of the luggage compartment lift up the carpet cover and remove the vehicle grommet.
7. From the outside of the vehicle drill out the grommet hole to Ø30mm. File any rough or sharp edges and spray on rust inhibitor.
8. Following the table below, connect the ezy-tap to the vehicle harness wire and then connect the trailer patch terminal to the corresponding wire.

Function	Trailer Patch	Vehicle Connector
L.IND	YELLOW / BLACK	BLUE / BROWN

For MY10 X5 Vehicles:

Function	Trailer Patch	Vehicle Connector
L.IND	YELLOW / BLACK	GREEN / BLUE

9. Route the trailer patch (P/No:100854-WL) along the vehicle harness towards the RHS tail light connector.
10. Following the table below, connect the ezy-taps to the vehicle harness wires and then connect the trailer patch terminals to the corresponding wires.

Function	Trailer Patch	Vehicle Connector
R.IND	GREEN / BLACK	BLUE / BROWN
REVERSE	BLACK / WHITE	BLACK / YELLOW
TAIL	BROWN / BLACK (X5 & X6)	YELLOW / PURPLE
BRAKES	RED / BLACK	BLACK / WHITE

For MY10 X5 Vehicles:

Function	Trailer Patch	Vehicle Connector
R.IND	GREEN / BLACK	BLUE / BROWN
REVERSE	BLACK / WHITE	BLUE / YELLOW
TAIL	BROWN / BLACK (X5 & X6)	YELLOW / PURPLE
BRAKES	RED / BLACK	BLACK / BLUE



Wiring Loom Fitting Instructions
To Suit BMW X1, 3 Series, X5 & X6
Part Number 100854-WL

11. Connect the trailer patch 12-way connector to the ECU (No: 04829).
12. Slot the ECU into the vacant slot underneath the fuse panel.
13. Connect the trailer patch 8-way connector to the tail harness (tail length 1200mm) mating connector.
14. Route the tail harness through the previously drilled out grommet hole towards the towbar.
15. Mount the trailer socket to the towbar mounting bracket using M4 fasteners (not supplied).
16. Ensure the tail harness grommet is seated correctly and secured in place using a cable tie (not supplied).
17. Test the trailer socket using a light board or multi-meter.
18. Secure the all harnesses using cables ties (not supplied).
19. Re-fit all removed parts and secure all fasteners.
20. Place the instructions in the glove box after fitment.