

TRAILBOSS

Tow bar Fitting Instructions To Suit Ford FG Falcon Sedan & Fairlane Including XR6, XR8 & G6 Part Number FD132L Rating 1600 Kg Max Static Ball Load 160Kg

WARNING:

1. Do not, drill, cut, weld or otherwise modify the tow bar.
2. If you are using electric welding on a motor vehicle, **always** check that the vehicle is not equipped with electronic engine or instrument management equipment. Failure to do so could **destroy** any onboard computers. If in doubt, check with the vehicle's manufacturer.

General:

1. Ensure all hardware items have been included refer to assembly diagram.
2. It is recommended that the instructions are read through and completely understood before making any attempt to fit this product.
3. Be wary of any changes to vehicle designs or other accessories that may conflict with the installation of this product.
4. Before drilling ensure that the area is clear of fuel, electrical & other components.
5. All holes drilled into the body panels shall have all burrs & swarf removed then coated with a suitable rust preventative paint.
6. The high tensile fasteners supplied with this product were used to achieve the specified rating. If replacement is required ensure that fasteners of the same rating & quality are used. Contact an authorized **Trailboss** dealer if further information is required.
7. Ensure that all hardware is fastened to torque list below check fasteners on regular basis.
8. Tow bar load rating sticker provided with this product shall be conspicuously located on inside rear end of the driver's door. **(See diagram below).**
9. Trailboss recommends that you check your tow ball to ensure that it complies with the Australian standards **AS 4177.2**.
10. **PLEASE NOTE:** It is advised to remove your lug or tbn when not actually towing so as to produce a clear view of the vehicles registration plate if obscured, and to also provide maximum available departure angle.

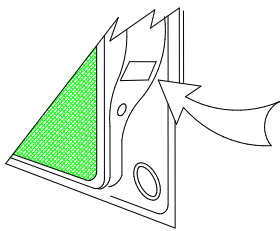

Place load rating sticker
inside driver's door here

FOR TOWING PURPOSES ONLY

For towing capacity details please refer to vehicle owner's manual or to the manufacturer. Overloading can void your warranties.

RECOMMENDED ASSEMBLY TORQUE LISTING

<u>Diameter</u>	<u>Grade 8.8 Bolt</u>
M6	9.5 Nm
M8	21.7 Nm
M10	43.4 Nm
M12	77.3 Nm
M16	189.8 Nm

Tow bar Maintenance and Care.

Trailboss recommends that bolt torque's, as listed below, are routinely and regularly inspected and checked for correct tension. Replace any worn or defective parts.

We recommended to remove Tow Ball Mounts (TBM's, tongues or lugs) when not being used for any considerable length of time.

So as to avoid injury, when not towing it is suggested that the tongue, Pull Pin and R-clip are removed then stored in a safe, clean and dry place, away from excessive moisture.

Hitch Pull Pins and spring "R" clips are regularly checked for proper installation. Replace any worn or defective parts.

Tow bar Fitting Instructions
To Suit Ford FG Falcon Sedan & Fairlane Including XR6, XR8 & G6
Part Number FD132L
Rating 1600 Kg Max Static Ball Load 160Kg

11. Remove rear bumper bar skin via

- Remove 3 x plastic scrivets from underside of bumper bar skin see fig 1.
- Remove 3 x plastic trim plugs from each wheel arch, one screw in the vertical plane & one screw in the horizontal plane see fig 2.
- Remove 3x plastic trim plugs from plastic trim inside boot cavity see fig 3.
- Remove plastic trim then fold carpet forward rear seats may need to be folded forward.
- Remove 1 x plastic trim plug each side of side carpet trim then fold back to gain access to tail light assemblies.
- Remove 3 x nuts from each tail light assembly then unplug wiring loom see fig 4.
- Remove tail light assemblies ensuring that grommet is pushed through panel see fig 5.
- Remove 2 x screws from underneath taillight cavity see fig 5.
- Remove 4 x plastic scrivets from underneath taillight cavity see fig 5.
- Caution** two person lift required flex bumper bar skin out at the sides then pull rear ward some force may be required to remove.

Underside of bumper



Remove x 3 plastic scrivets

Fig 1

Screw in vertical plane



Plastic trim plug

Fig 2

Remove one trim plug each side of vehicle then fold side trim forward

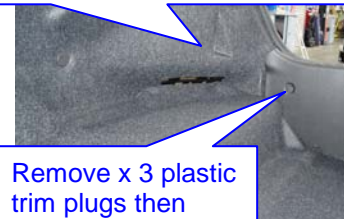

Remove x 3 plastic trim plugs then remove plastic trim

Fig 3

Remove x 3 nuts from each tail light assembly



Unplug tail light loom then remove tail light.

Fig 4

Remove x 2 plastic scrivets

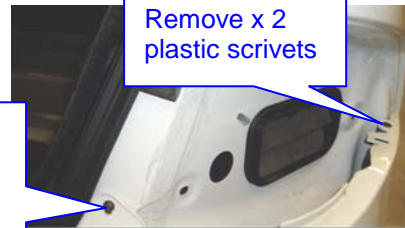

Remove screw from each side of vehicle.

Fig 5

12. Offer tow bar to vehicle sub frame

- Offer tow bar to the vehicle sub frame then fasten with driver side vertical mount with taptite bolt provided see fig 6.
- Fasten passenger side horizontal mounts with taptite bolts provided see fig 7.
- Using holes on driver's side plate as a guide drill pilot holes first then drill through 12.5mm see fig 8.
- Fit M 12 x 35 bolts flat & spring washers provided ensure that packer plate is fitted between side plate of tow bar & end of chassis mount see assembly detail for correct orientation of components.

Tow bar Fitting Instructions
To Suit Ford FG Falcon Sedan & Fairlane Including XR6, XR8 & G6
Part Number FD132L
Rating 1600 Kg Max Static Ball Load 160Kg

Vertical taptite bolt on the driver's side of vehicle drive in to bushes inside chassis rail.

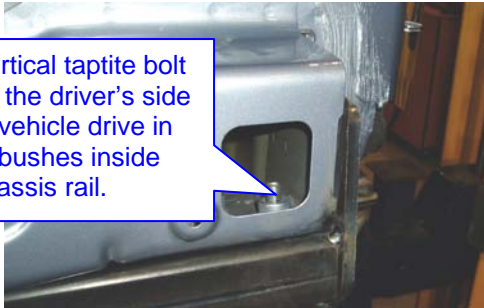

Fig 6

Horizontal taptite bolts on the passenger of the vehicle drive in to bushes inside chassis rail.



Fig 7

After drilling fit M12 x 35 bolts flat & spring washers with nuts provided then fasten to torque listing.



Fig 8

Using holes in side plates as a guide first pilot drill then drill out 12.5mm through outer panel only. Ensure that all swarf & filings are cleaned & all raw edges are coated with suitable rust preventative paint

13. Drill centre holes via

- Using the holes in the tow bar as a guide first pilot drill then drill out 11mm in two places see fig 9.
- Fit two bolt & loose plates on wire through access points on the rear panel of the vehicle so that bolts drop down through the holes just drilled through the panel.
- Fasten with M10 whizz nuts provided fasten to torque listing.
- Ensure that the wire on bolts is inside the chassis panel and not sticking out.

Using holes in cross tube as a guide drill up through bottom of panel pilot first then drill 11mm.

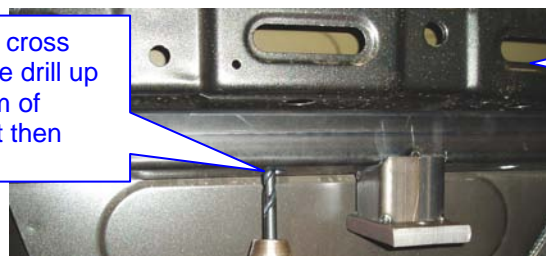

Fig 9

Feed bolt with plate on wire through these open panels each side of tow bar.

14. Fig 10 rear bumper bar cut for base XT model see fig 11 for XR & G6 bumper cut details. Note that bumper cut is only required for FG falcon models only. BA & BF models have pop out window just remove factory window no cutting is required for BA & BF models.

Tow bar Fitting Instructions To Suit Ford FG Falcon Sedan & Fairlane Including XR6, XR8 & G6 Part Number FD132L

Rating 1600 Kg Max Static Ball Load 160Kg

- Mark out then cut the rear bumper bar skin as shown in fig 10 ensure that all swarf and raw edges are filed so that cut is neat.
- Mark out then drill 35mm hole as shown in fig 10.

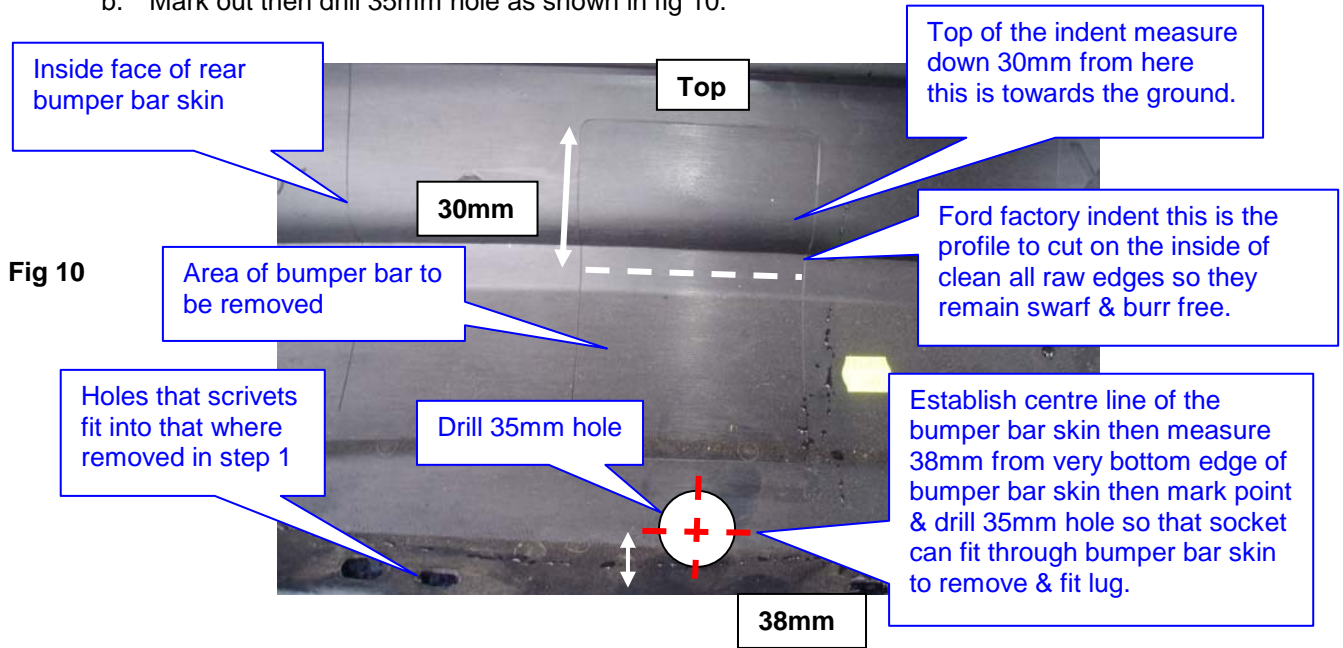

Bumper cut detail for XR6, XR8 & G6 models only

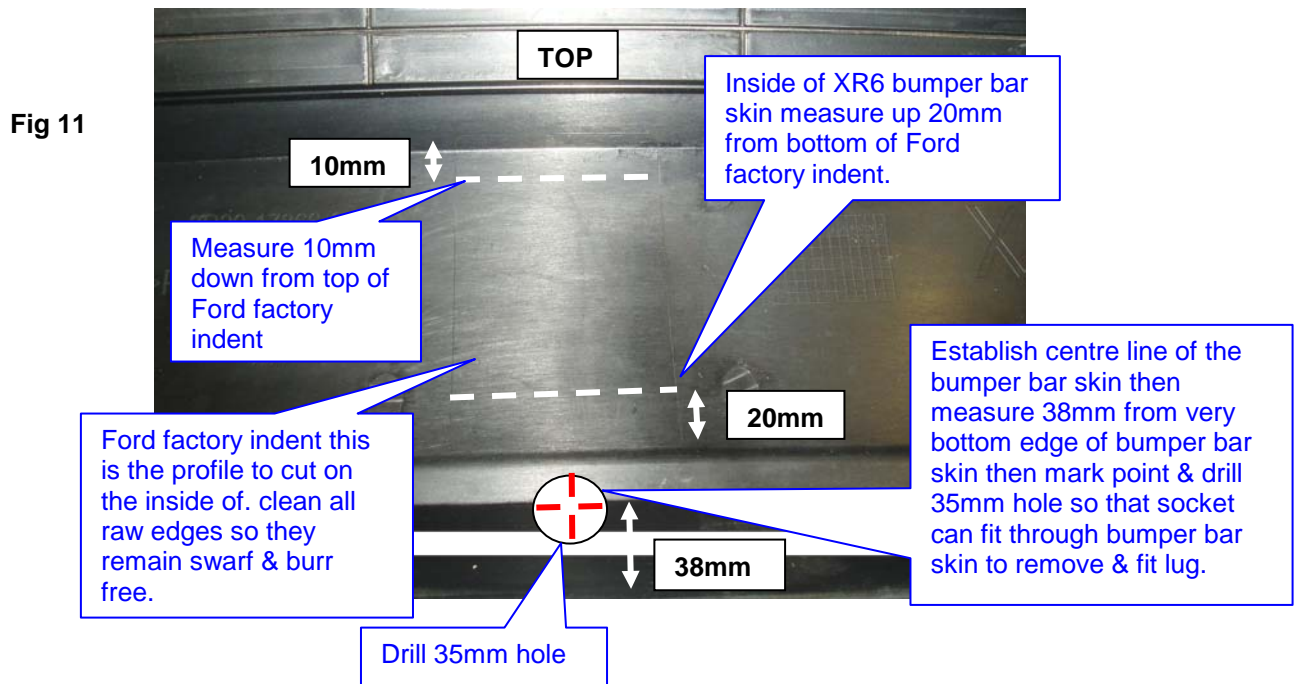

Tow bar Fitting Instructions
To Suit Ford FG Falcon Sedan & Fairlane Including XR6, XR8 & G6
Part Number FD132L
Rating 1600 Kg Max Static Ball Load 160Kg

15. Refit the rear bumper bar skin

- Refit the rear bumper bar skin in the reverse of steps 11h through to 11a
- Fit the tow bar tongue with the two 16 x 45 bolts & spring washers provided fasten to torque listing.
- Fit shackles to chain connection point.

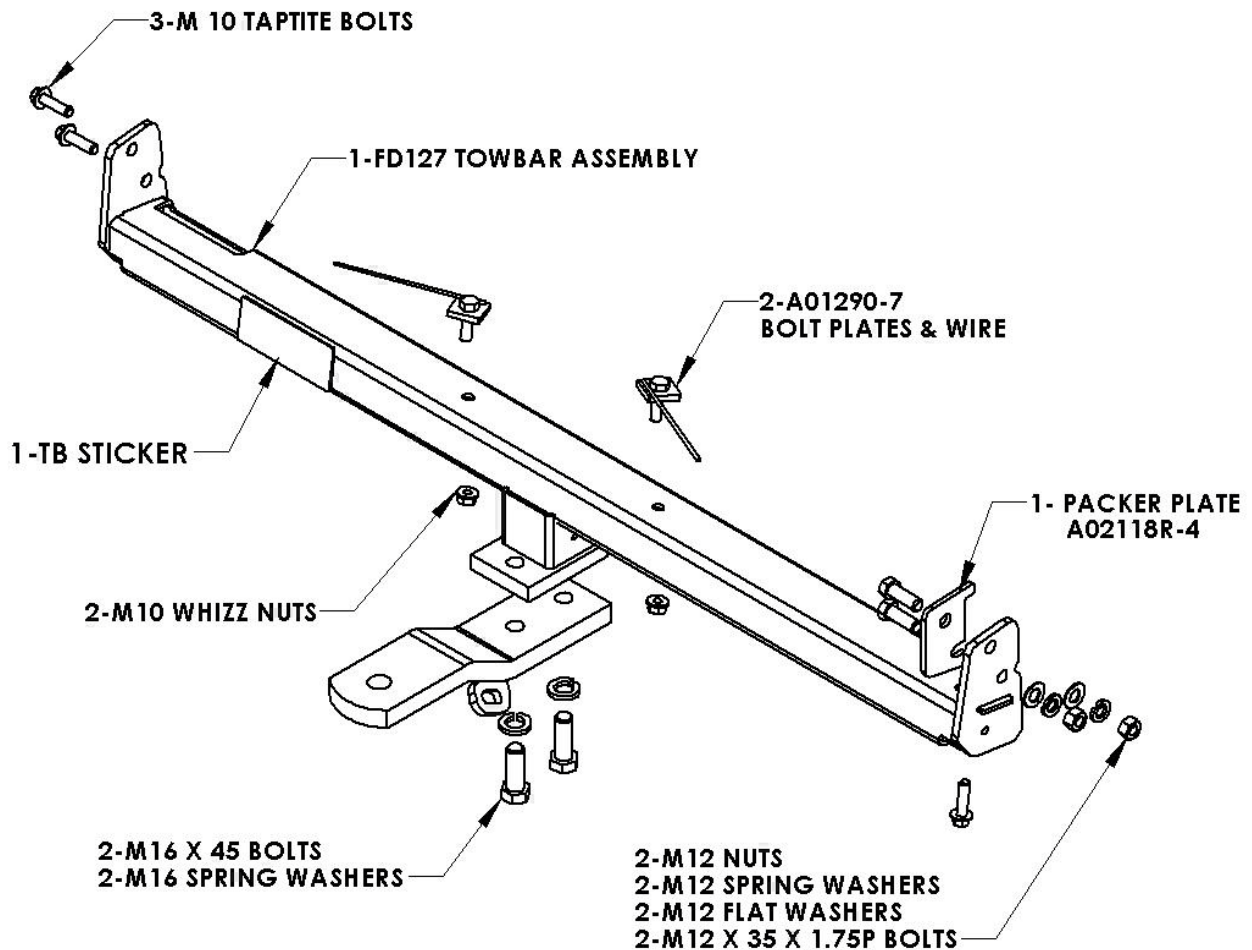



Wiring Loom Fitting Instructions
To Suit Ford EL Falcon
Ford FG Falcon G6/G6E/G6E Turbo
Part Number 100319-WL

Wiring Loom Installation Instructions

Ford EL Falcon
Ford FG Falcon / G6/G6E/G6E Turbo
Part No: 100319-WL

Tail Harness Length Required: 1200mm
RPA Override Switch Part No: 04848 (If Fitted)

Ford EL Falcon: Pages 2 – 3
Ford FG Falcon G6/G6E/G6E Turbo: Pages 4

Wiring Loom Installation Time: Approx. 30 Mins

TRAILBOSS

Wiring Loom Fitting Instructions To Suit Ford EL Falcon Ford FG Falcon G6/G6E/G6E Turbo Part Number 100319-WL

The following steps are for Ford EL Falcon models only. For Ford FG Falcon G6/G6E/G6E Turbo models, please proceed to page 4.

1. In the luggage compartment, remove the floor carpet cover.
2. Release the panel clip from the RHS luggage compartment trim.
3. Dislodge the RHS luggage compartment trim by first releasing the panel clip.
4. Drill a Ø30mm hole in the spare wheel well sheet metal.



5. File any rough or sharp edges and spray on rust inhibitor.
6. Locate and disconnect the RHS tail light connectors.
7. Connect the trailer patch (P/No 100319-WL) connectors between the tail light connectors.
8. Using a multimeter, locate the vehicle 'GREEN' LHS indicator signal wire.
9. Following the table below, connect the ezy-tap to the vehicle 'GREEN' LHS indicator signal wire.

Function	Trailer Patch	Vehicle Connector
L.IND	YELLOW	GREEN

10. Connect the trailer patch terminal to the ezy-tap.



Wiring Loom Fitting Instructions
To Suit Ford EL Falcon
Ford FG Falcon G6/G6E/G6E Turbo
Part Number 100319-WL

11. Route the trailer patch across the rear of the luggage compartment towards the previously drilled out hole.
12. Mount the trailer socket to the towbar mounting bracket using M4 fasteners (not supplied).
13. Route the tail harness (tail length 1200mm) along the towbar and up through the previously drilled out hole.
14. Ensure the tail harness grommet is seated correctly and makes a good seal.
15. Secure the grommet in place using a cable tie (not supplied).
16. Connect the tail harness 8-way connector to the trailer patch 8-way mating connector.
17. Test the trailer harness function using a light board or multimeter.
18. Secure all harnesses using cable ties (not supplied).
19. Re-fit all removed parts and secure all fasteners, ensuring there are no squeaks or rattles.
20. Place the instructions in the glove box after fitment.



Wiring Loom Fitting Instructions
To Suit Ford EL Falcon
Ford FG Falcon G6/G6E/G6E Turbo
Part Number 100319-WL

The following steps are for the Ford EL FG Falcon G6/G6E/G6E Turbo models only. For the Ford EL Falcon, please refer to page 2.

1. In the luggage compartment, remove the floor carpet cover.
2. Release the panel clip from the RHS luggage compartment trim.
1. Remove the carpet flooring from the vehicle.
2. Peel open the RHS luggage compartment trim to gain access to the RHS tail light connector.
3. Locate and disconnect the RHS tail light connector.
4. Connect the trailer harness (P/No: 100319-WL) connector between the tail light connectors.
5. Locate the vehicle blanking grommet and remove it.

Note: If vehicle is fitted with an RPA kit, drill a Ø30mm access hole near the existing grommet for Tail harness routing.

6. Mount the trailer socket to the towbar using M4 fasteners then route the tail harness (tail length 1200mm) over to the grommet hole then feed it into the vehicle.

Note: The grommet must be moved along the harness to the desired location.

7. Route the tail harness (2) (tail length 1200mm) along the towbar and up through the previously drilled out hole.
8. Ensure the tail harness grommet is seated correctly and makes a good seal.
9. Secure the grommet in place using a cable tie (not supplied).
10. Connect the tail harness 8-way connector to the trailer patch 8-way mating connector.
11. Test the trailer harness function using a light board or multimeter.
12. Secure all harnesses using cable ties (not supplied).
13. Re-fit all removed parts and secure all fasteners, ensuring there are no squeaks or rattles.
14. Place the instructions in the glove box after fitment.