

TRAILBOSS

Towbar Fitting Instructions To Suit FORD KUGA SUV 02-2012 On Part Number FD205L Rating 750 kg

**PLEASE ENSURE THAT ALL INSTRUCTIONS ARE UNDERSTOOD PRIOR TO FITMENT
PLACE THESE INSTRUCTIONS IN THE VEHICLES GLOVE BOX AFTER INSTALLATIONS COMPLETE**

WARNING:

Do not, drill, cut, weld or otherwise modify the tow bar.

If you are using electric welding on a motor vehicle, **always** check that the vehicle is not equipped with electronic engine or instrument management equipment. Failure to do so could **destroy** any onboard computers. If in doubt, check with the vehicle's manufacturer.

The high tensile fasteners supplied with this product were used to achieve the specified rating. If replacement is required ensure that fasteners of the same rating & quality are used. Contact an authorised **Trailboss** dealer if further information is required.

General:

1. Ensure all hardware items have been included refer to assembly diagram.
2. It is recommended that the instructions are read through and completely understood before making any attempt to fit this product.
3. Be wary of any changes to vehicle designs or other accessories that may conflict with the installation of this product.
4. Before drilling ensure that the area is clear of fuel, electrical & other components.
5. All holes drilled into the body panels shall have all burrs & swarf removed then coated with a suitable rust preventative paint.
6. For vehicles that require the bumper to be cut. Ensure cut out area is in correct position on the vehicle prior to cutting the bumper.
7. The high tensile fasteners supplied with this product were used to achieve the specified rating. If replacement is required ensure that fasteners of the same rating & quality are used. Contact an authorized **Trailboss** dealer if further information is required.
8. Ensure that all hardware is fastened to torque list below check fasteners on regular basis.
9. Tow bar load rating sticker provided with this product shall be conspicuously located on inside rear end of the driver's door. **(See diagram below).**
10. Trailboss recommends that you check your tow ball to ensure that it complies with the Australian standards **AS 4177.2.**
11. **PLEASE NOTE:** It is advised to remove your lug or tbn when not actually towing so as to produce a clear view of the vehicles registration plate if obscured, and to also provide maximum available departure angle
12. Pull Pin must be fit in down position.

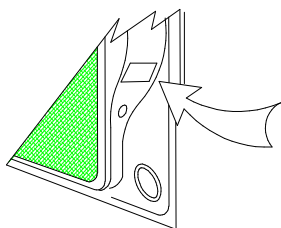

**Place load rating sticker
inside driver's door here**

FOR TRAILER TOWING PURPOSES ONLY
For towing capacity details please refer to vehicle owner's manual
or to the manufacturer. Overloading can void your warranties.

RECOMMENDED ASSEMBLY TORQUE LISTING

<u>Diameter</u>	<u>Grade 8.8 Bolt</u>
M6	9.5 Nm
M8	21.7 Nm
M10	43.4 Nm
M12	77.3Nm
M14	146 Nm
M16	189.8 Nm

Tow bar Maintenance and Care.

Trailboss recommends that bolt torque's, as listed below, are routinely and regularly inspected and checked for correct tension. Replace any worn or defective parts.

We recommend to remove Tow Ball Mounts (TBM's or lugs) when not being used for any considerable length of time. So as to avoid injury, when not towing it is suggested that the tongue, Pull Pin and R-clip are removed then stored in a safe, clean and dry place, away from excessive moisture.

Hitch Pull Pins and spring "R" clips are regularly checked for proper installation. Replace any worn or defective parts.

TRAILBOSS

Towbar Fitting Instructions
 To Suit FORD KUGA SUV 02-2012 On
 Part Number FD205L
 Rating 750 kg

PLEASE ENSURE THAT ALL INSTRUCTIONS ARE UNDERSTOOD PRIOR TO FITMENT
 PLACE THESE INSTRUCTIONS IN THE VEHICLES GLOVE BOX AFTER INSTALLATIONS COMPLETE

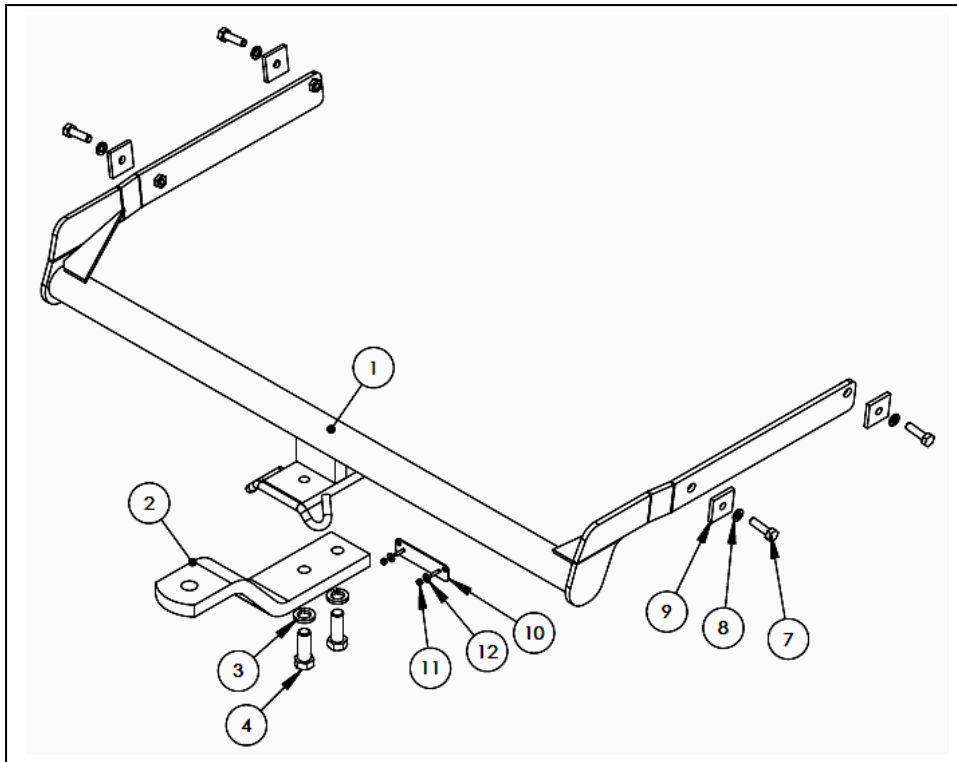

QTY.	DESCRIPTION	ITEM NO.
1	WELDED ASSEMBLY	1
1	LUG ASSY	2
2	M16 SPRING WASHER	3
2	M16 x 45 2.0P BOLT	4
1	BOLT PACK	5
1	PLASTIC SHEET BAG	6
4	M10 x 35 1.5P BOLT	7
4	M10 SPRING WASHER	8
4	LOOSE PLT 40 x 6 x 40 Ø11	9
1	PLUG BRACKET	10
2	Nut nyloc M4-0.7 z/p	11
2	M5 FLAT WASHER	12





Towbar Fitting Instructions
To Suit FORD KUGA SUV 02-2012 On
Part Number FD205L
Rating 750 kg

**PLEASE ENSURE THAT ALL INSTRUCTIONS ARE UNDERSTOOD PRIOR TO FITMENT
PLACE THESE INSTRUCTIONS IN THE VEHICLES GLOVE BOX AFTER INSTALLATIONS COMPLETE**

REMOVAL OF BUMPER :

1. Open boot / tailgate, locate and remove screw from plastic (tail light) covering
Separate cover from tail light assembly, both LH & RH sides of vehicle.

From inside boot area, remove side wall compartment lid, inside cavity find connection plug to rear of tail light assembly and disconnect.
2. Unscrew plastic holders, from rear of tail light assembly, remove from vehicle and place to side. Both LH & RH sides of vehicle.
3. Outside of vehicle, remove two screws from bumper panel, place to side. Both LH & RH sides of vehicle.
4. From inside wheel arch, remove two torque screws and place to side.
5. Peel back inner wheel arch panel, to expose torque screw, remove and place to side. Both LH & RH sides of vehicle.
6. Under vehicle, remove four torque screws from bumper support brackets, place to side. Both LH & RH sides of vehicle.
7. From inside rear of bumper, disconnect all connection plugs,, including rear sensors (if fitted) check both sides of vehicle.
8. Slightly pull outwards on sides of bumper, then pull outwards to remove bumper from vehicle. Place bumper on suitable stand.

REMOVAL OF IMPACT BEAM :

9. Remove foam covering from impact beam, place to side. Remove three nuts from impact beam , place to side. Both LH & RH sides of vehicle.
10. Remove impact beam from vehicle, place to side. Discard impact beam & accessories.

NOTE : If removal of towbar is necessary, impact beam assembly will need to be re-installed.

FITMENT OF TOWBAR :

11. Raise towbar and insert arms into chassis cavity, aligning holes together both LH & RH sides of vehicle.
12. Using loose plates supplied, insert two M10 bolts and spring washers through chassis holes, secure into nuts, in side arm of towbar.
13. Tighten all bolts to torque specifications, listed on page 1.

TRAILBOSS

Towbar Fitting Instructions
To Suit FORD KUGA SUV 02-2012 On
Part Number FD205L
Rating 750 kg

**PLEASE ENSURE THAT ALL INSTRUCTIONS ARE UNDERSTOOD PRIOR TO FITMENT
PLACE THESE INSTRUCTIONS IN THE VEHICLES GLOVE BOX AFTER INSTALLATIONS COMPLETE**

BUMPER CUT OUT :

14. Find centre line of bumper, cover area to be cut out with masking tape, to protect surfaces from scratches.
15. Mark out area to be cut, from centre line bottom edge of bumper, measure out sideways 80mm, mark vertical lines to a height of 70mm. Measure up 90mm, mark horizontal line across. Refer to diagram below.
16. From centre line found, measure out 40mm each side, join these lines with the 70mm lines marked previously. Referring to diagram.
17. Cut out area with a suitable sawing device, remove all burrs.

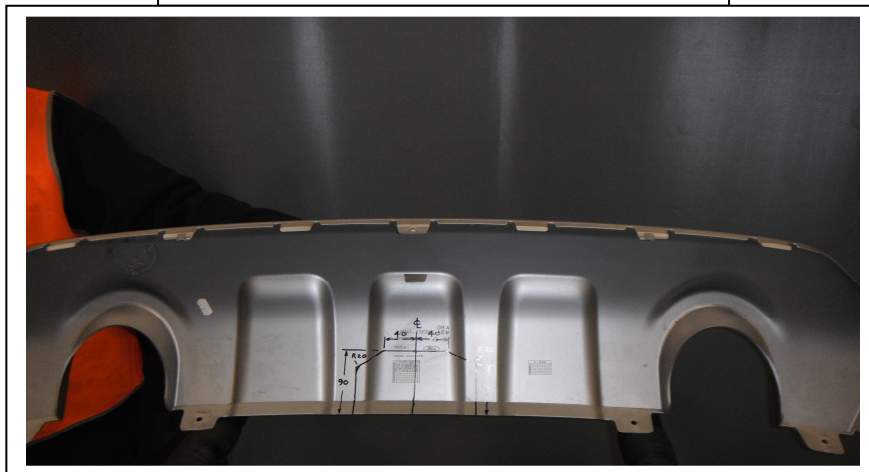
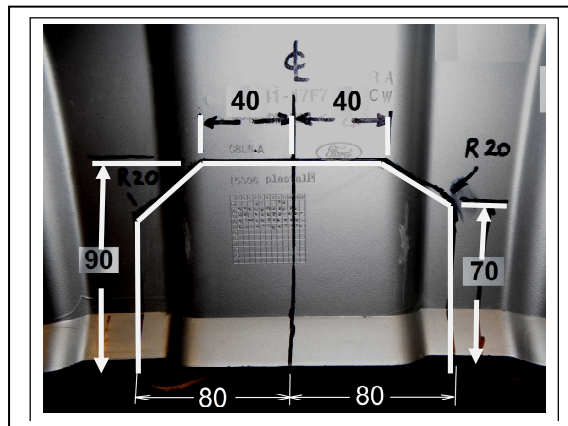

18. Refit bumper bar in reverse order of removal, making sure all connector plugs are connected.
19. Attach all other accessories supplied, to towbar.



Wiring Loom Fitting Instructions
To Suit Ford Kuga
Part Number 100798-WL

Wiring Loom Installation Instructions

Ford Kuga
Part No: 100798-WL
ECU: 04826

Tail Harness Length Required: 1200mm
RPA Override Tail Part No: 04943 (If Fitted)

Wiring Loom Installation Time: Approx 40 Mins



Wiring Loom Fitting Instructions
To Suit Ford Kuga
Part Number 100798-WL

1. In the rear luggage compartment, remove the floor cover carpet.
2. Remove the LHS and RHS tool compartments.
3. Remove the centre foam support on the spare wheel.
4. Remove the rear luggage compartment trim by pulling in an upwards direction.
5. On the LHS luggage compartment, remove the access panel.
Repeat for the RHS.
6. On the LHS of the luggage compartment, dislodge the rear luggage compartment side trim.
Repeat for the RHS.
7. Dislodge the LHS luggage compartment trim enough to gain access to connectors.
Repeat for the RHS.
8. In the luggage compartment, on the RHS rear quarter panel, drill a hole to Ø30mm using a step drill.
9. File any rough or sharp edges.
10. In the LHS luggage compartment, disconnect the 2-way tail light connector.
11. Following the table below, connect the ezy-tap to the L.IND wire and REVERSE wire, then connect the trailer patch terminal to the ezy-tap.

Function	Trailer Patch	Vehicle Connector
L.IND	YELLOW/BLACK	GREEN/BLUE
REVERSE	BLACK/WHITE	BLACK/YELLOW

12. Connect the trailer harness ground ring terminal to the vehicle grounding point.
13. Route the trailer harness along the rear luggage compartment panel, towards the RHS of the luggage compartment trim.
14. On the RHS of the luggage compartment, disconnect the 4-way female tail light connector and patch the trailer harness in between.



Wiring Loom Fitting Instructions
To Suit Ford Kuga
Part Number 100798-WL

15. Following the table below, connect the ezy-tap to the corresponding vehicle wire, then connect the trailer patch terminal to the ezy-tap.

Function	Trailer Patch	Vehicle Connector
R.IND	GREEN / BLACK	BLUE / RED

16. Connect the trailer harness 12-way connector to the ECU (04826).

17. On the RHS luggage compartment, using the supplied double sided tape, adhere the ECU to the indicated location on the vehicle sheet metal.

18. Route the 'ORANGE' power wire towards the 12v socket

19. Continue routing the 'ORANGE' power wire, behind the 12v socket.

20. Following the table below, connect the ezy-tap to the corresponding 12v Socket wire, then connect the trailer patch terminal to the ezy-tap.

Function	Trailer Patch	Vehicle Connector
POWER	ORANGE	ORANGE

21. Mount the trailer socket to the towbar mounting bracket using M4 fasteners (not supplied).

22. Route the tail harness (tail length 1200mm) towards and up through the previously drilled out hole.

23. Ensure the tail harness grommet is seated correctly and makes a good seal.

24. Secure the grommet in place using cable ties (not supplied).

25. Connect the tail harness 8-way connector to the Trailer Patch 8-way mating connector.

26. Test the Trailer Harness function using a light board or multimeter.

27. Secure all harnesses using cable ties (not supplied).

28. Re-fit removed parts and secure all fasteners, ensuring there are no squeaks or rattles.

29. Place the instructions in the glove box after fitment.