

# TRAILBOSS

## Tow bar Fitting Instructions To Suit Honda Accord Euro-09-2008-On Part Number HN63L Rating 1200 kg Max Static Ball Load 60 Kg

### **WARNING:**

1. Do not, drill, cut, weld or otherwise modify the tow bar.
2. If you are using electric welding on a motor vehicle, **always** check that the vehicle is not equipped with electronic engine or instrument management equipment. Failure to do so could **destroy** any onboard computers. If in doubt, check with the vehicle's manufacturer.

### **General:**

1. Ensure all hardware items have been included refer to assembly diagram.
2. It is recommended that the instructions are read through and completely understood before making any attempt to fit this product.
3. Be wary of any changes to vehicle designs or other accessories that may conflict with the installation of this product.
4. Before drilling ensure that the area is clear of fuel, electrical & other components.
5. All holes drilled into the body panels shall have all burrs & swarf removed then coated with a suitable rust preventative paint.
6. The high tensile fasteners supplied with this product were used to achieve the specified rating. If replacement is required ensure that fasteners of the same rating & quality are used. Contact an authorized **Trailboss** dealer if further information is required.
7. Ensure that all hardware is fastened to torque list below check fasteners on regular basis.
8. Tow bar load rating sticker provided with this product shall be conspicuously located on inside rear end of the driver's door. **(See diagram below).**
9. Trailboss recommends that you check your tow ball to ensure that it complies with the Australian standards **AS 4177.2**.
10. **PLEASE NOTE:** It is advised to remove your lug or tbn when not actually towing so as to produce a clear view of the vehicles registration plate if obscured, and to also provide maximum available departure angle

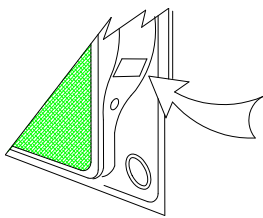

Place load rating sticker  
inside driver's door here

### **FOR TOWING PURPOSES ONLY**

For towing capacity details please refer to vehicle owner's manual or to the manufacturer. Overloading can void your warranties.

### **RECOMMENDED ASSEMBLY TORQUE LISTING**

<u>Diameter</u>	<u>Grade 8.8 Bolt</u>
M6	9.5 Nm
M8	21.7 Nm
M10	43.4 Nm
M12	77.3Nm
M14	146 Nm
M16	189.8 Nm

### **Tow bar Maintenance and Care.**

Trailboss recommends that bolt torque's, as listed below, are routinely and regularly inspected and checked for correct tension. Replace any worn or defective parts.

We recommended to remove Tow Ball Mounts (TBM's, tongues or lugs) when not being used for any considerable length of time.

So as to avoid injury, when not towing it is suggested that the tongue, Pull Pin and R-clip are removed then stored in a safe, clean and dry place, away from excessive moisture.

Hitch Pull Pins and spring "R" clips are regularly checked for proper installation. Replace any worn or defective parts.

# TRAILBOSS

Tow bar Fitting Instructions  
To Suit Honda Accord Euro-09-2008-On  
Part Number HN63L  
Rating 1200 kg Max Static Ball Load 60 Kg

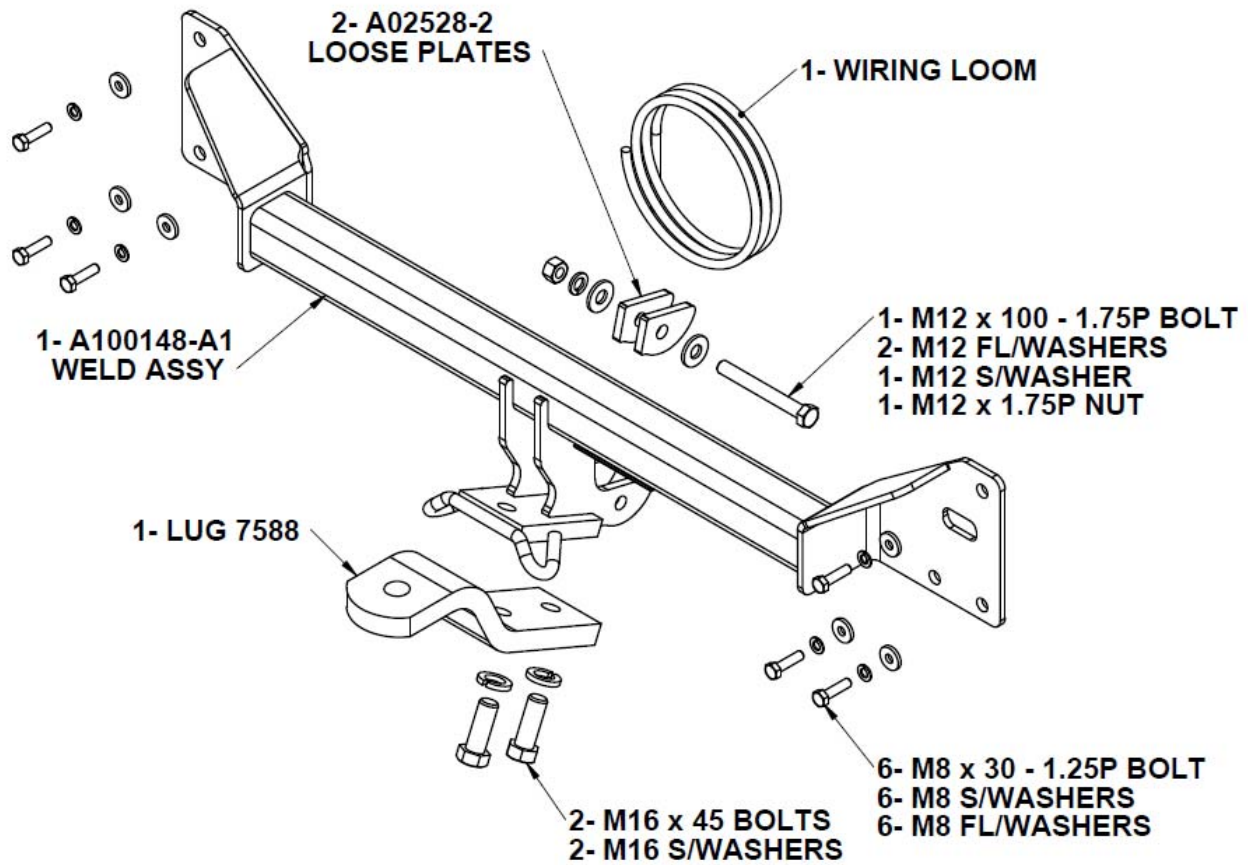

# TRAILBOSS

Tow bar Fitting Instructions  
To Suit Honda Accord Euro-09-2008-On  
Part Number HN63L  
Rating 1200 kg Max Static Ball Load 60 Kg

11. **Remove rear bumper bar skin via**
  - a. Remove 3 x screws from each inner wheel arch.
  - b. Remove 2 x plastic trim plugs from the underside of the bumper bar skin.
  - c. Remove 2 x plastic covers from inside boot cavity to expose bolts.
  - d. Remove 2 x bolts from rear boot cavity.
  - e. Remove 2 x screws from underside of each quarter panel.
  - f. Flex bumper bar out at the sides so to disengage the plastic retaining clips.
  - g. Remove by pulling rearward **Caution two person lift required** some force may be required to remove.
  - h. Disconnect the reverse park assist connection if fitted.
  
12. **Remove rear Impact beam via**
  - a. Remove 3 bolts retaining Impact beam each side of the vehicle.
  - b. Lift impact beam up slightly to remove.
  - c. Discard the Impact beam & retaining bolts.
  - d. Using suitable hammer flatten the sheet metal tab each side of the vehicle this is the tab that locates the rear impact beam it is not required as tow bar will be in its place.
  
13. **Fitment of tow bar to the vehicle**
  - a. Offer tow bar to vehicles rear panel so that the holes in the side plates align with captive holes on vehicle panel.
  - b. Fasten with M8 bolts & washers provided loosely.
  - c. Fit loose plates with M12 bolt washers & nut provided to shipping hook on the underside of the vehicle.
  - d. Fasten all hardware to the torque listing.
  
14. **Rear bumper bar cut out detail**
  - a. From the inside face of the rear bumper bar skin use the Honda factory indent as a guide see fig 1.
  - b. Carefully cut around the profile using a utility knife or small hacksaw.
  - c. Ensure that cut is free of burrs or sharp edges.
  
15. **Reconnect reverse park assist if fitted & refit rear bumper bar skin**
  - a. Reconnect the reverse park assist if fitted not all models have them fitted.
  - b. Refit the rear bumper bar in the reverse of steps 11 h through to 11 a.
  - c. Fit tow bar tongue with M16 x 45 bolts & washers provided.





Tow bar Fitting Instructions  
To Suit Honda Accord Euro-09-2008-On  
Part Number HN63L  
Rating 1200 kg Max Static Ball Load 60 Kg

### Wiring Loom Installation Instructions

Honda Accord Euro  
Part No: 100146-WL

Tail Harness Length Required: 1200mm  
RPA Override Switch Part No: 04848 (If Fitted)

Wiring Loom Installation Time: Approx 20 Mins



Tow bar Fitting Instructions  
To Suit Honda Accord Euro-09-2008-On  
Part Number HN63L  
Rating 1200 kg Max Static Ball Load 60 Kg

1. Remove all the required trims to gain access to the LHS rear quarter area of the vehicle.
2. On the RHS area of the luggage compartment, remove the grommet from the rear of the vehicle (located just below the vehicle grounding point).
3. Disconnect the RHS main harness 20-way tail light connector and patch the Trailer Patch Harness connectors (P/No: 100146-WL) in between.
4. Secure the Trailer Patch Harness ground ring terminal to the vehicle grounding point.
5. From outside of the vehicle, secure the tail harness (Tail length 1200mm) socket onto the towbar mounting bracket using M4 fasteners (not supplied).
6. Route in the tail harness connector (Tail length 1200mm) through the grommet hole and connect it to the power harness connector.
7. Adjust the harness grommet to the desired location and then secure the grommet with a cable tie (not supplied).
8. Connect the Tail Harness 8-way male connector to the trailer patch harness female connector.
9. Test the Trailer Harness function using trailer light board or multimeter.
10. Secure all harnesses to the vehicle using cable ties (not supplied).
11. Refit all removed parts and secure all fasteners.
12. Please place the fitting instructions in the glove box after installation.