

# TRAILBOSS

Towbar Fitting Instructions  
To Suit **HONDA CITY** 2008-on  
Part Number **HN64L**  
Rating **800/70** kg

**WARNING:**

1. Do not, drill, cut, weld or otherwise modify the tow bar.
2. If you are using electric welding on a motor vehicle, **always** check that the vehicle is not equipped with electronic engine or instrument management equipment. Failure to do so could **destroy** any onboard computers. If in doubt, check with the vehicle's manufacturer.

**General:**

1. Ensure all hardware items have been included refer to assembly diagram.
2. It is recommended that the instructions are read through and completely understood before making any attempt to fit this product.
3. Be wary of any changes to vehicle designs or other accessories that may conflict with the installation of this product.
4. Before drilling ensure that the area is clear of fuel, electrical & other components.
5. All holes drilled into the body panels shall have all burrs & swarf removed then coated with a suitable rust preventative paint.
6. For vehicles that require the bumper to be cut. Ensure cut out area is in correct position on the vehicle prior to cutting the bumper.
7. The high tensile fasteners supplied with this product were used to achieve the specified rating. If replacement is required ensure that fasteners of the same rating & quality are used. Contact an authorized **Trailboss** dealer if further information is required.
8. Ensure that all hardware is fastened to torque list below check fasteners on regular basis.
9. Tow bar load rating sticker provided with this product shall be conspicuously located on inside rear end of the driver's door. **(See diagram below).**
10. Trailboss recommends that you check your tow ball to ensure that it complies with the Australian standards **AS 4177.2.**
11. **PLEASE NOTE:** It is advised to remove your lug or tbn when not actually towing so as to produce a clear view of the vehicles registration plate if obscured, and to also provide maximum available departure angle

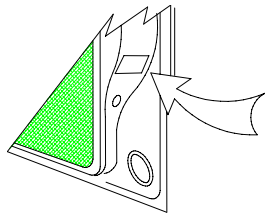

Place load rating sticker  
inside driver's door here

**FOR TOWING PURPOSES ONLY**  
For towing capacity details please refer to vehicle owner's manual or to the manufacturer. Overloading can void your warranties.

**RECOMMENDED ASSEMBLY TORQUE LISTING**  
Diameter Grade 8.8 Bolt

M6	9.5 Nm
M8	21.7 Nm
M10	43.4 Nm
M12	77.3Nm
M14	146 Nm
M16	189.8 Nm

**Tow bar Maintenance and Care.**

Trailboss recommends that bolt torque's, as listed below, are routinely and regularly inspected and checked for correct tension. Replace any worn or defective parts.

We recommended to remove Tow Ball Mounts (TBM's, tongues or lugs) when not being used for any considerable length of time.

So as to avoid injury, when not towing it is suggested that the tongue, Pull Pin and R-clip are removed then stored in a safe, clean and dry place, away from excessive moisture.

Hitch Pull Pins and spring "R" clips are regularly checked for proper installation. Replace any worn or defective parts.

# TRAILBOSS

Towbar Fitting Instructions  
To Suit **HONDA CITY** 2008-on  
Part Number **HN64L**  
Rating **800/70** kg

1. Remove 2 hex screws under boot lid seal.
2. Remove 2 plastic clips under the bumper
3. Remove 4 screws in mud guard area on both sides.
4. Release bumper skin.
5. Cut perforated area on the back panel on both sides; file to remove any sharp edges.
6. Insert Towbar into chassis rails opening, fit Towbar to vehicle using M10x40, spring washer and loose plate.
7. Fit M10x75, spring washer, flat washer and hook plates to towing hook mount.
8. Torque all fasteners to specification.
9. Find centre line using two plastic mounting holes as a guide. Cut 65x65mm square from the bottom of bumper. Refit bumper skin to vehicle.

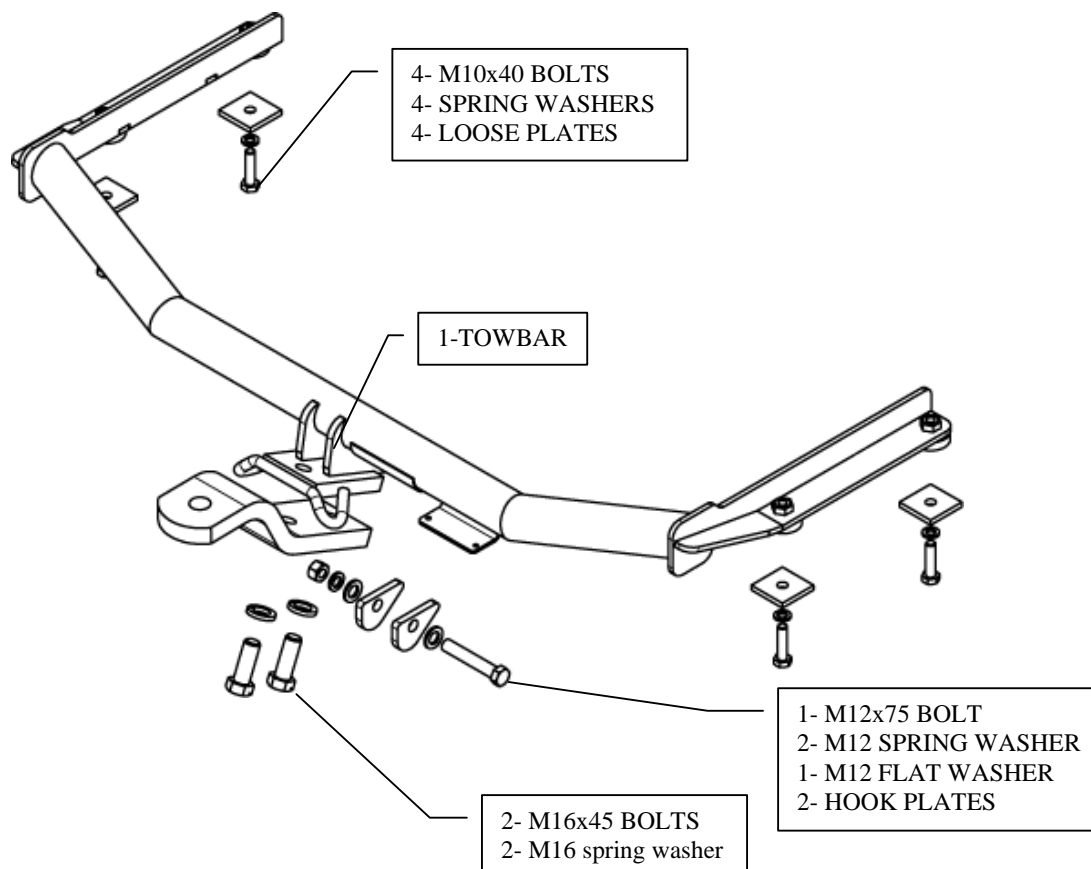



Wiring Loom Fitting Instructions  
To Suit Honda City  
Part Number 100181-WL

Wiring Loom Installation Instructions

Honda City  
Part No: 100181-WL

Tail Harness Length Required: 1800mm  
RPA Override Switch Part No: 04848 (If Fitted)

Wiring Loom Installation Time: Approx 20 Mins



Wiring Loom Fitting Instructions  
To Suit Honda City  
Part Number 100181-WL

1. Remove the rear bumper fascia by removing all its fasteners.
2. Remove tail gate RHS grommet.
3. In the luggage compartment, remove all required trims to gain access to the LHS and RHS tail light connectors.
4. Secure the Tail Harness (P/No: 100181-WL) socket to the towbar mounting bracket using M4 fasteners. Secure Tail harness to towbar with cable ties (not supplied)
5. Route the Tail Harness (Tail length: 1200mm) through the grommet hole and into the luggage compartment area. Adjust the Tail Harness grommet position ensuring the grommet is seated correctly. Secure the grommet using a cable tie (not supplied).
6. In the luggage compartment, disconnect the RHS indicator tail light connector and connect the Trailer Patch Harness (P/No: 100181-WL) connectors in between.
7. Route the Trailer Patch Harness along the rear of the vehicle harness towards the LHS tail light assembly. Secure the Trailer Patch Harness ground ring terminal to the vehicle grounding point. Connect the tail harness 8-way male connector to the Trailer Patch Harness 8-way female connector.
8. Disconnect the LHS tail light connectors and patch the Trailer Patch Harness connectors in between.
9. On the outside, secure the harness to the towbar using cable ties (not supplied).
10. Refit the rear bumper fascia.
11. Test the Trailer socket using a light board or multi-meter.
12. Secure the all harnesses using cables ties (not supplied).
13. Refit all removed parts and secure all fasteners.
14. Place instructions in glove box after fitment.