

TRAILBOSS

Towbar Fitting Instructions To Suit **HYUNDAI i30 TOURER 2013 ON** Part Number **HY32L** Rating **1500/150 kg**

PLACE THESE INSTRUCTIONS IN THE VEHICLE'S GLOVEBOX AFTER INSTALLATION IS COMPLETED

WARNING:

1. Do not, drill, cut, weld or otherwise modify the tow bar.
2. If you are using electric welding on a motor vehicle, **always** check that the vehicle is not equipped with electronic engine or instrument management equipment. Failure to do so could **destroy** any onboard computers. If in doubt, check with the vehicle's manufacturer.
3. The high tensile fasteners supplied with this product were used to achieve the specified rating. If replacement is required ensure that fasteners of the same rating & quality are used. Contact an authorised **Trailboss** dealer if further information is required.

General:

1. Ensure all hardware items have been included refer to assembly diagram.
2. It is recommended that the instructions are read through and completely understood before making any attempt to fit this product.
3. Be wary of any changes to vehicle designs or other accessories that may conflict with the installation of this product.
4. Before drilling ensure that the area is clear of fuel, electrical & other components.
5. All holes drilled into the body panels shall have all burrs & swarf removed then coated with a suitable rust preventative paint.
6. For vehicles that require the bumper to be cut. Ensure cut out area is in correct position on the vehicle prior to cutting the bumper.
7. The high tensile fasteners supplied with this product were used to achieve the specified rating. If replacement is required ensure that fasteners of the same rating & quality are used. Contact an authorized **Trailboss** dealer if further information is required.
8. Ensure that all hardware is fastened to torque list below check fasteners on regular basis.
9. Tow bar load rating sticker provided with this product shall be conspicuously located on inside rear end of the driver's door. **(See diagram below)**.
10. Trailboss recommends that you check your tow ball to ensure that it complies with the Australian standards **AS 4177.2**.
11. **PLEASE NOTE:** It is advised to remove your lug or tbn when not actually towing so as to produce a clear view of the vehicles registration plate if obscured, and to also provide maximum available departure angle
12. Pull Pin must be fit in down position.

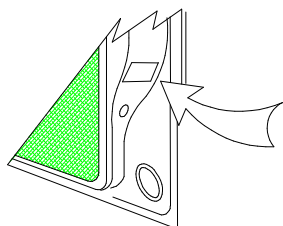

Place load rating sticker
inside driver's door here

FOR TRAILER TOWING PURPOSES ONLY
For towing capacity details please refer to vehicle owner's manual or to the manufacturer. Overloading can void your warranties.

RECOMMENDED ASSEMBLY TORQUE LISTING

Diameter	Grade 8.8 Bolt
M6	9.5 Nm
M8	21.7 Nm
M10	43.4 Nm
M12	77.3Nm
M14	146 Nm
M16	189.8 Nm

Tow bar Maintenance and Care.

Trailboss recommends that bolt torque's, as listed below, are routinely and regularly inspected and checked for correct tension. Replace any worn or defective parts.

We recommended to remove Tow Ball Mounts (TBM's, tongues or lugs) when not being used for any considerable length of time.

So as to avoid injury, when not towing it is suggested that the tongue, Pull Pin and R-clip are removed then stored in a safe, clean and dry place, away from excessive moisture.

Hitch Pull Pins and spring "R" clips are regularly checked for proper installation. Replace any worn or defective parts.

TRAILBOSS

Towbar Fitting Instructions
 To Suit **HYUNDAI i30 TOURER 2013 ON**
 Part Number **HY32L**
 Rating **1500/150 kg**

PLACE THESE INSTRUCTIONS IN THE VEHICLE'S GLOVEBOX AFTER INSTALLATION IS COMPLETED

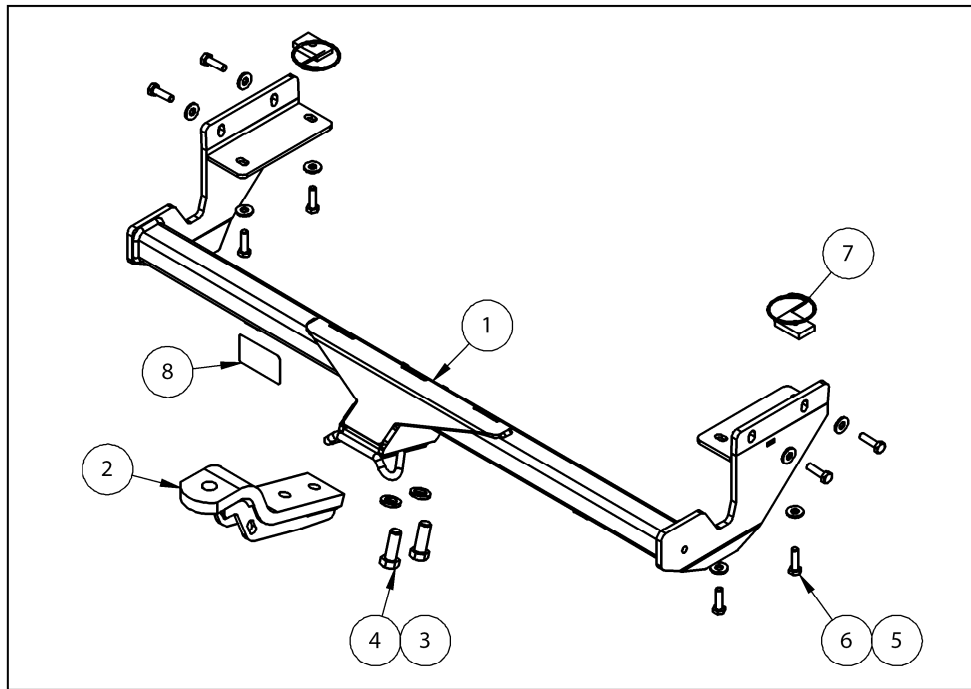

QTY.	DESCRIPTION	ITEM NO.
1	TOWBAR ASSEMBLY	1
1	LUG ASEMBLY	2
2	M16 SPRING WASHER	3
2	M16x45x2.0P HEX BOLT	4
8	M10 FLAT WASHER	5
8	M10x35x1.25P SET SCREW	6
2	FITTING PLATE WITH WIRE	7
1	ACRYLIC CP LABEL	8

ADDITIONAL ITEMS

FITTING INSTRUCTION LR LABEL WIRING LOOM

PLUG BRACKET NUT NYLOC



Towbar Fitting Instructions
To Suit **HYUNDAI i30 TOURER 2013 ON**
Part Number **HY32L**
Rating **1500/150 kg**

PLACE THESE INSTRUCTIONS IN THE VEHICLE'S GLOVEBOX AFTER INSTALLATION IS COMPLETED

INSTRUCTION:

1. Remove 3x Screws in both Rear Wheel Arches.
2. Remove 3x Scrivets from the underside of Bumper on both sides. Do **“NOT”** remove 3x Scrivets in the centre on the underside of the Bumper.
3. Remove 2x Screws from light housing on both sides and remove light by firmly pulling backwards.
4. Unplug lights and remove 2x Screws on topside of Bumper on both sides.
5. Unbolt the rear Impact Beam by removing 2x Bolts on both sides on the front side of the Rear Panel. Making sure not to remove the 3x Scrivets on the underside of the Bumper.
6. Unclip the sides of the rear Bumper and remove the Bumper and Impact Beam as one piece by pulling back firmly on the Bumper.
7. Trim Driver's side under panel guard as shown in Figure 1.
8. Trim passenger side under panel guard using the left most indentation as a template. (Figure 2)
9. Drill out rear most small hole in Chassis Rail to 12mm.
10. Loosely Bolt on Towbar, using 2x M10 Bolts through the side of Chassis Rail both sides. Insert Tapped Plate into the Chassis Rail on both sides lining up with rear most holes and insert M10 Bolt.
11. Insert final M10 Bolt in the underside plate on both sides and torque up all bolts using the settings provided at the start of the fitting instructions, making sure to tighten the underside Bolts first.
12. Remove Impact Beam from rear Bumper and re-fit all components in reverse order.

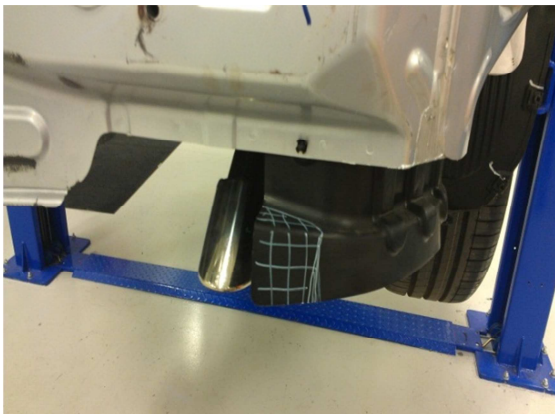

Figure 1

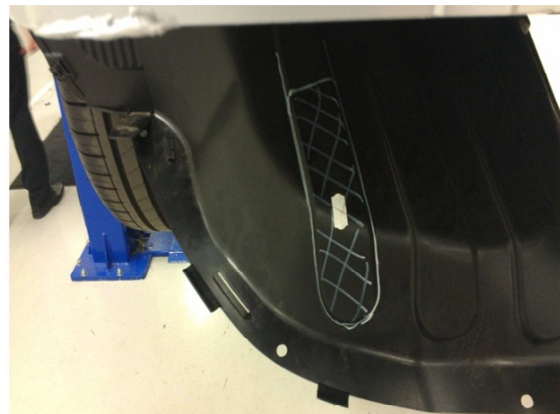

Figure 2



Wiring Loom Fitting Instructions
To Suit Hyundai i30 Hatch MY12 / Hyundai i30 Tourer MY13
Part Number 100841-WL

Wiring Loom Installation Instructions

Hyundai i30 Hatch MY12
Hyundai i30 Tourer MY13
Part No: 100841-WL

Tail Harness Length Required: 1200mm

Hyundai i30 Hatch MY12 – Pages 2 – 4
Hyundai i30 Tourer MY13 - Pages 5 - 8

Wiring Loom Installation Time: Approx 60 Mins



Wiring Loom Fitting Instructions
To Suit Hyundai i30 Hatch MY12 / Hyundai i30 Tourer MY13
Part Number 100841-WL

The following steps are for Hyundai i30 Hatch MY12 models only. For Hyundai i30 Tourer MY13 models, please proceed to page 5.

1. Inside the luggage compartment area, remove the rear sunshade.
2. Remove the cargo hook latch covers.
3. Remove the floor carpet.
4. Fold down the rear passenger seats.
5. Remove the rear luggage compartment trim by removing the three clips by pulling in an upwards direction.
6. On the luggage compartment LHS trim, open the two fastener covers and remove the two bolts.
7. Remove the two clips and screw.
8. Disconnect the luggage compartment light connector and then peel open the luggage compartment trim.

Repeat steps 6-8 for RHS (luggage compartment light only on LHS).

9. Dislodge the LHS upper 'C' pillar trim.
10. At the rear RHS passenger door area, remove the under-seat trim.
11. Dislodge the 'B' pillar trim.
12. Remove the lower 'C' pillar trim by removing the clip.
13. On the front of the vehicle, on the RHS, remove the driver's scuff plate trim and fuse access panel.
14. Remove the bonnet release lever by first removing the fastener.
15. Remove the driver's kick panel trim.
16. On the rear RHS quarter of the luggage compartment area, drill a Ø30mm hole (1) into the sheet metal in the area as shown.

Wiring Loom Fitting Instructions
To Suit Hyundai i30 Hatch MY12 / Hyundai i30 Tourer MY13
Part Number 100841-WL



17. File any rough or sharp edges and spray with rust inhibitor.
18. In the LHS of the luggage compartment, following the table below, connect the ezy-tap (1) to the vehicle 'BLUE' reverse wire (2), then connect the trailer patch terminal to the ezy-tap (1).

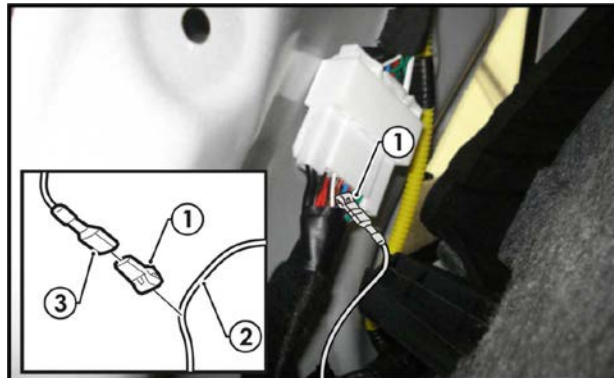

Function	Trailer Patch	Vehicle Connector
REVERSE	BLACK / WHITE	BLUE

19. On the LHS of the luggage compartment, disconnect the tail light connector and connect the trailer patch (P/No:100841-WL) connectors in between.
20. Route the trailer patch RHS connectors across the rear of the vehicle towards the RHS tail light area.
21. On the RHS of the luggage compartment area, disconnect the vehicle tail light connectors and connect the trailer patch (P/No: 100841-WL) connectors in between.
22. Secure the trailer patch ground ring terminal to a suitable location using a self tapping screw (not supplied).
23. Following the existing vehicle harness, route the 'ORANGE' power wire along the rear RHS door sill area towards the front of the vehicle.

Wiring Loom Fitting Instructions To Suit Hyundai i30 Hatch MY12 / Hyundai i30 Tourer MY13 Part Number 100841-WL

24. Continue routing the 'ORANGE' power wire following the existing vehicle harness, towards the fuse panel.
25. On the fuse panel, locate and remove the 15 Amp fuse.
26. Insert the supplied 20Amp (1) fuse and the supplied 15Amp fuse (2) to the add-a-fuse harness (3).
27. Connect the trailer patch red wire connector (4) to the add-a-fuse harness connector (5).

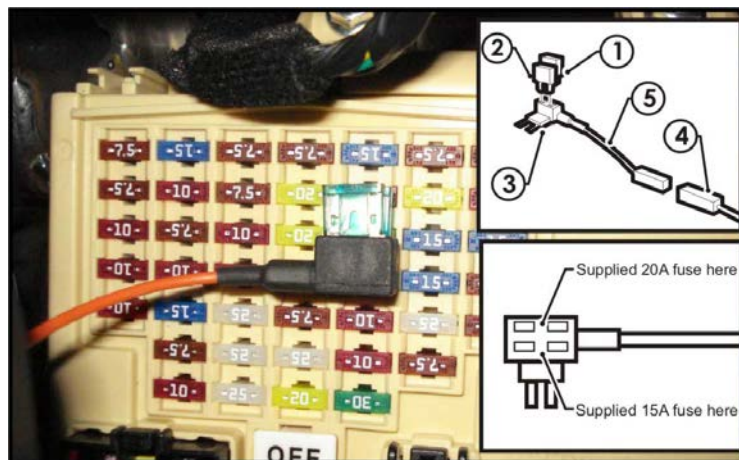

28. Insert the add-a-fuse harness (3) into the now vacant fuse location.
Note: When placing the add-a-fuse, ensure to secure in the correct orientation as shown.
29. Mount the trailer socket to the tow bar mounting bracket using M4 fasteners (not supplied).
30. Route the tail harness across the tow bar towards the RHS of the vehicle and up through the previously drilled out hole.
31. Ensure the tail harness grommet is seated correctly and secure in place using a cable tie (not supplied).
32. Connect the tail harness (tail length 1200mm) 8-way connector to the trailer patch mating 8-way connector.
33. Test the trailer patch function using a light board or multi meter.
34. Secure all harnesses using cable ties (not supplied).
35. Re-fit all removed parts and secure all fasteners, ensuring there are no squeaks or rattles.
36. Place the fitting instructions in the glove box after fitment.



Wiring Loom Fitting Instructions
To Suit Hyundai i30 Hatch MY12 / Hyundai i30 Tourer MY13
Part Number 100841-WL

The following steps are for Hyundai i30 Tourer MY13 models only. For Hyundai i30 Hatch MY12 models, please refer to page 2.

1. Inside the luggage compartment area, remove the rear sunshade.
2. Remove the cargo hooks.
3. Remove the floor carpet.
4. Fold down the rear passenger seats.
5. In the tool storage compartment, remove the five screws.
6. Remove the tool storage compartment.
7. Remove both the LHS & RHS storage tool trays by removing the six screws.
8. Remove the rear luggage compartment trim by removing the three clips and pulling in an upwards direction.
9. On the LHS storage compartment, remove the cover and the two screws.
10. Remove the LHS storage compartment trim.
Repeat for the RHS.
11. On the LHS luggage compartment trim, remove the seven screws.
Repeat for the RHS.
12. Carefully dislodge the LHS luggage compartment trim and disconnect the light connector.
13. Carefully dislodge the RHS luggage compartment trim and disconnect the 12v accessory connector.
14. Dislodge the LHS upper 'C' pillar trim by first removing the two screws.
15. On the RHS of the rear passenger, fold the seat base forward.
16. Remove the two screws and remove the RHS door trim.
17. Dislodge the 'B' pillar trim.
18. On the RHS of the driver's side, remove the door trim.
19. On the RHS kick panel trim, remove the bonnet release lever by first removing the one screw.

Wiring Loom Fitting Instructions To Suit Hyundai i30 Hatch MY12 / Hyundai i30 Tourer MY13 Part Number 100841-WL

20. Remove the RHS kick panel trim.
21. Remove the fuse panel trim.
22. On the RHS rear quarter panel of the luggage compartment, drill a Ø30mm hole (1) next to the air vent.
23. File any sharp or rough edges and spray with rust inhibitor.



24. In the LHS upper 'C' pillar trim panel, following the table below, connect the ezy-tap (1) to the vehicle 'BLUE' reverse wire (2), then connect the trailer patch terminal (3) to the ezy-tap (1).

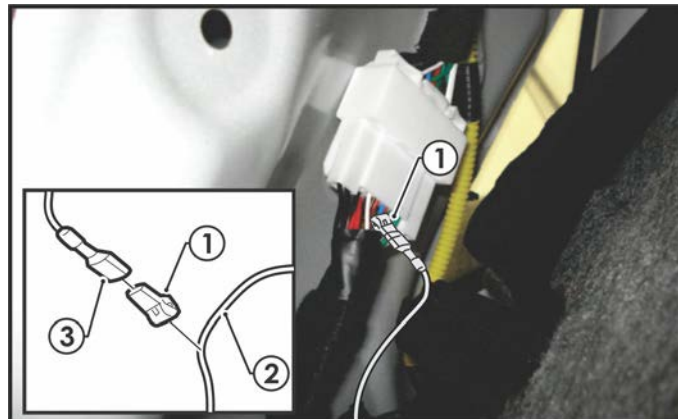

Function	Trailer Patch	Vehicle Connector
REVERSE	BLACK / WHITE	BLUE

Note: Ensure to test the 'BLUE' reverse wire (2) with a multimeter prior to scotch locking as there are two 'BLUE' wires.

Wiring Loom Fitting Instructions To Suit Hyundai i30 Hatch MY12 / Hyundai i30 Tourer MY13 Part Number 100841-WL

25. On the LHS of the luggage compartment, disconnect the tail light connector and connect the trailer patch (P/No: 100841-WL) connectors in between.
26. Route the trailer patch RHS connectors across the rear of the vehicle towards the RHS tail light area.
27. On the RHS of the luggage compartment area, disconnect the vehicle tail light connectors and connect the trailer patch (P/No: 100841-WL) connectors in between.
28. Secure the trailer patch ground ring terminal to the location indicated using a self- tapping screw (not supplied).
29. Following the existing vehicle harness, route the 'ORANGE' power wire along the rear RHS door sill area towards the front of the vehicle.
30. Continue routing the 'ORANGE' power wire along the existing vehicle harness past the 'B' pillar area towards the front of the vehicle.
31. Continue routing the 'ORANGE' power wire following the existing vehicle harness, towards the fuse panel.
32. On the fuse panel, locate and remove the 15 Amp fuse.
33. Insert the supplied 20Amp (1) fuse and the supplied 15Amp fuse (2) to the add-a-fuse harness (3).
34. Connect the trailer patch red wire connector (4) to the add-a-fuse harness connector (5).

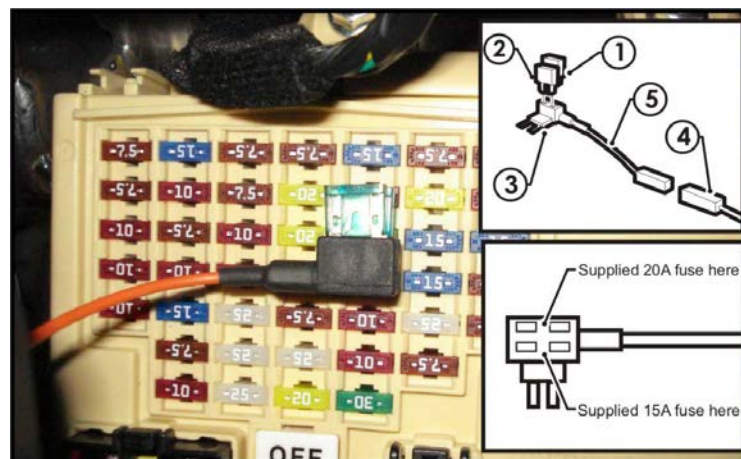

35. Insert the add-a-fuse harness (3) into the now vacant fuse location.

Note: When placing the add-a-fuse, ensure to secure in the correct orientation as shown.



Wiring Loom Fitting Instructions
To Suit Hyundai i30 Hatch MY12 / Hyundai i30 Tourer MY13
Part Number 100841-WL

36. Mount the trailer socket to the tow bar mounting bracket using M4 fasteners (not supplied).
37. Route the tail harness across the tow bar towards the RHS of the vehicle and up through the previously drilled out hole.
38. Ensure the tail harness grommet is seated correctly and secure in place using a cable tie (not supplied).
39. Connect the tail harness (tail length 1200mm) 8-way connector to the trailer patch mating 8-way connector.
40. Test the trailer patch function using a light board or multi meter.
41. Secure all harnesses using cable ties (not supplied).
42. Re-fit all removed parts and secure all fasteners, ensuring there are no squeaks or rattles.
43. Place the fitting instructions in the glove box after fitment.