

TRAILBOSS

Towbar Fitting Instructions
To Suit KIA CERATO 2009-on
Part Number KM14L
Suits - Si MODELS ONLY
Rating 1200/120 kg

WARNING:

Do not, drill, cut, weld or otherwise modify the tow bar.

If you are using electric welding on a motor vehicle, **always** check that the vehicle is not equipped with electronic engine or instrument management equipment. Failure to do so could **destroy** any onboard computers. If in doubt, check with the vehicle's manufacturer.

General:

1. Ensure all hardware items have been included refer to assembly diagram.
2. It is recommended that the instructions are read through and completely understood before making any attempt to fit this product.
3. Be wary of any changes to vehicle designs or other accessories that may conflict with the installation of this product.
4. Before drilling ensure that the area is clear of fuel, electrical & other components.
5. All holes drilled into the body panels shall have all burrs & swarf removed then coated with a suitable rust preventative paint.
6. For vehicles that require the bumper to be cut. Ensure cut out area is in correct position on the vehicle prior to cutting the bumper.
7. The high tensile fasteners supplied with this product were used to achieve the specified rating. If replacement is required ensure that fasteners of the same rating & quality are used. Contact an authorized **Trailboss** dealer if further information is required.
8. Ensure that all hardware is fastened to torque list below check fasteners on regular basis.
9. Tow bar load rating sticker provided with this product shall be conspicuously located on inside rear end of the driver's door. **(See diagram below).**
10. Trailboss recommends that you check your tow ball to ensure that it complies with the Australian standards **AS 4177.2**.
11. **PLEASE NOTE:** It is advised to remove your lug or tbn when not actually towing so as to produce a clear view of the vehicles registration plate if obscured, and to also provide maximum available departure angle

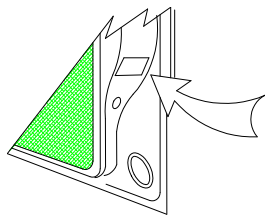

Place load rating sticker
inside driver's door here

FOR TOWING PURPOSES ONLY
For towing capacity details please refer to vehicle owner's manual
or to the manufacturer. Overloading can void your warranties.

RECOMMENDED ASSEMBLY TORQUE LISTING

<u>Diameter</u>	<u>Grade 8.8 Bolt</u>
M6	9.5 Nm
M8	21.7 Nm
M10	43.4 Nm
M12	77.3Nm
M14	146 Nm
M16	189.8 Nm

Tow bar Maintenance and Care.

Trailboss recommends that bolt torque's, as listed below, are routinely and regularly inspected and checked for correct tension. Replace any worn or defective parts.

We recommended to remove Tow Ball Mounts (TBM's, tongues or lugs) when not being used for any considerable length of time.

So as to avoid injury, when not towing it is suggested that the tongue, Pull Pin and R-clip are removed then stored in a safe, clean and dry place, away from excessive moisture.

Hitch Pull Pins and spring "R" clips are regularly checked for proper installation. Replace any worn or defective parts.

TRAILBOSS



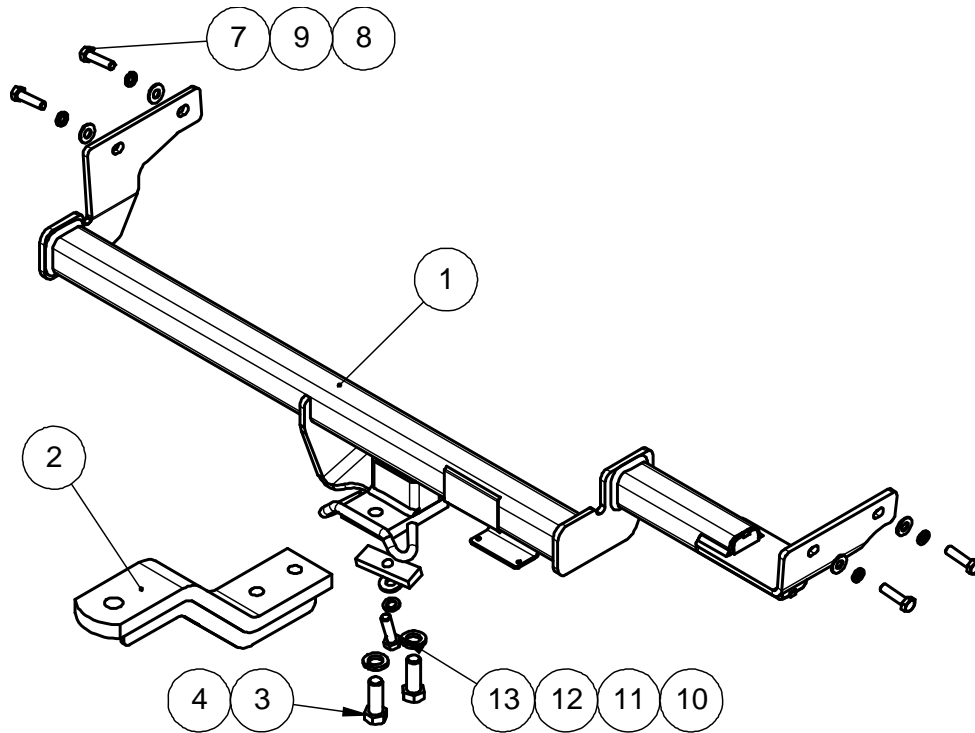

Towbar Fitting Instructions
 To Suit KIA CERATO 2009-on
 Part Number KM14L
 Suits - Si MODELS ONLY
 Rating 1200/120 kg



QTY.	DESCRIPTION	ITEM NO.
1	CERATO WELDED ASSY	1
1	LUG	2
2	M16 x 45 2.0P BOLT	3
2	M16 X 5 X 3.5 SPRING WASHER	4
1	CP - TB	5
1	FITTING INSTRUCTIONS	6
4	Bolt M10x1.25x40	7
4	Washer Flat M10 x 23 x 2 z/p	8
4	M10 X 3.5 X 2.2 SPRING WSHR	9
1	TAPPED PLATE 25x12x80 M12	10
1	Washer M12x28.8x3	11
1	M12 X 4.0 X 2.5 SPRING WASHER	12
1	BOLT M12-1.75x40 GR8.8	13
1	LRL - TB	14



TRAILBOSS

Towbar Fitting Instructions
To Suit KIA CERATO 2009-on
Part Number KM14L
Suits - Si MODELS ONLY
Rating 1200/120 kg

	<ol style="list-style-type: none">1. Remove 4 screws on each wheel arch, 2 inside, 1 under mud guard, 1 inside top corner of the bumper tip.
	<ol style="list-style-type: none">2. Remove 3 screws under the bumper.
	<ol style="list-style-type: none">3. Disconnect taillight and remove taillight assembly on both sides.4. Remove 2 screws holding the bumper inside taillight cavity.5. Release bumper skin from the vehicle by pulling away from the vehicle.
	<ol style="list-style-type: none">6. Remove centre bracket and discard.7. Release muffer hangs for ease of installation.

TRAILBOSS

Towbar Fitting Instructions
To Suit KIA CERATO 2009-on
Part Number KM14L
Suits - Si MODELS ONLY
Rating 1200/120 kg

	<p>8. Offer towbar to position; secure towbar to existing captive nuts on each side of chassis rails using supplied M10-1.25x40 bolts, spring washer and flat washer.</p>
	<p>9. Secure centre mounting point using supplied M12-1.75x40, spring washer, flat washer, and M12 Tapped plate.</p> <p>10. Torque all fasteners to specification.</p>
	<p>11. Trim off centre mounting point on bumper skin and reinstall the bumper in reverse order.</p>



Wiring Loom Fitting Instructions
To Suit Kia Cerato
Part Number 100145-WL

Wiring Loom Installation Instructions

**Kia Cerato
Part No: 100145-WL**

**Tail Harness Length Required: 1200mm
RPA Override Switch Part No: 04848 (If Fitted)**

Wiring Loom Installation Time: Approx 25 Mins



Wiring Loom Fitting Instructions
To Suit Kia Cerato
Part Number 100145-WL

1. Remove all the required trims to gain access to the LHS and RHS tail light connectors and the boot reverse light connector (underneath the boot lid trim).
2. Disconnect the boot reverse light 4-way connector and patch in the Trailer Patch Harness (P/No: 100145-WL) connectors. Secure the Trailer Patch Harness to the boot hinge clips using cable ties (not supplied).
3. Route the Trailer Patch Harness (P/No: 100145-WL) along the rear of the luggage compartment and towards the rear RHS quarter of the vehicle.
4. Disconnect the RHS tail light connectors and connect the Trailer Patch Harness connectors in between the tail light connectors.
5. Underneath the vehicle at the rear RHS quarter, remove the grommet.
6. Using a Ø31mm step drill, drill into the grommet hole.
7. Secure the Trailer socket onto the towbar mounting bracket with M4 fasteners (not supplied).
8. Route the Tail Harness across the towbar towards the grommet hole.
9. From outside of the vehicle, route the Tail Harness (tail length 1200mm) into the vehicle through the drilled out grommet hole.
10. Adjust the Tail Harness grommet to the correct position ensuring it is seated correctly into the grommet hole.
11. Connect the Tail Harness 8-way male connector to the Trailer Patch Harness female connector.
12. On the outside, secure the harness to the towbar using cable ties (not supplied).
13. Test the Trailer socket using a light board or multi-meter.
14. Secure the all harnesses using cables ties (not supplied).
15. Refit all removed parts and secure all fasteners.
16. Place instructions in glove box after fitment.