



Tow bar Fitting Instructions

To Suit MAZDA 3 SP23 SEDAN AND HATCH 01/04-03/09, 04/09-on HATCH ONLY

Part Number MA79

Rating 900/75Kg

WARNING:

1. Do not, drill, cut, weld or otherwise modify the tow bar.
2. If you are using electric welding on a motor vehicle, **always** check that the vehicle is not equipped with electronic engine or instrument management equipment. Failure to do so could **destroy** any onboard computers. If in doubt, check with the vehicle's manufacturer

- 1 Ensure all hardware items have been included
- 2 Remove bumper bar via:
 - a) Centre inner boot trim, 4 plastic trim buttons (sedan only, 2 for 09 hatch)
 - b) Right hand side inner boot trim, 3 plastic trim buttons (sedan only)
 - c) Left hand side inner boot trim, 4 plastic trim buttons (sedan only)
 - d) Tail lights via 4 x 6mm nuts unplug and pull rearward (hatch and sedan, 3 for 09 hatch)
 - e) Tail lights cavity, 2 plastic trim buttons and 2 screws (hatch and sedan)
 - f) Inner wheel arch, 4 screws (hatch and sedan, 2 plastic trim buttons and 2 screws)
 - g) 1 screw under mud guard on each sides (09 hatch)
 - h) Flex bumper out from the sides and pull rearward (hatch and sedan)
 - i) Disconnect any wiring to bumper.
- 3 Remove discard impact beam via 8 x 8mm nuts (hatch and sedan)
- 4 Uncover 4 x 12mm holes on the outer side of the chassis rails approximately 75mm and 375mm forward of back panel (hatch and sedan)
- 5 Locate towbar into the chassis rails and mount with 4 x M10 bolts (hatch and sedan)
- 6 Tighten to torque listing (hatch and sedan)
- 7 Cut bumper as per drawing via: (shown in figure 1 (hatch only))
 - a) 01/04-03/09 hatch cut 90mm wide, 40mm deep in the middle of the bumper.
 - b) 04/09 hatch 90mm wide, 90mm deep for single exhaust, 90mm wide, 110 deep for dual exhaust.
- 8 Refit bumper bar in reverse of step 2 (hatch and sedan)

RECOMMENDED ASSEMBLY TORQUE LISTING

<u>Diameter</u>	<u>Grade 8.8 Bolt</u>
	Nm
M6	9.5
M8	21.7
M10	43.4
M12	77.3
M14	121.0
M16	189.8

Tow bar Fitting Instructions
To Suit MAZDA 3 SP23 SEDAN AND HATCH 01/04-03/09, 04/09-on HATCH ONLY
Part Number MA79
Rating 900/75Kg

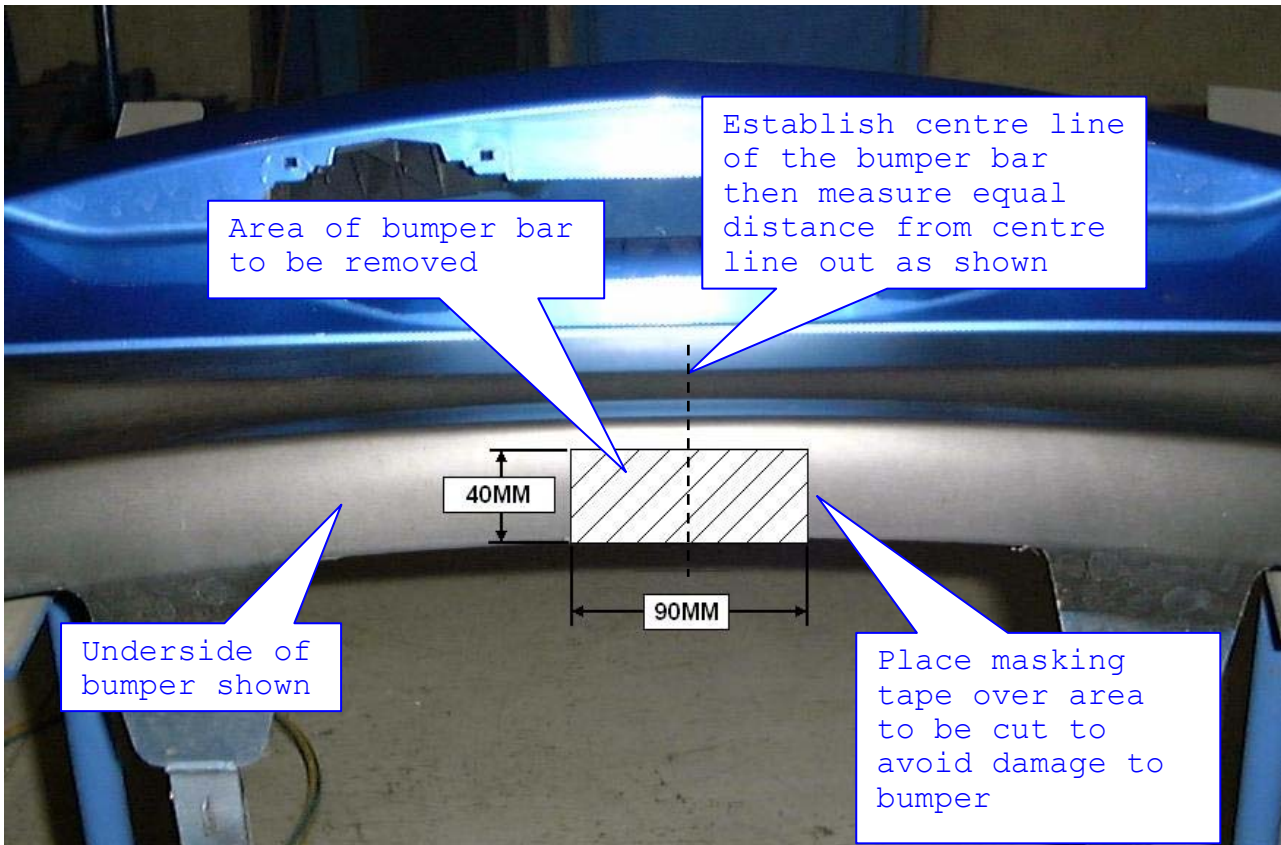

FIGURE 1: Bumper cut drawing for hatch only

BUMPER CUT REFERENCE

HATCH: 90mm wide, 40mm deep
09 HATCH SINGLE EXHAUST: 90mm wide, 90mm deep
09 HATCH TWIN EXAUSTS: 90mm wide, 110mm deep

TRAILBOSS

Tow bar Fitting Instructions

To Suit MAZDA 3 SP23 SEDAN AND HATCH 01/04-03/09, 04/09-on HATCH ONLY

Part Number MA79

Rating 900/75Kg

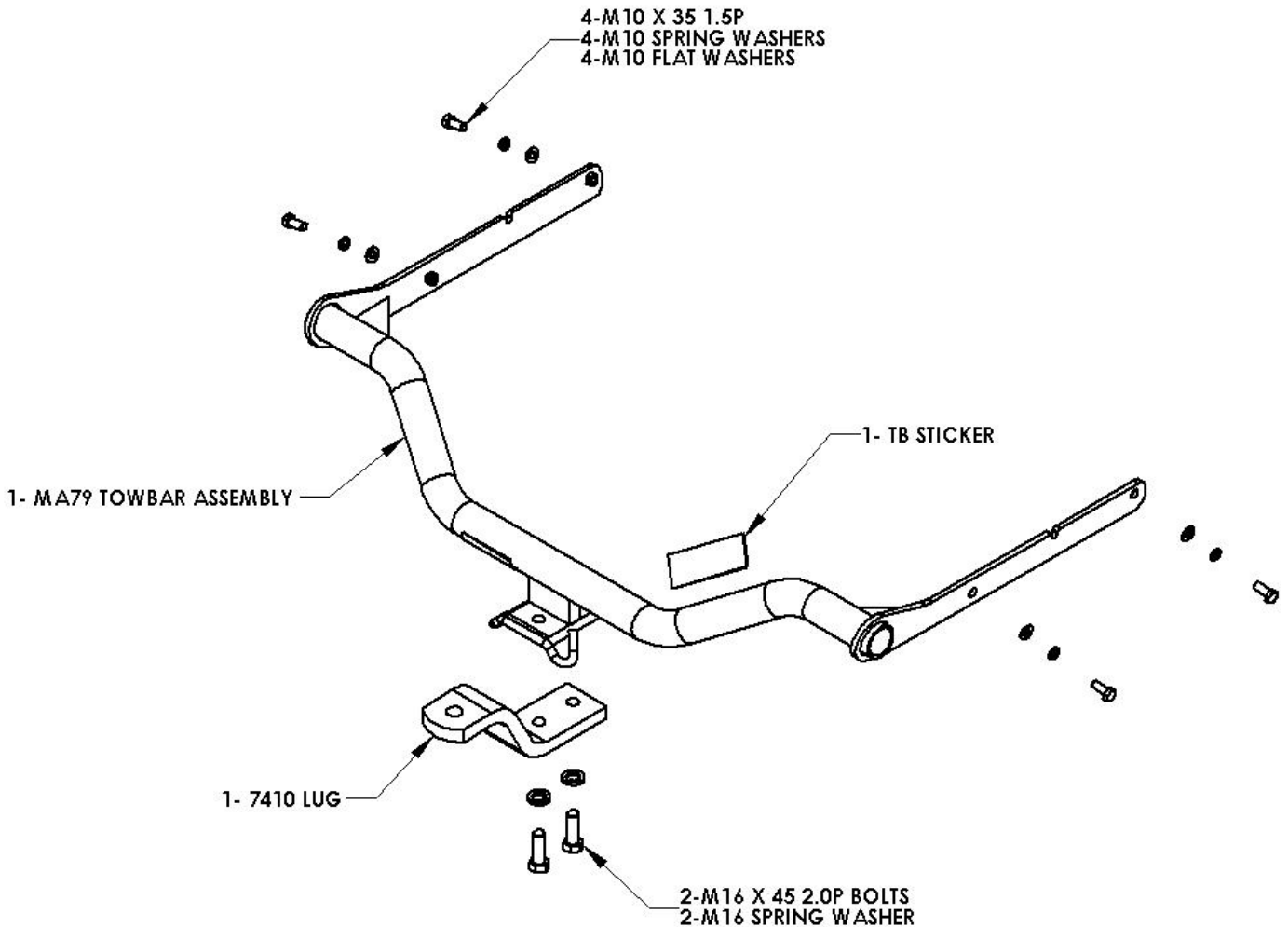

PLEASE NOTE: You must remove the lug unless you are actually towing if it obscures your number plate. Failure to do so may result in a fine.