



Towbar Fitting Instructions
To Suit **MAZDA 2 HATCH** 2011-on
Part Number **MA83L**
Rating **700/70** kg

WARNING:

1. Do not, drill, cut, weld or otherwise modify the tow bar.
2. If you are using electric welding on a motor vehicle, **always** check that the vehicle is not equipped with electronic engine or instrument management equipment. Failure to do so could **destroy** any onboard computers. If in doubt, check with the vehicle's manufacturer.
3. The high tensile fasteners supplied with this product were used to achieve the specified rating. If replacement is required ensure that fasteners of the same rating & quality are used. Contact an authorised **Trailboss** dealer if further information is required.

General:

1. Ensure all hardware items have been included refer to assembly diagram.
2. It is recommended that the instructions are read through and completely understood before making any attempt to fit this product.
3. Be wary of any changes to vehicle designs or other accessories that may conflict with the installation of this product.
4. Before drilling ensure that the area is clear of fuel, electrical & other components.
5. All holes drilled into the body panels shall have all burrs & swarf removed then coated with a suitable rust preventative paint.
6. For vehicles that require the bumper to be cut. Ensure cut out area is in correct position on the vehicle prior to cutting the bumper.
7. The high tensile fasteners supplied with this product were used to achieve the specified rating. If replacement is required ensure that fasteners of the same rating & quality are used. Contact an authorized **Trailboss** dealer if further information is required.
8. Ensure that all hardware is fastened to torque list below check fasteners on regular basis.
9. Tow bar load rating sticker provided with this product shall be conspicuously located on inside rear end of the driver's door. **(See diagram below).**
10. Trailboss recommends that you check your tow ball to ensure that it complies with the Australian standards **AS 4177.2**.
11. **PLEASE NOTE:** It is advised to remove your lug or tbn when not actually towing so as to produce a clear view of the vehicles registration plate if obscured, and to also provide maximum available departure angle
12. Pull Pin must be fit in down position.

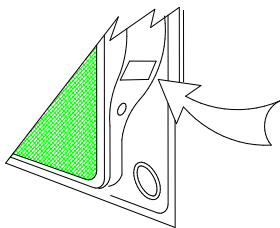

Place load rating sticker
inside driver's door here

FOR TRAILER TOWING PURPOSES ONLY
For towing capacity details please refer to vehicle owner's manual or to the manufacturer. Overloading can void your warranties.

RECOMMENDED ASSEMBLY TORQUE LISTING
Diameter Grade 8.8 Bolt

M6	9.5 Nm
M8	21.7 Nm
M10	43.4 Nm
M12	77.3Nm
M14	146 Nm
M16	189.8 Nm

Tow bar Maintenance and Care.

Trailboss recommends that bolt torque's, as listed below, are routinely and regularly inspected and checked for correct tension. Replace any worn or defective parts.

We recommended to remove Tow Ball Mounts (TBM's, tongues or lugs) when not being used for any considerable length of time.

So as to avoid injury, when not towing it is suggested that the tongue, Pull Pin and R-clip are removed then stored in a safe, clean and dry place, away from excessive moisture.

Hitch Pull Pins and spring "R" clips are regularly checked for proper installation. Replace any worn or defective parts.



Towbar Fitting Instructions
To Suit **MAZDA 2 HATCH** 2011-on
Part Number **MA83L**
Rating **700/70** kg

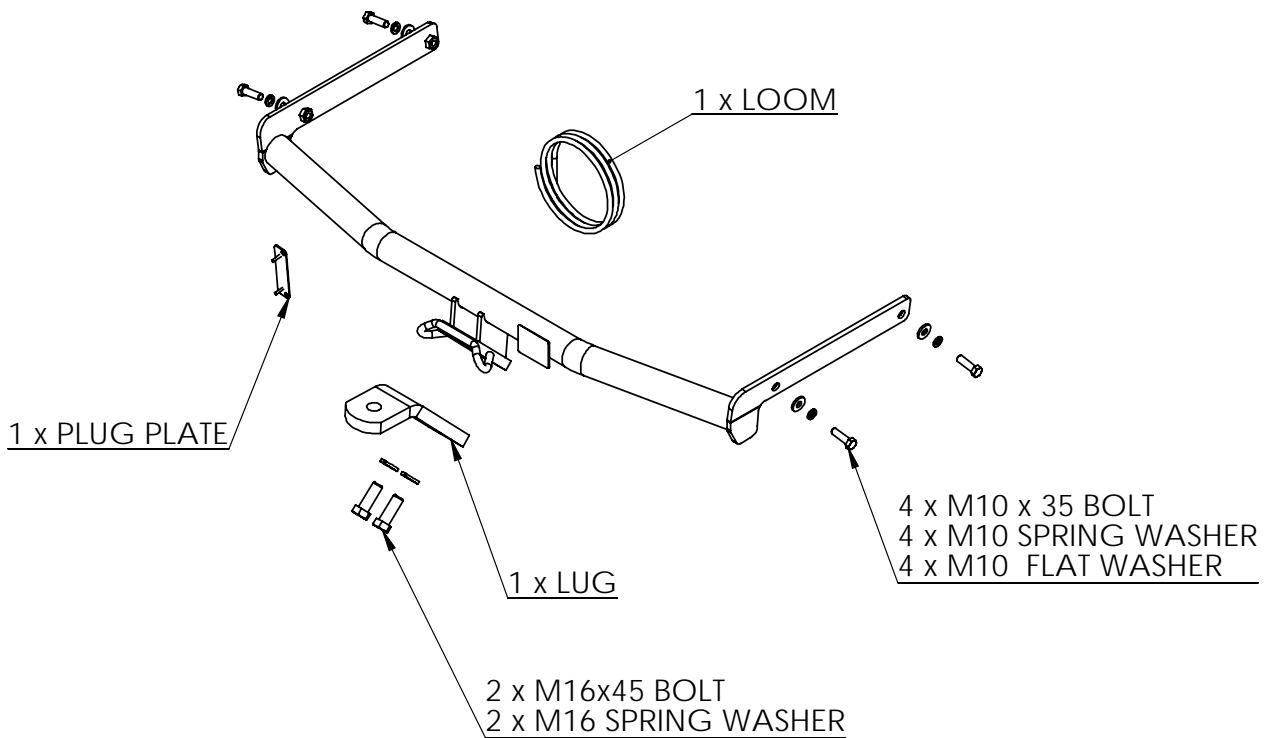

1. Remove 4 screws and 1 skivet around wheel arch area on both sides.
2. Remove 2 skivets under the bumper.
3. Open the boot lid and remove 2 screws between the cavities.
4. Loosen taillight assemblies via accessing from inside the boot.
5. Remove bumper and disconnect and wirings connecting to the bumper.
6. Fit towbar inside chassis rails, fit towbar using M10 bolts, washers, and spring washers supplied.
7. Torque all fasteners to specifications.
8. Using numberplate lights as a guide, cut 95mm wide by 55mm deep from the bottom of the bumper bar.
9. Refit bumper bar to vehicle.



Wiring Loom Installation Instructions
To Suit Mazda 2 Hatch
DE11 & DE12 2008 Onwards
Part Number 100073-WL

Wiring Loom Installation Instructions

**Mazda 2 Hatch
DE11 & DE12 2008 Onwards
Part No: 100073-WL**

Tail Harness Length Required: 1200mm

RPA Override Switch Part No: 04848 (If Fitted)

Wiring Loom Installation Time: Approx 30 Mins



Wiring Loom Installation Instructions
To Suit Mazda 2 Hatch
DE11 & DE12 2008 Onwards
Part Number 100073-WL

1. In the luggage compartment, remove the floor cover carpet.
2. Remove the parcel shelf and fold the rear seats forward.
3. Remove the rear trim by first removing the two clips.
4. Dislodge the LHS side trim by first removing any scrivets or fasteners.
5. Dislodge the RHS side trim by first removing any scrivets or fasteners.
6. Disconnect the RHS light 2-way connector.
7. From outside the vehicle, remove the RHS rear grommet.
8. Drill out the grommet hole to Ø31mm.
9. File any rough or sharp edges and spray on rust inhibitor.
10. From inside the luggage compartment, disconnect the LHS tail light 6-way connector.
11. Patch in the trailer patch mating 6-way connectors.
12. Route the trailer patch harness (P/No: 100073-WL) from the LHS tail light assembly towards the rear of the luggage compartment.
13. Route the trailer patch harness along the rear of the luggage compartment and towards the RHS.
14. Route the trailer patch harness towards the RHS tail light assembly.
15. Disconnect the RHS tail light 6-way connector.
16. Patch in the trailer patch mating 6-way connectors.
17. Using a self tapping tech screw, secure the trailer patch harness ground ring terminal to the RHS vehicle sheet metal as shown.

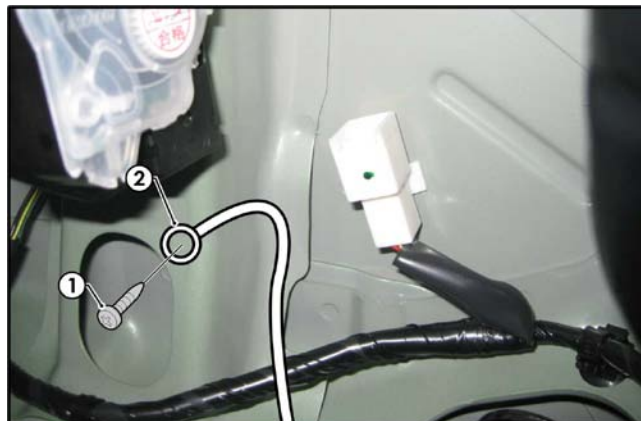



Wiring Loom Installation Instructions
To Suit Mazda 2 Hatch
DE11 & DE12 2008 Onwards
Part Number 100073-WL

18. Mount the trailer socket to the towbar mounting bracket using M4 fasteners (not supplied).
19. Route the tail harness (tail length 1200mm) across the towbar, towards the RHS of the vehicle and up through the previously drilled out grommet hole.
20. Ensure the tail harness grommet is seated correctly and secure in place using a cable tie (not supplied).
21. Connect the tail harness 8-way connector to the trailer harness mating 8-way connector.
22. Test the trailer harness function using a light board or multi meter.
23. Secure all harnesses using cables ties (not supplied).
24. Re-fit all removed parts and secure all fasteners, ensuring there are no squeaks or rattles.
25. Place the instructions in the glove box after fitment