

TRAILBOSS

Towbar Fitting Instructions
To Suit **NISSAN PATHFINDER 4x4 WAGON 10/2010 on**
Ti 550 - 3500 Kg Capacity Vehicle Only
Part Number **QTDS847L**
Rating 3500/350 kg

WARNING:

Do not, drill, cut, weld or otherwise modify the tow bar.

If you are using electric welding on a motor vehicle, **always** check that the vehicle is not equipped with electronic engine or instrument management equipment. Failure to do so could **destroy** any onboard computers. If in doubt, check with the vehicle's manufacturer.

NOTE: VEHICLE MANUFACTURER DOES NOT RECOMMEND WEIGHT DISTRIBUTION ON THIS VEHICLE

General:

1. Ensure all hardware items have been included refer to assembly diagram.
2. It is recommended that the instructions are read through and completely understood before making any attempt to fit this product.
3. Be wary of any changes to vehicle designs or other accessories that may conflict with the installation of this product.
4. Before drilling ensure that the area is clear of fuel, electrical & other components.
5. All holes drilled into the body panels shall have all burrs & swarf removed then coated with a suitable rust preventative paint.
6. For vehicles that require the bumper to be cut. Ensure cut out area is in correct position on the vehicle prior to cutting the bumper.
7. The high tensile fasteners supplied with this product were used to achieve the specified rating. If replacement is required ensure that fasteners of the same rating & quality are used. Contact an authorized **Trailboss** dealer if further information is required.
8. Ensure that all hardware is fastened to torque list below check fasteners on regular basis.
9. Tow bar load rating sticker provided with this product shall be conspicuously located on inside rear end of the driver's door. **(See diagram below).**
10. Trailboss recommends that you check your tow ball to ensure that it complies with the Australian standards **AS 4177.2.**
11. **PLEASE NOTE:** It is advised to remove your lug or tbm when not actually towing so as to produce a clear view of the vehicles registration plate if obscured, and to also provide maximum available departure angle

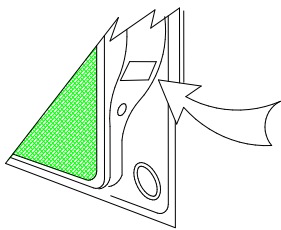

Place load rating sticker
inside driver's door here

FOR TOWING PURPOSES ONLY

For towing capacity details please refer to vehicle owner's manual or to the manufacturer. Overloading can void your warranties.

RECOMMENDED ASSEMBLY TORQUE LISTING

Diameter	Grade 8.8 Bolt
M6	9.5 Nm
M8	21.7 Nm
M10	43.4 Nm
M12	77.3Nm
M14	146 Nm
M16	189.8 Nm

Tow bar Maintenance and Care.

Trailboss recommends that bolt torque's, as listed below, are routinely and regularly inspected and checked for correct tension. Replace any worn or defective parts.

We recommended to remove Tow Ball Mounts (TBM's, tongues or lugs) when not being used for any considerable length of time.

So as to avoid injury, when not towing it is suggested that the tongue, Pull Pin and R-clip are removed then stored in a safe, clean and dry place, away from excessive moisture.

Hitch Pull Pins and spring "R" clips are regularly checked for proper installation. Replace any worn or defective parts.

TRAILBOSS

Towbar Fitting Instructions

To Suit **NISSAN PATHFINDER 4x4 WAGON 10/2010 on**

Ti 550 - 3500 Kg Capacity Vehicle Only

Part Number **QTDS847L**

Rating 3500/350 kg

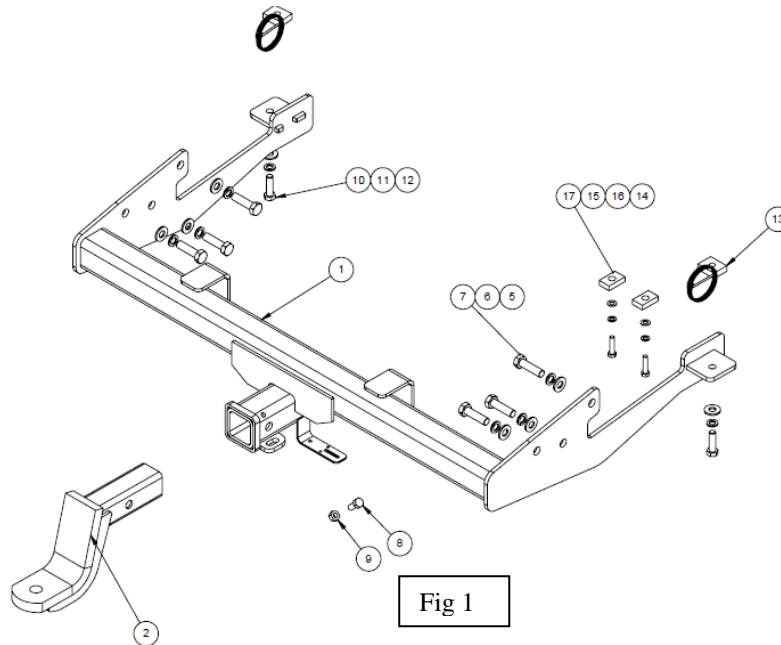

Fig 1

QTY.	DESCRIPTION	ITEM NO.
1	WELDED ASSY NISSAN PATHFINDER	1
1	TBM ASSEMBLY	2
1	BOLT PACK	3
1	Bag CK 200x500 Clear	4
6	M14 X 28 X 3 Z/P FT WASHER	5
6	M14 X 4.0 X 2.5 Z/P FT SEC SPRING WASHER	6
6	BOLT M14 x 50 x 1.5p	7
1	BOLT M10-1.50 x 25	8
1	M10x1.5 HEX NUT PC8	9
2	BOLT M12-1.75x40 GR8.8	10
2	Wshr spring ft sec M12x4.0x2.5mm z/p	11
2	WASHER M12x28.8x3mm	12
2	TAPPED PLATE AND WIRE ASSY	13
2	Bolt M8-1.25 x 35mm GR 8.8 z/p	14
2	Wshr ft M8 x 17 x 1.20 z/p	15
2	WSHR SPRING FT SEC M8x3.0x2.0mm z/p	16
2	PLATE 25 X 10 X 40 (DIA 13)	17

ADDITIONAL ITEMS



PULL PIN



R CLIP



TB COLLAR COVER



LOAD RATING LABEL



WIRING LOOM



FITTING INSTRUCTIONS



Towbar Fitting Instructions
To Suit **NISSAN PATHFINDER 4x4 WAGON 10/2010 on**
Ti 550 - 3500 Kg Capacity Vehicle Only
Part Number **QTDS847L**
Rating 3500/350 kg

STEPS TO FIT TOWBAR



Position the vehicle on to a safe working height on the hoist before commencing fitment.

1. Remove screws x 3 from the mud flap on the wheel arch.

Note: Repeat the step for driver side.

2. Remove screw x 1, from behind the mud flap and remove the mud flap.

Note: Repeat the step for driver side.

3. Remove screw x 1 from the top of the wheel arch.

Note: Repeat the step for driver side.

4. Remove the lights, by removing bolts x 2. Refer to manufacturer's manual for details.

Note: Repeat the step for driver side.

5. Turn the bumper lock pin after removing the lights to release.

Note: Repeat the step for driver side.

6. Remove screw x 2 and bolt x 1 from underneath the bumper, on both sides.

7. Remove bumper.

8. Remove the bumper foam support.

9. Locate the towbar on the vehicle, and line up the towbar holes, with the holes in the chassis rails and fit with the relevant fasteners, as shown in Figure 1

10. If required fit spacer plates (Item 17) between chassis and exhaust bracket to provide additional clearance from exhaust. (as shown in FIG: 1)

11. Torque the bolts to the required torque mentioned on page 1.

12. Establish the centreline of the bumper and make a cut, as per the illustration, shown in Figure 2.

Note: Make sure to cut the bumper as well as the internal plastic reinforcing.

13. Fit the bumper back on in the reverse order.

14. Fit the lights back on in the reverse order.

15. Affix the load rating label, as shown on page 1.

16. Use the Pull pin & R Clip, shown in Figure 1, as per the directions mentioned on page 1.

17. Install the wiring, as per the wiring instructions followed.

TRAILBOSS

Towbar Fitting Instructions

To Suit **NISSAN PATHFINDER 4x4 WAGON 10/2010 on**

Ti 550 - 3500 Kg Capacity Vehicle Only

Part Number **QTDS847L**

Rating 3500/350 kg



85

FROM CENTRE OF BUMPER EDGE – CUT OUT 85mm WIDE x 125mm HEIGHT

Bumper Cut Out Illustration (Figure 2).



Wiring Loom Fitting Instructions
To Suit Nissan Pathfinder
Part Number 100484-WL

Wiring Loom Installation Instructions

**Nissan Pathfinder
Part No: 100484-WL**

**Tail Harness Length Required: 1200mm
RPA Override Switch Part No: 04848 (If Fitted)**

Wiring Loom Installation Time: Approx 30 Mins



Wiring Loom Fitting Instructions
To Suit Nissan Pathfinder
Part Number 100484-WL

From the outside of the vehicle, remove the tail lights by first removing the two fasteners.

2. Remove the rear bumper fascia.
3. In the luggage compartment, ensure the rear seats are folded flat.
4. Remove the floor cover.
5. Remove the rear trim.
6. Remove the four 10mm bolts that are located under the cargo tie down hooks.
7. Remove the four 14mm seat belt mounting bolts.
8. Remove the RHS rear scuff plate.
9. Repeat step for the LHS.
10. Dislodge the RHS side trim.
11. Repeat step for the LHS.
12. Disconnect the 12v accessory connector.
13. From outside the vehicle, remove the RHS grommet.
14. Drill out the grommet hole to Ø31mm. File any rough or sharp edges and spray on rust inhibitor.
15. From inside the vehicle, disconnect the LHS tail light connectors.
16. Patch in the trailer harness (P/No: 100484-WL) mating connectors.
17. Connect the ground ring terminal to the factory ground location.
18. Route the trailer harness from the LHS, along the rear of the luggage compartment and towards the RHS tail light connectors.
19. Disconnect the RHS tail light connectors and patch in the trailer harness mating connectors.
20. From outside the vehicle, route the tail harness (tail length 1200mm) through the previously drilled out grommet hole to the inside of the vehicle.
21. Mount the trailer socket to the towbar mounting bracket using M4 fasteners (not supplied).
22. Route the tail harness across the towbar, towards the LHS of the vehicle and up through the previously drilled out hole.
23. Ensure that the tail harness grommet is seated correctly and secure in place using a cable tie (not supplied).
24. Connect the tail harness (tail length 1200mm) 8-way connector to the trailer harness mating 8-way connector.



Wiring Loom Fitting Instructions
To Suit Nissan Pathfinder
Part Number 100484-WL

25. Test the Trailer socket using a light board or multi-meter.
26. Secure the all harnesses using cables ties (not supplied).
27. Re-fit all removed parts and secure all fasteners.
28. Place instructions in glove box after fitment.