



Towbar Fitting Instructions  
To Suit GREAT WALL V240 STEP & NON STEP AND CAB CHASSIS 2009-on  
GREAT WALL V200 4x4 4x2 UTE 08 / 2011 On

Part Number **QTGW001L**

Rating (V240) 2250 - 225 kg

Rating (V200) 2000 - 200 kg

**WARNING:**

Do not, drill, cut, weld or otherwise modify the tow bar.

If you are using electric welding on a motor vehicle, **always** check that the vehicle is not equipped with electronic engine or instrument management equipment. Failure to do so could **destroy** any onboard computers. If in doubt, check with the vehicle's manufacturer.

**General:**

1. Ensure all hardware items have been included refer to assembly diagram.
2. It is recommended that the instructions are read through and completely understood before making any attempt to fit this product.
3. Be wary of changes to vehicle designs or other accessories that may conflict with the installation of this product.
4. Before drilling ensure that the area is clear of fuel, electrical & other components.
5. All holes drilled into the body panels shall have all burrs & swarf removed then coated with a suitable rust preventative paint.
6. For vehicles that require the bumper to be cut. Ensure cut out area is in correct position on the vehicle prior to cutting the bumper.
7. The high tensile fasteners supplied with this product were used to achieve the specified rating. If replacement is required ensure that fasteners of the same rating & quality are used. Contact an authorized **Trailboss** dealer if further information is required.
8. Ensure that all hardware is fastened to torque list below check fasteners on regular basis.
9. Tow bar load rating sticker provided with this product shall be conspicuously located on inside rear end of the driver's door. **(See diagram below).**
10. Trailboss recommends you check your tow ball to ensure that it complies with Australian standards **AS 4177.2**.
11. **PLEASE NOTE:** It is advised to remove your lug or tbn when not actually towing so as to produce a clear view of the vehicles registration plate if obscured, and to also provide maximum available departure angle

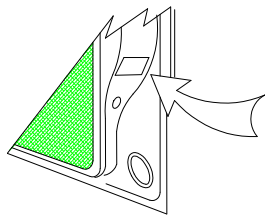

Place load rating sticker  
inside driver's door here

**FOR TOWING PURPOSES ONLY**

For towing capacity details please refer to vehicle owner's manual or to the manufacturer. Overloading can void your warranties.

**RECOMMENDED ASSEMBLY TORQUE LISTING**

Diameter    Grade 8.8 Bolt

M6	9.5 Nm
M8	21.7 Nm
M10	43.4 Nm
M12	77.3Nm
M14	146 Nm
M16	189.8 Nm

**Tow bar Maintenance and Care.**

Trailboss recommends that bolt torque's, as listed below, are routinely and regularly inspected and checked for correct tension. Replace any worn or defective parts.

We recommend to remove Tow Ball Mounts (Tongues or lugs) when not being used for any considerable length of time. So as to avoid injury, when not towing it is suggested that the tongue, Pull Pin and R-clip are removed then stored in a safe, clean and dry place, away from excessive moisture.

Hitch Pull Pins and spring "R" clips are regularly checked for proper installation. Replace any worn or defective parts.



**Towbar Fitting Instructions**  
**To Suit GREAT WALL V240 STEP & NON STEP AND CAB CHASSIS 2009-on**  
**GREAT WALL V200 4x4 4x2 UTE 08 / 2011 On**

Part Number **QTGW001L**

Rating (V240) 2250 - 225 kg

Rating (V200) 2000 - 200 kg

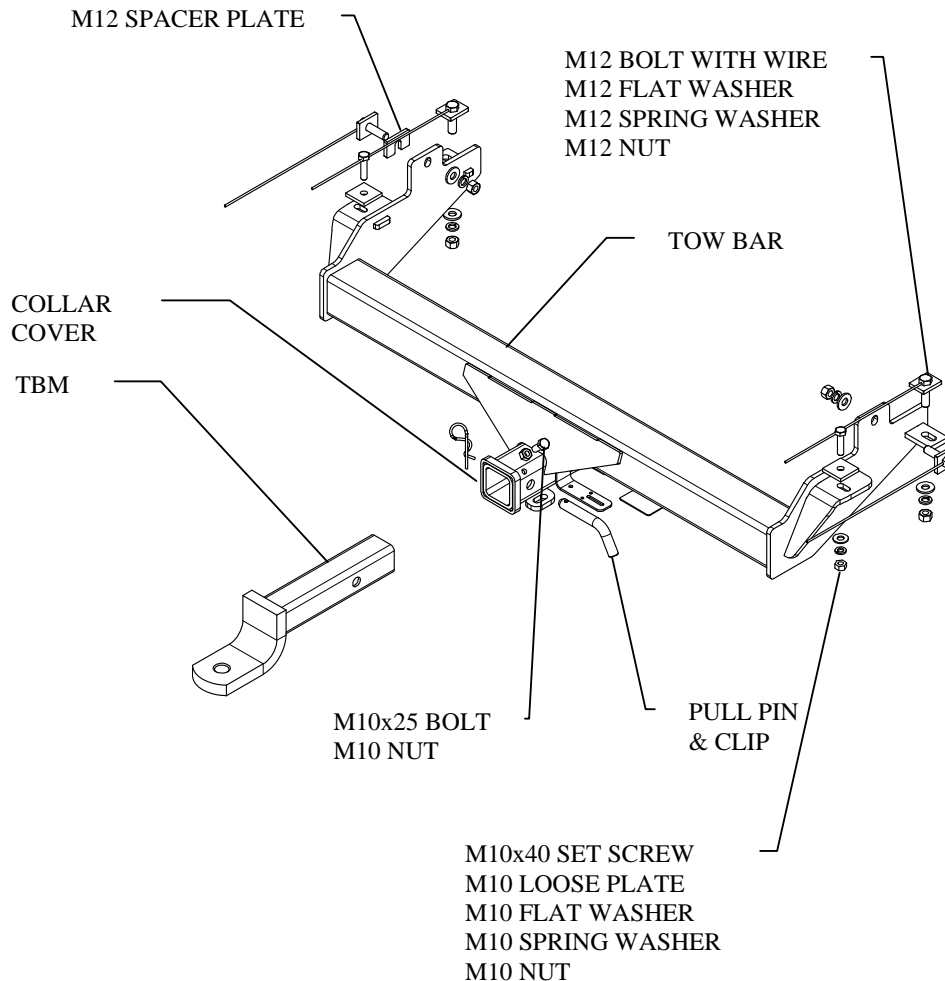

1. Insert M12 bolt with wire in to forward vertical hole from inside chassis rail on both sides.
2. Remove cable tie from chassis rail on both side.
3. Fit towbar to chassis with M12 nut, spring washer and flat washer to M12 bolt with wire.
4. Insert M12 bolt with wire inside chassis on to horizontal hole. Secure with M12 nut, spring washer and flat washer on both sides.  
**Note: you must insert spacer plate to horizontal hole on tow hook side.**
5. Secure rear most holes using M10 bolt, loose plate from inside chassis rail to M10 nut, spring washer & flat washer.
6. Torque all fasteners, starting from horizontal holes first.



Wiring Loom Fitting Instructions  
To Suit GWM V240 Ute & Cab Chassis  
GWM V200 4X2 & 4X4  
Part Number 100193-WL

### Wiring Loom Installation Instructions

GWM V240 Ute & Cab Chassis  
GWM V200 4X2 & 4X4  
Part No: 100193-WL

Ute -Tail Harness Length Required: 1800mm  
Cab Chassis – Tail Harness Length Required: 1200mm  
ECU (Optional) Part No: 04826  
Power Harness (Optional) Part No: 04825  
RPA Override Switch Part No: 04848 (If Fitted)

Ute – Page 3 - 4  
Cab Chassis – Page 3

Wiring Loom Installation Time: Approx 40 Mins



Wiring Loom Fitting Instructions  
To Suit GWM V240 Ute & Cab Chassis  
GWM V200 4X2 & 4X4  
Part Number 100193-WL



**Maximum trailer Electrical Load**

The Great Wall GWMV240 vehicle – like many other vehicles – has a limited amount of current available for powering trailer lighting circuits. If the vehicle circuits are overloaded by the trailer lighting circuits, vehicle fuses can fail and potential damage to wiring can occur. While most trailers have a small number of lamps on them, some larger trailers (especially 2 axle trailers and caravans) have a large number of lighting circuits.

The optional power harness and ECU for the Great Wall GWMV240 allows any large trailer to be towed without concern about drawing too much power from the vehicle circuits. Refer to the tables below to see the maximum lighting loads with and without the ECU and power harness option.

**Recommended Maximum trailer Electrical Load without ECU**

Light Signal Name	Load (Watts) total	Current Load (Amps) total (at 12V)
Left Turn	52W	4.3A
Right Turn	52W	4.3A
Tail Lamps	96W	8A
Reverse Lamps	52W	4.3A
Stop Lamps	52W	4.3A

**Recommended Maximum trailer Electrical Load with ECU**

Light Signal Name	Load (Watts) total	Load (Amps) total (at 12V)
Left Turn	96W	8 A
Right Turn	96W	8 A
Tail Lamps	132W	11 A
Reverse Lamps	96W	8 A
Stop Lamps	96W	8 A

**UTE**



Wiring Loom Fitting Instructions  
To Suit GWM V240 Ute & Cab Chassis  
GWM V200 4X2 & 4X4  
Part Number 100193-WL

1. Remove the RHS tail light fasteners and then remove the tail light.

**Repeat for the LHS side.**

2. From underneath the RHS rear quarter, route the trailer patch harness (P/No: 100193-WL) up the tail light cavity and connect the trailer Patch harness to the vehicle tail light connector.
3. Route the tail harness (tail length 1800mm) up through the RHS tail light cavity.
4. Apply electrical grease or silicon on to the back of the connectors to make them waterproof.
5. Connect the tail harness male 8-way connector to the trailer Patch harness female 8-way connector.
6. Connect the trailer Patch harness ECU connector to the ECU. Secure the ECU inside the RHS tail light cavity using cable ties or double sided adhesive tape (not supplied).

**Note: If the fitment does not require the ECU, connect the supplied ECU blanking connector into the trailer harness ECU connector.**

7. From underneath the vehicle RHS, drill into the indicated point and secure the trailer Patch harness ground ring terminal using a tech screw.
8. Route the trailer Patch harness across to the LHS tail light cavity and connect the body wiring to the trailer patch harness.

**Proceed with step 9 only if ECU has been fitted.**

9. Connect the power harness (P/No: 04825) 1-way connector to the trailer Patch harness 1-way connector.

**Note: If an ECU is required, continue with Steps 10, 11 and 12. Otherwise, go to Step 13.**

10. Route the power harness ORANGE wire ring terminal along the LHS chassis and to the brake lines.
11. Continue to route the power harness ring terminal along the brake lines, towards the engine bay.
12. Retrieve the power harness ring terminal and secure the terminal to the engine bay battery terminal.
13. Connect the trailer Patch harness to the tail light assembly connector.
14. Refit both tail light assemblies.
15. Using M4 fasteners (not supplied) mount the tail harness socket onto the towbar mounting plate.
16. Test the trailer harness function using a light board or multi meter.



Wiring Loom Fitting Instructions  
To Suit GWM V240 Ute & Cab Chassis  
GWM V200 4X2 & 4X4  
Part Number 100193-WL

17. Secure the all harnesses using cables ties (not supplied).
18. Refit all removed parts and secure all fasteners ensuring there are no squeaks or rattles.
19. Please place the fitting instructions in the glove box after installation.

**CAB CHASSIS**

1. Disconnect the RHS tail light connector.
2. Connect the RHS tail light connector to the trailer harness (P/No: 100193-WL) mating connector.
3. Connect the trailer harness connector to the RHS tail light assembly mating connector.
4. Route the trailer harness along the rear of the vehicle tray towards the LHS tail light assembly.
5. Connect the LHS tail light connector to the trailer harness mating connector.
6. Connect the trailer harness connector to the LHS tail light assembly mating connector.
7. Secure the trailer harness to the vehicle tray using cable ties (not supplied).
8. Connect the tail harness (tail length 1200mm) 8-way connector to the trailer harness mating 8-way connector.
9. Using electrical grease or silicone, water proof the back of the tail harness connector, trailer harness connector and 12-way ECU connector.
10. Route the tail harness towards the towbar.
11. Secure the trailer socket to the towbar mounting bracket using M4 fasteners (not supplied).
12. Secure the tail harness to the vehicle towbar using cable ties (not supplied).
13. Test the trailer harness function using a light board or multi meter.
14. Secure all harnesses to the vehicle using cable ties (not supplied).
15. Refit all removed parts and secure all fasteners ensuring there are no squeaks or rattles.
16. Please place the fitting instructions in the glove box after installation.