

TRAILBOSS

Towbar Fitting Instructions
To Suit **Hyundai IX35** on
Part Number **QTHY254L**
Rating **1600-160** kg

WARNING:

1. Do not, drill, cut, weld or otherwise modify the tow bar.
2. If you are using electric welding on a motor vehicle, **always** check that the vehicle is not equipped with electronic engine or instrument management equipment. Failure to do so could **destroy** any onboard computers. If in doubt, check with the vehicle's manufacturer.

General:

1. Ensure all hardware items have been included refer to assembly diagram.
2. It is recommended that the instructions are read through and completely understood before making any attempt to fit this product.
3. Be wary of any changes to vehicle designs or other accessories that may conflict with the installation of this product.
4. Before drilling ensure that the area is clear of fuel, electrical & other components.
5. All holes drilled into the body panels shall have all burrs & swarf removed then coated with a suitable rust preventative paint.
6. For vehicles that require the bumper to be cut. Ensure cut out area is in correct position on the vehicle prior to cutting the bumper.
7. The high tensile fasteners supplied with this product were used to achieve the specified rating. If replacement is required ensure that fasteners of the same rating & quality are used. Contact an authorized **Trailboss** dealer if further information is required.
8. Ensure that all hardware is fastened to torque list below check fasteners on regular basis.
9. Tow bar load rating sticker provided with this product shall be conspicuously located on inside rear end of the driver's door. **(See diagram below).**
10. Trailboss recommends that you check your tow ball to ensure that it complies with the Australian standards **AS 4177.2.**
11. **PLEASE NOTE:** It is advised to remove your lug or tbn when not actually towing so as to produce a clear view of the vehicles registration plate if obscured, and to also provide maximum available departure angle

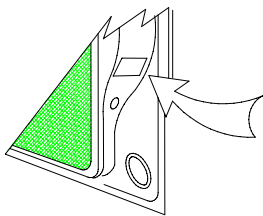

Place load rating sticker
inside driver's door here

FOR TOWING PURPOSES ONLY

For towing capacity details please refer to vehicle owner's manual or to the manufacturer. Overloading can void your warranties.

RECOMMENDED ASSEMBLY TORQUE LISTING

<u>Diameter</u>	<u>Grade 8.8 Bolt</u>
M6	9.5 Nm
M8	21.7 Nm
M10	43.4 Nm
M12	77.3Nm
M14	146 Nm
M16	189.8 Nm

Tow bar Maintenance and Care.

Trailboss recommends that bolt torque's, as listed below, are routinely and regularly inspected and checked for correct tension. Replace any worn or defective parts.

We recommended to remove Tow Ball Mounts (TBM's, tongues or lugs) when not being used for any considerable length of time.

So as to avoid injury, when not towing it is suggested that the tongue, Pull Pin and R-clip are removed then stored in a safe, clean and dry place, away from excessive moisture.

Hitch Pull Pins and spring "R" clips are regularly checked for proper installation. Replace any worn or defective parts.

TRAILBOSS

Towbar Fitting Instructions
To Suit **Hyundai IX35** on
Part Number **QTHY254L**
Rating **1600-160** kg

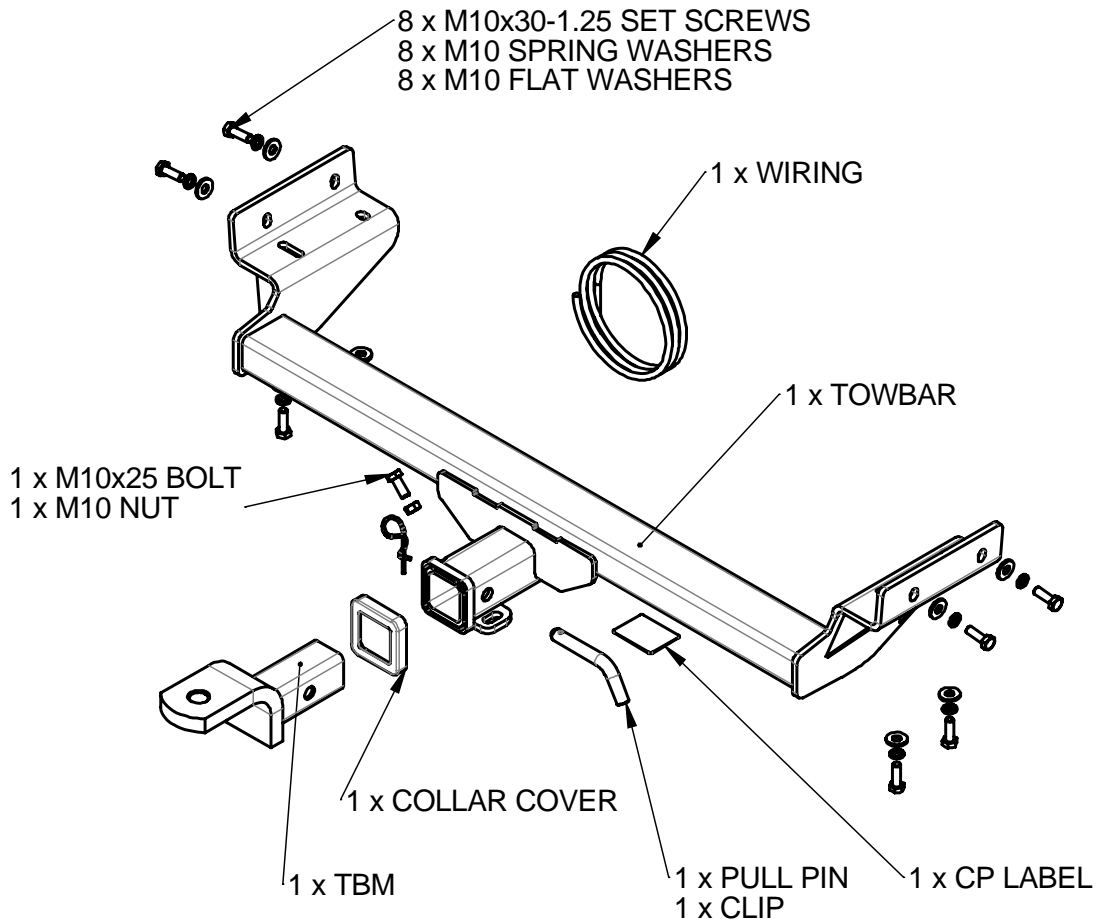

1. Remove bottom centre skivet of bumper bar, bend centre metal bracket upward.
2. Make two steps cut on to bumper bar. Step one from bottom, establish centre cut 230mm. wide and 25mm. deep.
Step two cut 75mm. wide and 70mm. deep.
3. Fit tow bar under chassis rails using M10x30-1.25 set screws, spring washers, and flat washers.
4. Once all fasteners in place, torque all fasteners to specification.



Wiring Loom Fitting Instructions
To Suit Hyundai ix35
Part Number 100284-WL

Wiring Loom Installation Instructions

Hyundai ix35
Part No: 100284-WL

Tail Harness Length Required: 1200mm
RPA Override Switch Part No: 04848 (If Fitted)

Wiring Loom Installation Time: Approx 50 Mins

TRAILBOSS

Wiring Loom Fitting Instructions To Suit Hyundai ix35 Part Number 100284-WL

1. Remove all the required trims to gain access to the vehicle LHS and RHS rear quarters.
2. Remove the rear passenger seat cushion, RHS front and rear passenger door sill trims.
3. Remove the driver's kick panel and the driver's lower dash garnish trim.
4. Dislodge the lower 'B' pillar trim.
5. At the luggage compartment RHS area, remove the black covering.
6. At the RHS rear quarter, locate the air vent. Drill a $\varnothing 31$ mm hole into the flat sheet metal area to the bottom-right corner of the air vent. File down any rough or sharp edges and spray on rust inhibitor.
7. At the LHS rear quarter of the vehicle, route the trailer patch harness (P/No: 100284-WL) tail light assembly connector through the tail light cavity ensuring the trailer patch harness grommet is seated correctly. Connect the trailer patch connector to the vehicle tail light connector.
8. Locate the vehicle RED reverse wire from the LHS vehicle main wiring. Secure the supplied ezy tap onto the vehicle harness RED reverse wire. Connect the trailer patch wire terminal into the ezy tap.
9. At the RHS rear quarter of the vehicle, route the trailer patch harness (P/No: 100284-WL) tail light assembly connector through the tail light cavity ensuring the trailer patch harness grommet is seated correctly. Connect the trailer patch connector to the vehicle tail light connector.
10. Secure the trailer patch ground ring terminal to the vehicle sheet metal just below the centre area of the RHS 'D' pillar trim.
11. Route the trailer patch harness power wire to the fuse panel at the front of the vehicle.
12. At the driver's cabin, connect the power harness (1) to the add-a-fuse harness (2). Remove and discard the vehicle fuse from the location shown (3). Insert the two supplied 15amp fuses (4) into the add-a-fuse harness. Insert the add-a-fuse harness (2) into the slot of the previously removed fuse (3).

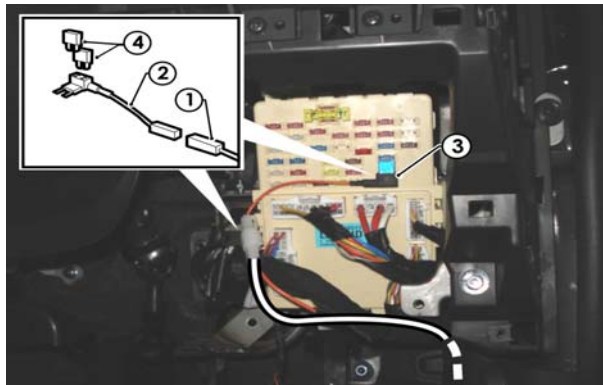



Wiring Loom Fitting Instructions
To Suit Hyundai ix35
Part Number 100284-WL

13. From the outside rear of the vehicle, mount the tail harness socket onto the towbar mounting bracket using M4 fasteners (not supplied).
14. Route the tail harness (tail length: 1200mm) into the vehicle. Adjust the tail harness grommet into place so that it is seated correctly. Secure the grommet into place using a cable tie (not supplied).
15. Connect the trailer patch harness connector to the tail harness connector.
16. On the outside, secure the harness to the towbar using cable ties (not supplied).
17. Test the Trailer socket using a light board or multi-meter.
18. Secure the all harnesses using cables ties (not supplied).
19. Refit all removed parts and secure all fasteners.
20. Place instructions in glove box after fitment.