

TRAILBOSS

Towbar Fitting Instructions To Suit **Jeep Grand Cherokee** 2011-on Part Number **QTJP11L** Rating **3500/350** kg

WARNING:

1. Do not, drill, cut, weld or otherwise modify the tow bar.
2. If you are using electric welding on a motor vehicle, **always** check that the vehicle is not equipped with electronic engine or instrument management equipment. Failure to do so could **destroy** any onboard computers. If in doubt, check with the vehicle's manufacturer.
3. The high tensile fasteners supplied with this product were used to achieve the specified rating. If replacement is required ensure that fasteners of the same rating & quality are used. Contact an authorised **Trailboss** dealer if further information is required.

General:

1. Ensure all hardware items have been included refer to assembly diagram.
2. It is recommended that the instructions are read through and completely understood before making any attempt to fit this product.
3. Be wary of any changes to vehicle designs or other accessories that may conflict with the installation of this product.
4. Before drilling ensure that the area is clear of fuel, electrical & other components.
5. All holes drilled into the body panels shall have all burrs & swarf removed then coated with a suitable rust preventative paint.
6. For vehicles that require the bumper to be cut. Ensure cut out area is in correct position on the vehicle prior to cutting the bumper.
7. The high tensile fasteners supplied with this product were used to achieve the specified rating. If replacement is required ensure that fasteners of the same rating & quality are used. Contact an authorized **Trailboss** dealer if further information is required.
8. Ensure that all hardware is fastened to torque list below check fasteners on regular basis.
9. Tow bar load rating sticker provided with this product shall be conspicuously located on inside rear end of the driver's door. **(See diagram below).**
10. Trailboss recommends that you check your tow ball to ensure that it complies with the Australian standards **AS 4177.2.**
11. **PLEASE NOTE:** It is advised to remove your lug or tbn when not actually towing so as to produce a clear view of the vehicles registration plate if obscured, and to also provide maximum available departure angle
12. Pull Pin must be fit in down position.

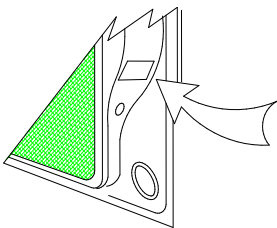

Place load rating sticker
inside driver's door here

FOR TRAILER TOWING PURPOSES ONLY
For towing capacity details please refer to vehicle owner's manual or to the manufacturer. Overloading can void your warranties.

RECOMMENDED ASSEMBLY TORQUE LISTING

| <u>Diameter</u> | <u>Grade 8.8 Bolt</u> |
|-----------------|-----------------------|
| M6 | 9.5 Nm |
| M8 | 21.7 Nm |
| M10 | 43.4 Nm |
| M12 | 77.3Nm |
| M14 | 146 Nm |
| M16 | 189.8 Nm |

Tow bar Maintenance and Care.

Trailboss recommends that bolt torque's, as listed below, are routinely and regularly inspected and checked for correct tension. Replace any worn or defective parts.

We recommended to remove Tow Ball Mounts (TBM's, tongues or lugs) when not being used for any considerable length of time.

So as to avoid injury, when not towing it is suggested that the tongue, Pull Pin and R-clip are removed then stored in a safe, clean and dry place, away from excessive moisture.

Hitch Pull Pins and spring "R" clips are regularly checked for proper installation. Replace any worn or defective parts.

TRAILBOSS

Towbar Fitting Instructions
To Suit **Jeep Grand Cherokee** 2011-on
Part Number **QTJP11L**
Rating **3500/350 kg**

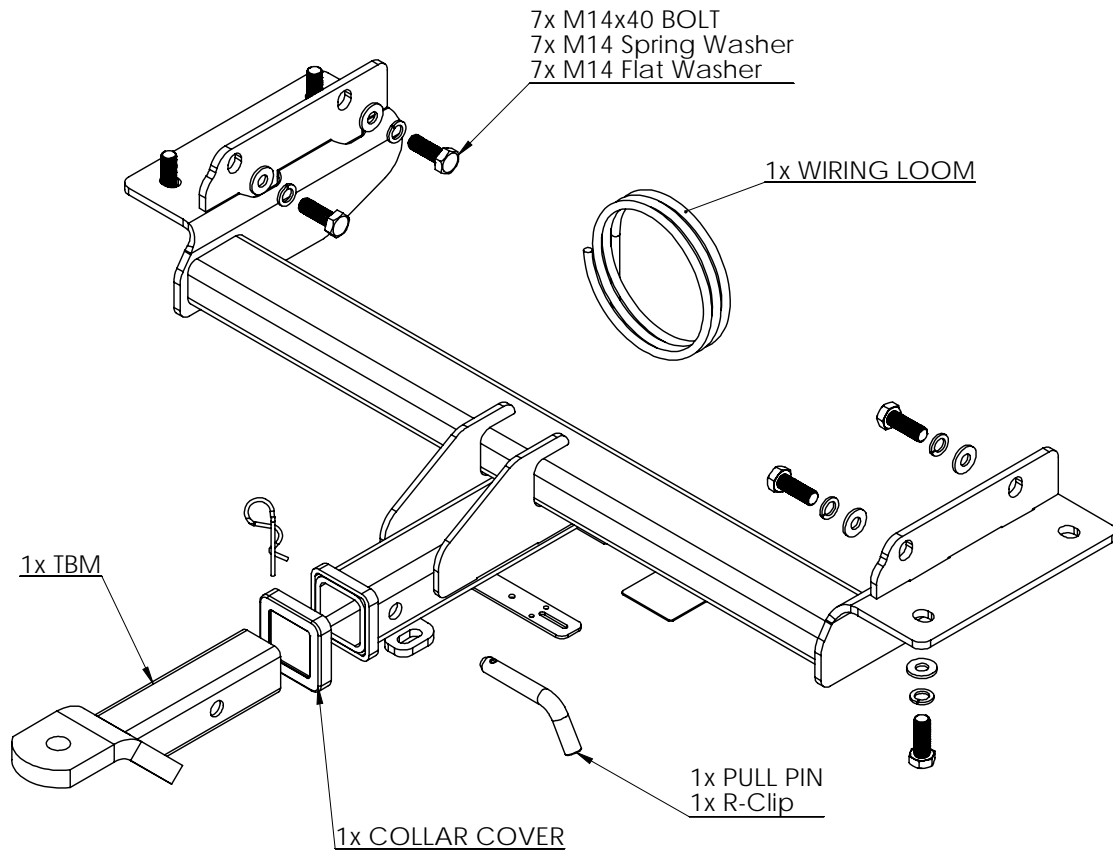

1. Remove recovery hook on passenger side via 5 setscrews and discard.
2. Remove 3 setscrews from the other sides attaching to impact beam.
3. Cut 90mmx90mm section from the bottom centre of the bumper.
4. Cut or trim off sheet metal along bottom of chassis rails, after cut bend sheet metal back flush to the rear panel.
5. Fit towbar using fasteners provided, please note there only 3 fastening points on driver side.
6. Torque all fasteners to specification on page1



Wiring Loom Fitting Instructions
To Suit Jeep WK2 Grand Cherokee
Part Number 100523-WL

Wiring Loom Installation Instructions

**Jeep WK2 Grand Cherokee
Part No: 100523-WL**

Tail Harness Length Required: 1200mm

Wiring Loom Installation Time: Approx 20 Mins

Note: Factory RPA cannot be overridden, however it can be disabled through a switch on the vehicle dash.

Wiring Loom Fitting Instructions To Suit Jeep WK2 Grand Cherokee Part Number 100523-WL

1. In the luggage compartment, remove the parcel shelf and the floor cover.
2. Remove the LHS & RHS large storage compartments.
3. Fold the rear seats forward.
4. Remove the small LHS storage compartment.
5. Remove the rear trim by first removing the two 7mm bolts from the rear cargo hooks.
6. Remove the two screws from the front cargo hooks.
7. Remove the spare wheel surround by first removing the two nuts and disconnecting the connector.
8. Dislodge the LHS luggage compartment trim and disconnect the connector.
9. In the LHS rear quarter of the luggage compartment, lift the carpet upwards and drill a Ø31mm hole (1) in the vehicle sheet metal, as shown below.



10. File any rough or sharp edges and spray on rust inhibitor.
11. On the LHS of the luggage compartment, locate the 13-way male breakout connector.
12. Connect the Trailer Harness (P/No: 100523-WL) 13-way female connector to the vehicle 13-way male breakout connector.
13. Mount the trailer socket to the towbar mounting bracket using M4 fasteners (not supplied).
14. Route the Tail Harness (tail length 1200mm) across the towbar and up through the previously drilled out hole.
15. Ensure the Trailer Harness grommet is seated correctly and secure it in place using a cable tie (not supplied).
16. Connect the Tail Harness 8-way connector to the Trailer Harness mating 8-way connector.



Wiring Loom Fitting Instructions
To Suit Jeep WK2 Grand Cherokee
Part Number 100523-WL

17. Test the Trailer socket using a light board or multi-meter.
18. Secure the all harnesses using cables ties (not supplied).
19. Re-fit all removed parts and secure all fasteners, ensuring there are no squeaks or rattles.
20. Place the instructions in the glove box after fitment.