

TRAILBOSS

Tow bar Fitting Instructions
To Suit Kia Sorrento 2003-0N
Part Number QTKM6L
Rating from 2003- 11/06 – 2300Kg
Rating From 11/2006-ON - 2800kg

WARNING : 1. Do not drill, cut weld or otherwise modify the towbar.

2. If you are using electric welding on a motor vehicle, always check that the vehicle is not equipped with electronic engine or instrument management equipment. Failure to do so could destroy any onboard computers. If in doubt, check with the vehicle's manufacturer.

1. Ensure all hardware items have been included
2. It is recommended that the instructions are read through and completely understood before making any attempt to fit this product.
3. Be wary of any changes to vehicle designs or other accessories that may conflict with the installation of this product.
4. The high tensile fasteners supplied with this product were used to achieve the specified rating. If replacement is required ensure that fasteners of the same rating & quality are used. Contact an authorised **Trailboss** dealer if further information is required.
5. Ensure that all hardware is fastened to torque list below check fasteners on regular basis.
6. Lift towbar into position, so as holes within side arm align with captive nuts on inside of chassis rails.
7. Fit 4 M12 bolts spring washers & flat washers into captive nuts & semi tighten.
8. Fit 2 M10 bolts on wire through large hole on outside of chassis rail down through side mounting tags on each side of towbar.
9. Fit nuts spring washers & flat washers to M10 bolts.
10. Tighten all bolts to torque listing.
11. Towbar load rating sticker provided with this product shall be conspicuously located on inside rear end of the driver's door. **(See diagram below).**
12. Trailboss recommends that you check your tow ball to ensure that it complies with the Australian standards **AS 4177.2**.
13. **PLEASE NOTE:** It is advised to remove your lug or TBM when not actually towing so as to produce a clear view of the vehicles registration plate if obscured, and to also provide maximum available departure angle.

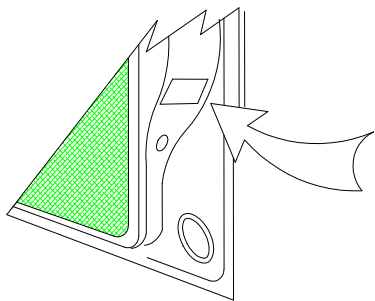

Place load rating sticker
inside driver's door here

RECOMMENDED ASSEMBLY TORQUE LISTING
Diameter Grade 8.8 Bolt

M6	9.5 Nm
M8	21.7 Nm
M10	43.4 Nm
M12	77.3 Nm
M16	189.8 Nm

FOR TOWING PURPOSES ONLY
For towing capacity details please refer to vehicle owner's
manual or to the manufacturer. Overloading can void your

TRAILBOSS

Tow bar Fitting Instructions
 To Suit Kia Sorrento 2003-0N
 Part Number QTKM6L
 Rating from 2003- 11/06 – 2300Kg
 Rating From 11/2006-ON - 2800kg
QTKM6L - HITCH ASSEMBLY

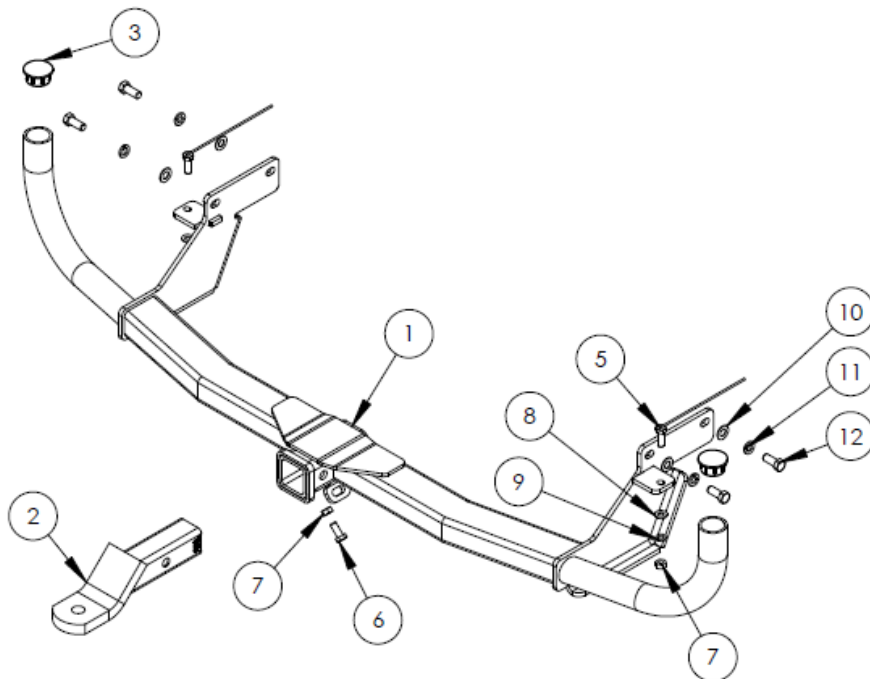

ADDITIONAL ITEMS



ITEM NO.	QTY.	DESCRIPTION
1	1	WELDED ASSEMBLY
2	1	T.B.MOUNT 21161
3	2	END CAP BLANK
4	1	BOLTPACK ASSEMBLY
5	2	BOLT M10x30 1.5P & WIRE 200
6	1	M10 x 25 1.5P BOLT
7	3	NUT M10 x 1.5P
8	2	Wshr ft 3/8 x 1 x 16 brt z/p
9	2	M10 SPRING WASHER
10	4	Wshr ft 1/2" x 1-1/8" x 16 z/p
11	4	M12 SPRING WASHER
12	4	BOLT M12x30 1.5P

Tow bar Maintenance and Care.

Trailboss recommends that bolt torque's, as listed below, are routinely and regularly inspected and checked for correct tension. Replace any worn or defective parts.
 We recommended to remove Tow Ball Mounts (TBM's, tongues or lugs) when not being used for any considerable length of time.
 So as to avoid injury, when not towing it is suggested that the tongue, Pull Pin and R-clip are removed then stored in a safe, clean and dry place, away from excessive moisture.
 Hitch Pull Pins and spring "R" clips are regularly checked for proper installation. Replace any worn or defective parts.



Wiring Loom Fitting Instructions
To Suit Kia Sorento
Part Number 100015-WL

Wiring Loom Installation Instructions

Kia Sorento
Part No: 100015-WL

Tail Harness Length Required: 1200mm
RPA Override Switch Part No: 04848 (If Fitted)

Wiring Loom Installation Time: Approx 45 Mins



Wiring Loom Fitting Instructions
To Suit Kia Sorento
Part Number 100015-WL

1. In the luggage compartment, remove the parcel shelf and the three caps at the base of the rear seats.
2. Fold the rear of the floor cover carpet back to gain access to the four 10mm bolts.
3. Remove the four 10mm bolts.
4. Remove the floor cover carpet.
5. Fold the rear seats forward.
6. Remove the LHS and RHS outer floor covers.
7. Remove the tool storage tray by first removing the 5 screws.
8. Remove the rear trim.
9. Dislodge the upper LHS upper trim.
10. Remove the lower screw and dislodge the LHS side trim enough to gain access to the LHS tail light connector.
11. Remove the RHS parcel shelf guide by first removing the screw and the bolt located under the cap.
12. Remove the two cargo hooks by first removing the two M10 bolts.
13. Remove the RHS scuff plate to gain access to the screw located underneath.
14. Remove the screw.
15. Remove the three screws located underneath the caps on RHS 'C' Pillar.
16. Dislodge the RHS upper trim.
17. Remove the three lower clips and remove the RHS side trim.
18. Remove the vehicle jack.

Wiring Loom Fitting Instructions To Suit Kia Sorento Part Number 100015-WL



19. Remove the RHS vehicle grommet (1).
20. Drill out the grommet hole to Ø31mm.
21. File any rough or sharp edges and spray on rust inhibitor.
22. Locate and disconnect the LHS tail light connector.
23. Patch in the trailer harness (P/No: 100015-WL) mating connectors.
24. Route the trailer harness across the rear of the luggage compartment and towards the RHS of the vehicle.
25. Locate and disconnect the RHS tail light connector.
26. Patch in the trailer harness mating connectors.
27. From outside the vehicle, mount the trailer socket to the towbar mounting bracket using M4 fasteners (not supplied).
28. Route the Tail Harness across the towbar towards the RHS of the vehicle and up through the previously drilled out hole.
29. Ensure the Tail Harness grommet is seated correctly and secure in place using a cable tie (not supplied).
30. Connect the Tail Harness 8-way connector to the Trailer Harness mating 8-way connector.
31. Test the Trailer Harness function using a Light Board or multi-meter.
32. Secure all Harnesses using cables ties (not supplied).
33. Re-fit all removed parts and secure all fasteners, ensuring there are no squeaks or rattles.
34. Place the instructions in the glove box after fitment.