

TRAILBOSS

Towbar Fitting Instructions

To Suit **MERCEDES C-CLASS W205 08/14 – ON (DIESEL ONLY)**

NOTE: Does not suit AMG Styling or Hybrid model.

Part Number **QTMB411L**

Rating **1800/75 kg**

PLACE THESE INSTRUCTIONS IN THE VEHICLE'S GLOVEBOX AFTER INSTALLATION IS COMPLETED

WARNING:

1. Do not, drill, cut, weld or otherwise modify the tow bar.
2. If you are using electric welding on a motor vehicle, **always** check that the vehicle is not equipped with electronic engine or instrument management equipment. Failure to do so could **destroy** any onboard computers. If in doubt, check with the vehicle's manufacturer.
3. The high tensile fasteners supplied with this product were used to achieve the specified rating. If replacement is required ensure that fasteners of the same rating & quality are used. Contact an authorised **Trailboss** dealer if further information is required.
4. If TBM is used in inverted position tow ball may make contact with rear tailgate when lowered, which could cause damage.

General:

1. Ensure all hardware items have been included refer to assembly diagram.
2. It is recommended that the instructions are read through and completely understood before making any attempt to fit this product.
3. Be wary of any changes to vehicle designs or other accessories that may conflict with the installation of this product.
4. Before drilling ensure that the area is clear of fuel, electrical & other components.
5. All holes drilled into the body panels shall have all burrs & swarf removed then coated with a suitable rust preventative paint.
6. For vehicles that require the bumper to be cut. Ensure cut out area is in correct position on the vehicle prior to cutting the bumper.
7. The high tensile fasteners supplied with this product were used to achieve the specified rating. If replacement is required ensure that fasteners of the same rating & quality are used. Contact an authorized **Trailboss** dealer if further information is required.
8. Ensure that all hardware is fastened to torque list below check fasteners on regular basis.
9. Tow bar load rating sticker provided with this product shall be conspicuously located on inside rear end of the driver's door. **(See diagram below).**
10. Trailboss recommends that you check your tow ball to ensure that it complies with the Australian standards **AS 4177.2.**
11. **PLEASE NOTE:** It is advised to remove your lug or tbm when not actually towing so as to produce a clear view of the vehicles registration plate if obscured, and to also provide maximum available departure angle
12. Pull Pin must be fit in down position.

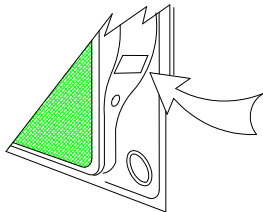

Place load rating sticker
inside driver's door here

FOR TRAILER TOWING PURPOSES ONLY
For towing capacity details please refer to vehicle owner's manual or to the manufacturer. Overloading can void your warranties.

RECOMMENDED ASSEMBLY TORQUE LISTING

<u>Diameter</u>	<u>Grade 8.8 Bolt</u>
M6	9.5 Nm
M8	21.7 Nm
M10	43.4 Nm
M12	77.3Nm
M14	146 Nm
M16	189.8 Nm

Tow bar Maintenance and Care.

Trailboss recommends that bolt torque's, as listed below, are routinely and regularly inspected and checked for correct tension. Replace any worn or defective parts.

We recommended to remove Tow Ball Mounts (TBM's, tongues or lugs) when not being used for any considerable length of time.

So as to avoid injury, when not towing it is suggested that the tongue, Pull Pin and R-clip are removed then stored in a safe, clean and dry place, away from excessive moisture.

Hitch Pull Pins and spring "R" clips are regularly checked for proper installation. Replace any worn or defective parts.

Rev: A

Page 1

Issue Date: **28-07-2015**

Cequent Customer Service

Ph: 1800 812 017 Fax: 03 9898 3299

Email: info@cequent.com.au

Post: PO Box 4050, Dandenong South VIC 3175

TRAILBOSS

Towbar Fitting Instructions

To Suit **MERCEDES C-CLASS W205 08/14 – ON (DIESEL ONLY)**

NOTE: Does not suit AMG Styling or Hybrid model.

Part Number **QTMB411L**

Rating **1800/75 kg**

PLACE THESE INSTRUCTIONS IN THE VEHICLE'S GLOVEBOX AFTER INSTALLATION IS COMPLETED

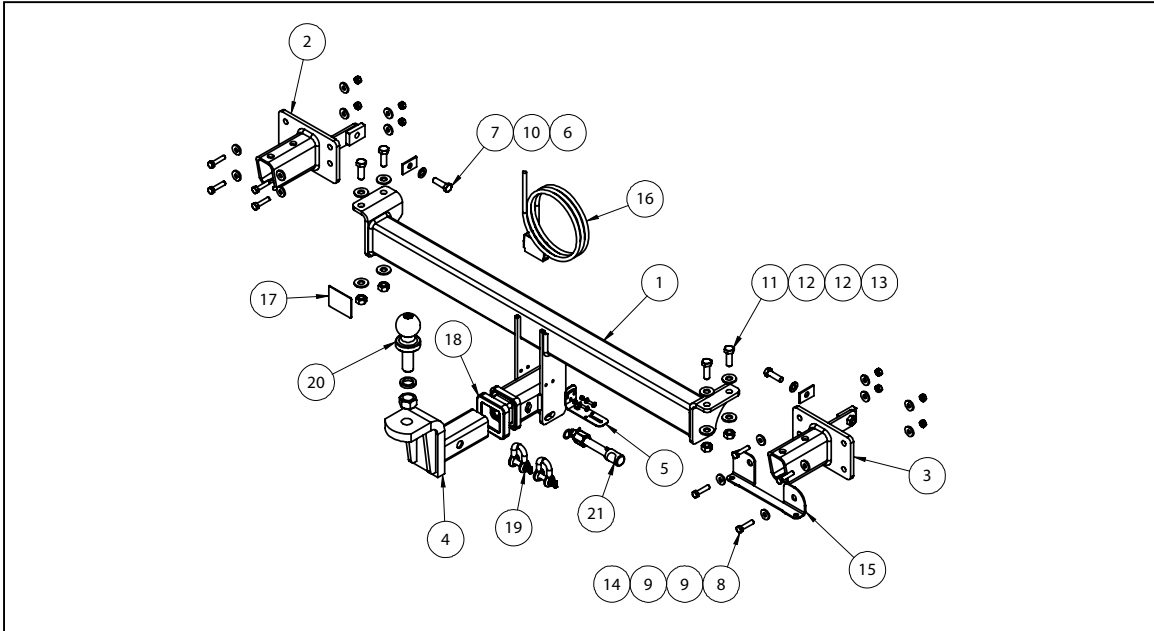

QTY.	DESCRIPTION	ITEM NO.
1	MER C-CLASS CENTRE SECTION ASSY	1
1	SIDEARM ASSEMBLY LHS	2
1	SIDEARM ASSEMBLY RHS	3
1	TBM ASSY	4
1	UNIVERSAL PULG BRACKET KIT	5
2	LOOSE PLATE 25x3x40 Ø11	6
2	SET SCREW M10-1.5x35mm	7
8	BOLT HEX M8x35x1.25P	8
16	FLAT WASHER M8x22x3.3mm	9
2	FLAT WASHER M10x21x1.6mm	10
4	SET SCREW M12-1.25x35	11
8	WASHER FLAT M12	12
4	HEX NUT M12x1.25 PC8	13
8	NUT M8-1.25	14
1	TANK SUPPORT BRACKET	15
1	WIRING LOOM	16
1	ACRYLIC COMPLIANCE PLATE	17
1	HITCH BOX COLLAR COVER	18
2	10mm "D" SHACKLE	19
1	50mm TOWBALL	20
1	SILENT HITCH PIN - SILVER	21



Towbar Fitting Instructions

To Suit **MERCEDES C-CLASS W205 08/14 – ON (DIESEL ONLY)**

NOTE: Does not suit AMG Styling or Hybrid model.

Part Number **QTMB411L**

Rating **1800/75 kg**

PLACE THESE INSTRUCTIONS IN THE VEHICLE'S GLOVEBOX AFTER INSTALLATION IS COMPLETED

INSTRUCTION:

1. From inside wheel well, remove 3x push Rivets and 1x Screw.
Repeat for opposite side of vehicle.
2. Under RH-side of rear bumper, remove 2x Screws and 1x push rivet securing lower bumper trim to main bumper assembly.
3. From underneath central bumper assembly, remove 2x Screws.
4. On LH side of vehicle, remove 2x Screws located underneath rear bumper securing rear bumper trim to internal Heat shield.
5. Within wheel well, pull aside well carpet to expose and remove 2x Push Rivets securing bumper trim to internal plastic framework.
Repeat for opposite side of vehicle.
6. Remove side panels from each side of inside of boot cavity.
7. Remove internal scuff plate from boot cavity by removing 2x plugs and pulling trim vertically.
Care to avoid damage is required as plugs can be difficult to remove.
8. Remove boot flooring mat by disconnecting 2 plugs located towards the forward end of the boot cavity.
9. Remove 2x plugs and 2x tie down points, one of each per side of boot cavity securing internal side wall to floor.
Tie-down point is removed by lifting off black plastic cover to expose torx Head Screw and loosening Screw.
10. Remove 2x Hooks located inside boot cavity, hooks are removed by lifting push pin and pulling out.
11. Pull internal trim to side to expose inside of vehicle chassis and securing points for tail lights.
12. Remove 3x Nuts securing tail light assembly. Remove and disconnect tail light assembly. Store tail lights in a safe place. Repeat for opposite side of vehicle.
13. Remove rear bumper trim from vehicle, peeling from wheel well working towards centre.

NOTE: Due to the nature of bumper's design, bumper is difficult to remove.

Caution is required not to damage bumper during removal, 2 person removal is recommended.

Use of trim removal tools is recommended to assist in loosening trim from clips, ensuring not to damage bumper.

Lift trim lining to assist removal if needed.

Disconnect parking sensor plug and keyless entry sensor and store bumper in safe place.



Towbar Fitting Instructions

To Suit **MERCEDES C-CLASS W205 08/14 – ON (DIESEL ONLY)**

NOTE: Does not suit AMG Styling or Hybrid model.

Part Number **QTMB411L**

Rating **1800/75 kg**

PLACE THESE INSTRUCTIONS IN THE VEHICLE'S GLOVEBOX AFTER INSTALLATION IS COMPLETED

14. Remove 2x Screws securing LH heat shield to upper heat shield.
15. Lower exhaust by removing 2x torx head Screws securing hanger to chassis rail.
16. On bluetec variants of vehicle; remove 2x Screws securing rear tank to RHS of impact beam.
17. Remove impact beam from vehicle chassis by removing 8x Nuts.
2 each side are located beside outside face of chassis rail.
4 are located inside boot cavity beside chassis rail.
18. Insert side arm assemblies into vehicle chassis, loosely securing parts to chassis using M8 and M10 Bolts supplied.
Mount to rear chassis panel, ensuring that M8 Bolts are used to mount to panel and M10 Bolts, alongside with a Spacer plate, are used to secure tab insert of part to the inside face of chassis rail.
19. On diesel variants of vehicle, install plug bracket onto RH arm insert to allow for mounting of tank hanger to sidearm assembly.
20. Mount Towbar centre to sidearm rail inserts, aligning holes on Towbar arms with those of the rail inserts.
Use M12 Bolts complete with supplied washers and nuts to loosely secure Towbar to arms.
Torque all bolts to recommended torques listed on page 1.
21. Where hands-free boot access is fitted, remove sections at the bottom of the bumper trim to allow for clearance of Towbar dropper plates.

CAUTION: Electric cabling is located where sections are needed to be cut, ensure the cable is dislodged around the section before attempting any cut.

If installed, remove vehicle infill panel from internal bumper assembly by drilling out 4x rivets and discard panel.

Reinstall bumper following steps 1 to 15 in reverse.

Ensure Towball mount is removed when not in use.



Wiring Loom Fitting Instructions
To Suit Mercedes C Class Sedan Diesel (MY14 Onwards)
Part Number 100515-WL

Wiring Loom Installation Instructions

MERCEDES C CLASS SEDAN DIESEL (MY14 Onwards)
Part No: 100515-WL

Tail Length Required: 1200mm

ECU Required: 04826

Wiring Loom Installation Time: Approx 30 Mins

Note: Factory RPA cannot be overridden, however it can be disabled through a switch on the vehicle dash.

Wiring Loom Fitting Instructions To Suit Mercedes C Class Sedan Diesel (MY14 Onwards) Part Number 100515-WL

1. In the luggage compartment, remove the floor cover carpet.
2. Remove the rear trim by first removing the clips.
3. Remove RHS panel hook by removing retaining clip.
4. Remove cargo holder by removing cover and bolt.
5. Repeat on LHS.
6. Remove floor trim cover.
7. On the rear RHS of the exterior of the vehicle. Find and drill out the existing grommet hole to Ø30mm. Check for obstructions before drilling.
Note: If occupied, drill a Ø30mm hole next to the plastic cover.
8. File any rough or sharp edges and spray with rust inhibitor.
9. Modify the harness (100515-WL) by separating the Earth (white) and 12V (orange) wire.

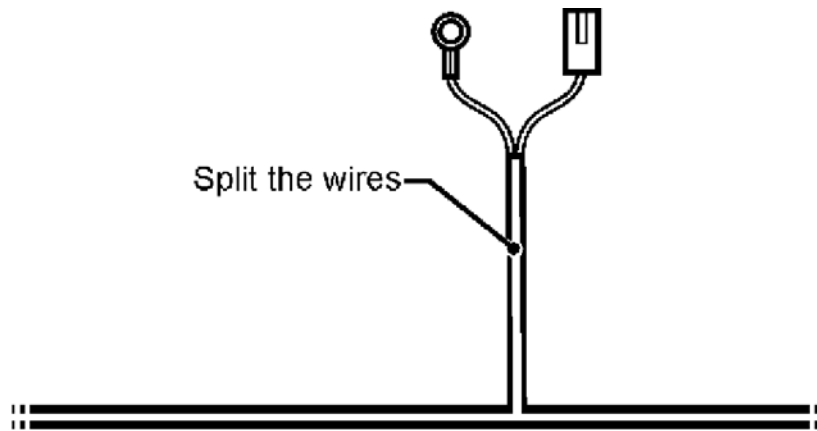

Wiring Loom Fitting Instructions To Suit Mercedes C Class Sedan Diesel (MY14 Onwards) Part Number 100515-WL

10. In the upper RHS of the luggage compartment, locate the tail light wiring harness (1).
11. Following the table below, connect the ezy-taps (2) to the vehicle tail light wires (3) then connect the trailer harness wire terminals (4) to the ezy taps (2).

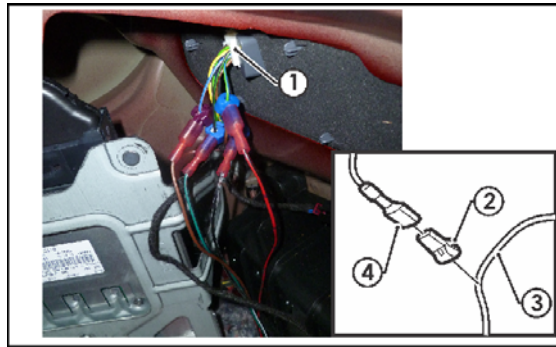

Function	Trailer Patch	Vehicle Connector
L.IND	GREEN/BLACK	BLACK/GREEN
BRAKES	RED/BLACK	GREEN/BLUE
TAILS	BROWN/BLACK	GREY/BLUE
REVERSE	BLACK/WHITE	BLACK/BLUE

12. Route the trailer patch harness (1) across to the LHS tail light.
13. In the upper LHS of the luggage compartment, locate the tail light wiring harness (1).
14. Following the table below, connect the ezy-taps (2) to the vehicle tail light wires (3) then connect the trailer harness wire terminals (4) to the ezy taps (2).

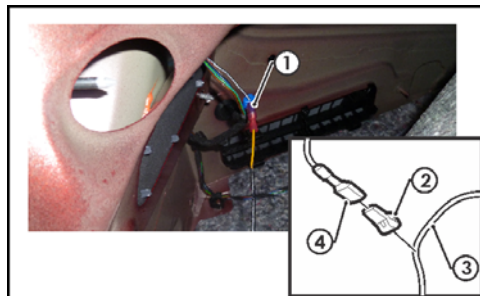

Function	Trailer Patch	Vehicle Connector
L.IND	YELLOW/BLACK	BLACK/WHITE

Wiring Loom Fitting Instructions To Suit Mercedes C Class Sedan Diesel (MY14 Onwards) Part Number 100515-WL

15. Secure the ECU (1) to the bracket (2) using double sided adhesive tape supplied. Ensure the ECU is mounted to the vehicle with the connector pointing downwards.
16. Connect the trailer patch ECU connector (3) to the ECU (1).
17. Secure the trailer patch ground ring terminal (5) to vehicle grounding point.

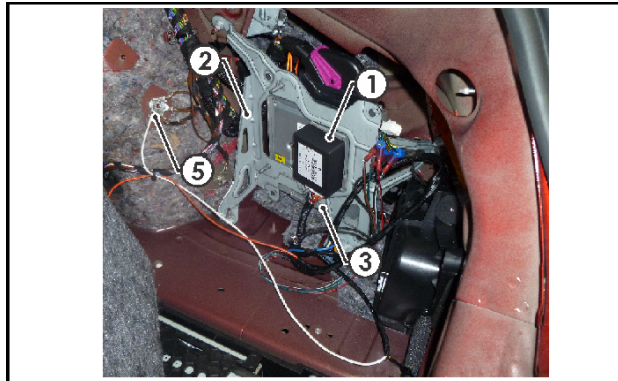

18. Locate the vacant fuse slot (1).
19. Insert the supplied 20 Amp fuse (2) into the upper slot of the add-a-fuse harness (3).
20. Plug the add-a-fuse harness (3) into the vacant fuse slot (1) on the fuse panel in the orientation shown.
21. Connect the 'ORANGE' power wire 1-way connector (4) into the add-a-fuse harness (3) mating connector.

Note: If the fuse location is occupied, first remove the vehicle fuse and insert it in the lower slot of the add-a-fuse harness (3).

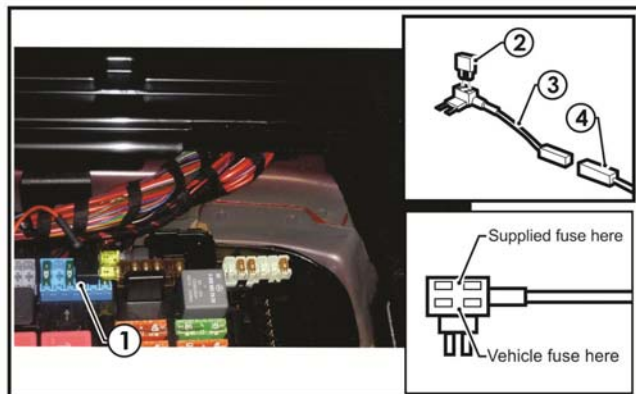



Wiring Loom Fitting Instructions
To Suit Mercedes C Class Sedan Diesel (MY14 Onwards)
Part Number 100515-WL

23. Mount the trailer socket to the towbar mounting bracket using M4 fasteners (not supplied).
24. Route the tail harness across the towbar towards the RHS of the vehicle and up through the previously drilled out hole.
25. Ensure the tail harness grommet is seated correctly and secure in place using a cable tie (not supplied).
26. Connect the tail harness (tail length 1200mm) 8-way connector to the trailer harness mating 8-way connector.
27. Refit tail lights.
28. Test the trailer harness function using a light board or multimeter.
29. Secure all harnesses using cables ties (not supplied).
30. Re-fit all removed parts and secure all fasteners, ensuring there are no squeaks or rattles.
31. Place instructions in glove box after fitment



FITTING INSTRUCTIONS

Silent Anti-Rattle Hitch Pin (PR0001)

• These fitting instructions are supplied to ensure understanding of how the HITCH PIN should be fitted and used correctly.

• Once installed, we recommend **ALL** instructions are kept and placed in the vehicle glove box.

NOTE: Routine maintenance and inspection of the towbar & HITCH PIN is required. Regularly inspect for wear and check the tightness of the Hitch Pin. Follow instructions below to retighten the nut when necessary.

***Do not tow with your vehicle if the R CLIP or the HITCH PIN is loose or missing. Replacement parts are available from your Pro Series Distributor.**

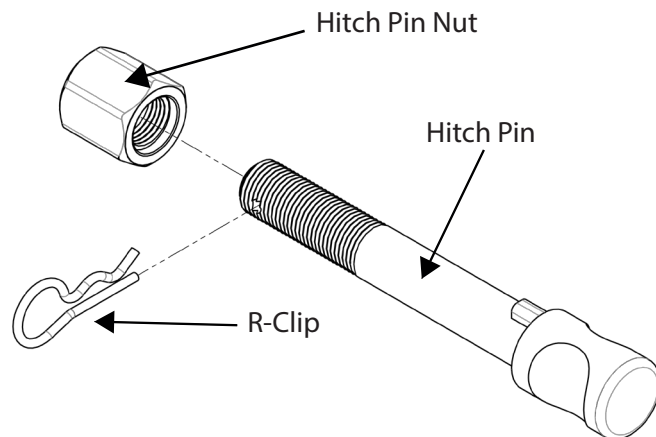

Fig 1. Silent Anti-Rattle Hitch Pin assembly

STEP 1

Insert Trailer Ball Mount (TBM) into towbar HITCHBOX, aligning hole in TBM SHANK with hole in HITCHBOX (Fig 2).

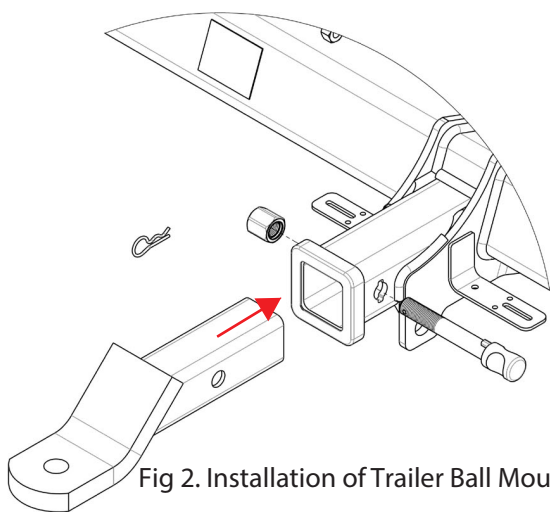

Fig 2. Installation of Trailer Ball Mount

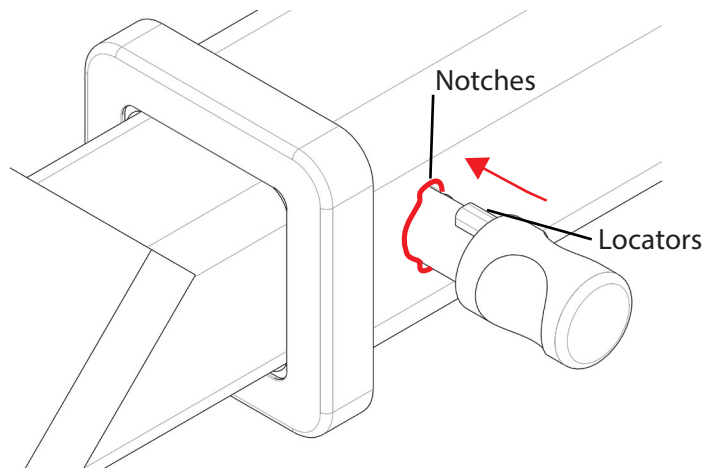

Fig 3. Silent Anti-Rattle Hitch Pin orientation

STEP 2

Insert HITCH PIN through hole in HITCHBOX and hole in TBM SHANK; ensure the LOCATORS are inserted into the NOTCHES in the HITCHBOX (Fig. 3).

STEP 3

Screw HITCH PIN NUT onto HITCH PIN ; tighten HITCH PIN NUT until finger tight, ensuring TBM is restrained from movement.

STEP 4

Tighten HITCH PIN NUT by turning nut a further 1/8th of a turn in the clockwise direction using a 24mm spanner (Fig. 4).

STEP 5

Install HITCH PIN R CLIP through the hole on the HITCH PIN (Fig. 1).

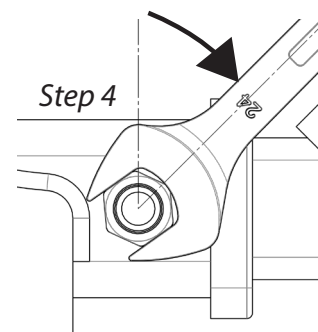

Fig 4. Tightening of Silent Anti-Rattle Hitch Pin Nut