

TRAILBOSS

Towbar Fitting Instructions
To Suit **VOLKSWAGEN PASSAT B8 SERIES**
Part Number **QTVW216L**
Rating **2200/90 kg**

PLACE THESE INSTRUCTIONS IN THE VEHICLE'S GLOVEBOX AFTER INSTALLATION IS COMPLETED

WARNING:

1. Do not, drill, cut, weld or otherwise modify the tow bar.
2. If you are using electric welding on a motor vehicle, **always** check that the vehicle is not equipped with electronic engine or instrument management equipment. Failure to do so could **destroy** any onboard computers. If in doubt, check with the vehicle's manufacturer.
3. The high tensile fasteners supplied with this product were used to achieve the specified rating. If replacement is required ensure that fasteners of the same rating & quality are used. Contact an authorised **Trailboss** dealer if further information is required.
4. If TBM is used in inverted position tow ball may make contact with rear tailgate when lowered, which could cause damage.

General:

1. Ensure all hardware items have been included refer to assembly diagram.
2. It is recommended that the instructions are read through and completely understood before making any attempt to fit this product.
3. Be wary of any changes to vehicle designs or other accessories that may conflict with the installation of this product.
4. Before drilling ensure that the area is clear of fuel, electrical & other components.
5. All holes drilled into the body panels shall have all burrs & swarf removed then coated with a suitable rust preventative paint.
6. For vehicles that require the bumper to be cut. Ensure cut out area is in correct position on the vehicle prior to cutting the bumper.
7. The high tensile fasteners supplied with this product were used to achieve the specified rating. If replacement is required ensure that fasteners of the same rating & quality are used. Contact an authorized **Trailboss** dealer if further information is required.
8. Ensure that all hardware is fastened to torque list below check fasteners on regular basis.
9. Tow bar load rating sticker provided with this product shall be conspicuously located on inside rear end of the driver's door. **(See diagram below).**
10. Trailboss recommends that you check your tow ball to ensure that it complies with the Australian standards **AS 4177.2**.
11. **PLEASE NOTE:** It is advised to remove your lug or tbm when not actually towing so as to produce a clear view of the vehicles registration plate if obscured, and to also provide maximum available departure angle
12. Pull Pin must be fit in down position.

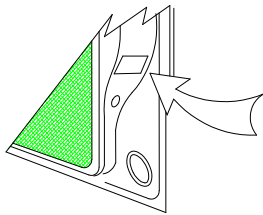

Place load rating sticker
inside driver's door here

FOR TRAILER TOWING PURPOSES ONLY
For towing capacity details please refer to vehicle owner's manual or to the manufacturer. Overloading can void your warranties.

RECOMMENDED ASSEMBLY TORQUE LISTING

Diameter	Grade 8.8 Bolt
M6	9.5 Nm
M8	21.7 Nm
M10	43.4 Nm
M12	77.3Nm
M14	146 Nm
M16	189.8 Nm

Tow bar Maintenance and Care.

Trailboss recommends that bolt torque's, as listed below, are routinely and regularly inspected and checked for correct tension. Replace any worn or defective parts.

We recommended to remove Tow Ball Mounts (TBM's, tongues or lugs) when not being used for any considerable length of time.

So as to avoid injury, when not towing it is suggested that the tongue, Pull Pin and R-clip are removed then stored in a safe, clean and dry place, away from excessive moisture.

Hitch Pull Pins and spring "R" clips are regularly checked for proper installation. Replace any worn or defective parts.

TRAILBOSS

Towbar Fitting Instructions
 To Suit **VOLKSWAGEN PASSAT B8 SERIES**
 Part Number **QTVW216L**
 Rating **2200/90 kg**

PLACE THESE INSTRUCTIONS IN THE VEHICLE'S GLOVEBOX AFTER INSTALLATION IS COMPLETED

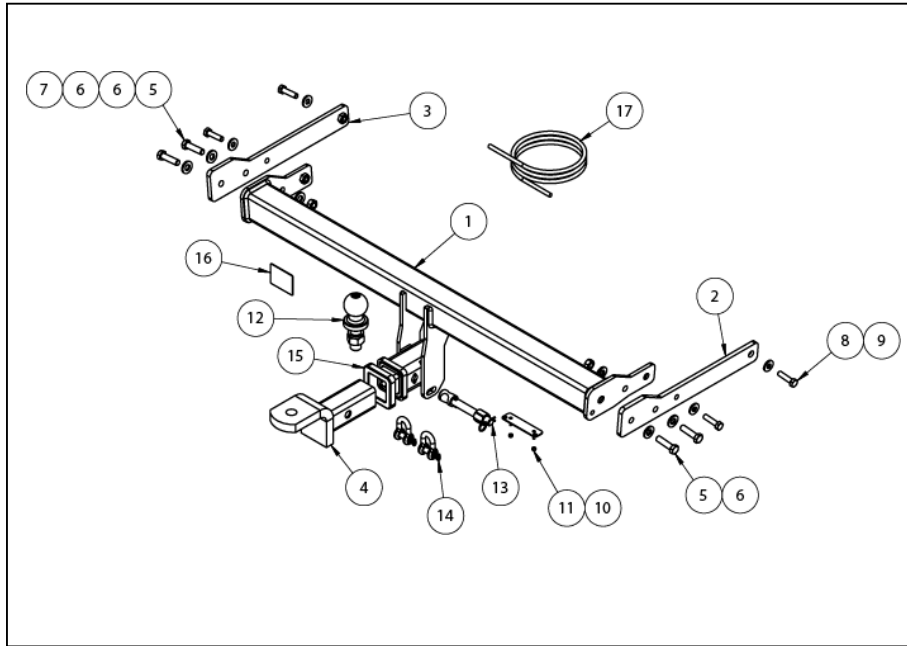

QTY.	DESCRIPTION	ITEM NO.
1	VW PASSAT B8 WELDED ASSY	1
1	SIDEARM ASSEMBLY - RHS	2
1	SIDEARM ASSEMBLY - LHS	3
1	TRAILER BALL MOUNT	4
4	SET SCREW M12x45x1.25P G10.9	5
6	WASHER FLAT 1/2"x1 1/8"x1/8"	6
2	M12x1.25 HEX NUT PC8	7
4	BOLT M10x1.25x40 GR10.9	8
4	WSHR FT M10x25.4x3	9
1	PLUG BRACKET	10
2	NUT NYLOC M4-0.7 Z/P	11
1	TOWBALL 50MM	12
1	SILENT HITCH PIN - SILVER	13
2	"D" SHACKLE 10MM	14
1	HITCH BOX COLLAR COVER	15
1	ACRYLIC COMPLIANCE PLATE	16
1	WIRING LOOM	17

TRAILBOSS

Towbar Fitting Instructions
To Suit **VOLKSWAGEN PASSAT B8 SERIES**
Part Number **QTVW216L**
Rating **2200/90 kg**

PLACE THESE INSTRUCTIONS IN THE VEHICLE'S GLOVEBOX AFTER INSTALLATION IS COMPLETED

1. Remove spring loaded screw securing tail light assembly. Remove and disconnect tail light assembly.

Repeat for opposite side of vehicle.

2. Remove 3 x Screws from within rear wheel arch.

Repeat for opposite side of vehicle.



3. Remove 1 x Screw securing top of bumper for vehicle within rear wheel arch.

Repeat for opposite side of vehicle.



TRAILBOSS

Towbar Fitting Instructions
To Suit **VOLKSWAGEN PASSAT B8 SERIES**
Part Number **QTVW216L**
Rating **2200/90 kg**

PLACE THESE INSTRUCTIONS IN THE VEHICLE'S GLOVEBOX AFTER INSTALLATION IS COMPLETED

4. Remove 4 x Screws and 1 x Scrivet from underside of rear bumper, behind right rear wheel arch.



5. Remove 1 x Screw and 1 x Scrivet from underside of rear bumper, behind left rear wheel arch.



6. Remove 3 x Screws and 3 x Scrivets from rear underside of rear bumper.
7. Unclip and remove rear bumper; disconnect parking sensor loom as required.



TRAILBOSS

Towbar Fitting Instructions
To Suit **VOLKSWAGEN PASSAT B8 SERIES**
Part Number **QTVW216L**
Rating **2200/90 kg**

PLACE THESE INSTRUCTIONS IN THE VEHICLE'S GLOVEBOX AFTER INSTALLATION IS COMPLETED

8. Remove and discard 8 x Hex head Bolts from rear impact beam (4 per side); remove and discard rear impact beam.



9. Remove Hex head Bolt from exhaust mount rear of the muffler.

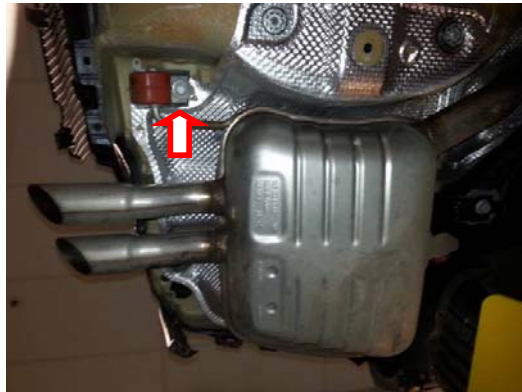

10. Remove hex head Bolt from exhaust mount on forward side of muffler.

Gently lower rear section of exhaust.

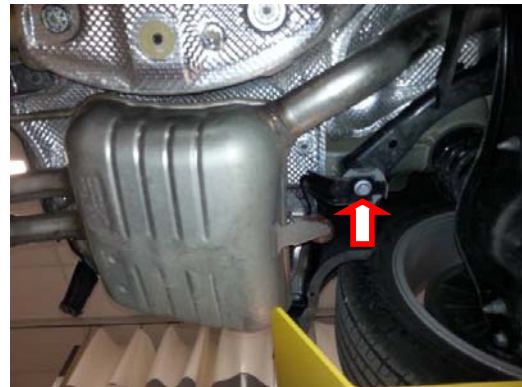

TRAILBOSS

Towbar Fitting Instructions
To Suit **VOLKSWAGEN PASSAT B8 SERIES**
Part Number **QTVW216L**
Rating **2200/90 kg**

PLACE THESE INSTRUCTIONS IN THE VEHICLE'S GLOVEBOX AFTER INSTALLATION IS COMPLETED

11. Slide sidearm assembly into chassis rail; loosely secure sidearm assembly to outboard side of chassis rail using 1 x M10 Bolt, complete with 1 x M10 Flat Washer.

Repeat for opposite side of vehicle.



12. Loosely secure Towbar welded assembly to sidearm assemblies using 1 x M10 Bolt per side, complete with 1 x Flat Washer per Bolt.

Loosely secure towbar welded assembly to sidearm assemblies using 2 x M12 Hex head Screws per side, complete with 1 x Flat Washer per Screw.

Secure 2 forward M12 Hex head Screws using 1 x flat Washer and 1 x M12 Nut per Screw.

13. Tighten all fasteners to torques listed below:

M10 Bolts: 68 N.m
M12 Screws: 125 N.m



14. Identify centreline of bumper, using the vanes on the underside as a guide.

Create bumper cut 75mm tall x 90mm wide in the location shown.

IMPORTANT: Prior to creating cut, mark proposed cut and check against vehicle as validation.

Note that additional cut may be required to provide ease of fitment.



Towbar Fitting Instructions
To Suit **VOLKSWAGEN PASSAT B8 SERIES**
Part Number **QTVW216L**
Rating **2200/90 kg**

PLACE THESE INSTRUCTIONS IN THE VEHICLE'S GLOVEBOX AFTER INSTALLATION IS COMPLETED

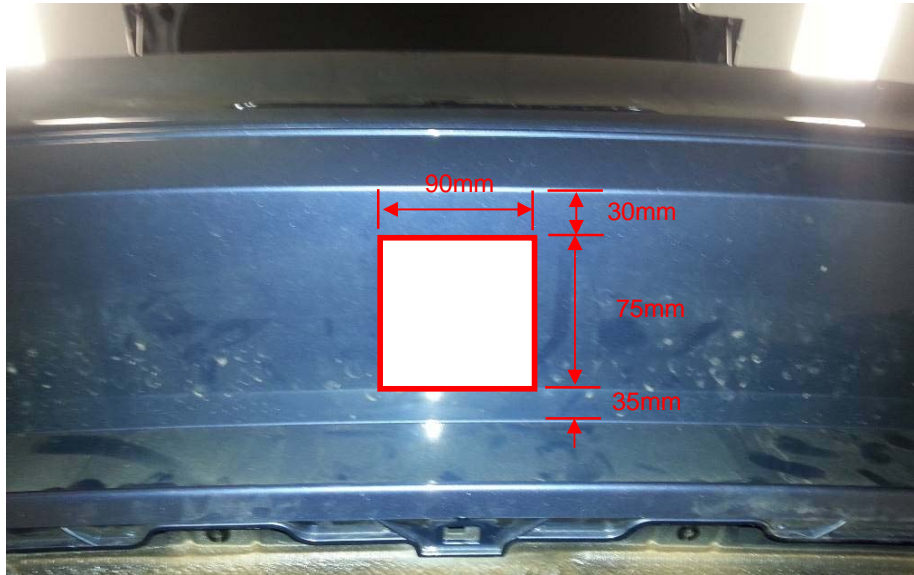

15. Mark out and drill 2x $\varnothing 5\text{mm}$ holes 69mm apart on bumper skin to support plug bracket. Feed bracket threads through drilled holes prior to reinstalling bumper.

16. Reinstall bumper following steps 1 to 10 in reverse order.

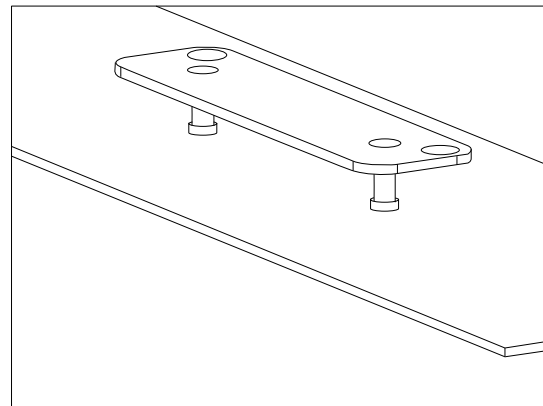



Wiring Loom Fitting Instructions
To Suit Volkswagen Passat B8
Sedan and Wagon
Part Number 101472-WL (QTVW216L)

Wiring Loom Installation Instructions

Volkswagen Passat B8
Sedan and Wagon

Part No: 101472-WL
ECU Required: 04836

Tail Harness Length Required: 1200mm

Wiring Loom Installation Time: Approx 45 Mins

TRAILBOSS

Wiring Loom Fitting Instructions To Suit Volkswagen Passat B8 Sedan and Wagon Part Number 101472-WL (QTVW216L)

All Steps are suitable for both variants:

1. Remove the rear sun shade (1) (if applicable).
2. Remove the cargo barrier attachment (2) (if applicable).

Step 3 to 6 for Wagon models only:

3. Remove the interior LHS rear quarter lower trim.
4. Lift up the floor cover and remove the two small plastic stoppers from the LHS and RHS floor cover guide rail trim.
5. Remove the floor cover.
6. Fold down the rear row seats.
7. Remove the luggage compartment rear centre trim.

Steps 8 to 10 for Wagon models only:

8. Remove the luggage compartment rear upper centre trim.
9. Remove the LHS upper 'D' pillar trim.
10. Remove the nine fasteners from the LHS luggage compartment trim and then dislodge enough of the trim to gain access to the LHS tail light connectors. **Repeat Steps 8 to 10 for the RHS trims.**

For Sedan models:

11. Remove the lower side plastic trim and the boot hinge surround trim to gain access to the rear quarter interior. **Repeat for the RHS trim.**
12. Locate and remove the rear LHS grommet (1) and drill or cut out a Ø30mm hole.

Wagon models: Go Step 13.

Sedan models: Go to Step 15.



Wiring Loom Fitting Instructions
To Suit Volkswagen Passat B8
Sedan and Wagon
Part Number 101472-WL (QTVW216L)

13. In the interior LHS rear quarter, unclip the vehicle harness from the body. Following the table below, locate REVERSE from the main vehicle harness (1) and then connect the trailer patch (P/No: 101472-WL) terminal (2) to the ezy-tap (3). **Note: REVERSE and TAILS are both WHITE and must be located with a multi-meter.** Locate the remaining signals from the vehicle harness tail light branch of wires (4) and then connect the trailer patch terminals (2) to the ezy-taps (3).

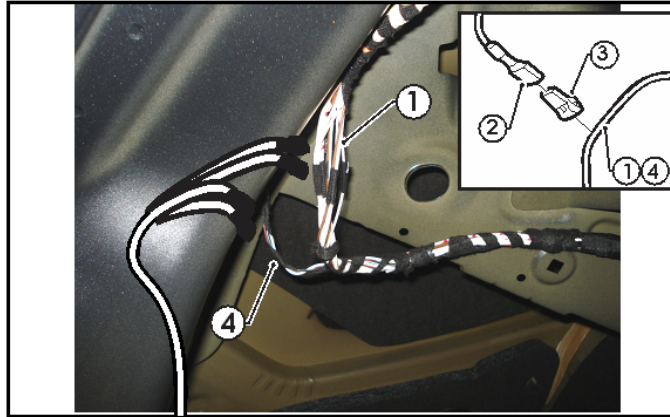

Function	Trailer Patch	Vehicle Harness
L.IND	YELLOW / BLACK	BLACK / WHITE
REVERSE	BLACK / WHITE	USE MULTI-METER
TAIL	BROWN / BLACK	USE MULTI-METER
BRAKES	RED / BLACK	BLACK / RED

14. Connect the trailer patch connector (1) to the ECU (2). Remove the backing from the back of the ECU (2) and mount the ECU (2) onto the outer side of the inner sheet metal skin (3). **Ensure the ECU is mounted with the connector pointing downwards.**
Go to Step 17.

Wiring Loom Fitting Instructions
To Suit Volkswagen Passat B8
Sedan and Wagon
Part Number 101472-WL (QTVW216L)

Steps 15 and 16 for Sedans only:

15. In the interior LHS rear quarter, unclip the vehicle harness from the body. Following the table below, locate the signals from the main vehicle harnesses (1) and then connect the trailer patch (P/No: 101472-WL) terminals (2) to the ezy-taps (3).

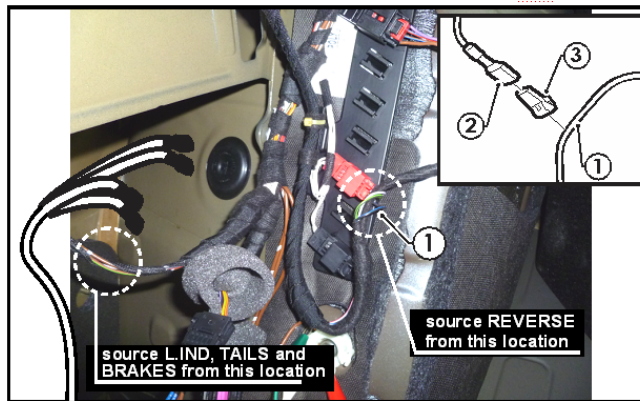

Function	Trailer Patch	Vehicle Harness
L.IND	YELLOW / BLACK	BLACK / WHITE
REVERSE	BLACK / WHITE	BLACK / BLUE
TAIL	BROWN / BLACK	BROWN / GREEN
BRAKES	RED / BLACK	BLACK / RED

16. Connect the trailer patch connector to the ECU . Remove the backing from the back of the ECU and mount the ECU onto the wheel arch sheet metal skin. **Ensure ECU is mounted with the connector pointing downwards.**

17. Locate the trailer patch power ORANGE wire and strip the insulation off the terminal and house the terminal into the vehicle harness break out connector RED / WHITE wire. **Seal the connection appropriately after.**

18. Secure the trailer patch ground ring terminal onto the vehicle grounding point.

19. Route the trailer patch RHS wire across the rear interior of the vehicle towards the RHS tail light harness.

Wiring Loom Fitting Instructions
To Suit Volkswagen Passat B8
Sedan and Wagon
Part Number 101472-WL (QTVW216L)

20. In the interior RHS rear quarter, unclip the vehicle harness from the body. Following the table below, secure the ezy-tap (1) to the R. IND signal from the vehicle harness tail light branch of wires (2) and then connect the trailer patch terminal (3) to the ezy tap.

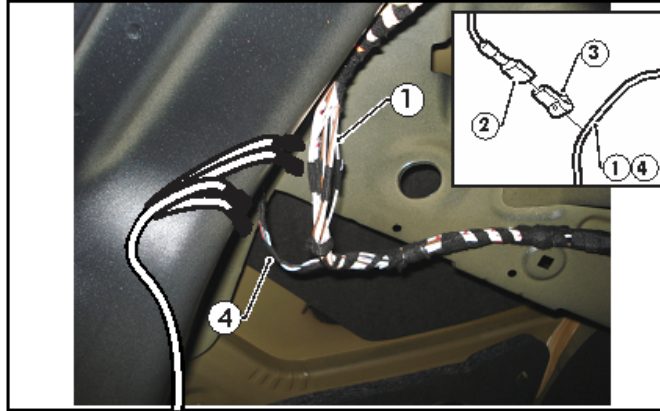

Function	Trailer Patch	Vehicle Harness
R.IND	GREEN / BLACK	BLACK / GREEN

21. Mount the trailer socket to the towbar mounting bracket using M4 fasteners (not supplied).
22. Route the tail harness across the towbar towards the LHS of the vehicle and up through the previously drilled out grommet.
23. Ensure the tail harness grommet is seated correctly and secure in place using a cable tie (not supplied). **Seal the grommet appropriately and refit after routing.**
24. Connect the tail harness (tail length 1200mm) 8-way connector to the trailer patch mating 8-way connector.
25. Refit the tail light assemblies.
26. Test the trailer patch function using a light board or multi meter.
27. Secure all harnesses using cable ties (not supplied).
28. Re-fit all removed parts and secure all fasteners, ensuring there are no squeaks or rattles.
29. Place the fitting instructions in the glove box after fitment.
30. The RPA can be disabled via a switch on the dash.



FITTING INSTRUCTIONS

Silent Anti-Rattle Hitch Pin (PR0001)

• These fitting instructions are supplied to ensure understanding of how the HITCH PIN should be fitted and used correctly.

• Once installed, we recommend **ALL** instructions are kept and placed in the vehicle glove box.

NOTE: Routine maintenance and inspection of the towbar & HITCH PIN is required. Regularly inspect for wear and check the tightness of the Hitch Pin. Follow instructions below to retighten the nut when necessary.

***Do not tow with your vehicle if the R CLIP or the HITCH PIN is loose or missing. Replacement parts are available from your Pro Series Distributor.**

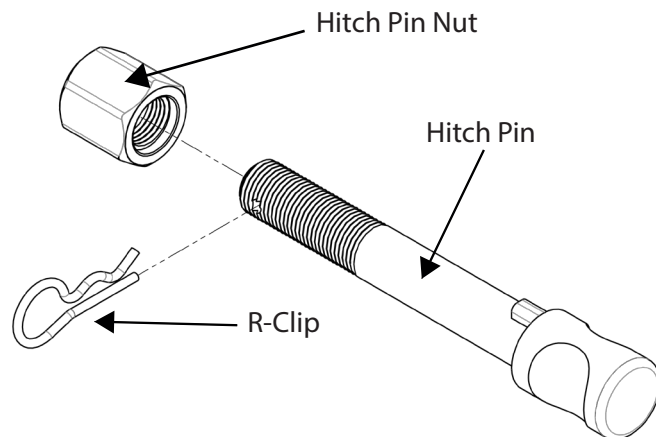

Fig 1. Silent Anti-Rattle Hitch Pin assembly

STEP 1

Insert Trailer Ball Mount (TBM) into towbar HITCHBOX, aligning hole in TBM SHANK with hole in HITCHBOX (Fig 2).

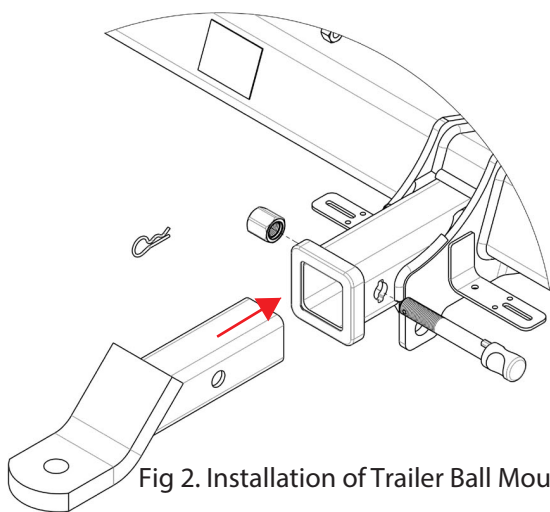

Fig 2. Installation of Trailer Ball Mount

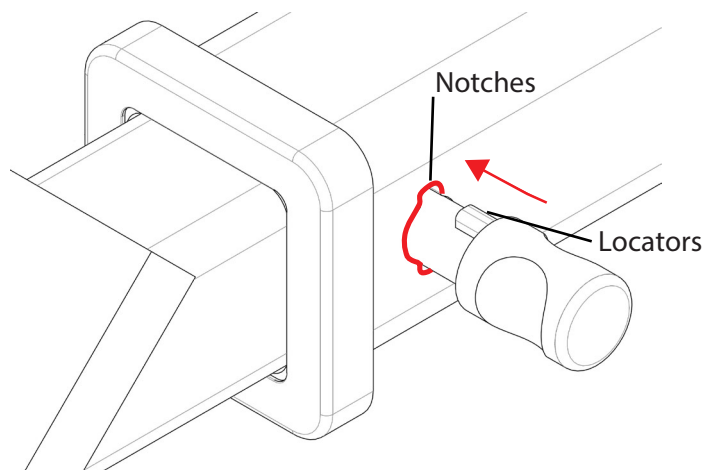

Fig 3. Silent Anti-Rattle Hitch Pin orientation

STEP 2

Insert HITCH PIN through hole in HITCHBOX and hole in TBM SHANK; ensure the LOCATORS are inserted into the NOTCHES in the HITCHBOX (Fig. 3).

STEP 3

Screw HITCH PIN NUT onto HITCH PIN ; tighten HITCH PIN NUT until finger tight, ensuring TBM is restrained from movement.

STEP 4

Tighten HITCH PIN NUT by turning nut a further 1/8th of a turn in the clockwise direction using a 24mm spanner (Fig. 4).

STEP 5

Install HITCH PIN R CLIP through the hole on the HITCH PIN (Fig. 1).

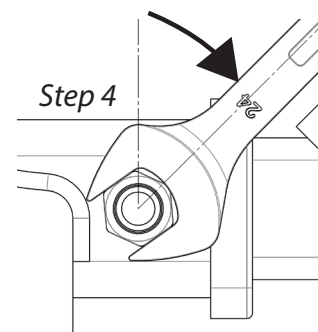

Fig 4. Tightening of Silent Anti-Rattle Hitch Pin Nut