

TRAILBOSS

Towbar Fitting Instructions To Suit TOYOTA COROLLA 12/01-on Part Number TT132L Rating 950Kg

1. Ensure all hardware items have been included
2. Remove spare wheel.
3. Remove rear most rubber grommet from spare wheel well.
4. Remove tow hook from passenger side sub frame.
5. Lift towbar into position to align with tow hook tapped holes.
6. Fit 4 M12 x 30 bolts supplied.
7. Fit M10 coach bolt, round loose plate, spring washer and nut to tail as per diagram.
8. Tighten all bolts to torque listing below.
9. Refit spare wheel.

RECOMMENDED ASSEMBLY TORQUE LISTING

<u>Diameter</u>	<u>Grade 8.8 Bolt</u>
	Nm
M6	9.5
M8	21.7
M10	43.4
M12	77.3
M14	121.0
M16	189.8

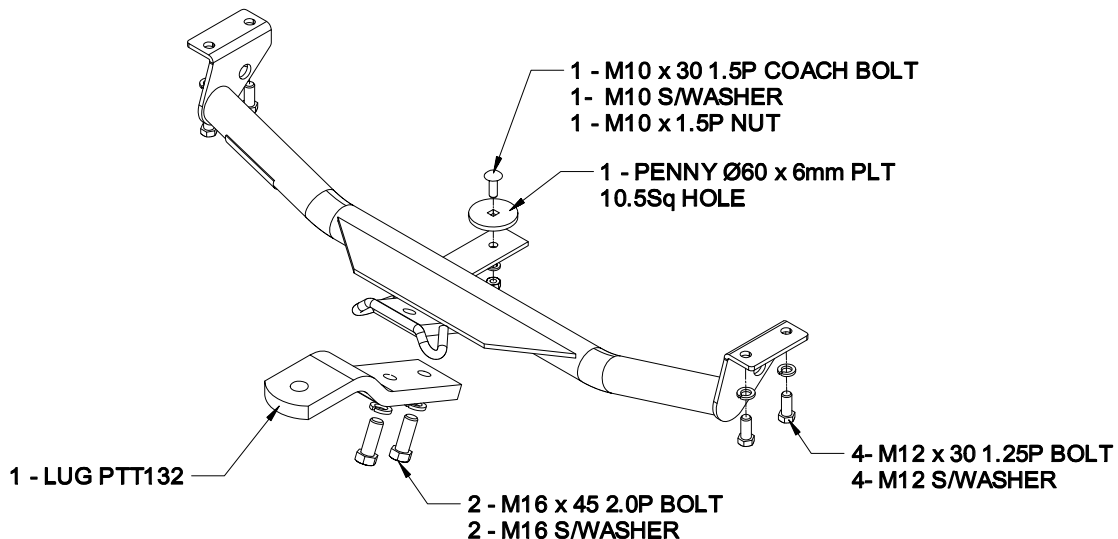



Towbar Fitting Instructions
To Suit TOYOTA COROLLA 12/01-on
Part Number TT132L
Rating 950Kg

Wiring Loom Installation Instructions

TOYOTA COROLLA
Part No: 100483-WL
ECU: 04826

Tail Harness Length Required: 1200mm
RPA Override Switch Part No: 04848 (If Fitted)

Wiring Loom Installation Time: Approx 30 Mins

1. In the luggage compartment, remove the parcel shelf (1).
2. Remove the floor cover carpet (2).



Towbar Fitting Instructions
To Suit TOYOTA COROLLA 12/01-on
Part Number TT132L
Rating 950Kg

3. Remove the two tool storage trays (1) by first removing the four fasteners (2).



4. Remove the rear trim (1), by first removing the two clips (2).

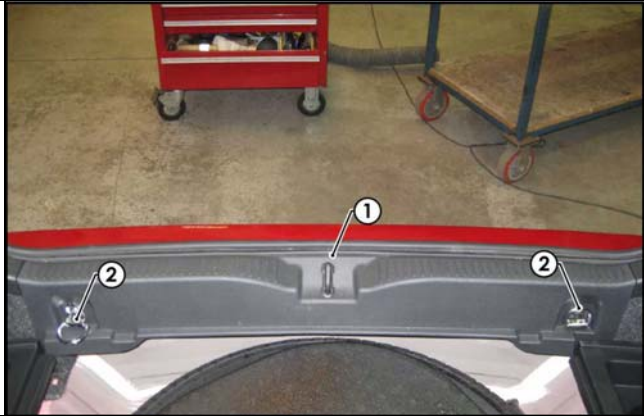

5. Remove the RHS & LHS tail light access panel covers (1).



Towbar Fitting Instructions
To Suit TOYOTA COROLLA 12/01-on
Part Number TT132L
Rating 950Kg

6. Remove the LHS rear scuff plate (1).
7. Remove the LHS front scuff plate and kick panel.



8. From outside the vehicle, remove the LHS rear grommet (1) located behind the LHS rear wheel.
9. Drill out the grommet hole to $\text{\O}31\text{mm}$. File any rough or sharp edges and spray on rust inhibitor.



10. On the LHS of the luggage compartment, untape the rear junction connector (1) that is closest to the front of the vehicle.
11. Disconnect the rear junction connector (1) from its splice connector (2).
12. Patch the trailer harness (P/No: 100483-WL) connectors (3) in between the rear junction connector (1) and the splice connector (2).

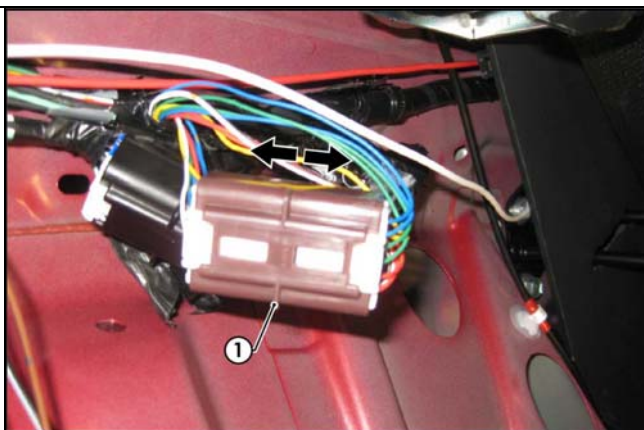

Towbar Fitting Instructions
 To Suit TOYOTA COROLLA 12/01-on
 Part Number TT132L
 Rating 950Kg

13. Route the trailer harness (1) from the LHS across the rear of the luggage compartment towards the RHS of the vehicle.



14. Locate the RHS tail light wiring loom (1).
 15. Carefully splice open the wiring loom (1) and locate the right indicator 'LIGHT BLUE' wire (2).
 16. Following the table below, connect the supplied ezy tap (3) to the vehicle harness wire (2) then connect the trailer harness terminal (5) to the corresponding wire (2).

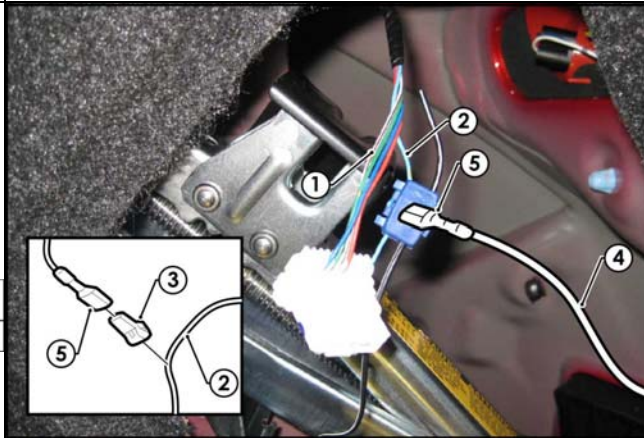

Function	Trailer Patch	Vehicle Connector
R.IND	GREEN / BLACK	LIGHT BLUE

17. Route the orange power wire (1) from the rear of the vehicle, along the LHS towards the front of the vehicle.



TRAILBOSS

Towbar Fitting Instructions To Suit TOYOTA COROLLA 12/01-on Part Number TT132L Rating 950Kg

18. Under the LHS dash, locate and remove the fuse panel cover.
19. Place in vehicle glove compartment for safe keeping.
20. Insert the supplied 20-amp fuse (1) into the upper slot of the add-a-fuse harness (2).
21. Plug the add-a-fuse harness (2) into an available fuse slot on the fuse panel.
22. Connect the orange power wire 1-way connector (3) into the add-a-fuse harness (2) mating connector

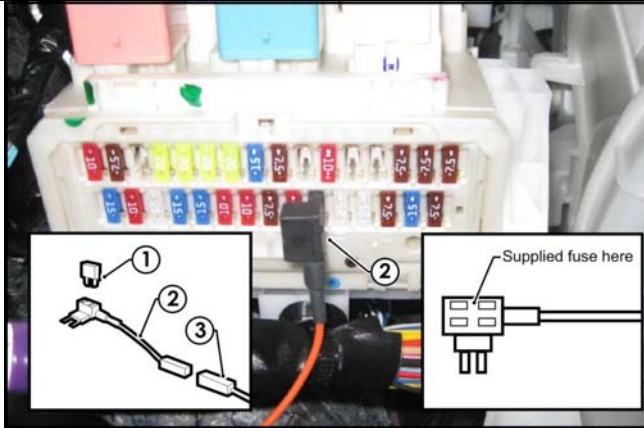

23. In the luggage compartment, connect the trailer harness ground ring terminal (1) to the existing vehicle bolt (2).

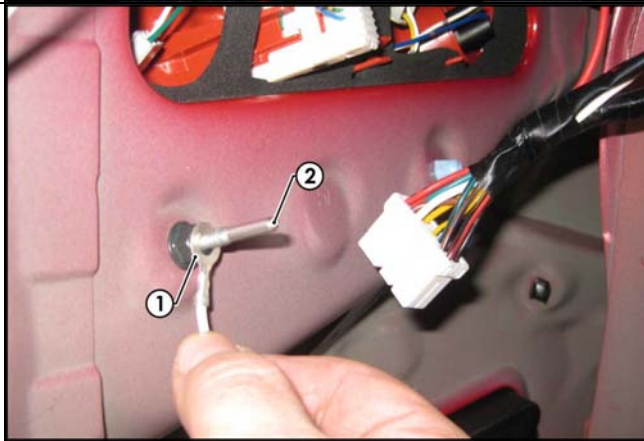

24. Connect the trailer harness 12-way connector (1) to the ECU (04826) (2).

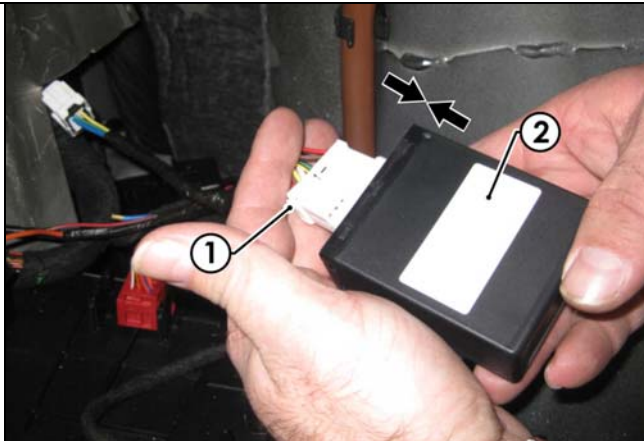

Towbar Fitting Instructions
To Suit TOYOTA COROLLA 12/01-on
Part Number TT132L
Rating 950Kg

25. Apply double sided tape to the ECU and adhere it to the vehicle sheet metal on the LHS just below the LHS tail light area (1).

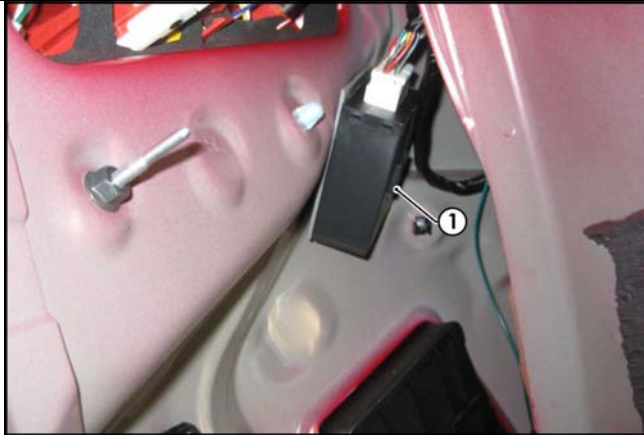

26. Mount the trailer socket to the towbar mounting bracket using M4 fasteners (not supplied).
27. Route the tail harness across the towbar towards the LHS of the vehicle and up through the previously drilled out hole.
28. Ensure the tail harness grommet is seated correctly and secure in place using a cable tie (not supplied).
29. Connect the tail harness (tail length 1200mm) 8-way connector (1) to the trailer harness mating 8-way connector (2).

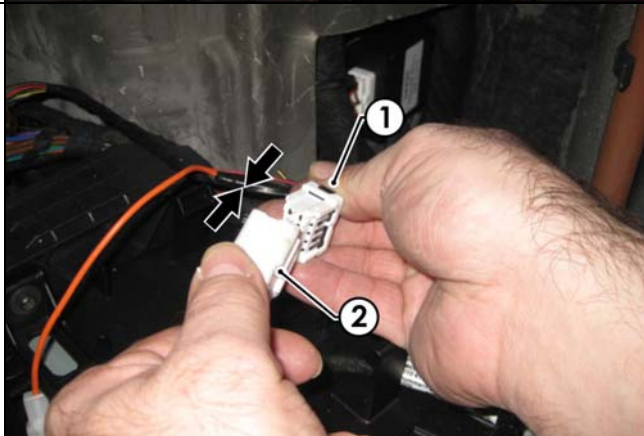

30. Test the trailer harness function using a Light Board or multimeter.
31. Secure all harnesses using cables ties (not supplied).
32. Re-fit all removed parts and secure all fasteners, ensuring there are no squeaks or rattles.
33. Place instructions in glove box after fitment.