

# TRAILBOSS

Towbar Fitting Instructions  
To Suit **TOYOTA COROLLA SEDAN 07/14 – ON**  
Part Number **TT162L**  
Rating **1300/130** kg

PLACE THESE INSTRUCTIONS IN THE VEHICLE'S GLOVEBOX AFTER INSTALLATION IS COMPLETED

## **WARNING:**

1. Do not, drill, cut, weld or otherwise modify the tow bar.
2. If you are using electric welding on a motor vehicle, **always** check that the vehicle is not equipped with electronic engine or instrument management equipment. Failure to do so could **destroy** any onboard computers. If in doubt, check with the vehicle's manufacturer.
3. The high tensile fasteners supplied with this product were used to achieve the specified rating. If replacement is required ensure that fasteners of the same rating & quality are used. Contact an authorised **Trailboss** dealer if further information is required.
4. If TBM is used in inverted position tow ball may make contact with rear tailgate when lowered, which could cause damage.

## **General:**

1. Ensure all hardware items have been included refer to assembly diagram.
2. It is recommended that the instructions are read through and completely understood before making any attempt to fit this product.
3. Be wary of any changes to vehicle designs or other accessories that may conflict with the installation of this product.
4. Before drilling ensure that the area is clear of fuel, electrical & other components.
5. All holes drilled into the body panels shall have all burrs & swarf removed then coated with a suitable rust preventative paint.
6. For vehicles that require the bumper to be cut. Ensure cut out area is in correct position on the vehicle prior to cutting the bumper.
7. The high tensile fasteners supplied with this product were used to achieve the specified rating. If replacement is required ensure that fasteners of the same rating & quality are used. Contact an authorized **Trailboss** dealer if further information is required.
8. Ensure that all hardware is fastened to torque list below check fasteners on regular basis.
9. Tow bar load rating sticker provided with this product shall be conspicuously located on inside rear end of the driver's door. **(See diagram below).**
10. Trailboss recommends that you check your tow ball to ensure that it complies with the Australian standards **AS 4177.2**.
11. **PLEASE NOTE:** It is advised to remove your lug or tbm when not actually towing so as to produce a clear view of the vehicles registration plate if obscured, and to also provide maximum available departure angle
12. Pull Pin must be fit in down position.

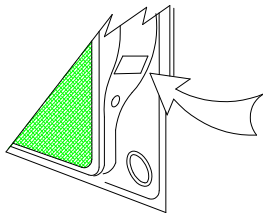

Place load rating sticker  
inside driver's door here

**FOR TRAILER TOWING PURPOSES ONLY**  
For towing capacity details please refer to vehicle owner's manual or to the manufacturer. Overloading can void your warranties.

### **RECOMMENDED ASSEMBLY TORQUE LISTING**

Diameter	Grade 8.8 Bolt
M6	9.5 Nm
M8	21.7 Nm
M10	43.4 Nm
M12	77.3Nm
M14	146 Nm
M16	189.8 Nm

## **Tow bar Maintenance and Care.**

Trailboss recommends that bolt torque's, as listed below, are routinely and regularly inspected and checked for correct tension. Replace any worn or defective parts.

We recommended to remove Tow Ball Mounts (TBM's, tongues or lugs) when not being used for any considerable length of time.

So as to avoid injury, when not towing it is suggested that the tongue, Pull Pin and R-clip are removed then stored in a safe, clean and dry place, away from excessive moisture.

Hitch Pull Pins and spring "R" clips are regularly checked for proper installation. Replace any worn or defective parts.

# TRAILBOSS

Towbar Fitting Instructions  
 To Suit **TOYOTA COROLLA SEDAN 07/14 – ON**  
 Part Number **TT162L**  
 Rating **1300/130 kg**

PLACE THESE INSTRUCTIONS IN THE VEHICLE'S GLOVEBOX AFTER INSTALLATION IS COMPLETED

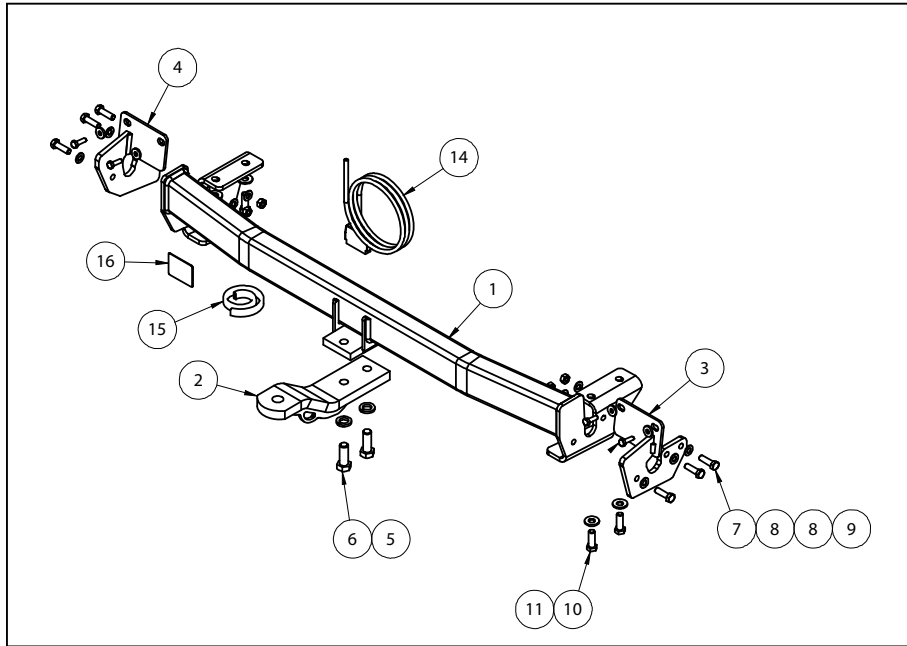

QTY.	DESCRIPTION	ITEM NO.
1	WELDED ASSY	1
1	LUG ASSY	2
1	RHS PANEL MOUNT	3
1	LHS PANEL MOUNT	4
2	SPRING WASHER M16x5x3.5	5
2	BOLT M16x45 2.0P	6
6	SET SCREW M10-1.5x35mm	7
12	FLAT WASHER M10x21x1.6mm	8
6	HEX NUT M10X1.5	9
4	SET SCREW M12-1.25x35	10
4	WASHER FLAT M12	11
4	SET SCREW M8-1.25x25mm	12
4	FLAT WASHER M8x22x3.3mm	13
1	WIRING LOOM	14
1	BUMPER TRIM PINCH WELD 300mm	15
1	ACRYLIC COMPLIANCE PLATE	16



Towbar Fitting Instructions  
To Suit **TOYOTA COROLLA SEDAN 07/14 – ON**  
Part Number **TT162L**  
Rating **1300/130 kg**

PLACE THESE INSTRUCTIONS IN THE VEHICLE'S GLOVEBOX AFTER INSTALLATION IS COMPLETED

**INSTRUCTION:**

1. If installed, remove mudguards from vehicle by removing 3xScrews securing guards to vehicle.
2. Remove 1x small push Rivet securing small plastic tab to rearwards end of the wheel well , remove 1x Screw located on inside wheel well securing bumper facia to main vehicle body.
3. Repeat steps 1 & 2 for opposite side of vehicle.
4. Remove 1x push Rivet located underneath the facia behind the rear wheel, repeat for opposite side of vehicle
5. Remove 3x push Rivets securing lower rearwards end of bumper facia to vehicle and lower chassis plastic mud-guard.
6. Remove 2x push Rivets located underneath the bumper facia which are secured to the rearwards end of the chassis body.
7. Carefully remove Bumper trim from vehicle, disconnecting any wiring Plugs during removal.
8. Remove main section of rear Intrusion Beam from vehicle body by removing 4x Bolts securing beam to beam supports.
9. Remove Intrusion beam supports from rear vehicle chassis by removing 2x Bolts from each support.
10. Remove Shipping Hook from chassis rail and discard.
11. Lower exhaust by loosening Rubber Hanger from support rod.
12. Lightly mount main section of Towbar to vehicle assembly using 4x M12 Set Screws and Washers provided.
13. Flatten tab located on the rear face of the vehicle below the chassis rail, this is to allow fitment of Towbar side-plates.
14. Mount Towbar side-plates to vehicle using Bolts provided.  
  
Torque all bolts to recommended torques listed on page 1.
15. Cut out sections in bumper to allow for fitment of Towbar.  
  
Use profiles provided to cut out relevant sections of bumper, ensure images are to scale before proceeding with cut.
16. Reassemble following steps 1 to 6 in reverse.



Towbar Fitting Instructions  
To Suit **TOYOTA COROLLA SEDAN 07/14 – ON**  
Part Number **TT162L**  
Rating **1300/130 kg**

PLACE THESE INSTRUCTIONS IN THE VEHICLE'S GLOVEBOX AFTER INSTALLATION IS COMPLETED

THIS PAGE INTENTIONALLY LEFT BLANK



Towbar Fitting Instructions  
To Suit **TOYOTA COROLLA SEDAN 07/14 – ON**  
Part Number **TT162L**  
Rating **1300/130 kg**

PLACE THESE INSTRUCTIONS IN THE VEHICLE'S GLOVEBOX AFTER INSTALLATION IS COMPLETED

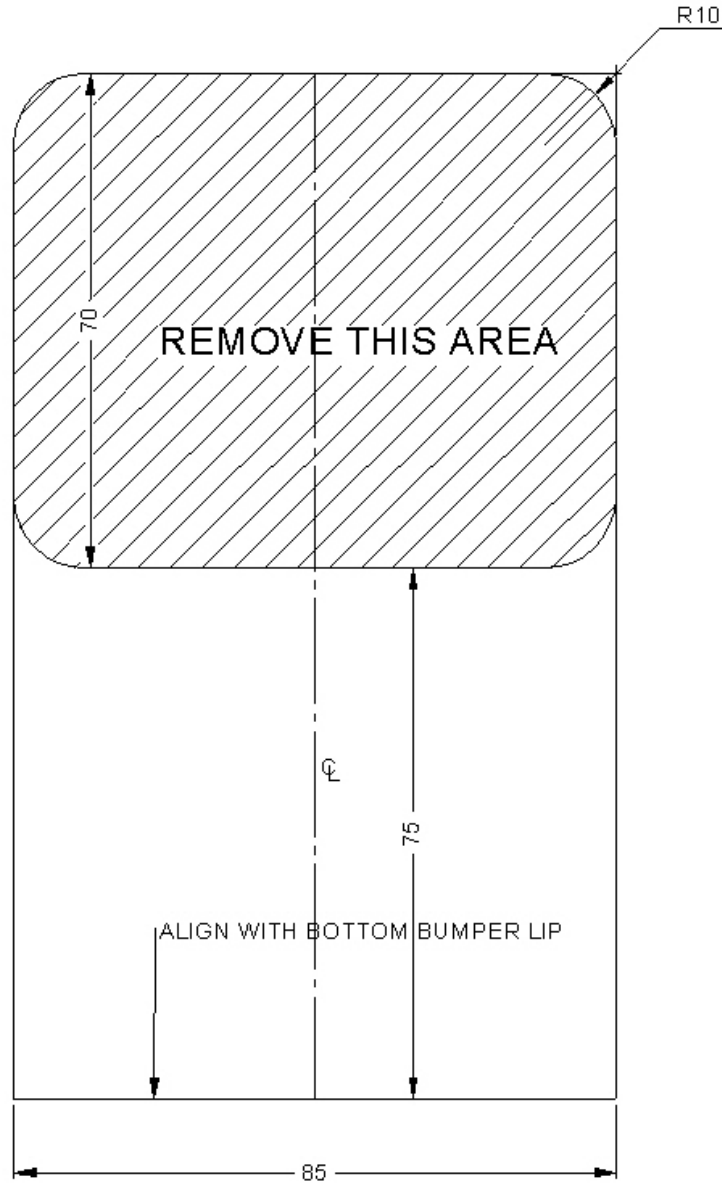



Towbar Fitting Instructions  
To Suit **TOYOTA COROLLA SEDAN 07/14 – ON**  
Part Number **TT162L**  
Rating **1300/130 kg**

PLACE THESE INSTRUCTIONS IN THE VEHICLE'S GLOVEBOX AFTER INSTALLATION IS COMPLETED

THIS PAGE INTENTIONALLY LEFT BLANK

Towbar Fitting Instructions  
To Suit **TOYOTA COROLLA SEDAN 07/14 – ON**  
Part Number **TT162L**  
Rating **1300/130 kg**

PLACE THESE INSTRUCTIONS IN THE VEHICLE'S GLOVEBOX AFTER INSTALLATION IS COMPLETED

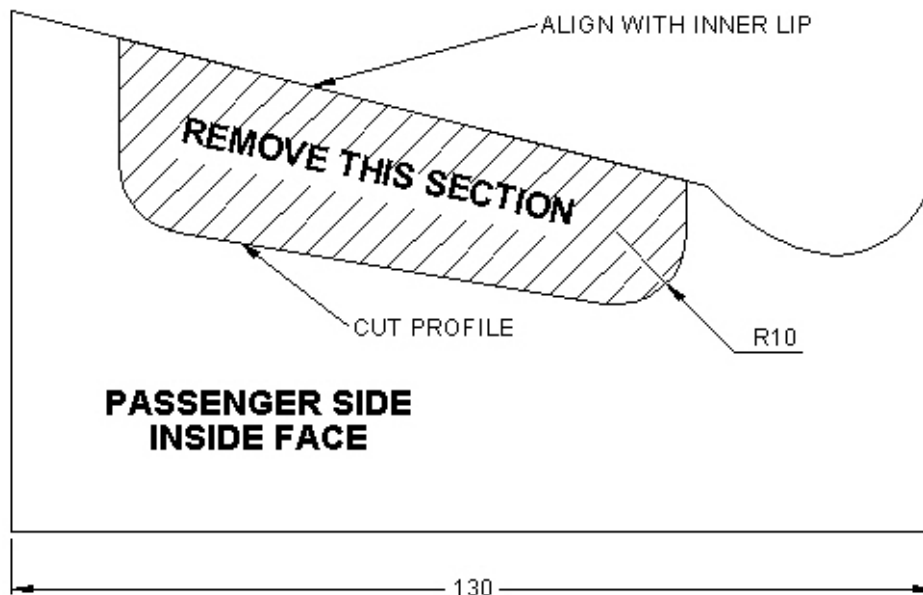
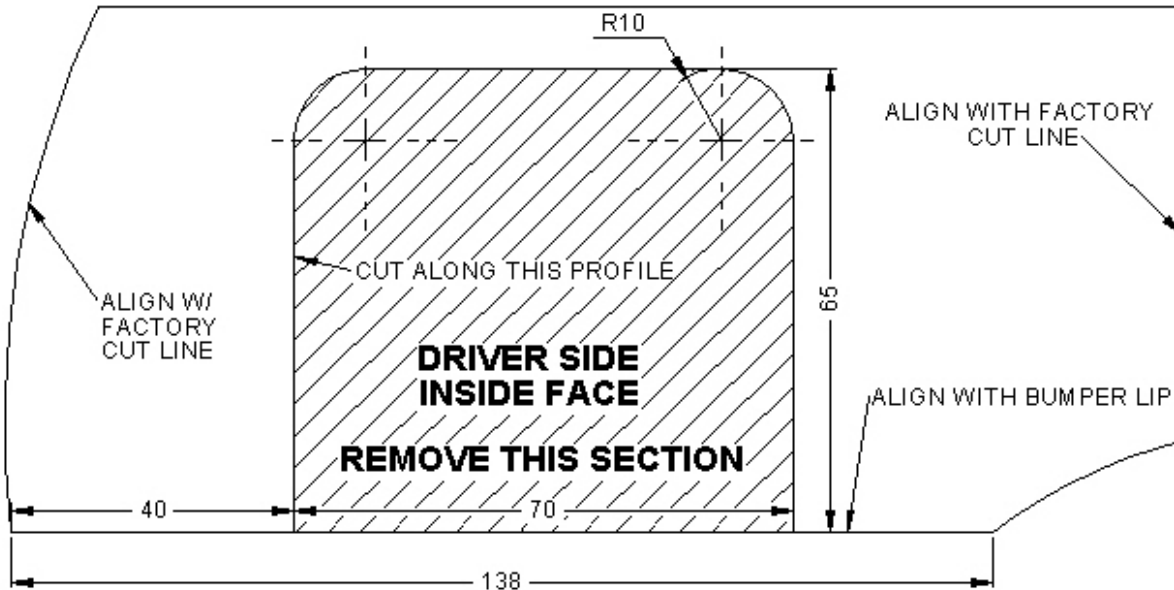



Wiring Loom Fitting Instructions  
To Suit Toyota Corolla MY14 Sedan  
Part Number 101181-WL

Wiring Loom Installation Instructions

Toyota Corolla Sedan  
Part No: 101181-WL

Tail Harness Length Required: 1800mm

Wiring Loom Installation Time: Approx 20 Mins





**Wiring Loom Fitting Instructions  
To Suit Toyota Corolla MY14 Sedan  
Part Number 101181-WL**

1. In the luggage compartment, remove the floor cover carpet.
2. Remove the luggage compartment rear trim by removing the two fasteners.
3. On the RHS of the luggage compartment, dislodge the RHS trim by first removing three clips. Carefully flex the RHS trim towards the centre of the vehicle. Repeat for LHS.
4. At the rear LHS, locate the grommet hole in the rear quarter well sitting vertically and facing the centre. Drill out the existing grommet hole to Ø30mm. If the grommet is occupied, drill a new hole nearby at a suitable location. De-burr any rough edges and apply rust inhibitor after drilling.
5. Disconnect the LHS 2-way tail light connector only. Connect the trailer patch harness (P/no: 101181-WL) connectors on the branch labelled LHS, in between the vehicle 2-way tail light connectors.
6. For reverse, locate the vehicle harness running down from the LHS boot hinge. Expose the vehicle harness wires and locate the vehicle reverse signal RED wire by using a multi-meter.
7. Connect the ezy-tap to the corresponding vehicle RED reverse wire, then connect the trailer patch wire terminal to the ezy-tap.
8. Route the trailer patch harness along the rear of the vehicle, towards the RHS. Secure the trailer patch ground ring terminal to the vehicle grounding point.
9. Disconnect the RHS tail light 2-way and 4-way connectors and connect the trailer patch harness connectors on the branch labelled RHS, in between the tail light connectors.
10. Secure the tail harness (tail length 1800mm) to the mounting bracket using M4 fasteners (not supplied).
11. Route the trailer patch harness across the vehicle and up into the drilled out hole ensuring the trailer patch rubber grommet is seated correctly. Secure grommet with a cable tie (not supplied).
12. From outside the vehicle, mount the trailer socket to the towbar mounting bracket using M4 fasteners (not supplied).
13. Inside the luggage compartment, connect the tail harness (tail length 1200mm) 8-way connector to the trailer harness mating 8-way connector.
14. Test the Trailer socket using a light board or multi-meter.
15. Secure the all harnesses using cables ties (not supplied).
16. Re-fit all removed parts and secure all fasteners.
17. Place instructions in glove box after fitment.